

EDNA MAYLE LEASE 33 ACRES WELL NUMBER 1 47-017-00814

(UTM(M) ZONE 17 NORTH)
NAD'83 GEO. LAT-(N) 39.278951 LONG-(W) 80.670912
NAD'83 UTM (M) N. 4,347,784 E. 528,384

NAD'83 GRID NORTH

LATITUDE 00°00'00"
LONGITUDE 00°00'00"
4,632'

3-19-29
LEON ASH REXFORD
100.41 AC. ±

FENCE POST S 88°16' W 901.92'

3-20-19
LEE & REGINA
McELWAIN
31.85 AC. ±

3-20-29
LILA S. SHARPES
54.56 AC. ±

3-19-36.1
WALTER & DEBORAH
RANDOPH
11.12 AC. ±

3-20-2.1
FRANCISCO &
MANUEL F.
AZEVEDO
10.31 AC. ±

06423
06424
06485
06486
06487

01496

LATITUDE 00°00'00"

47-017-00814
#1

00008

00038

3-20-60
WV RAILROAD
MAINTENANCE
AUTHORITY
26.24 AC. ±

3-20-20
FRANCISCO &
MANUEL F.
AZEVEDO
10.31 AC. ±



12 Vanhorn Drive | P.O. Box 150 | Glenville, WV 26351 | 304.462.5634
1412 Kanawha Boulevard, East | Charleston, WV 25301 | 304.346.3952
254 East Beckley Bypass | Beckley, WV 25801 | 304.255.5296
slsvw.com

LEGEND

- LEASE LINE
- SURFACE LINE
- TIE LINE
- CREEK
- ROADWAY
- RAILROAD
- COUNTY ROUTE
- PROPOSED WELL
- EXISTING WELL
- PERMITTED WELL
- DISTRICT-TAXMAP-PARCEL 00-00-00

NOTES ON SURVEY

1. WELL SPOT CIRCLE & TOPO MARK SCALE IS 1"=2000'.

I THE UNDERSIGNED, HEREBY CERTIFY THAT THIS PLAT IS CORRECT TO THE BEST OF MY KNOWLEDGE AND BELIEF AND SHOWS ALL THE INFORMATION REQUIRED BY LAW AND THE REGULATIONS ISSUED AND PRESCRIBED BY THE DIVISION OF ENVIRONMENTAL PROTECTION.

P.S. 849 *Gregory A. Smith*

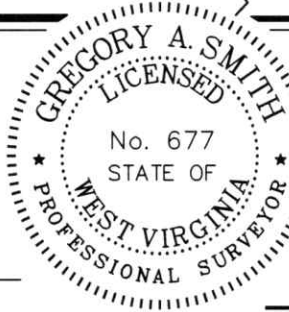

(+) DENOTES LOCATION OF WELL ON UNITED STATES TOPOGRAPHIC MAPS.

DATE NOVEMBER 10, 20 22

REVISED _____, 20 ____

OPERATORS WELL NO. 1

API WELL NO. 47 - 017 - 00814-P

STATE COUNTY PERMIT

MINIMUM DEGREE OF ACCURACY 1 / 2500 FILE NO. 9284-SURV-17 00814-REC-R01-JDR-221110.dwg

HORIZONTAL & VERTICAL CONTROL DETERMINED BY DGPS (SUBMETER MAPPING GRADE TIE TO CORS NETWORK) SCALE 1" = 300'

STATE OF WEST VIRGINIA
DIVISION OF ENVIRONMENTAL PROTECTION
OFFICE OF OIL AND GAS



WELL TYPE: OIL ___ GAS X LIQUID INJECTION ___ WASTE DISPOSAL ___ IF "GAS" PRODUCTION ___ STORAGE ___ DEEP ___ SHALLOW X

LOCATION: ELEVATION 835' WATERSHED BUCKEYE FORK OF MIDDLE ISLAND CREEK

DISTRICT GRANT COUNTY DODDRIDGE QUADRANGLE SMITHBURG 7.5'

SURFACE OWNER LEE & REGINA MCELWAIN ACREAGE 31.85 AC. ±

ROYALTY OWNER JAMES L. MAYLE ACREAGE 33 AC. ±

PROPOSED WORK: LEASE NO. 12/23/2022

DRILL ___ CONVERT ___ DRILL DEEPER ___ REDRILL ___ FRACTURE OR STIMULATE ___ PLUG OFF OLD

FORMATION ___ PERFORATE NEW FORMATION ___ PLUG AND ABANDON X CLEAN OUT AND REPLUG ___ OTHER ___

PHYSICAL CHANGE IN WELL (SPECIFY) TARGET FORMATION BIG INJUN

ESTIMATED DEPTH 1,800'

WELL OPERATOR UNKNOWN WVDEP PAID PLUGGING CONTRACT DESIGNATED AGENT JASON HARMON, WVDEP

ADDRESS 601 57TH STREET SE CHARLESTON, WV 25304

ADDRESS 601 57TH STREET SE CHARLESTON, WV 25304

COUNTY NAME PERMIT

STS

EDNA MAYLE LEASE 47-017-00814

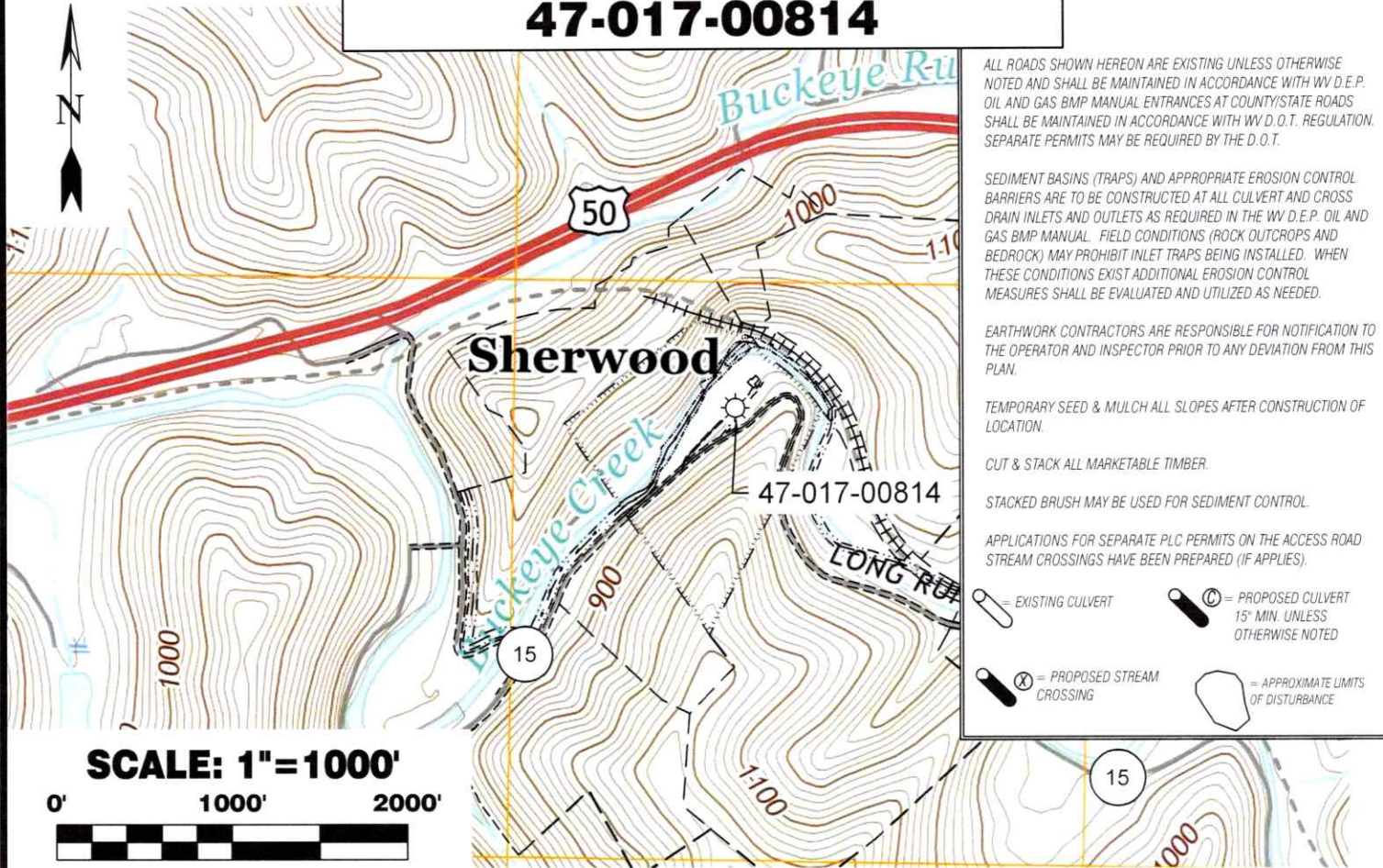

ALL ROADS SHOWN HEREON ARE EXISTING UNLESS OTHERWISE NOTED AND SHALL BE MAINTAINED IN ACCORDANCE WITH WV D.E.P. OIL AND GAS BMP MANUAL ENTRANCES AT COUNTY/STATE ROADS SHALL BE MAINTAINED IN ACCORDANCE WITH WV D.O.T. REGULATION. SEPARATE PERMITS MAY BE REQUIRED BY THE D.O.T.

SEDIMENT BASINS (TRAPS) AND APPROPRIATE EROSION CONTROL BARRIERS ARE TO BE CONSTRUCTED AT ALL CULVERT AND CROSS DRAIN INLETS AND OUTLETS AS REQUIRED IN THE WV D.E.P. OIL AND GAS BMP MANUAL. FIELD CONDITIONS (ROCK OUTCROPS AND BEDROCK) MAY PROHIBIT INLET TRAPS BEING INSTALLED. WHEN THESE CONDITIONS EXIST ADDITIONAL EROSION CONTROL MEASURES SHALL BE EVALUATED AND UTILIZED AS NEEDED.

EARTHWORK CONTRACTORS ARE RESPONSIBLE FOR NOTIFICATION TO THE OPERATOR AND INSPECTOR PRIOR TO ANY DEVIATION FROM THIS PLAN.

TEMPORARY SEED & MULCH ALL SLOPES AFTER CONSTRUCTION OF LOCATION.

CUT & STACK ALL MARKETABLE TIMBER.

STACKED BRUSH MAY BE USED FOR SEDIMENT CONTROL.

APPLICATIONS FOR SEPARATE PLC PERMITS ON THE ACCESS ROAD STREAM CROSSINGS HAVE BEEN PREPARED (IF APPLIES).

Detail Sketch for 47-017-00814

Detail Sketch NOT TO SCALE

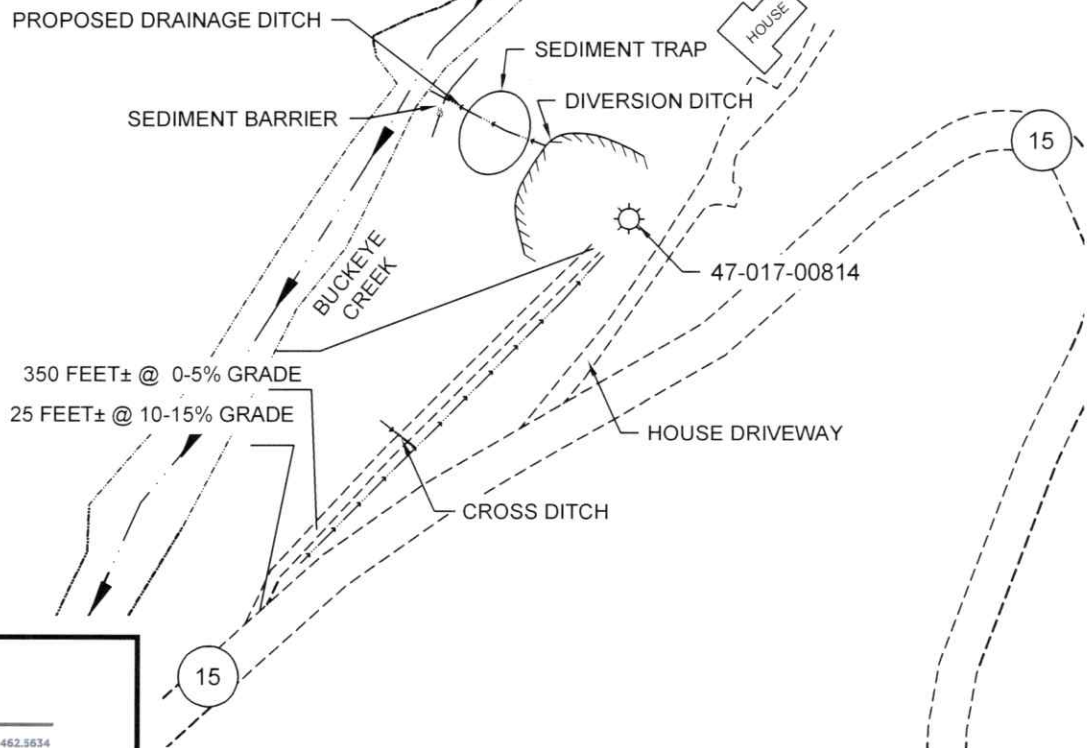

12 Vanhorn Drive | P.O. Box 150 | Glenville, WV 26351 | 304.462.5634
 1412 Kanawha Boulevard, East | Charleston, WV 25301 | 304.346.3952
 254 East Beckley Bypass | Beckley, WV 25801 | 304.255.5296

solv.com

DRAWN BY: JDR | FILE NO.: 9284 | DATE: 11-10-22 | CADD FILE: 9284-17 00814-REC-R00-JDR-221110.dwg

TOPO SECTION OF SMITHBURG, WV
7.5' TOPO QUADRANGLE

12/23/2022