

Latitude 39° 15'

Longitude 80° 40'

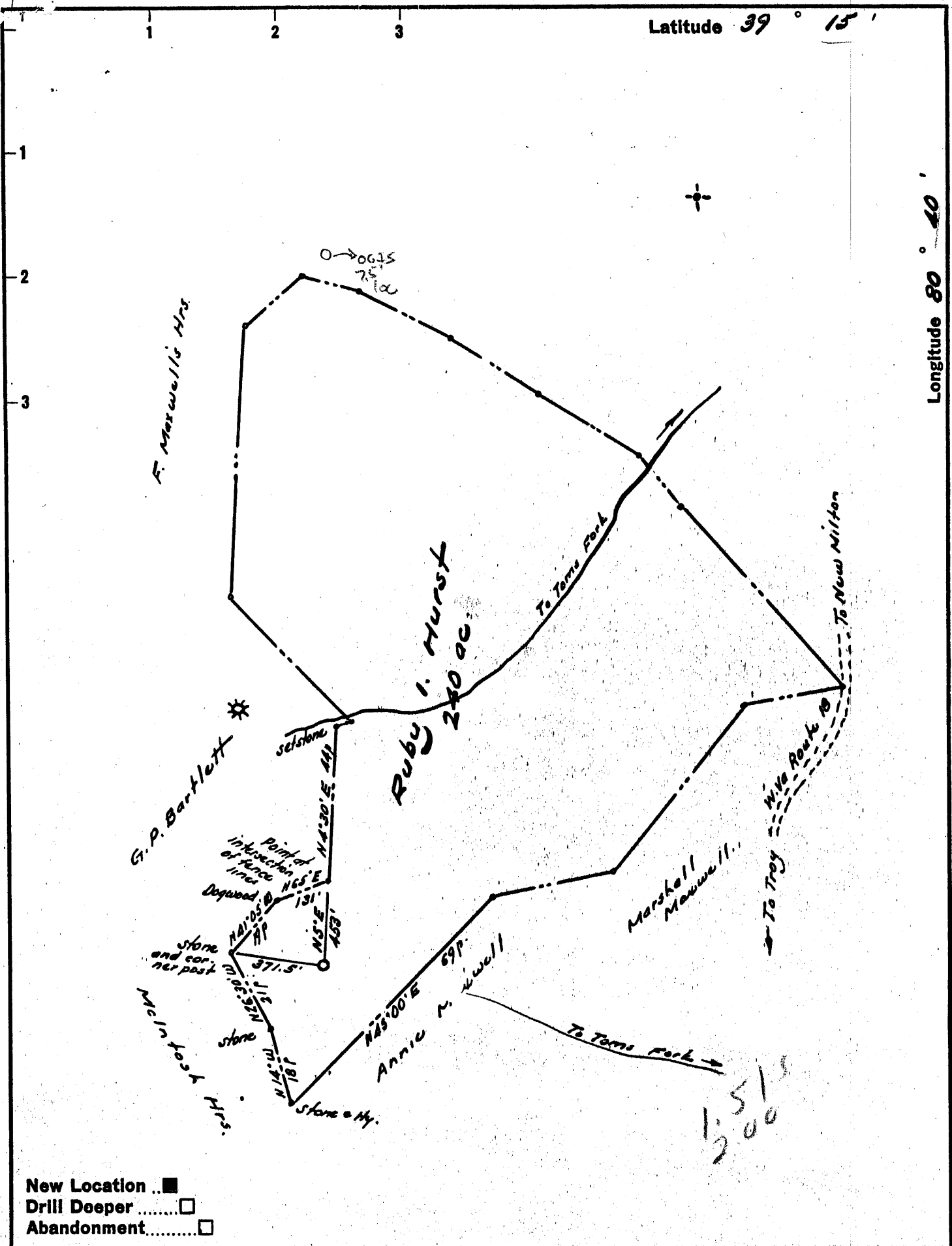

New Location ..
 Drill Deeper
 Abandonment.....

Company RAY BLACKWELL
 Address Box 127, West Union, W. Va.
 Farm Ruby I. Hurst et al
 Tract _____ Acres 240 Lease No. _____
 Well (Farm) No. one Serial No. _____
 Elevation (Spirit Level) 1122' or -7.5' top D
 Quadrangle Nadis NW near Milton 7.5' sq
 County Doddridge District New Milton
 Engineer W. S. [Signature]
 Engineer's Registration No. 1227
 File No. _____ Drawing No. _____
 Date May 1962 Scale 1" = 30'

STATE OF WEST VIRGINIA
 DEPARTMENT OF MINES
 OIL AND GAS DIVISION
 CHARLESTON

WELL LOCATION MAP
 FILE NO. Red-793

plugged 2/2/62
 + Denotes location of well on United States Topographic Maps, scale 1 to 62,500, latitude and longitude lines being represented by border lines as shown.
 - Denotes one inch spaces on border line of original tracing.

0-0 77



Transferred From Ray Blackwell

STATE OF WEST VIRGINIA
DEPARTMENT OF MINES
OIL AND GAS DIVISION 6

Quadrangle Vadis

Permit No. Dod-793

WELL RECORD

Oil or Gas Well Dry hole
(KIND)

Company R. C. Lawton & McAlester Fuel Co.
 Address P. O. Box 620, Magnolia, Ark.
 Farm Ruby I. Hurst Acres 240
 Location (waters) 1122.75' 400' Size
 Well No. 1 Elev. 1098' 16
 District New Milton County Doddridge 13
 The surface of tract is owned in fee by Ruby I. Hurst 10
 Address West Union, W. Va. 8 1/4 1075'
 Mineral rights are owned by Ruby I. Hurst 6 5/8
 Address _____ 5 3/16
 Drilling commenced June 2, 1962 3
 Drilling completed July 20, 1962 2
 Date Shot _____ From _____ To _____
 With _____
 Open Flow _____ /10ths Water in _____ Inch
 _____ /10ths Merc. in _____ Inch
 Volume _____ Cu. Ft.
 Rock Pressure _____ lbs. _____ hrs.
 Oil _____ bbls., 1st 2 1/2 hrs. COAL WAS ENCOUNTERED AT _____ FEET _____ INCHES
 WELL ACIDIZED _____ FEET _____ INCHES _____ FEET _____ INCHES
 WELL FRACTURED _____ FEET _____ INCHES _____ FEET _____ INCHES
 RESULT AFTER TREATMENT _____
 ROCK PRESSURE AFTER TREATMENT _____
 Fresh Water _____ Feet _____ water _____ Feet

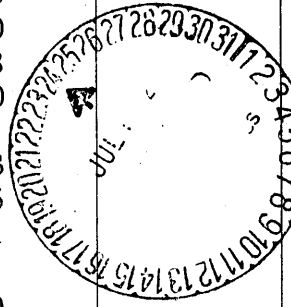
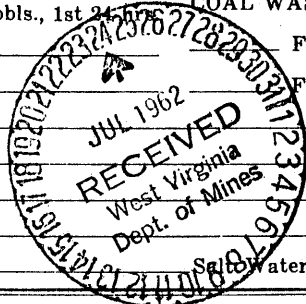

| Formation | Color | Hard or Soft | Top | Bottom | Oil, Gas or Water | Depth | Remarks |
|----------------|-------|--------------|-----|--------|-------------------|------------|-----------------|
| Surface | | | | | | 0 - 10' | Spudded |
| Sand | | Soft | | | | 10 - 30' | |
| Lime | | Medium | 30 | 125 | | 30 - 85' | Ran 18' Conduct |
| Shale | Grey | | 125 | 149 | | 125 - 149' | Pipe |
| Coal | Black | | 149 | 151 | | 149 - 151' | 2' Coal |
| Shale | Grey | | 151 | 176 | | 151 - 176' | |
| Lime | White | | 176 | 204 | | 176 - 204' | |
| Red Rock | | | 204 | 280 | | 204 - 280' | |
| Lime | White | | 280 | 290 | | 280 - 290' | |
| Sand | White | | 290 | 310 | | 290 - 310' | |
| Lime | Grey | | 310 | 325 | | 310 - 325' | |
| Red Rock | | | 325 | 336 | | 325 - 336' | |
| Lime | | | 336 | 350 | | 336 - 350' | |
| Sand | | | 350 | 378 | | 350 - 378' | |
| Red Rock | | Hard | 378 | 390 | | 378 - 390' | |
| Shale | Black | Soft | 390 | 417 | | 390 - 417' | |
| Lime | | | 417 | 433 | | 417 - 433' | Gritty |
| Shale & Shells | | | 433 | 465 | | 433 - 465' | |
| Lime | | | 465 | 481 | | 465 - 481' | |
| Red Rock | | Soft | 481 | 511 | | 481 - 511' | |
| Lime | | | 511 | 520 | | 511 - 520' | |
| Sand | | | 520 | 572 | | 520 - 572' | |
| Lime | | | 572 | 590 | | 572 - 590' | |
| Red Rock | | | 590 | 611 | | 590 - 611' | Over |

| Formation | Color | Hard or Soft | Top <i>6</i> | Bottom | Oil, Gas or Water | Depth Found | Remarks |
|----------------|---------|--------------|--------------|--------|-------------------|--------------|----------------|
| Lime | | | 611 | 658 | | 611 - 658' | |
| Shale | | | 658 | 670 | | 658 - 670' | |
| Lime | | | 670 | 720 | | 670 - 720' | |
| Shale & Shells | | | 720 | 762 | | 720 - 762' | |
| Lime | | | 762 | 793 | | 762 - 793' | |
| Red Rock | | | 793 | 850 | | 793 - 850' | |
| Lime | | | 850 | 885 | | 850 - 885' | |
| Red Rock | | | 885 | 903 | | 885 - 903' | |
| Lime | | | 903 | 938 | | 903 - 938' | |
| Red Rock | | | 938 | 950 | | 938 - 950' | |
| Lime | | | 950 | 969 | | 950 - 969' | |
| Red Rock | | | 969 | 979 | | 969 - 979' | |
| Lime | | | 979 | 1000 | | 979 - 1000' | |
| Shale | | | 1000 | 1015 | | 1000-1015' | |
| Lime | White | Hard | 1015 | 1051 | | 1015 - 1051' | |
| Shale & Shells | | | 1051 | 1136 | | 1051-1136' | |
| Lime | | | 1136 | 1150 | | 1136 - 1150' | |
| Sand | | | 1150 | 1175 | | 1150 - 1175' | |
| Shale & Shells | | | 1175 | 1217 | | 1175 - 1217' | |
| Sand | | | 1217 | 1256 | | 1217 - 1256' | |
| Lime | | | 1256 | 1293 | | 1256- 1293' | |
| Sand | | | 1293 | 1364 | | 1293- 1364' | |
| Shale & Shells | | | 1364 | 1369 | | 1364 - 1369 | |
| Lime | | | 1369 | 1430 | | 1369 - 1430' | |
| Shale & Shells | | | 1430 | 1438 | | 1430 - 1438' | |
| Sand | | | 1438 | 1463 | | 1438 - 1463 | |
| Lime | | | 1463 | 1545 | | 1463 - 1545 | Gritty |
| Sand | | | 1545 | 1569 | | 1545 - 1569' | |
| Shale & Shells | | | 1569 | 1629 | | 1569 - 1629 | |
| Sand | | | 1629 | 1690 | | 1629 - 1690 | |
| Lime | | | 1690 | 1770 | | 1690 - 1770 | |
| Sand | | | 1770 | 1818 | | 1770- 1818' | |
| Shale & Shells | | | 1818 | 1830 | | 1818 - 1830' | |
| Lime | Grey | | 1830 | 1935 | | 1830 - 1935 | |
| Shale & Shells | | | 1935 | 1976 | | 1935 - 1976 | |
| Lime | | Hard | 1976 | 2010 | | 1976 - 2010 | Little Lime |
| Sand | | | 2010 | 2038 | | 2010 - 2038' | |
| Lime | Grayish | Hard | 2038 | 2091 | | 2038 - 2091 | Big Lime |
| Sand | | | 2091 | 2169 | | 2091 - 2169 | Big Injun Sand |
| Shale | | | 2169 | 2211 | | 2211 | T. D. |

signed by _____ Date July 20, _____, 1962
APPROVED R. G. Lawton & McAlester Fuel Co Owner
By Jack Critcher
(Title)