

Latitude 39° 15'

Longitude 80° 45'

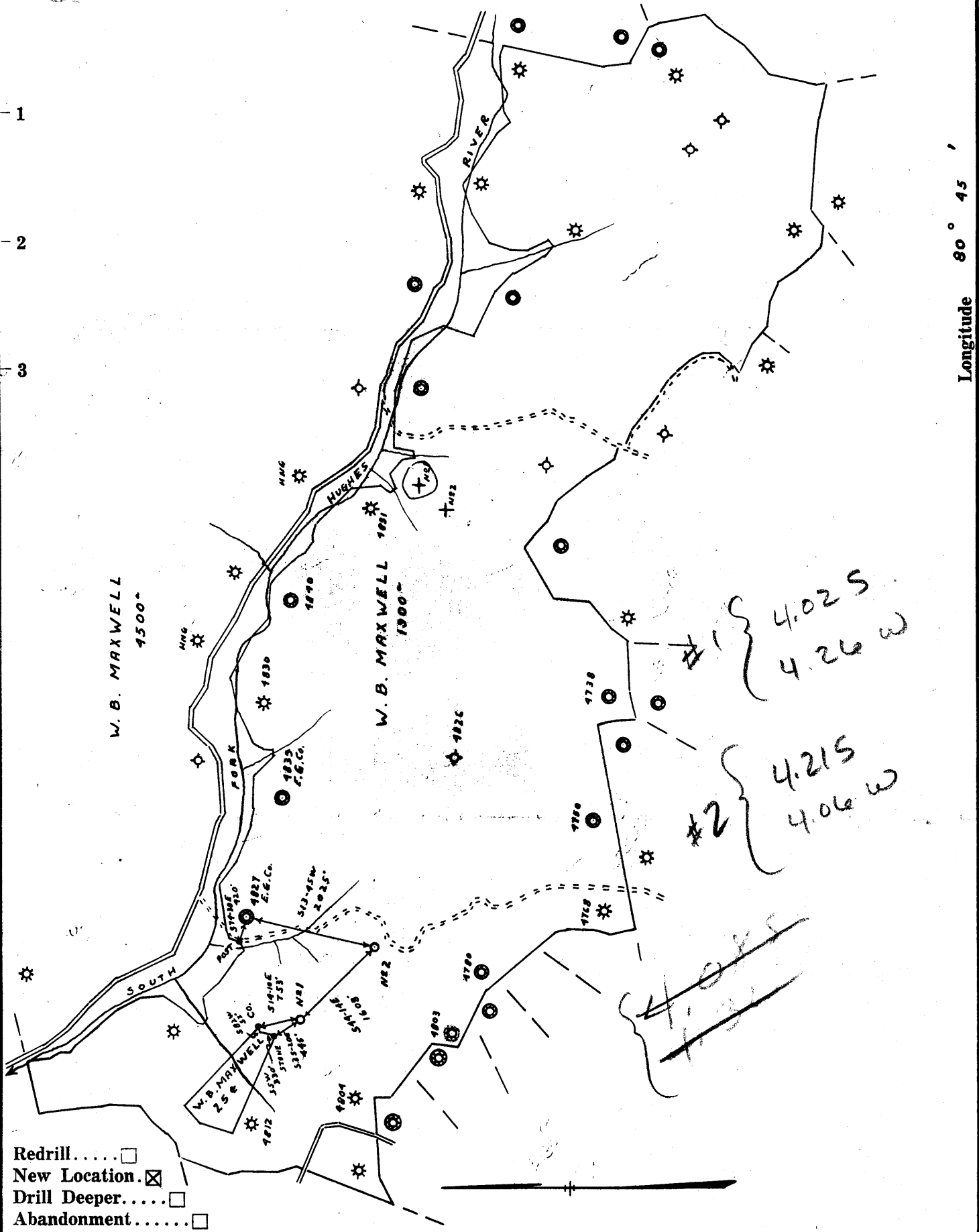

Redrill.....
 New Location.
 Drill Deeper.....
 Abandonment.....

Company	W. H. MOSSOR
Address	HARRISVILLE, W. VA.
Farm	W. B. MAXWELL
Tract	Acres 1900 Lease No.
Well (Farm) No.	26 - 27 Serial No. 1 - 2
Elevation (Spirit Level)	N ^o 1 = 1149' - N ^o 2 = 1148'
Quadrangle	HOLBROOK NE 14 NE
County	DODDRIDGE District SOUTH WEST
Engineer	J. D. JEFFRIES
Engineer's Registration No.	1084
File No.	199/32 Drawing No.
Date	6-2-60 Scale 1" = 2000'

STATE OF WEST VIRGINIA
 DEPARTMENT OF MINES
 OIL AND GAS DIVISION
 CHARLESTON

WELL LOCATION MAP
 FILE NO. DOD-422 #1
DOD-423 #2

+ Denotes location of well on United States Topographic Maps, scale 1 to 62,500, latitude and longitude lines being represented by border lines as shown.
 — Denotes one inch spaces on border line of original tracing.

RDME