

Latitude 39° 15'

Longitude 80° 45'

-1
-2
-3

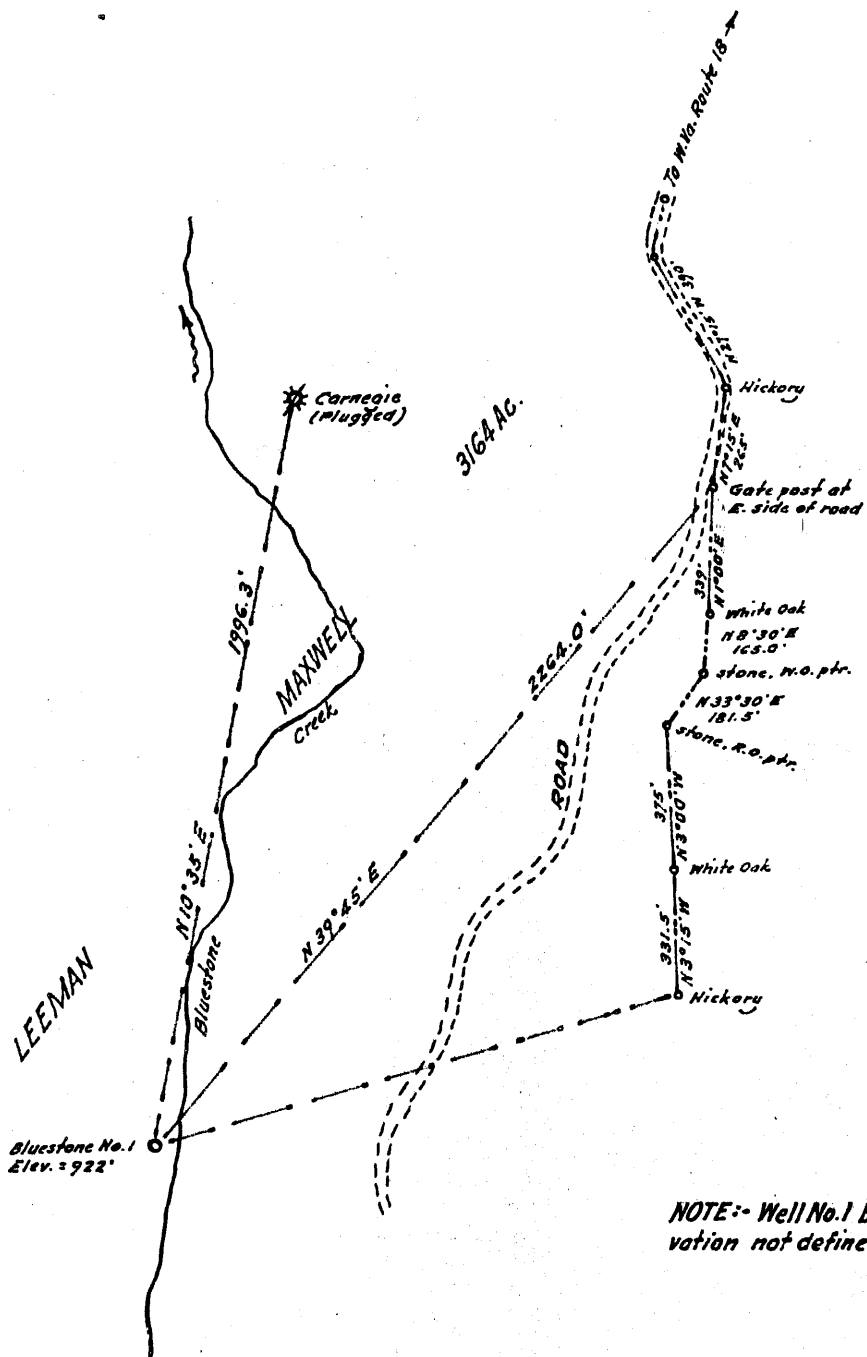

2.25
+
81W

PORTER MAXWELL

NOTE:- Well No.1 being drilled on 160 ac.(approx.) Reservation not defined by metes and bounds.

New Location..
Drill Deeper.....
Abandonment.....

Fee ownership is vested in Leeman Maxwell Heirs. Notify Mrs. Robert Holland of West Union, W. Va.

Company BLUESTONE OIL & GAS CO.
 Address Robert H. Holland, Agt., West Union, W. Va.
 Farm Leeman Maxwell
 Tract _____ Acres 3164 Lease No. _____
 Well (Farm) No. One Serial No. _____
 Elevation (Spirit Level) 922
 Quadrangle Holbrook NE
 County Doddridge District southwest
 Engineer [Signature]
 Engineer's Registration No. 1227
 File No. _____ Drawing No. _____
 Date January, 1957 Scale 1" = 500'

STATE OF WEST VIRGINIA
DEPARTMENT OF MINES
OIL AND GAS DIVISION
CHARLESTON

WELL LOCATION MAP
FILE NO. DOD-222

+ Denotes location of well on United States Topographic Maps, scale 1 to 62,500, latitude and longitude lines being represented by border lines as shown.
- Denotes one inch spaces on border line of original tracing.

6-6 133



STATE OF WEST VIRGINIA
DEPARTMENT OF MINES
OIL AND GAS DIVISION

Quadrangle Holbrook

Permit No. DOD222

WELL RECORD

Oil or Gas Well Gas

Company <u>Bluestone Oil & Gas Company</u>	Casing and Tubing	Used in Drilling	Left in Well	Packers
Address <u>West Union, West Virginia</u>				
Farm <u>Leeman Maxwell</u> Acres <u>3.164</u>				
Location (waters) <u>Bluestone Creek</u>	Size			
Well No. <u>1</u> Elev. <u>891</u> <u>927</u>	16			Kind of Packer
District <u>West Union</u> County <u>Doddridge</u>	13			
The surface of tract is owned in fee by <u>Justin M. Henderson</u>	10	280	-	Size of
Address <u>West Union, W.Va.</u>	8 1/4	1018	1018	
Mineral rights are owned by <u>Mary H. Holland, et al</u>	6 5/8			Depth set
Address <u>West Union, W.Va.</u>	5 3/16	1571	1571	
Drilling commenced <u>March 26, 1957</u>	3			Perf. top
Drilling completed <u>June 28, 1957</u>	2			Perf. bottom
Date Shot _____ From _____ To _____	Liners Used			Perf. top
With _____				Perf. bottom
Open Flow _____ /10ths Water in _____ Inch				
_____ /10ths Merc. in _____ Inch				
Volume <u>10,000</u> Cu. Ft.				
Rock Pressure <u>350</u> lbs. <u>24</u> hrs.				
Oil <u>None</u> bbls., 1st 24 hrs.				
WELL ACIDIZED <u>No</u>				
WELL FRACTURED <u>Yes, with oil</u> ✓				

CASING CEMENTED 5 1/2 SIZE 40 No. Ft. _____ Date _____

COAL WAS ENCOUNTERED AT None FEET _____ INCHES
 _____ FEET _____ INCHES FEET _____ INCHES
 _____ FEET _____ INCHES FEET _____ INCHES

RESULT AFTER TREATMENT 107,000 Cubic feet

ROCK PRESSURE AFTER TREATMENT 350 pounds

Fresh Water _____ Feet 80 Salt Water _____ Feet _____

Formation	Color	Hard or Soft	Top	Bottom	Oil, Gas or Water	Depth	Remarks
Red Rock	Red	Soft	0	50			
Sand	White	Soft	50	100	water	80	
Slate	White	"	100	310			
Sand			310	340			
Slate			340	357			
Red Rock			357	385			
Slate			385	405			
Red Rock			405	420			
Slate			420	463			
Sand			463	503			
Slate			503	544			
Red Rock			544	565			
lime			565	585			
Slate			585	725			
lime			725	835			
Sand			835	859			
Black lime			859	940			
B. Shale			940	962			
Slate			962	967			
Lime			967	985			
Sand			985	992			
Slate			992	1012			
Sand			1012	1018	Gas		1025-1030
"			1018	1050			
H. Sand			1050	1060			
" "			1060	1064			
Slate			1064	1070			
Sand			1070	1100			

(over)

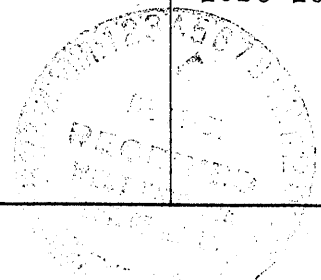

Formation	Color	Hard or Soft	Top \int	Bottom	Oil, Gas or Water	Depth Found	Remarks
Slate			1100	1144			
Sand			1144	1175			
Slate			1175	1295			
Sand			1295	1325			
Slate			1325	1355			
Lime			1355	1390			
Slate			1390	1455			
Red Rock			1455	1460			
lime			1460	1490			
Slate			1490	1497			
Little Lime			-1497	1522			
Black lime			1522	1530			
Blue Monday			1530	1540	gas		1535
Black Lime			1540	1959			
Pencil Cave			1559	1561			
Lime		gritty	-1561	1620	Big Lime		
Sand			1620	1693	gas		1675-1686 <u>Force</u>
Slate			1693	1712			
Lime			1712	1775			
Sand			1775	1900			
Lime		goldish	1900	2010			
Slate shell			2010	2164			
limey sand			2164	2188	Gantz ? (Probably 50')		
Slate Shell			2188	2225			
lime			2225	2268			
lime		gritty	2268	2275			
Bubble of gas			2275	2280			
Slate			2280				