

New Location

Drill Deeper

Abandonment

Company CITIES SERVICE OIL & GAS CORPORATION
 Address P.O. Box 873- Charleston, W/Va/. 25323

Farm Lewis Maxwell

Tract _____ Acres 2654.88 Lease No. C-32-A

Well (Farm) No. 43-A Serial No. GW-229

Elevation (Spirit Level) 1181.0'

Quadrangle Holbrook - N.E.

County Doddridge District West Union

Engineer James N. Sleep

Engineer's Registration No. 772

File No. _____ Drawing No. _____

Date January 28, '38 Scale 1 Inch = 1320'

STATE OF WEST VIRGINIA
 DEPARTMENT OF MINES
 OIL AND GAS DIVISION
 CHARLESTON

WELL LOCATION MAP

FILE NO. Dod-85-P

+ Denotes location of well on United States Topographic Maps, scale 1 to 62,500, latitude and longitude lines being represented by border lines as shown.

- Denotes one inch spaces on border lines of original tracing.

APR 29 1938

47-017

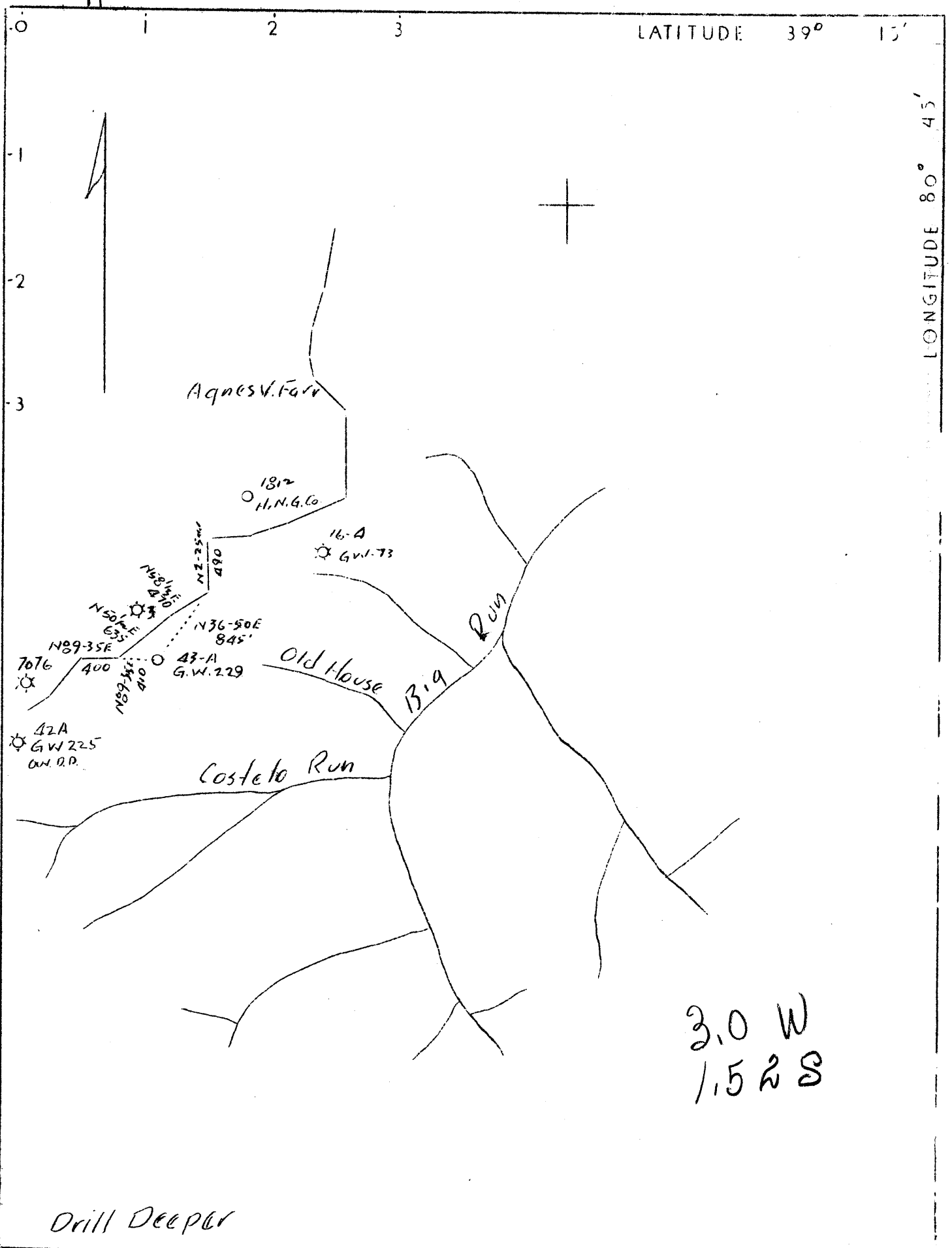

3.0 W
1.5 S

Company	Columbian Carbon
Address	P.O.Box 1240, Charleston, W.Va.
Farm	Lewis Maxwell
Tract	Acres 2654.88 Lease No. C-32-A
Well (Farm) No.	43-A Serial No. GW-229
Elevation (Spirit Level)	1181.0'
Quadrangle	Holbrook <i>N.E.</i>
County	Doddridge District West Union
Engineer	James N. Sell
Engineer's Registration No.	772
File No.	Drawing No.
Date	Jan. 28, 1938 Scale 1"-1320'

STATE OF WEST VIRGINIA
 Department of Mines
 OIL AND GAS DIVISION
 CHARLESTON

WELL LOCATION MAP

File No. DOD-858

+ Denotes location of well on United States Topographic Maps, scale 1 to 62,500, latitude and longitude lines being represented by border lines as shown.

— Denotes one inch spaces on border line of original tracing.

WEST VIRGINIA DEPARTMENT OF MINES
OIL AND GAS DIVISION

W E L L R E C O R D

Permit No. Dod-85

Gas Well

Holbrook Quad.

DRILLED DEEPER

CASING & TUBING

Company	Columbian Carbon Co.	Cond.	14	14
Address	Box 1240, Charleston, W.Va.	10	311'5"	
Farm	Lewis Maxwell Acres 2654.88	8 1/2	930'3"	
Location	Arnolds Creek	6 5/8	1855	1855
Well No.	43-A (C-43-A) Elev. 1011.0 1181	2 (Tub)	2019'4"	Pulled
District	West Union County Doddridge			
Surface	West Union Bank, Spec. Rec. for Lewis Maxwell Est., West Union, W.Va.			
Mineral	Same			
Drilling (Deeper)	Commenced 2/12/38			
	Completed 2/25/38			
Volume	28,992 Cu.Ft.			

Formation	Color	Hov	TOP	Base	Result	Formation	Color	Hov	TOP	Base	Result
Drilling Commenced			April		1922	Slate			1732	1805	
Drilling Completed			May		18, 1922	Little Lime			1805	1823	
Red Rock			0	14		Slate			1823	1828	
Sand			14	35		Sand-Blue Monday			1828	1840	Gas
Red Rock			35	140		Pencil Cave			1840	1850	1745
Sand			140	190		Big Line			1850	1911	
Red Rock			190	230		Big Injun			1911	1904	
Lime			230	270		Slate			1904	2007	Gas
Red Rock			270	290		<u>DRILLED DEEPER</u>					1947,
Lime			290	310		Commenced drilling deeper		2-12-	38		1969,
Red Rock			310	350		Completed drilling deeper		2-25-	38		1978,
Sand			350	420							1994.
Slate	White		420	435		Line Shells			2007	2100	
Lime			435	470		Line (Gritty)			2100	2140	
Red Rock			470	520		Gantz Sand	NG		2140	2268	
Lime			520	540		Slate & Line Shells			2268	2347	Berea
Slate			540	560		Sand	H		2347	2360	Slight
Sand			560	585		Slate & Line Shells			2360	2551	Show
Slate			585	630		Gordon Stray Sand &					Gas
Lime			630	780		Gordon Sand			2551	2570	2188-
Sand			780	815		Slate			2570	2600	2195
Slate			815	821							
Lime			821	846		NEW TOTAL DEPTH					2600
Red Rock			846	854							
Red Rock			854	874							
Red Rock			874	905							
Slate			905	942							
Big Dunkard Sand			942	978							
Slate			978	990							
Gas Sand			990	1020							
Slate			1020	1131							
Gas Salt Sand			1131	1200							
Slate			1200	1225							
Sand			1225	1240							
Slate			1240	1245							
Gas Salt Sand			1245	1410		Little					
Slate	Black		1410	1440		Show Oil					
Gas Salt Sand			1440	1465		1340-					
Slate			1465	1495		1442					
Gas Salt Sand			1495	1555							
Lime			1555	1610							
Sand			1610	1660		Little					
Lime			1660	1720		Show Gas					
Maxon Sand			1720	1757		1637					
Slate			1757	1762							
Sand			1762	1782							

