

LATITUDE 39° 20'

15' 100

LONGITUDE 80° 42' 30"



7'5 OGIS topo location

7.5' 100	<u>1.795</u>	15' 100	<u>1.795</u>
	<u>0.48W</u>	(calc.)	<u>2.91W</u>

Company PHILADELPHIA OIL Co

Farm JOHN G. COULAHAN

Quad SMITHBURG Centerpoint 15'SW

County Dodd

District WEST UNION

WELL LOCATION MAP

File No. 017-45

017-45

LOCATION OF WELL NO 4998

PHILADELPHIA OIL COMPANY OF PITTSBURGH PA

LEASE NO 20851 LESSOR JOHN C. COULEHAN ACRES 100
 DISTRICT WEST UNION COUNTY DODDRIDGE STATE W.VA.
 QTR QUADRANGLE CENTERPOINT SW 34 DATE SEPT 26 1933 NO. ON LEASE 6
 LEASE EXPIRES F. RESERVATION ELEVATION 987-L

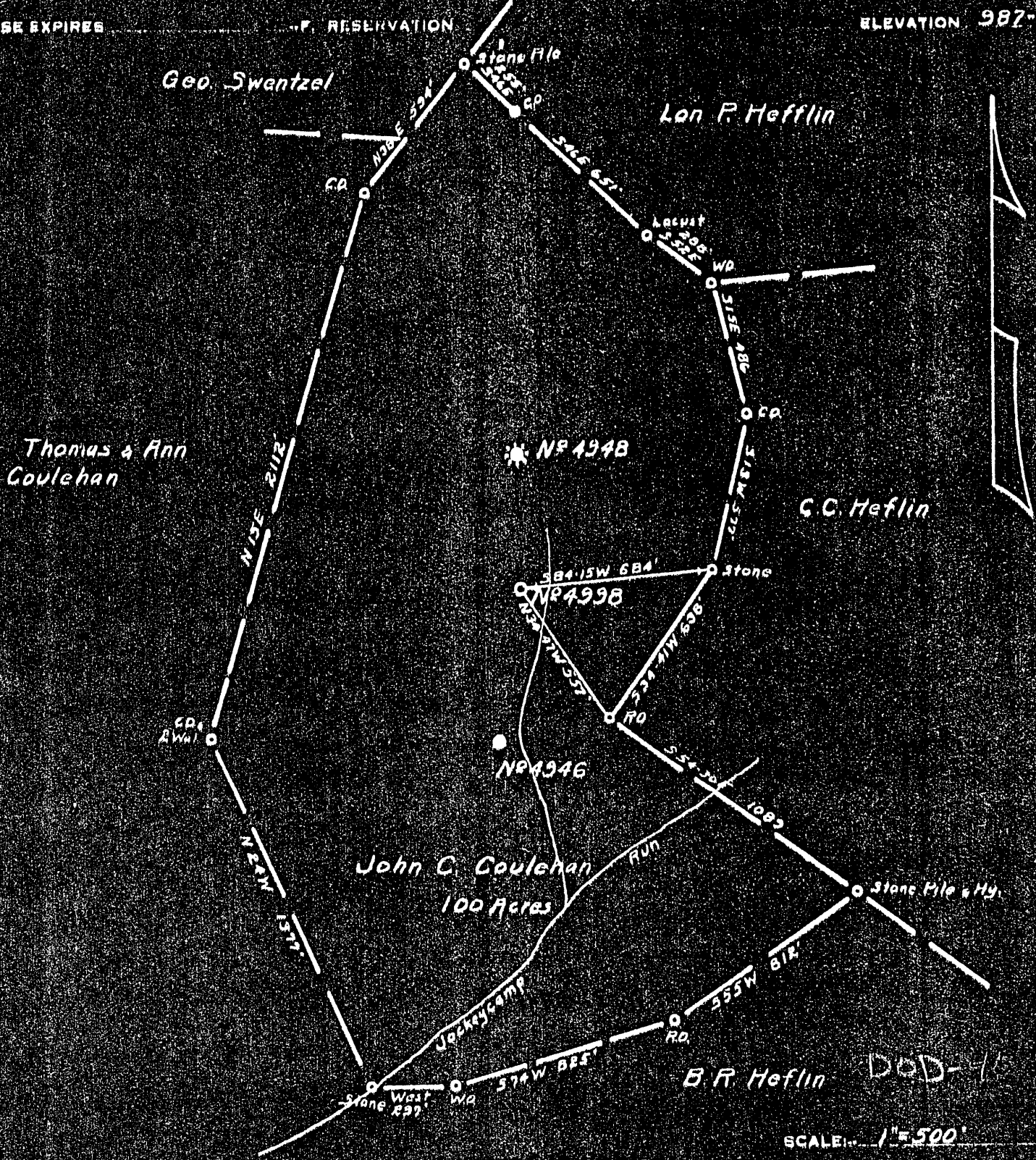

ENGINEER'S CERTIFICATE

I, THE UNDERSIGNED, HEREBY CERTIFY THAT THIS MAP IS CORRECT AND SHOWS ALL THE INFORMATION TO THE BEST OF MY KNOWLEDGE AND BELIEF, REQUIRED BY THE OIL AND GAS SECTION OF THE MINING LAWS OF WEST VIRGINIA.

ACKNOWLEDGED BEFORE ME, A NOTARY PUBLIC, THIS

26" DAY OF

[Signature]
 ENGINEER
 1933
[Signature]
 NOTARY PUBLIC.

WEST VIRGINIA DEPARTMENT OF MINES

OIL AND GAS DIVISION

PRELIMINARY DATA SHEET NO. 1

File No. Dod-45

Well No. 4998

PHILADELPHIA OIL COMPANY

Company, of CLARKSBURG,

WEST VIRGINIA

on the John C. Coulehan

Farm

containing 100

acres. Location Map Ref. Centerpoint S.W. 3-2

West Union

District, in Doddridge

County, West Virginia

Lawrence

The surface of the above tract is owned in fee by John C. Coulehan, Est. C/o Coulehan.

of West Union, West Va., R.F.D.#2

address, and the mineral rights are owned by

Same

Same

The oil and gas privileges are held under lease by the above named company, and this well is drilled under permit

No. Dodd-45

issued by the West Virginia Department of Mines, Oil and Gas Division

October 9th

1933

Elevation of surface at top of well, 987'

Spirit

~~600000~~

The number of feet of the different sized casings used in the well.

16

feet

13"

size. Wood conductor.

316

feet

10"

size, csg.

968

feet

8-1/4"

sized csg.

1718

feet

6-5/8"

size, csg.

feet

sized csg.

feet

size, csg.

feet

sized csg.

packer of

size, set at

packer of

size, set at

, in casing perforated at

feet to

feet.

, in casing perforated at

feet to

feet.

Coal was encountered at 130-131

feet; thickness

12

inches, and at

702-703

feet; thickness 12

inches; and at

feet; thickness

inches.

Liners were used as follows: (Give details)

December 18th, 1933.

Date.

Well Located 9-21-1933.

Began Drg. 10-30-1933.

Comp. Drg. 12-2-1933.

Producing Oil.

Approved

PHILADELPHIA OIL COMPANY.

Owner.

By

F. E. Bridgen.

(TITLE)

DEC 21 1933

PHILADELPHIA OIL COMPANY Company

CLARKSBURG, WEST VA. Address

COMPLETION DATA SHEET

No. 2

FORMATION RECORD

Well No. 4998, John C. Coulehan farm. *DOD-45*
West Union Dist., Doddridge Co., W.Va.

Name	Color	Character	Oil, Gas or Water	Top	Bottom	Thickness	Total Depth	Remarks
Clay	Red	Soft	Water 80'	0	15	15	15	
Slate	White	"		15	80	65	80	
Sand	"	"		80	130	50	130	
Mapletown Coal	Black	"		130	131	1	131	
Lime & Slate		Broken		131	180	49	180	
Lime	White	Hard		180	205	25	205	
Red Rock	Red	Soft		205	230	25	230	
Lime	White	Hard		230	250	20	250	
Slate	"	Soft		250	285	35	285	
Sand	"	"		285	310	25	310	
Slate	"	"	310	370	60	370		
Lime	"	Hard	370	518	148	518		
Red Rock	Red	Soft	518	578	60	578		
Lime	White	Hard	578	640	62	640		
Red Rock	Red	Soft	640	660	20	660		
Lime	White	Hard	660	678	18	678		
Slate	"	Soft	678	702	24	702		
Pgh. Coal	Black	"	702	703	1	703		
Lime	White	Hard	703	722	19	722		
Red Rock		Soft	722	775	53	775		
Lime	White	Hard	775	800	25	800		
Slate	Black	Soft	800	865	65	865		
Lime	White	Hard & Gritty	865	883	18	883		
Slate	Dark	Soft	883	924	41	924		
Lime	White	Hard	924	970	46	970		
Slate	"	Soft	970	1000	30	1000		
Big Dunkard	"	"	1000	1089	89	1089		
Slate	Dark	"	1089	1099	10	1099		
Stray Sand	"	"	1099	1134	35	1134		
Slate	White	"	1134	1148	14	1148		
Gas Sand	"	Hard	1148	1180	32	1180	S.L.1149'	
Slate	"	Soft	1180	1215	35	1215		
1st. Salt Sand	"	Hard	1215	1290	75	1290		
Slate	"	Soft	1290	1312	22	1312		
2nd. Salt Sand	"	Hard	Sh. Oil 1331'	1312	1360	48	1360	S.L.1341'
Slate	Dark	Soft	1360	1414	54	1414		
3rd. Salt Sand	White	Hard	1414	1492	78	1492		
Slate	"	Soft	1492	1515	23	1515		
Maxon Sand	"	Hard	1515	1550	35	1550		
Slate	Dark	Soft	1550	1622	72	1622		
Lime	White	Hard	1622	1645	23	1645		
Slate	Dark	Soft	1645	1685	40	1685		
Stray Sand	White	Hard	1685	1692	7	1692		
Slate	Dark	Soft	1692	1695	3	1695		
Little Lime	White	Hard	1695	1714	19	1714		

Cont'd to Sheet No. 2

shot
Well was not shot at Not shot. feet; well was shot at _____ feet.

~~SUCK~~ salt
Fresh water at 80' feet; fresh water at _____ feet.

producing
Well was 6-5/8" hole. PHILADELPHIA OIL COMPANY.

~~SUCK~~
December 18th, 1933. Date Approved By, F. E. Brigden. Owner

NOTE: All bottom formations must be noted as indicated above and all key-rocks and oil and gas sands must be recorded under their proper geological names in the district as well as any local names commonly used in the district for such strata.

DEC 21 1933

PHILADELPHIA OIL COMPANY.....Company

COMPLETION DATA SHEET

CLARKSBURG, WEST VA.Address

No. 2

Well No. 4998, John C. Coulehan farm.

FORMATION RECORD

West Union Dist., Doddridge Co., W.Va.

Name	Color	Character	Oil, Gas or Water	Top	Bottom	Thickness	Total Depth	Remarks
Blue Monday	White	Hard		1714	1751	37	1751	S.L.1718'
Big Lime	"	"		1751	1805	54	1805	
Big Injun	"	"	G-1812-14 O-1815-22	1805		21	1826	S.L.1809'
					TOTAL	DEPTH	1826'	

Well was not shot at..... **Not shot.**feet; well was shot at.....feet.

~~XXXX~~ Fresh water at 80'feet; fresh water at.....feet.

Well was producing 6-5/8 hole. ~~XXXX~~

PHILADELPHIA OIL COMPANY.

December 18th, 1933.Date

Approved..... By. F. E. Brigden.Owner

NOTE: All bottom formations must be noted as indicated above and all key-rocks and oil and gas sands must be recorded under their proper geological names in the district as well as any local names commonly used in the district for such strata.

DEC 21 1933