

LOCATION OF WELL NO. 4980

Dodd 15 15

PHILADELPHIA OIL COMPANY OF PITTSBURGH PA.

LEASE NO. 14232-32 LESSOR W.V. HOGUE ACRES 125

DISTRICT CENTRAL COUNTY DODDRIDGE STATE W. VA.

QTR. QUADRANGLE WEST UNION-S.E. 2C DATE OCT-21-1929 NO. ON LEASE 2

LEASE EXPIRES . . . F. RESERVATION ELEVATION 973

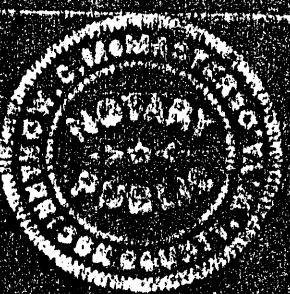
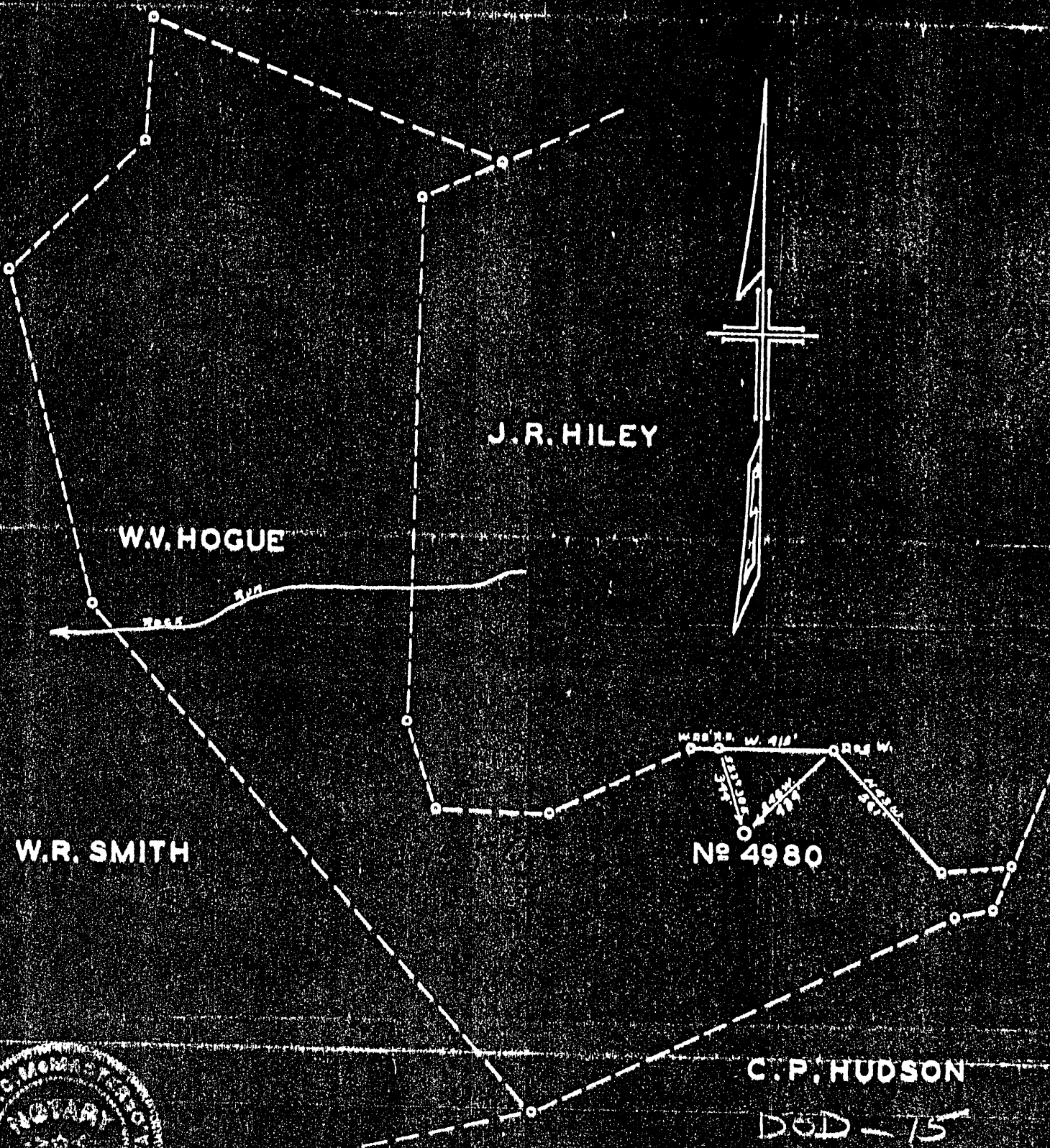

C. P. HUDSON  
 DOD-75  
 SCALE: 1" = 500'

ENGINEER'S CERTIFICATE

I, THE UNDERSIGNED, HEREBY CERTIFY THAT THIS MAP IS CORRECT AND SHOWS ALL THE INFORMATION TO THE BEST OF MY KNOWLEDGE AND BELIEF REQUIRED BY THE OIL AND GAS SECTION OF THE MINING LAWS OF WEST VIRGINIA.

*C. P. Hudson*  
 ENGINEER

ACKNOWLEDGED BEFORE ME A Notary Public  
 DAY OF October 1929

THIS 21st

W. C. McMasters, Notary Public  
 My Commission Expires  
 March 23, 1938

*W. C. McMasters*

LATITUDE 39° 20'

80° 47' 30"

LONGITUDE

7.5' 10C  
OGIS



7.5 OGIS topo location

7.5' 10C	<u>1.99 S</u>	15' 10C	<u>1.99 S</u>
	<u>1.24 W</u>	(calc.)	<u>3.47 W</u>

Company PHILADELPHIA OIL

Farm WV HOGUE

Quad West Union + SE 15'

County Loan

District Central

WELL LOCATION MAP

File No. Dodd 15

Dod 15-

WEST VIRGINIA DEPARTMENT OF MINES

Oil and Gas Section

PRELIMINARY DATA SHEET NO. 1

File No. .... Well No. **4980**

**PHILADELPHIA OIL COMPANY,** Company, of **CLARKSBURG,**

**WEST VIRGINIA,** on the **Hoge - Smith** Farm

containing **125** acres. Location .....

**Central** District, in **Doddridge** County, West Virginia.

The surface of the above tract is owned in fee by **W. V. Hoge**

of **% City Bank Bldg. Wheeling, W. Va.** address, and the mineral rights are owned by  
**S. A. Smith** #349 Washington Ave. Clarksburg, W. Va.  
**W. V. Hoge** of **% City Bank Bldg., Wheeling, W. Va.**

The oil and gas privileges are held under lease by the above named company, and this well is drilled under permit No. .... issued by the West Virginia Department of Mines, Oil and Gas Section, **November 30th, 1929** 19.....

Elevation of surface at top of well, **973'** Spirit ~~level~~

The number of feet of the different sized casings used in the well.

.....	<b>16</b>	feet	.....	<b>13"</b>	size.	Wood conductor.
<b>694</b>	feet	<b>10"</b>	size, csg.	<b>1262</b>	feet	<b>8-1/4"</b> sized csg.
<b>2043</b>	feet	<b>6-5/8"</b>	size, csg.	<b>2738</b>	feet	<b>5-5/16"</b> sized csg.
.....	feet	.....	size, csg.	.....	feet	..... sized csg.

240  
C.M.S.

..... packer of ..... size, set at .....

..... in casing perforated at ..... feet to ..... feet.  
..... in casing perforated at ..... feet to ..... feet.

Coal was encountered at **274-276** feet; thickness **24** inches, and at **762-764** feet; thickness **24** inches; and at ..... feet; thickness ..... inches.

Liners were used as follows: (Give details) .....

**May 21st, 1930**  
Date.

Approved **PHILADELPHIA OIL COMPANY,** Owner.

By **J. F. McNary,** *J. F. McNary*  
(Title) **Superintendent.**

PHILADELPHIA OIL COMPANY. Company

COMPLETION DATA SHEET

CLARKSBURG, WEST VA. Address

DOD-15

NO. 2

Well No. 4980, S.A. Smith & W.V. Hoge farm.

FORMATION RECORD

Central Dist., Doddridge Co. W.Va.

Name	Color	Character	Oil, Gas or Water	Top	Bottom	Thickness	Total Depth	Remarks
Red Rock				0	25	25	25	
Stone				25	40	15	40	
Red Rock				40	80	40	80	
Sand				80	130	50	130	
White shale				130	160	30	160	
Red Rock				160	240	80	240	
Lime				240	255	15	255	
White shale				255	274	19	274	
Coal				274	276	2	276	
Red Rock				276	320	64	320	
Lime				320	365	45	365	
Red Rock				365	385	20	385	
Dark Slate				385	430	45	430	
Red Rock				430	470	40	470	
Lime				470	490	20	490	
Dark Slate				490	528	38	528	
Lime				528	540	12	540	
Red Rock				540	550	10	550	
Lime				550	565	15	565	
Red Rock				565	585	20	585	
Lime				585	600	15	600	
Hurry up Sand				600	668	68	668	
Dark Slate				668	675	7	675	
Lime				675	690	15	690	
Slate				690	705	15	705	
Lime				705	715	10	715	
Gray Slate				715	722	7	722	
Sand-shells				722	730	8	730	
Dark Slate				730	762	32	762	
Coal (Pgh)				762	764	2	764	(Blossom)
Lime				764	780	16	780	
Slate				780	800	20	800	
Lime				800	820	20	820	
Slate				820	850	30	850	
Red Rock				850	865	15	865	
Slate				865	875	10	875	
Red Rock				875	915	40	915	
Slate				915	925	10	925	
Red Rock				925	945	20	945	
Slate				945	955	10	955	
Red Rock				955	975	20	975	
Lime-Shells				975	980	5	980	
Slate				980	1000	20	1000	
Lime-Shells				1000	1020	20	1020	
Sand				1020	1050	30	1050	
Black Slate				1050	1085	35	1085	

See sheet #2

PHILADELPHIA OIL COMPANY.

Company

COMPLETION DATA SHEET

CLARKSBURG? WEST VA.

Address

NO. 2

Well No. 4980, S.A. Smith & W.V. Hoge farm.

FORMATION RECORD

Central Dist., Doddridge Co., W.Va.

Name	Color	Character	Oil, Gas or Water	Top	Bottom	Thickness	Total Depth	Remarks
Lime				1085	1100	15	1100	
White Slate				1100	1105	5	1105	
Lime Shell				1105	1140	35	1140	
Slate				1140	1180	40	1180	
Lime & Shell				1180	1200	20	1200	
Blk Shale				1200	1240	40	1240	
Big Dunkard				1240	1252	12	1252	
Black Shale				1252	1268	16	1268	
Sand				1268	1290	22	1290	
Slate				1290	1332	42	1332	
1st. Salt				1332	1440	18	1440	
Slate				1440	1560	120	1560	
2nd. Salt				1560	1630	70	1630	
Blk. Slate				1630	1690	30	1690	
3rd. Salt				1690	1840	150	1840	
Dark Slate				1840	1940	100	1940	
Maxon Shells				1940	1955	15	1955	
Slate				1955	1975	20	1975	
Lime				1975	1985	10	1985	
Slate				1985	2002	17	2002	
Lime				2002	2010	8	2010	
Pencil Cave				2010	2018	8	2018	
Blue Monday				2018	2026	8	2026	
Big Lime				2026	2089	63	2089	
Big Injun			Gas 2097	2089	2117	28	2117	
Slate			Oil 2100	2177	2180	3	2180	
Squaw Sand			" 2106	2180	2245	65	2245	
Slate				2245	2330	85	2330	
Gantz				2330	2440	110	2440	
Blk Shale				2440	2530	10	2530	
Slate				2530	2540	10	2540	
50 Ft. Sand				2540	2550	10	2550	
Slate				2550	2585	35	2585	
30 Ft. Sand				2585	2595	10	2595	
Slate				2595	2615	20	2615	
Lime				2615	2645	30	2645	
Slate				2645	2657	12	2657	
Lime				2657	2670	13	2670	
Slate				2670	2723	53	2723	
Lime-Shell				2723	2724	1	2724	
Slate				2724	2731	7	2731	
Gordon Stray				2731	2736	5	2736	
Gordon Sand			Oil 2740	2738	2746	8	2746	
			" 2744					
T O T A L D E P T H -----							2749	

Well was ~~1085~~ shot at 2106 feet; well was shot at (2 Shots) 2745 feet.

Salt Fresh water at \_\_\_\_\_ salt feet; fresh water at \_\_\_\_\_ feet.

Well was producing hole. ~~xxx~~

PHILADELPHIA OIL COMPANY.

May 21st, 1930.

Approved \_\_\_\_\_

By, J. F. *Malary*

Owner Superintendent.

Date

NOTE: All bottom formations must be noted as indicated above and all key-rocks and oil and gas sands must be recorded under their proper geological names in the district as well as any local names commonly used in the district for such strata.