

1501378P

WW-7
8-30-06



West Virginia Department of Environmental Protection
Office of Oil and Gas

WELL LOCATION FORM: GPS

API: 47-0151378 WELL NO.: D.H. STEPHENSON #3

FARM NAME: THOMAS RICKMERS

RESPONSIBLE PARTY NAME: RAVEN RIDGE ENERGY, LLC

COUNTY: CLAY DISTRICT: UNION

QUADRANGLE: ELKHURST 7.5'

SURFACE OWNER: THOMAS RICKMERS

ROYALTY OWNER: HELEN V. STANLEY, et al

UTM GPS NORTHING: 4253001.9

UTM GPS EASTING: 481089 GPS ELEVATION: 1133'

The Responsible Party named above has chosen to submit GPS coordinates in lieu of preparing a new well location plat for a plugging permit or assigned API number on the above well. The Office of Oil and Gas will not accept GPS coordinates that do not meet the following requirements:

1. Datum: NAD 1983, Zone: 17 North, Coordinate Units: meters, Altitude: height above mean sea level (MSL) – meters.
2. Accuracy to Datum – 3.05 meters
3. Data Collection Method:

Survey grade GPS : Post Processed Differential

Real-Time Differential

Mapping Grade GPS : Post Processed Differential

Real-Time Differential

4. Letter size copy of the topography map showing the well location.

I the undersigned, hereby certify this data is correct to the best of my knowledge and belief and shows all the information required by law and the regulations issued and prescribed by the Office of Oil and Gas.

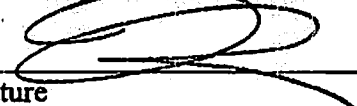
Signature

OFFICER
Title

5/12/2014
Date

Received

MAY 12 2014

Office of Oil and Gas
WV Dept. of Environmental Protection

1501378P

CUNNINGHAM ENERGY AO, CLAY CO. WV, UNION DIST

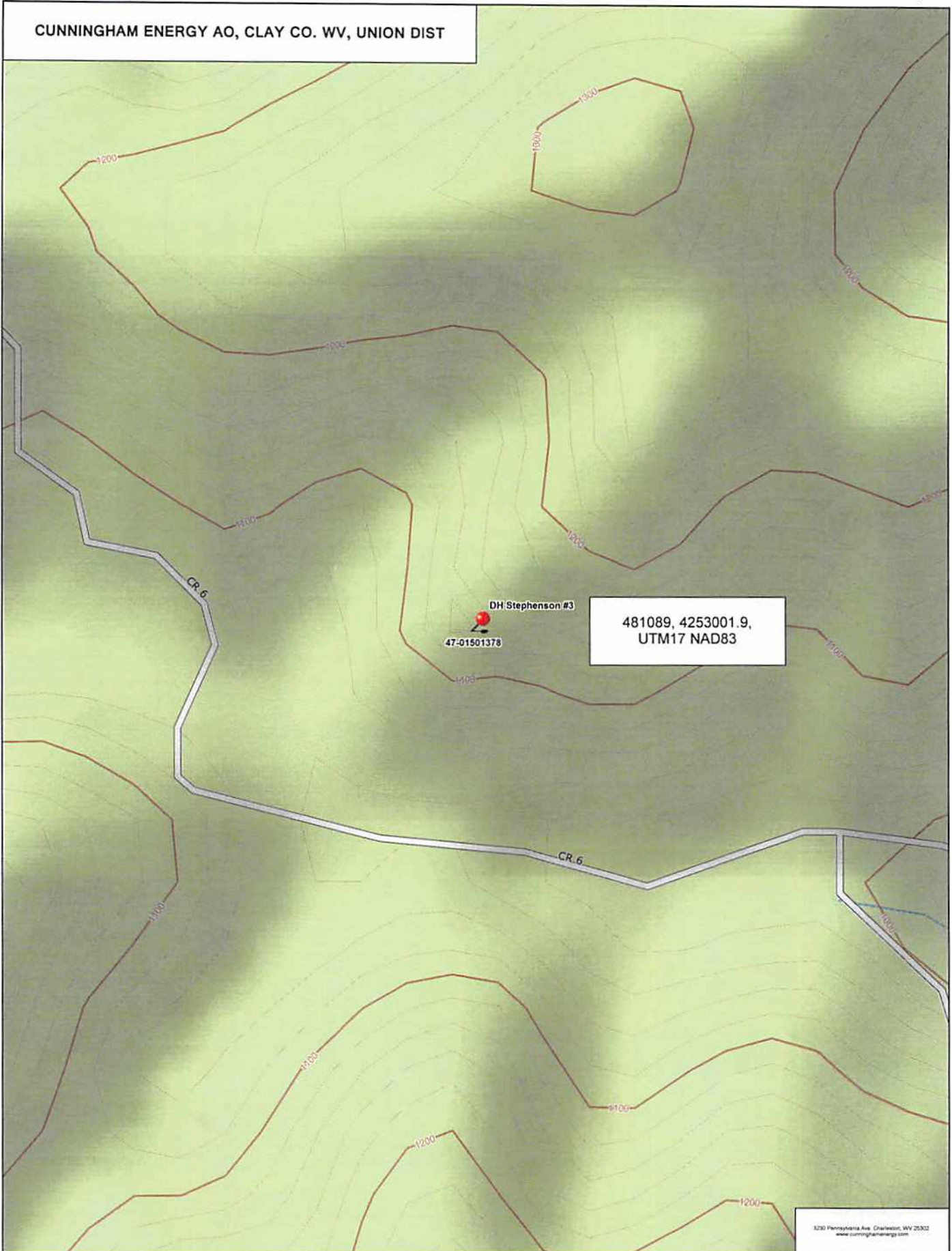

3250 Pennsylvania Ave. Charleston, WV 25302
www.cunninghamenergy.com

Data use subject to license.

© DeLorme. XMap® 7.
www.delorme.com

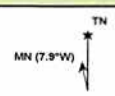

Scale 1 : 3,600

