

1500551 P

WW-7
8-30-06



West Virginia Department of Environmental Protection
Office of Oil and Gas
WELL LOCATION FORM: GPS

API: 47-015-00551 WELL NO.: WV 412441 Shadle #108

FARM NAME: Shadle

RESPONSIBLE PARTY NAME: EQT Production Company

COUNTY: Clay DISTRICT: Henry

QUADRANGLE: Elkhurst 7.5'

SURFACE OWNER: Kenneth and Carol Ward

ROYALTY OWNER: H. E. Shadle, et al

UTM GPS NORTHING: 4256486

UTM GPS EASTING: 488418 GPS ELEVATION: 346 m (1135 ft)

The Responsible Party named above has chosen to submit GPS coordinates in lieu of preparing a new well location plat for a plugging permit or assigned API number on the above well. The Office of Oil and Gas will not accept GPS coordinates that do not meet the following requirements:

1. Datum: NAD 1983, Zone: 17 North, Coordinate Units: meters, Altitude: height above mean sea level (MSL) – meters.
2. Accuracy to Datum – 3.05 meters
3. Data Collection Method:

Survey grade GPS : Post Processed Differential
Real-Time Differential

Mapping Grade GPS X: Post Processed Differential X
Real-Time Differential

4. Letter size copy of the topography map showing the well location.

I the undersigned, hereby certify this data is correct to the best of my knowledge and belief and shows all the information required by law and the regulations issued and prescribed by the Office of Oil and Gas.

Ben Styler
Signature

P.S. 2092
Title

4-19-13
Date

RECEIVED
Office of Oil & Gas

West Virginia Department of Environmental Protection

05/17/2013

Topo Quad: Elkhurst 7.5'

Scale: 1" = 2000'

County: Clay

Date: April 18, 2013

District: Henry

Project No: 53-05-00-07

47-015-00551 (WV 412441) Shadle #108

Topo

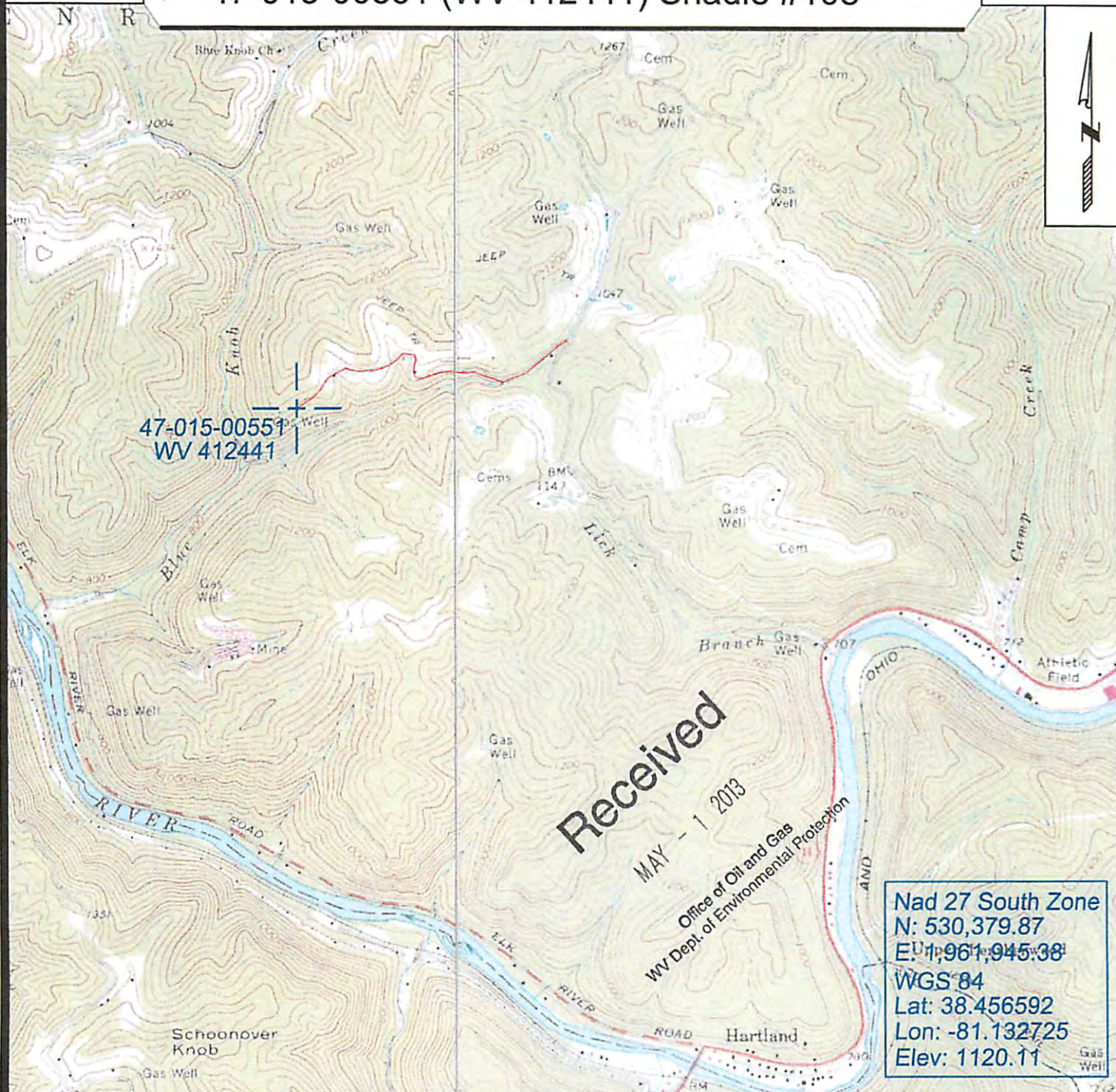

SURVEYING AND MAPPING SERVICES PERFORMED BY:
ALLEGHENY SURVEYS, INC.

1-800-482-8606
 P.O. BOX 438
 BIRCH RIVER, WV 26610
 PH: (304) 649-8606
 FAX: (304) 649-8608

PREPARED FOR:

EQT Production Company

P.O. Box 280
 Bridgeport, WV 26330

05/17/2013