

LATITUDE 38°55'00"

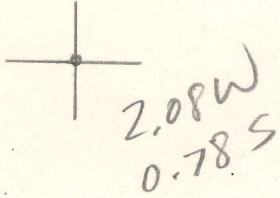

LONGITUDE 81°01'18"

7'5 OGIS topo location

7.5' loc _____

15' loc _____
(calc.) _____

Company _____

Farm _____

Quad Annamasiah 7 1/2'

County Calhoun

District Lee

WELL LOCATION MAP

File No. 013-574

Plot of the proposed location of all No. _____ of the _____
 _____ of _____ WVA _____ on the _____
 _____ Farm, consisting of _____ acres located in _____
 District _____ County.

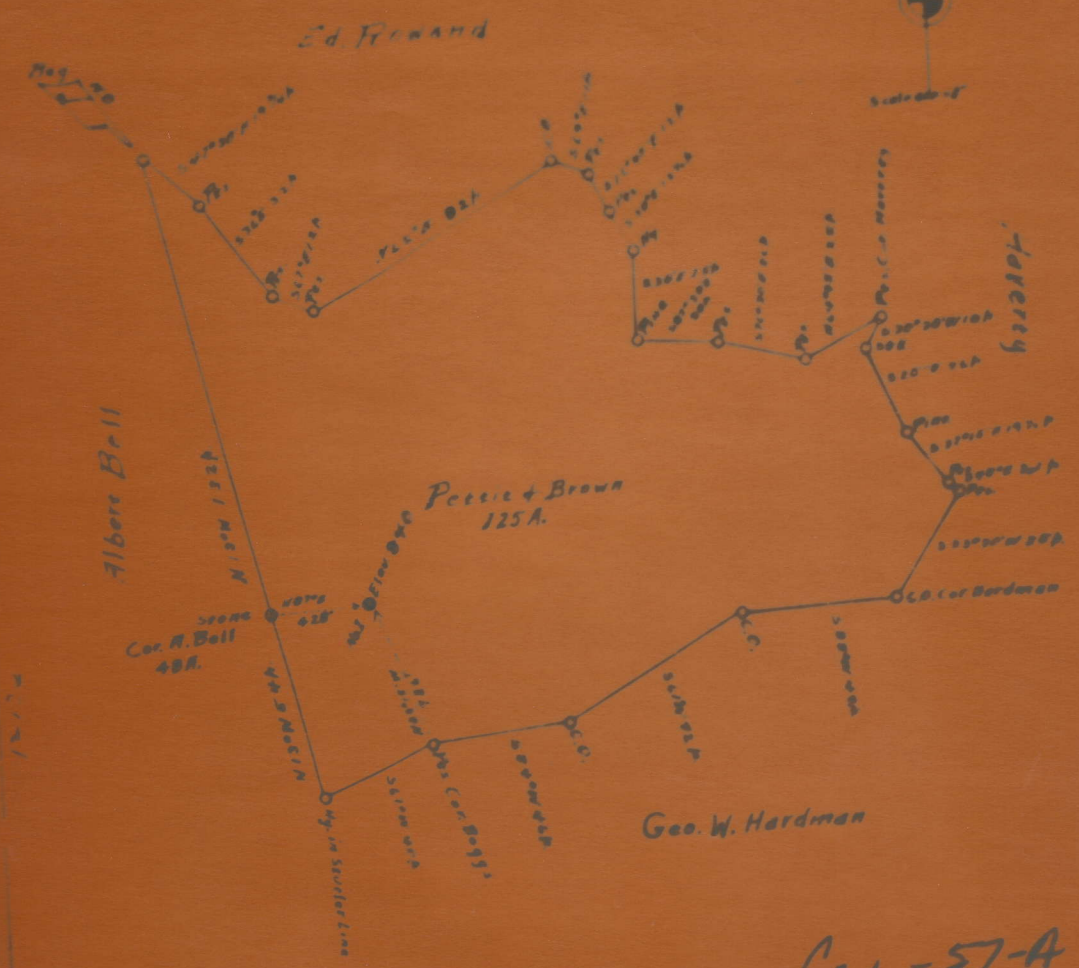

CAL-57-A

ENGINEER'S CERTIFICATE.

I, the undersigned, hereby certify that this map is correct and shows all the information to the best of my knowledge and belief, required by the oil and gas section of the Mining Law of West Virginia.

[Signature]

FETTIT & BROWN NO. 1.

Cal-57-A.

By Mrs. M. W. Crowley.

NO LOCATION

Lee Dist.