

RECEIVED  
FILE COPY  
AUG 10 1984



1) Date: August 6, 19 84  
 2) Operator's Well No. C. Connolly #6  
 3) API Well No. 47 - 013- 3785  
 State County Permit

OIL & GAS DIVISION STATE OF WEST VIRGINIA  
 DEPT. OF MINES DEPARTMENT OF MINES, OIL AND GAS DIVISION  
 APPLICATION FOR A WELL WORK PERMIT

- 4) WELL TYPE: A Oil  / Gas \_\_\_\_\_ /  
 B (If "Gas", Production \_\_\_\_\_ / Underground storage \_\_\_\_\_ / Deep \_\_\_\_\_ / Shallow \_\_\_\_\_ /)
- 5) LOCATION: Elevation: 857.21' Watershed: Steel Run LKW 13  
 District: Lee County: Calhoun Quadrangle: Arnoldsburg 7.5'
- 6) WELL OPERATOR Pennzoil Company 7) DESIGNATED AGENT James A. Crews  
 Address P.O. Box 1588 Address P.O. Box 1588  
 Parkersburg, WV 26102 Parkersburg, WV 26102
- 8) OIL & GAS INSPECTOR TO BE NOTIFIED 9) DRILLING CONTRACTOR:  
 Name Deo Mace Name \_\_\_\_\_  
 Address Route #1 - Box 5 Address \_\_\_\_\_  
 Sandridge, WV 25274
- 10) PROPOSED WELL WORK: Drill  / Drill deeper \_\_\_\_\_ / Redrill \_\_\_\_\_ / Stimulate  /  
 Plug off old formation \_\_\_\_\_ / Perforate new formation \_\_\_\_\_ /  
 Other physical change in well (specify) \_\_\_\_\_
- 11) GEOLOGICAL TARGET FORMATION, Berea  
 12) Estimated depth of completed well, 2405 feet  
 13) Approximate strata depths: Fresh, \_\_\_\_\_ feet; salt, \_\_\_\_\_ feet.  
 14) Approximate coal seam depths: \_\_\_\_\_ Is coal being mined in the area? Yes \_\_\_\_\_ / No  /

15) CASING AND TUBING PROGRAM

| CASING OR TUBING TYPE | SPECIFICATIONS |       |                |     |      | FOOTAGE INTERVALS |              | CEMENT FILL-UP OR SACKS (Cubic feet) | PACKERS       |
|-----------------------|----------------|-------|----------------|-----|------|-------------------|--------------|--------------------------------------|---------------|
|                       | Size           | Grade | Weight per ft. | New | Used | For drilling      | Left in well |                                      |               |
| Conductor             |                |       |                |     |      |                   |              |                                      | Kinds         |
| Fresh water           | 7              |       | 17             |     | X    | 460               | 460          | Cement to surface                    | NEAT          |
| Coal                  |                |       |                |     |      |                   |              |                                      | Sizes         |
| Intermediate          |                |       |                |     |      |                   |              |                                      |               |
| Production            | 4-1/2          | K55   | 9.5            | X   |      | 2436              | 2436         | 140 sks.                             | Depths set    |
| Tubing                |                |       |                |     |      |                   |              | as req. by rule 15.01                | Perforations: |
| Liners                |                |       |                |     |      |                   |              |                                      | Top Bottom    |

OFFICE USE ONLY  
 DRILLING PERMIT

Permit number 47-013-3785 Date September 19, 19 84

This permit covering the well operator and well location shown below is evidence of permission granted to drill in accordance with the pertinent legal requirements subject to the conditions contained herein and on the reverse hereof. **Notification must be given to the District Oil and Gas Inspector, (Refer to No. 8) Prior to the construction of roads, locations and pits for any permitted work.** In addition, the well operator or his contractor shall notify the proper district oil and gas inspector 24 hours before actual permitted work has commenced.)

The permitted work is as described in the Notice and Application, plat, and reclamation plan, subject to any modifications and conditions specified on the reverse hereof.

Permit expires September 19, 1986 unless well work is commenced prior to that date and prosecuted with due diligence.

|             |          |          |            |            |
|-------------|----------|----------|------------|------------|
| Bond: 112 ✓ | Agent: ✓ | Plat: MH | Casing: MH | Fee: 17788 |
|-------------|----------|----------|------------|------------|

Margaret J. Rasse  
 Administrator, Office of Oil and Gas

NOTE: Keep one copy of this permit posted at the drilling location.





RECEIVED  
AUG 10 1984

OFFICE USE ONLY

PERMIT MODIFICATIONS AND CONDITIONS (IF ANY) TO THE PROPOSED WELL WORK

1) DATE: \_\_\_\_\_

2) OPERATOR'S WELL NO.: \_\_\_\_\_

3) API WELL NO.: \_\_\_\_\_

4) LOCATION: DISTRICT: \_\_\_\_\_ COUNTY: \_\_\_\_\_ QUADRANGLE: \_\_\_\_\_

5) WELL OPERATOR: \_\_\_\_\_ ADDRESS: \_\_\_\_\_

6) OIL & GAS INSPECTOR TO BE NOTIFIED: \_\_\_\_\_ NAME: \_\_\_\_\_ ADDRESS: \_\_\_\_\_

7) DESIGNATED AGENT: \_\_\_\_\_ ADDRESS: \_\_\_\_\_

8) DRILLING CONTRACTOR: \_\_\_\_\_ NAME: \_\_\_\_\_ ADDRESS: \_\_\_\_\_

9) PROPOSED WELL WORK: DRILL:  DEEPEN:  REDELL:  PERFORATE NEW FORMATION:  OTHER PHYSICAL CHANGE IN WELL (SPECIFY): \_\_\_\_\_

10) APPROXIMATE COAL SEAM DEPTH: \_\_\_\_\_

11) APPROXIMATE TANK DEPTH: \_\_\_\_\_

12) ESTIMATED DEPTH OF COMPLETED WELL: \_\_\_\_\_

13) GEOLOGICAL TARGET FORMATION: \_\_\_\_\_

14) IS COAL BEING MINED IN THE AREA? YES  NO

OFFICE USE ONLY

This part of Form IV-2(b) is to record the dates of certain occurrences and any follow-up inspections.

|                                    | Date | Date(s) |
|------------------------------------|------|---------|
| Application received               |      |         |
| Well work started                  |      |         |
| Completion of the drilling process |      |         |
| Well Record received               |      |         |
| Reclamation completed              |      |         |

OTHER INSPECTIONS

Reason: \_\_\_\_\_

Reason: \_\_\_\_\_

|                                     |                                     |                                     |                                     |
|-------------------------------------|-------------------------------------|-------------------------------------|-------------------------------------|
| Agent                               | Plan                                | Casing                              | Fee                                 |
| <input checked="" type="checkbox"/> | <input checked="" type="checkbox"/> | <input checked="" type="checkbox"/> | <input checked="" type="checkbox"/> |

10/06/2023



1) Date: August 6, 19 84  
2) Operator's  
Well No. C. Connolly #6  
3) API Well No. 47-013-3785  
State County Permit

STATE OF WEST VIRGINIA  
DEPARTMENT OF MINES, OFFICE OF OIL & GAS  
NOTICE OF APPLICATION FOR A WELL WORK PERMIT

4) SURFACE OWNER(S) OF RECORD TO BE SERVED  
(i) Name Randall Connolly  
Address 2701 Grand Central Avenue  
Vienna, West Virginia 26105  
(ii) Name \_\_\_\_\_  
Address \_\_\_\_\_  
(iii) Name \_\_\_\_\_  
Address \_\_\_\_\_

5(i) COAL OPERATOR No Commercial Coal  
Address \_\_\_\_\_  
5(ii) COAL OWNER(S) WITH DECLARATION ON RECORD:  
Name \_\_\_\_\_  
Address \_\_\_\_\_  
Name \_\_\_\_\_  
Address \_\_\_\_\_  
5(iii) COAL LESSEE WITH DECLARATION ON RECORD:  
Name \_\_\_\_\_  
Address \_\_\_\_\_

TO THE PERSON(S) NAMED ABOVE: You should have received this Form and the following documents:  
(1) The Application for a Well Work Permit on Form IV-2(B) (or Form IV-4 if the well is to be plugged, which sets out the parties involved in the drilling or other work, and describes the well and its location and, if applicable, the proposed casing and cementing program;  
(2) The plat (surveyor's map) showing the well location on Form IV-6; and  
(3) The Construction and Reclamation Plan on Form IV-9 (unless the well work is only to plug a well), which sets out the plan for erosion and sediment control and for reclamation for the site and access road.

THE REASON YOU RECEIVED THESE DOCUMENTS IS THAT YOU HAVE RIGHTS REGARDING THE APPLICATION WHICH ARE SUMMARIZED IN THE "INSTRUCTIONS" ON THE REVERSE SIDE OF THE COPY OF THE APPLICATION (FORM IV-2(B) OR FORM 4, DESIGNATED FOR YOU. HOWEVER, YOU ARE NOT REQUIRED TO TAKE ANY ACTION AT ALL.

Take notice that under Chapter 22 of the West Virginia Code, the undersigned well operator proposes to file or has filed this Notice and Application and accompanying documents for a Well Work Permit with the Administrator of the Office of Oil and Gas, West Virginia Department of Mines, with respect to a well at the location described on attached Application and depicted on attached Form IV-6. Copies of this Notice, the Application, the plat, and the Construction and Reclamation Plan have been mailed by registered or certified mail or delivered by hand to the person(s) named above (or by publication in certain circumstances) on or before the day of mailing or delivery to the Administrator.

6) EXTRACTION RIGHTS  
Check and provide one of the following:  
 Included is the lease or leases or other continuing contract or contracts by which I hold the right to extract oil or gas. on file  
 The requirement of Code 22-4-1-(c) (1) through (4). (See reverse side for specifics.)  
7) ROYALTY PROVISIONS  
Is the right to extract, produce or market the oil or gas based upon a lease or leases or other contract or contracts providing for flat well royalty or any similar provision for compensation to the owner of the oil or gas in place which is not inherently related to the volume of oil or gas so extracted, produced or marketed? Yes  No   
If the answer above is No, nothing additional is needed. If the answer is Yes, you may use Affidavit Form IV-60.

RECEIVED  
AUG 10 1984  
OIL & GAS DIVISION  
DEPT. OF MINES

See the reverse side for line item instructions, and for instructions concerning the required copies of the Notice and Application, plat, and Construction and Reclamation Plan.

The truth of the information on the Notice and Application is verified and sworn to and the Notice is signed on behalf of the Well Operator in my County and State by  
Curtis A. Lucas  
this 6 day of August, 1984.  
My commission expires Oct. 24, 1989.  
Joyce M. Board  
Notary Public, Wood County,  
State of W. Va.

WELL OPERATOR Pennzoil Company  
By Curtis A. Lucas  
Its Supervisor, Surveying & Mapping  
Address P. O. Box 1588  
Parkersburg, West Virginia 26102  
Telephone 422-6565

10/06/2023

I N S T R U C T I O N S T O A P P L I C A N T

CONCERNING THE LINE ITEMS:

- 1) Date of Notice.
- 2) Your well name and number.
- 3) To be filled out by the Office of Oil & Gas.
- 4) & 5) Use separate sheet if necessary.
- 4) Surface owner(s) of record to be served with Notice and Application. However, see also Code § 22-4-1b(b) if "more than three tenants in common or other co-owners of interest described in subsection (a) of this section hold interests in such lands".
- 5(i) "Coal Operator" means any person, firm, partnership, partnership association or corporation that proposes to or does operate a coal mine.
- 5(ii, iii) See Code § 22-4-20.
- 6) See Code § 22-4-11(c). However, in lieu of filing the lease(s) or other continuing contract(s), the Applicant may fill out the information in the space provided below.
- 7) See Code § § 22-4-11(d, e).

CONCERNING THE REQUIRED COPIES FOR FILING AND SERVICE:

Filing. Code § 22-4-1k and Regulation 7.02 provide that the original and required copies of the Notice and Application must be filed with the Administrator, accompanied by (i) a plat in the form prescribed by Regulation 11, (ii) a bond in one of the forms prescribed by Regulation 12, or in lieu thereof the other security allowed by Code § 22-4-1k(d) and the reclamation required by Code § 22-4-12b and Regulation 23, (iv) unless previously paid on the same well, the fees required by Code § 22-4-1a(c) and 22-3-12a, and (v) if applicable, the consent required by Code § 22-4-8a from the owner of any water well on dwelling within 200 feet of the proposed well.

Service. In addition, service must be made on the surface owner(s) and the person(s) with an interest in the coal. See Code § § 22-4-1m, 22-4-2, 22-4-2a, and 22-4-2b.

---

INFORMATION SUPPLIED UNDER CODE § 22-4-11(d)

IN LIEU OF FILING LEASE(S) AND OTHER CONTINUING CONTRACT(S)

Under the oath required to make the verification on the obverse side of this Notice, I depose and say that I am the person who signed the Notice for the Applicant, and that--

- (1) the tract of land is the same tract described in the Application to which this Notice applies, partly or wholly depicted in the accompanying plat, and described in the Construction and Reclamation Plan;
- (2) the parties and recordation data (if recorded) for lease(s) or other continuing contract(s) by which the Applicant claims the right to extract, produce or market the oil or gas are as follows:

\_\_\_\_\_  
Grantor, lessor, etc.

\_\_\_\_\_  
Grantee, lessee, etc.

\_\_\_\_\_  
Royalty

\_\_\_\_\_  
Book Page





1) Date: March 29, 19 85  
 2) Operator's Well No. C. Connolly, No. 6-Rev  
 3) API Well No. 47 013 3785Rev  
 State County Permit

STATE OF WEST VIRGINIA  
 DEPARTMENT OF MINES, OIL AND GAS DIVISION  
APPLICATION FOR A WELL WORK PERMIT

- 4) WELL TYPE: A Oil  / Gas \_\_\_\_\_  
 B (If "Gas", Production \_\_\_\_\_ / Underground storage \_\_\_\_\_ / Deep \_\_\_\_\_ / Shallow \_\_\_\_\_)
- 5) LOCATION: Elevation: 899 Watershed: Steel Run  
 District: Lee County: Calhoun Quadrangle: Arnoldsburg 7.5
- 6) WELL OPERATOR Pennzoil Company 37450 7) DESIGNATED AGENT James A. Crews  
 Address P. O. Box 1588 Address P. O. Box 1588  
Parkersburg, W. Va. 26102 Parkersburg, W. Va.
- 8) OIL & GAS INSPECTOR TO BE NOTIFIED 9) DRILLING CONTRACTOR:  
 Name Deo Mace Name \_\_\_\_\_  
 Address Route 1, Box 5 Address \_\_\_\_\_  
Sandridge, W. Va. 25274
- 10) PROPOSED WELL WORK: Drill  / Drill deeper \_\_\_\_\_ / Redrill \_\_\_\_\_ / Stimulate   
 Plug off old formation \_\_\_\_\_ / Perforate new formation \_\_\_\_\_  
 Other physical change in well (specify) \_\_\_\_\_
- 11) GEOLOGICAL TARGET FORMATION, Berea  
 12) Estimated depth of completed well, 2510 feet  
 13) Approximate strata depths: Fresh, \_\_\_\_\_ feet; salt, \_\_\_\_\_ feet.  
 14) Approximate coal seam depths: \_\_\_\_\_ Is coal being mined in the area? Yes \_\_\_\_\_ / No
- 15) CASING AND TUBING PROGRAM

RECEIVED  
 APR - 2 1985  
 OIL & GAS DIVISION  
 DEPT. OF MINES

| CASING OR TUBING TYPE | SPECIFICATIONS |       |                |     |      | FOOTAGE INTERVALS |              | CEMENT FILL-UP OR SACKS (Cubic feet) | PACKERS       |
|-----------------------|----------------|-------|----------------|-----|------|-------------------|--------------|--------------------------------------|---------------|
|                       | Size           | Grade | Weight per ft. | New | Used | For drilling      | Left in well |                                      |               |
| Conductor             |                |       |                |     |      |                   |              |                                      | Kinds         |
| Fresh water           | 8-5/8          | H40   | 23             | X   |      | 480               | 480          | Cement to surface                    | NEAT          |
| Coal                  |                |       |                |     |      |                   |              |                                      | Sizes         |
| Intermediate          |                |       |                |     |      |                   |              |                                      | Depths set    |
| Production            | 4-1/2          | K55   | 9.5            | X   |      | 2510              | 2510         | 180 sks.                             |               |
| Tubing                |                |       |                |     |      |                   |              |                                      | Perforations: |
| Liners                |                |       |                |     |      |                   |              |                                      | Top Bottom    |

OFFICE USE ONLY  
 DRILLING PERMIT

Permit number 47-013-3785Rev Date April 23 19 85

This permit covering the well operator and well location shown below is evidence of permission granted to drill in accordance with the pertinent legal requirements subject to the conditions contained herein and on the reverse hereof. **Notification must be given to the District Oil and Gas Inspector, (Refer to No. 8) Prior to the construction of roads, locations and pits for any permitted work.** In addition, the well operator or his contractor shall notify the proper district oil and gas inspector 24 hours before actual permitted work has commenced.)

The permitted work is as described in the Notice and Application, plat, and reclamation plan, subject to any modifications and conditions specified on the reverse hereof.  
 Permit expires April 23 1987 unless well work is commenced prior to that date and prosecuted with due diligence.

|       |        |         |        |       |
|-------|--------|---------|--------|-------|
| Bond: | Agent: | Plat:   | Casing | Fee   |
| 112   | SW     | MMH MMH |        | 19566 |

*Margaret J. Hass*  
 Administrator, Office of Oil and Gas

NOTE: Keep one copy of this permit posted at the drilling location.

See the reverse side of the APPLICANT'S COPY for instructions to the well operator.

10/06/2023



OFFICE USE ONLY

PERMIT MODIFICATIONS AND CONDITIONS (IF ANY) TO THE PROPOSED WELL WORK

RECEIVED  
APR 2 1987

| PROJECT | DATE | DESCRIPTION         | APPROVED | REMARKS |
|---------|------|---------------------|----------|---------|
| 180     | 4/20 | Cemented to surface | X        |         |
| 180     | 4/20 | 130 sks.            | X        |         |

OFFICE USE ONLY

This part of Form IV-2(b) is to record the dates of certain occurrences and any follow-up inspections.

|                                    | Date | Date(s) |
|------------------------------------|------|---------|
| Application received               |      |         |
| Well work started                  |      |         |
| Completion of the drilling process |      |         |
| Well Record received               |      |         |
| Reclamation completed              |      |         |

OTHER INSPECTIONS

Reason: \_\_\_\_\_  
Reason: \_\_\_\_\_

10/06/2023



1) Date: March 29, 19 85  
 2) Operator's  
 Well No. C. Connolly No. 6-Rev.  
 3) API Well No. 47 013 3784-REV  
 State County Permit

STATE OF WEST VIRGINIA  
 DEPARTMENT OF MINES, OFFICE OF OIL & GAS  
 NOTICE OF APPLICATION FOR A WELL WORK PERMIT

4) SURFACE OWNER(S) OF RECORD TO BE SERVED

(i) Name Randall Connolly  
 Address 2701 Grand Central Avenue  
Vienna, West Virginia 26105  
 (ii) Name \_\_\_\_\_  
 Address \_\_\_\_\_  
 (iii) Name \_\_\_\_\_  
 Address \_\_\_\_\_

5(i) COAL OPERATOR No Commercial Coal  
 Address \_\_\_\_\_

5(ii) COAL OWNER(S) WITH DECLARATION ON RECORD:  
 Name \_\_\_\_\_  
 Address \_\_\_\_\_

Name \_\_\_\_\_  
 Address \_\_\_\_\_

5(iii) COAL LESSEE WITH DECLARATION ON RECORD:  
 Name \_\_\_\_\_  
 Address \_\_\_\_\_

P 153 643 567

RECEIPT FOR CERTIFIED MAIL

NO INSURANCE COVERAGE PROVIDED  
 NOT FOR INTERNATIONAL MAIL  
 (See Reverse)

|   |                                  |
|---|----------------------------------|
| Sent to   | <u>Randall Connolly</u>          |
| Street and No.  | <u>2701 Grand Central Avenue</u> |
| P.O., State and ZIP Code                                      | <u>Vienna, W. Va. 26105</u>      |
| Postage   | \$ _____                         |
| Certified Fee   | _____                            |
| Special Delivery Fee  | _____                            |
| Restricted Delivery Fee                                       | _____                            |
| Return Receipt Showing to whom and Date Delivered             | X                                |
| Return receipt showing to whom, Date, and Address of Delivery | _____                            |
| TOTAL Postage and Fees  | \$ _____                         |
| Postmark or Date  | <u>MAR 29 1985</u>               |

Documents:  
 the well is  
 or work,  
 casing and

is only to  
 for

APPLICATION  
 APPLICATION  
 ANY

well op-  
 documents  
 Virginia  
 application  
 at, and the  
 or delivered  
 or

OIL & GAS DIVISION  
 DEPT. OF MINES

APR - 2 1985

RECEIVED

Check and provide one of the following:

- Included is the lease or leases or other continuing contract or contracts, by which I hold the right to extract oil or gas. Lease on File: Richardson Unit Exhibit "B"
- The requirement of Code 22-4-1-(c) (1) through (4). (See reverse side for specifics.)

7) ROYALTY PROVISIONS

Is the right to extract, produce or market the oil or gas based upon a lease or leases or other contract or contracts providing for flat well royalty or any similar provision for compensation to the owner of the oil or gas in place which is not inherently related to the volume of oil or gas so extracted, produced or marketed? Yes  No

If the answer above is No, nothing additional is needed. If the answer is Yes, you may use Affidavit Form IV-60.

Affidavit on File: \_\_\_\_\_

See the reverse side for line item instructions, and for instructions concerning the required copies of the Notice and Application, plat, and Construction and Reclamation Plan.

The truth of the information on the Notice and Application is verified and sworn to and the Notice is signed on behalf of the Well Operator in my County and State by

Curtis A. Lucas  
 this 29 day of March, 19 85.  
 My commission expires Oct. 24, 19 89.

Joyce M. Board  
 Notary Public, Wood County,  
 State of W. Va.

WELL  
 OPERATOR Pennzoil Company

By Curtis A. Lucas  
 Its Supervisor, Surveying & Mapping  
 Address P. O. Box 1588  
Parkersburg, West Virginia 26102  
 Telephone 422-6565

10/06/2023



I N S T R U C T I O N S T O A P P L I C A N T

CONCERNING THE LINE ITEMS:

- 1) Date of Notice.
- 2) Your well name and number.
- 3) To be filled out by the Office of Oil & Gas.
- 4) & 5) Use separate sheet if necessary.
- 4) Surface owner(s) of record to be served with Notice and Application. However, see also Code § 22-4-1b(b) if "more than three tenants in common or other co-owners of interest described in subsection (a) of this section hold interests in such lands".
- 5(i) "Coal Operator" means any person, firm, partnership, partnership association or corporation that proposes to or does operate a coal mine.
- 5(ii, iii) See Code § 22-4-20.
- 6) See Code § 22-4-11(c). However, in lieu of filing the lease(s) or other continuing contract(s), the Applicant may fill out the information in the space provided below.
- 7) See Code § 22-4-11(d, e).

CONCERNING THE REQUIRED COPIES FOR FILING AND SERVICE:

Filing. Code § 22-4-1k and Regulation 7.02 provide that the original and required copies of the Notice and Application must be filed with the Administrator, accompanied by (i) a plat in the form prescribed by Regulation 11, (ii) a bond in one of the forms prescribed by Regulation 12, or in lieu thereof the other security allowed by Code § 22-4-1k(d) and the reclamation required by Code § 22-4-12b and Regulation 23, (iv) unless previously paid on the same well, the fees required by Code § 22-4-1a(c) and 22-3-12a, and (v) if applicable, the consent required by Code § 22-4-8a from the owner of any water well on dwelling within 200 feet of the proposed well.

Service. In addition, service must be made on the surface owner(s) and the person(s) with an interest in the coal. See Code § 22-4-1m, 22-4-2, 22-4-2a, and 22-4-2b.

---

INFORMATION SUPPLIED UNDER CODE § 22-4-11(d)

IN LIEU OF FILING LEASE(S) AND OTHER CONTINUING CONTRACT(S)

Under the oath required to make the verification on the obverse side of this Notice, I depose and say that I am the person who signed the Notice for the Applicant, and that--

- (1) the tract of land is the same tract described in the Application to which this Notice applies, partly or wholly depicted in the accompanying plat, and described in the Construction and Reclamation Plan;
- (2) the parties and recordation data (if recorded) for lease(s) or other continuing contract(s) by which the Applicant claims the right to extract, produce or market the oil or gas are as follows:

|                       |                       |         |           |
|-----------------------|-----------------------|---------|-----------|
| Grantor, lessor, etc. | Grantee, lessee, etc. | Royalty | Book Page |
|-----------------------|-----------------------|---------|-----------|





DATE: August 6, 1984  
OPERATOR'S  
WELL NO.: C. Connolly, #6  
API NO: 47 - -  
State County Permi

State of West Virginia

OFFICE OF OIL AND GAS  
DEPARTMENT OF MINES

A F F I D A V I T

State of W. Va.  
County of Wood

I, James A. Crews (the designated owner or operator, or authorized representative thereof), after being duly sworn, do depose and say that the undersigned is authorized by the owner of the working interest in the well permit application to which this affidavit is attached do state that (he, she, or it) shall tender to the owner of the oil and gas in place not less than one-eighth of the total amount paid to or received by or allowed to the owner of the working interest at the wellhead for the oil or gas so extracted, produced, or marketed before deducting the amount to be paid or set aside for the owner of the oil or gas in place, or all such oil or gas to be extracted, produced, or marketed from the well. West Virginia Code 22-4-11(e) (1982).

Signed: James A. Crews

Taken, Subscribed, and sworn to before me this 6 day of August, 1984.

Notary: Curtis A. Lucas

My Commission Expires: July 2, 1990

**RECEIVED**  
AUG 10 1984  
OIL & GAS DIVISION  
DEPT. OF MINES





IV-9  
(Rev 8-81)

DATE 7/30/84  
WELL NO. C. CONNOLLY #6  
API NO. 47 - 013 - 3785

State of West Virginia  
Department of Mines  
Oil and Gas Division

CONSTRUCTION AND RECLAMATION PLAN

COMPANY NAME PENNZOIL COMPANY DESIGNATED AGENT JAMES A. CREWS  
Address P.O. Box 1588, Parkersburg, WV Address Box 1588, Parkersburg, W.V.  
Telephone 422-6565 Telephone 422-6565  
LANDOWNER CONNOLLY HAS - RANDALL CONNOLLY A.G.T. SOIL CONS. DISTRICT LITTLE KANAWHA  
Revegetation to be carried out by HALLS RECLAMATION INC. (Agent)

This plan has been reviewed by Little Kanawha SCD. All corrections and additions become a part of this plan: 7-31-84  
(Date)

Garrett Newton  
(SCD Agent)

| ACCESS ROAD                     | LOCATION                             |
|---------------------------------|--------------------------------------|
| Structure <u>ROADSIDE DITCH</u> | (A) Structure <u>DIVERSION DITCH</u> |
| Spacing <u>SEE SKETCH</u>       | Material <u>EARTHEN</u>              |
| Page Ref. Manual <u>2-12</u>    | Page Ref. Manual <u>2-12</u>         |
| Structure <u>CULVERT 12"</u>    | (B) Structure _____                  |
| Spacing <u>SEE SKETCH</u>       | Material _____                       |
| Page Ref. Manual <u>2-7</u>     | Page Ref. Manual _____               |
| Structure <u>CULVERT 20"</u>    | (C) Structure _____                  |
| Spacing <u>SEE SKETCH</u>       | Material _____                       |
| Page Ref. Manual <u>2-7</u>     | Page Ref. Manual _____               |

RECEIVED  
AUG 10 1984  
OIL & GAS DIVISION  
DEPT. OF MINES

All structures should be inspected regularly and repaired if necessary. All commercial timber is to be cut and stacked and all brush and small timber to be cut and removed from the site before dirt work begins.

REVEGETATION

| Treatment Area I   | Treatment Area II  |
|--|--|
| Lime _____ Tons/acre<br>or correct to pH <u>6.5</u>        | Lime _____ Tons/acre<br>or correct to pH <u>6.5</u>        |
| Fertilizer <u>500</u> lbs/acre<br>(10-20-20 or equivalent) | Fertilizer <u>500</u> lbs/acre<br>(10-20-20 or equivalent) |
| Mulch <u>STRAW</u> <u>2</u> Tons/acre                      | Mulch <u>STRAW</u> <u>2</u> Tons/acre                      |
| Seed* <u>KY 31 FESCUE</u> <u>35</u> lbs/acre               | Seed* <u>KY 31 FESCUE</u> <u>35</u> lbs/acre               |
| <u>PERENNIAL RYEGRASS</u> <u>15</u> lbs/acre               | <u>PERENNIAL RYEGRASS</u> <u>15</u> lbs/acre               |
| <u>ALSIKE CLOVER</u> <u>5</u> lbs/acre                     | <u>ALSIKE CLOVER</u> <u>10/06/2023</u> lbs/acre            |

\*Inoculate all legumes such as vetch, trefoil and clovers with the proper bacterium. Inoculate with 3X recommended amount.

NOTES: Please request landowners' cooperation to protect new seedling for one growing season. Attach separate sheets as necessary for comments.

PLAN PREPARED BY Curtis A. Lucas  
ADDRESS P.O. Box 1588  
Parkersburg, W.V.  
PHONE NO. 422-6565



ATTACH OR PHOTOCOPY SECTION OF  
INVOLVED TOPOGRAPHIC MAP,  
QUADRANGLE ARNOLDSBURG 7 1/2'

| LEGEND      |   |
|-------------|---|
| Well Site   | ⊕ |
| Access Road | — |

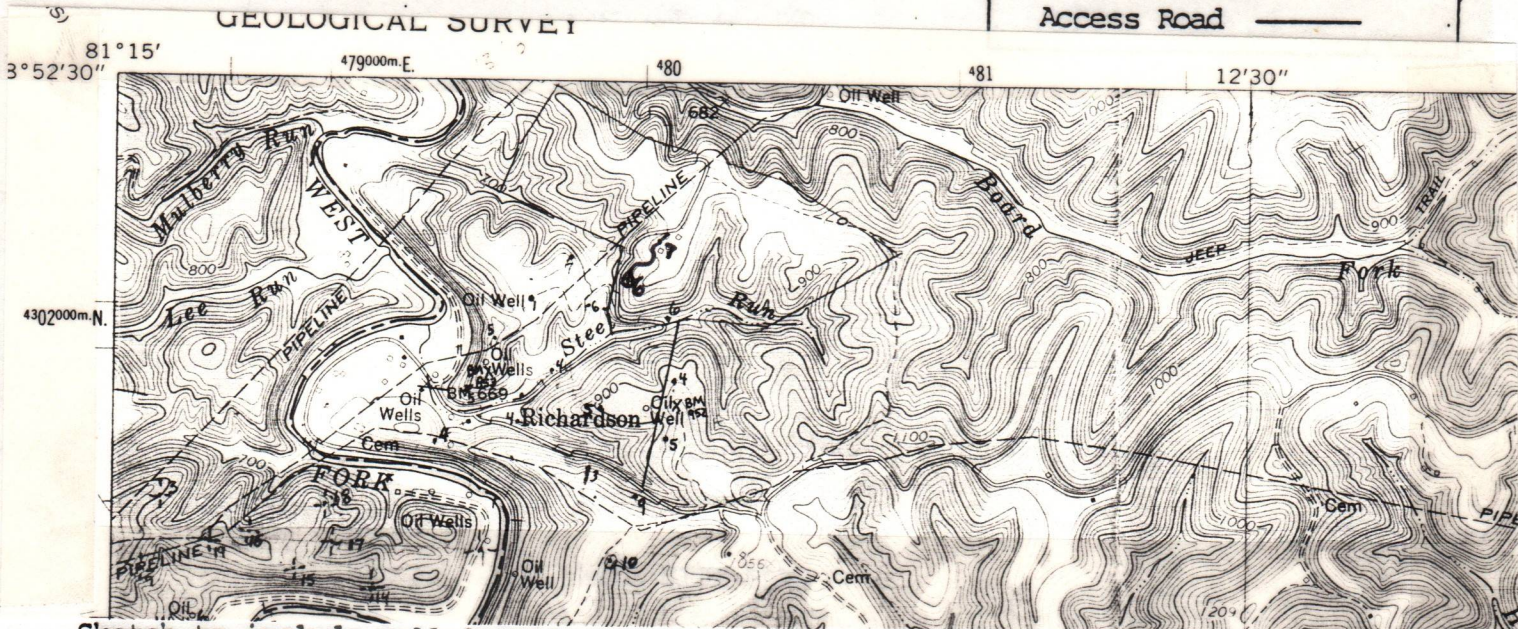

Sketch to include well location, existing access road, roads to be constructed, well site drilling pits and necessary structures numbered or lettered to correspond with the first part of this plan. Include all natural drainage.

| LEGEND            |                                 |
|-------------------|---------------------------------|
| Property boundary | — — — — —                       |
| Road              | == == == == ==                  |
| Existing fence    | — X — X —                       |
| Planned fence     | — / — / —                       |
| Stream            | ~ ~ ~ ~ ~                       |
| Open ditch        | — · · · · — · · · · — · · · · — |
| Diversion         | //// //// //// ////             |
| Spring            | ⊕ →                             |
| Wet spot          | ⊕                               |
| Building          | ■                               |
| Drain pipe        | — ○ — ○ — ○ — →                 |
| Waterway          | ← == == == == →                 |

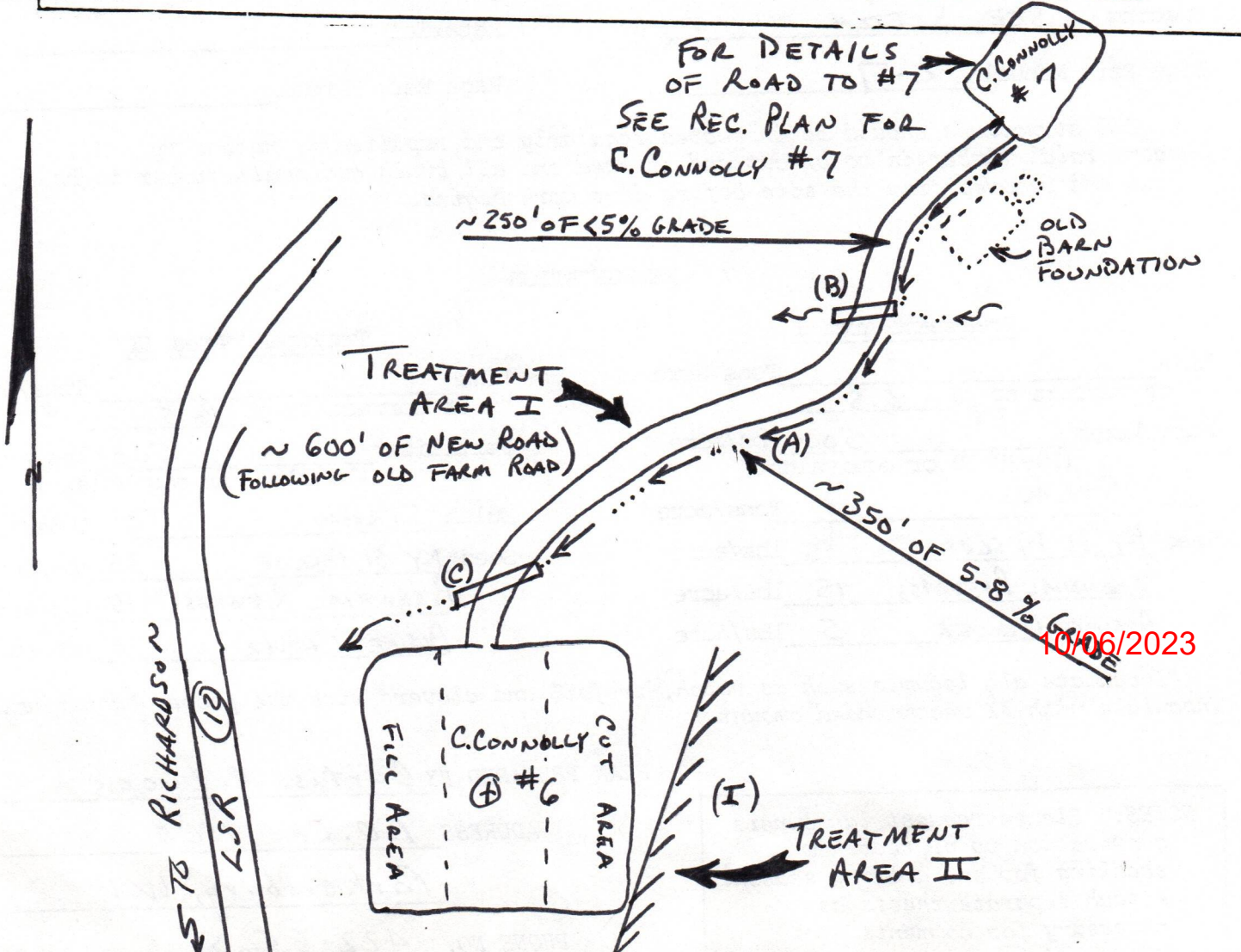





RECEIVED

IV-9 (Rev 8-81)

APR - 2 1985

State of West Virginia Department of Mines Oil and Gas Division

DATE 3/25/85 WELL NO. C. Connolly #6 REV. REV. API NO. 47 - 013 - 3785-A

OIL & GAS DIVISION DEPT. OF MINES

CONSTRUCTION AND RECLAMATION PLAN

COMPANY NAME PENNZOIL COMPANY DESIGNATED AGENT JAMES A. CREWS Address P.O. Box 1588, Parkersburg, WV Telephone 422-6565 LANDOWNER RANDALL CONNOLLY SOIL CONS. DISTRICT LITTLE KANAWHA

Revegetation to be carried out by CONTRACTOR (Agent) This plan has been reviewed by Little Kanawha SCD. All corrections and additions become a part of this plan: 3/26/85 (Date) Randall L. Atkinson (SCD Agent)

field review

Table with columns: ACCESS ROAD, LOCATION, Structure, Spacing, Page Ref. Manual. Rows include ROADSIDE DITCH, CULVERT 18" I.D., and empty rows.

All structures should be inspected regularly and repaired if necessary. All commercial timber is to be cut and stacked and all brush and small timber to be cut and removed from the site before dirt work begins.

REVEGETATION

Table with columns: Treatment Area I, Treatment Area II. Rows include Lime, Fertilizer, Mulch, and Seed\* with specific quantities and types.

\*Inoculate all legumes such as vetch, trefoil and clovers with the proper bacterium. Inoculate with 3X recommended amount.

NOTES: Please request landowners' cooperation to protect new seedling for one growing season. Attach separate sheets as necessary for comments.

PLAN PREPARED BY Curtis A. Lucas ADDRESS P.O. Box 1588 Parkersburg, W.V. PHONE NO. 422-6565



ATTACH OR PHOTOCOPY SECTION OF INVOLVED TOPOGRAPHIC MAP. QUADRANGLE ARNOLDSBURT 7 1/2

**LEGEND**



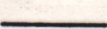

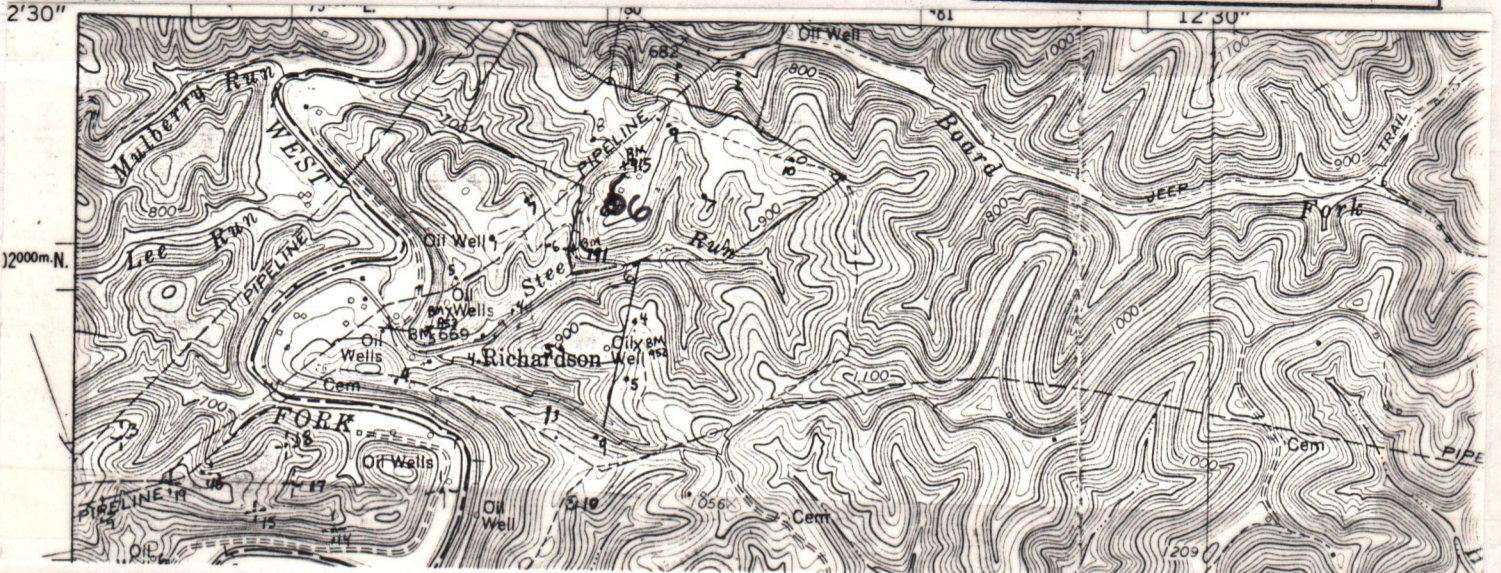

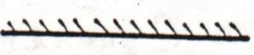

Well Site 

Access Road 



Sketch to include well location, existing access road, roads to be constructed, wellsite, drilling pits and necessary structures numbered or lettered to correspond with the first part of this plan. Include all natural drainage.

**LEGEND**

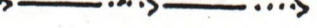
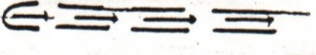
|   |  |
|---|--|
| Property boundary  | Diversion   |
| Road               | Spring      |
| Existing fence     | Wet spot    |
| Planned fence      | Building    |
| Stream             | Drain pipe  |
| Open ditch         | Waterway    |

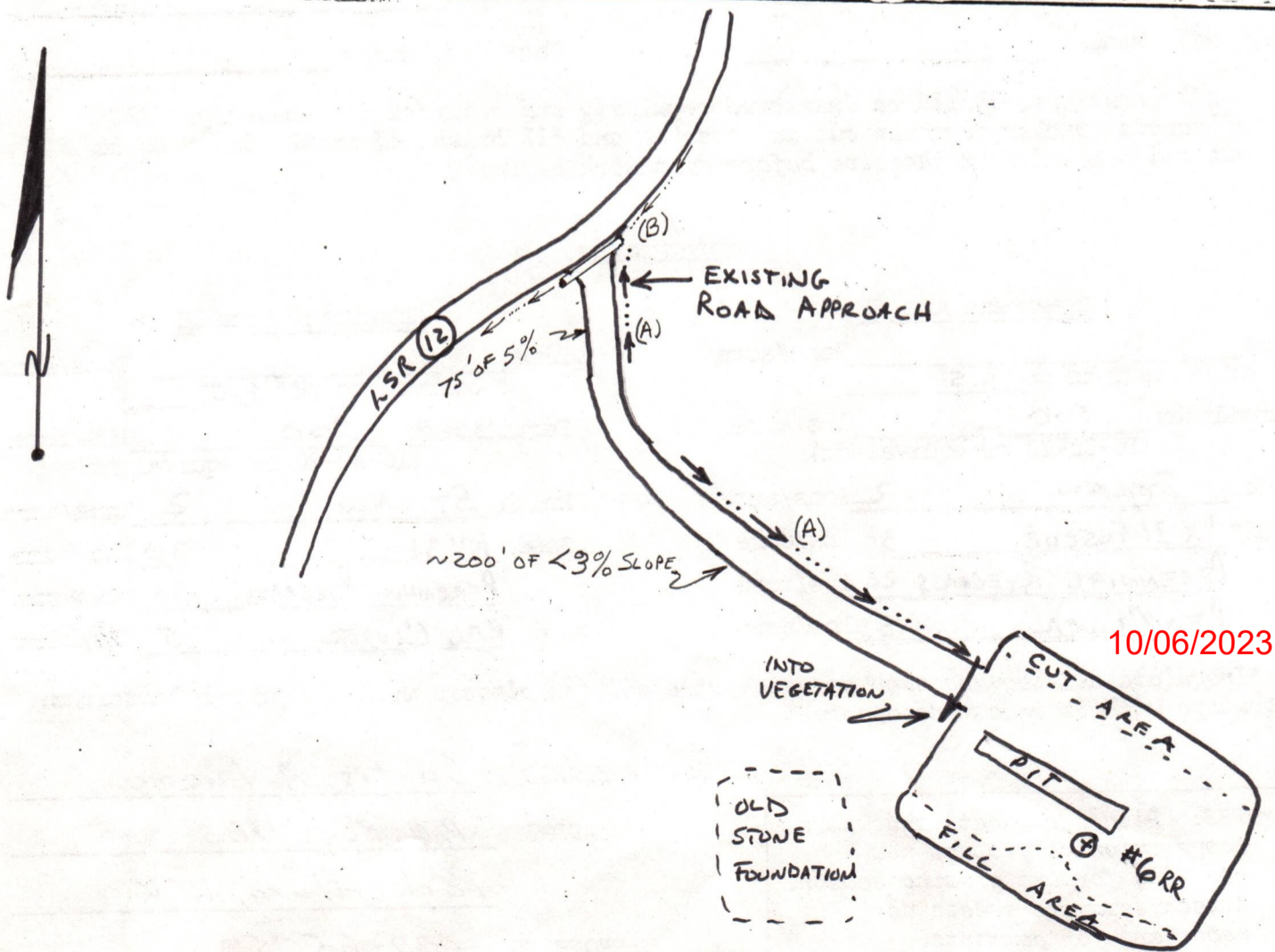



P 528 469 502

**RECEIPT FOR CERTIFIED MAIL**

NO INSURANCE COVERAGE PROVIDED  
NOT FOR INTERNATIONAL MAIL

(See Reverse)

★ U.S.G.P.O. 1983-403-517

PS Form 3800, Feb. 1982

|  |        |
|--|--------|
| Sent to<br>Randall Connolly                                      |        |
| Street and No.<br>2701 Grand Central Ave.                        |        |
| P.O., State and ZIP Code<br>Vienna, WV 26105                     |        |
| Postage  | \$     |
| Certified Fee  |        |
| Special Delivery Fee   |        |
| Restricted Delivery Fee  |        |
| Return Receipt Showing<br>to whom and Date Delivered             | X      |
| Return receipt showing to whom,<br>Date, and Address of Delivery |        |
| TOTAL Postage and Fees   | \$2.06 |
| Postmark or Date<br>19   |        |

**RECEIVED**  
AUG 10 1984

OIL & GAS DIVISION  
DEPT. OF MINES



RECEIVED  
WR-15 NOV 5 - 1985



DIVISION OF OIL & GAS  
DEPT. OF ENERGY

State of West Virginia  
DEPARTMENT OF ENERGY  
Oil and Gas Division

Date October 31, 1985  
Operator's Well No. 6  
Farm C. Connolly  
API No. 47 - 013 - 3785-Rev

WELL OPERATOR'S REPORT  
OF  
DRILLING, FRACTURING AND/OR STIMULATING, OR PHYSICAL CHANGE

WELL TYPE: Oil X / Gas \_\_\_ / Liquid Injection \_\_\_ / Waste Disposal \_\_\_ /  
(If "Gas," Production \_\_\_ / Underground Storage \_\_\_ / Deep \_\_\_ / Shallow \_\_\_ /)

LOCATION: Elevation: 899 Watershed Steel Run  
District: Spencer County Roane Quadrangle Arnoldsburg 7.5'

COMPANY Pennzoil Company

ADDRESS P.O. Box 1588, Parkersburg, WV 26102

DESIGNATED AGENT James A. Crews

ADDRESS P.O. Box 1588, Parkersburg, WV 26102

SURFACE OWNER Randall Connolly, Aqt.

ADDRESS 2701 Grand Central Ave., Vienna, WV 26105

MINERAL RIGHTS OWNER Same as Above

ADDRESS \_\_\_\_\_

OIL AND GAS INSPECTOR FOR THIS WORK Homer

Dougherty ADDRESS Linden Rt., Box 3-A

PERMIT ISSUED 4-23-85 Looneyville, WV

DRILLING COMMENCED 6-8-85

DRILLING COMPLETED 6-12-85

IF APPLICABLE: PLUGGING OF DRY HOLE ON CONTINUOUS PROGRESSION FROM DRILLING OR REWORKING. VERBAL PERMISSION OBTAINED ON \_\_\_\_\_

| Casing & Tubing  | Used in Drilling | Left in Well | Cement fill up Cu. ft. |
|------------------|------------------|--------------|------------------------|
| Size 20-16 Cond. |                  |              |                        |
| 13-10"           |                  |              |                        |
| 9 5/8            |                  |              |                        |
| 8 5/8            | 492              | 492          | 225 sks                |
| 7                |                  |              |                        |
| 5 1/2            |                  |              |                        |
| 4 1/2            | 2508             | 2508         | 120 sks                |
| 3                |                  |              |                        |
| 2                |                  |              |                        |
| Liners used      |                  |              |                        |

GEOLOGICAL TARGET FORMATION Berea Depth 2432 feet

Depth of completed well 2525 feet Rotary X / Cable Tools \_\_\_\_\_

Water strata depth: Fresh 432 feet; Salt 1695 feet

Coal seam depths: \_\_\_\_\_ Is coal being mined in the area? No

OPEN FLOW DATA

Producing formation Berea Pay zone depth 2430 feet

Gas: Initial open flow 0 Mcf/d Oil: Initial open flow 0 Bbl/d

Final open flow 2 Mcf/d Final open flow 2 Bbl/d

Time of open flow between initial and final tests \_\_\_\_\_ hours

Static rock pressure 80 psig (surface measurement) after \_\_\_\_\_ hours shut in

(If applicable due to multiple completion--)

Second producing formation \_\_\_\_\_ Pay zone depth \_\_\_\_\_ feet

Gas: Initial open flow \_\_\_\_\_ Mcf/d Oil: Initial open flow 10/06/2023 Bbl/d

Final open flow \_\_\_\_\_ Mcf/d Oil: Final open flow \_\_\_\_\_ Bbl/d

Time of open flow between initial and final tests \_\_\_\_\_ hours

Static rock pressure \_\_\_\_\_ psig (surface measurement) after \_\_\_\_\_ hours shut in

(Continue on reverse side.)



DETAILS OF PERFORATED INTERVALS, FRACTURING OR STIMULATING, PHYSICAL CHANGE, ETC.

Fractured: 7-31-85

Berea w/250 gls. acid; 134 BGW, 2000# 20/40 sd

Perforated: 2430-2433; 2440-2447/14H

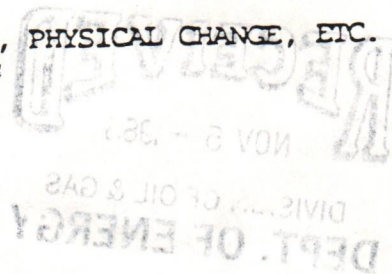

WELL LOG

| FORMATION         | COLOR | HARD OR SOFT | TOP FEET | BOTTOM FEET | REMARKS   |
|-------------------|-------|--------------|----------|-------------|---|
|                   |       |              |          |             | Including indication of all fresh and salt water, coal, oil and gas |
| Clay              |       |              | 0        | 60          |   |
| Sand              |       |              | 60       | 95          |   |
| Silt              |       |              | 95       | 104         |   |
| Sand, Silt        |       |              | 104      | 866         |   |
| Shale             |       |              | 866      | 907         |   |
| Silt              |       |              | 907      | 920         |   |
| Shale, Sand, Silt |       |              | 920      | 1695        |   |
| Salt Sand         |       |              | 1695     | 1794        |   |
| Shale             |       |              | 1794     | 1872        |   |
| Little Lime       |       |              | 1872     | 1899        |   |
| Pencil Cave       |       |              | 1899     | 1921        |   |
| Big Lime          |       |              | 1921     | 2053        |   |
| Big Injun         |       |              | 2053     | 2074        |   |
| Pocono Shale      |       |              | 2074     | 2418        |   |
| Coffee Shale      |       |              | 2418     | 2432        |   |
| Berea             |       |              | 2432     | 2456        |   |
| Shale             |       |              | 2456     | 2525        |   |
| Total Depth       |       |              |          | 2525        |   |

(Attach separate sheets as necessary)

Pennzoil Company  
Well Operator

By: Curtis A. Luman

Date: 11-1-85

10/06/2023

Note: Regulation 2.02(i) provides as follows:  
"The term 'log' or 'well log' shall mean a systematic detailed geological record of all formations, including coal, encountered in the drilling of a well."



Date: November 20, 1985

Operator's Well No. C. Connolly No. 6

API Well No. 47 - 013 - 3785  
State County Permit

STATE OF WEST VIRGINIA  
DEPARTMENT OF ENERGY  
OIL AND GAS DIVISION

WELL OPERATOR'S REPORT  
OF  
INITIAL GAS-OIL RATIO TEST

WELL OPERATOR Pennzoil Company  
Address P.O. Box 1588  
Parkersburg, W.Va. 26102

DESIGNATED AGENT James A. Crews  
Address P.O. Box 1588  
Parkersburg, W.Va. 26102

GEOLOGICAL TARGET FORMATION: Berea Depth 2425-2450 feet  
Perforation Interval 2430-2447 feet

GUIDELINES FOR TESTING:

- 1- A minimum of gas vented or flared
- 2- A 24 hour preflow into pipelines or tanks
- 3- Uniform producing rate during the 24 hour test per test period
- 4- Measurement standards as for Form IV-39, "Report of Annual Production" (see Regulation 21.01)
- 5- Separate Form IV-36 for each producing formation in a multiple completion

| TEST DATA  |   |                                    |   |                                    |
|--|---|------------------------------------|---|------------------------------------|
| START OF TEST-DATE<br><u>8-17-85</u>   | TIME<br><u>8:00 A.M.</u>  | END OF TEST-DATE<br><u>8-18-85</u> | TIME<br><u>8:00 A.M.</u>  | DURATION OF TEST<br><u>24 hrs.</u> |
| TUBING PRESSURE  | CASING PRESSURE   | SEPARATOR PRESSURE                 | SEPARATOR TEMPERATURE   |                                    |
| OIL PRODUCTION DURING TEST<br><u>0</u> bbls.   | GAS PRODUCTION DURING TEST<br><u>2.4</u> Mcf                          |                                    | WATER PRODUCTION DURING TEST & SALINITY<br><u>0</u> bbls. <u>psm.</u>                               |                                    |
| OIL GRAVITY  | PRODUCING METHOD (Flowing, pumping, gas lift, etc.)<br><u>pumping</u> |                                    |   |                                    |
| GAS PRODUCTION   |   |                                    |   |                                    |
| MEASUREMENT METHOD<br>FLANGE TAP <input checked="" type="checkbox"/> PIPE TAP <input type="checkbox"/> L-10 <input type="checkbox"/> |   |                                    | POSITIVE CHOKE <input checked="" type="checkbox"/><br>CRITICAL FLOW PROVER <input type="checkbox"/> |                                    |
| ORIFICE DIAMETER<br><u>1/4</u>   | PIPE DIAMETER (INSIDE DIAM.)<br><u>2</u>                              |                                    | NOMINAL CHOKE SIZE - IN.  |                                    |
| DIFFERENTIAL PRESSURE RANGE  | MAX. STATIC PRESSURE RANGE  |                                    | PROVER & ORIFICE DIAM. - IN.  |                                    |
| DIFFERENTIAL   | STATIC  |                                    | GAS GRAVITY (Air=1.0)<br>MEASURED ESTIMATED <input checked="" type="checkbox"/>                     |                                    |
| GAS GRAVITY (Air=1.0)<br><u>1.32</u>   | FLOWING TEMPERATURE<br><u>78°</u>                                     |                                    | GAS TEMPERATURE _____ °F  |                                    |
| 24 HOUR COEFFICIENT.   |   |                                    | 24 HOUR COEFFICIENT   |                                    |
| PRESSURE - _____ psia  |   |                                    |   |                                    |
| TEST RESULTS   |   |                                    |   |                                    |
| DAILY OIL<br><u>0</u> bbls.  | DAILY WATER<br><u>0</u> bbls.   | DAILY GAS<br><u>2.4</u> Mcf.       | GAS-OIL RATIO<br>SCF/STB  |                                    |

Pennzoil Company  
Well Operator  
By: Curtis A. Crews  
Its: Supervisor, Surveying and Mapping

10/06/2023



STATE OF WEST VIRGINIA  
DEPARTMENT OF MINES  
OIL AND GAS WELLS DIVISION

RECEIVED  
DEPARTMENT OF ENERGY  
OIL AND GAS

JAN 14 1986

INSPECTOR'S WELL REPORT

Permit No. 13-3785 (4-23-85)

Oil or Gas Well \_\_\_\_\_  
(KIND)

| Company _____<br>Address _____<br>Farm _____<br>Well No. _____<br>District _____ County _____<br>Drilling commenced _____<br>Drilling completed _____ Total depth _____<br>Date shot _____ Depth of shot _____<br>Initial open flow _____ /10ths Water in _____ Inch<br>Open flow after tubing _____ /10ths Merc. in _____ Inch<br>Volume _____ Cu. Ft.<br>Rock pressure _____ lbs. _____ hrs.<br>Oil _____ bbls., 1st 24 hrs.<br>Fresh water _____ feet _____ feet<br>Salt water _____ feet _____ feet | CASING AND TUBING | USED IN DRILLING | LEFT IN WELL | PACKERS                               |
|---|-------------------|------------------|--------------|---------------------------------------|
|   | Size              |                  |              | Kind of Packer                        |
|   | 16                |                  |              |                                       |
|   | 13                |                  |              |                                       |
|   | 10                |                  |              | Size of                               |
|   | 8 1/4             |                  |              |                                       |
|   | 6 5/8             |                  |              | Depth set                             |
|   | 5 3/16            |                  |              |                                       |
|   | 3                 |                  |              | Perf. top                             |
|   | 2                 |                  |              | Perf. bottom                          |
| Liners Used _____   |                   |                  |              | Perf. top _____<br>Perf. bottom _____ |

Drillers' Names \_\_\_\_\_

Remarks: Release reclamation

1-9-86  
DATE

W. W. Mason 10/06/2023  
DISTRICT WELL INSPECTOR



Form 26  
2/16/82

STATE OF WEST VIRGINIA  
DEPARTMENT OF MINES  
OIL AND GAS WELLS DIVISION  
INSPECTOR'S PLUGGING REPORT

Permit No. \_\_\_\_\_ Well No. \_\_\_\_\_

COMPANY \_\_\_\_\_ ADDRESS \_\_\_\_\_

FARM \_\_\_\_\_ DISTRICT \_\_\_\_\_ COUNTY \_\_\_\_\_

Filling Material Used \_\_\_\_\_

| Liner                       |           | Location |                       | Amount | Packer    | Location          |      |  |
|-----------------------------|-----------|----------|-----------------------|--------|-----------|-------------------|------|--|
| PLUGS USED AND DEPTH PLACED |           |          | BRIDGES               |        |           | CASING AND TUBING |      |  |
| CEMENT-THICKNESS            | WOOD-SIZE | LEAD     | CONSTRUCTION-LOCATION |        | RECOVERED | SIZE              | LOST |  |
|                             |           |          |                       |        |           |                   |      |  |
|                             |           |          |                       |        |           |                   |      |  |
|                             |           |          |                       |        |           |                   |      |  |
|                             |           |          |                       |        |           |                   |      |  |
|                             |           |          |                       |        |           |                   |      |  |
|                             |           |          |                       |        |           |                   |      |  |
|                             |           |          |                       |        |           |                   |      |  |
|                             |           |          |                       |        |           |                   |      |  |
|                             |           |          |                       |        |           |                   |      |  |
|                             |           |          |                       |        |           |                   |      |  |
|                             |           |          |                       |        |           |                   |      |  |
|                             |           |          |                       |        |           |                   |      |  |
|                             |           |          |                       |        |           |                   |      |  |
|                             |           |          |                       |        |           |                   |      |  |
|                             |           |          |                       |        |           |                   |      |  |
|                             |           |          |                       |        |           |                   |      |  |
|                             |           |          |                       |        |           |                   |      |  |
|                             |           |          |                       |        |           |                   |      |  |
|                             |           |          |                       |        |           |                   |      |  |
|                             |           |          |                       |        |           |                   |      |  |

Drillers' Names \_\_\_\_\_

Remarks: \_\_\_\_\_

\_\_\_\_\_  
DATE I hereby certify I visited the above well on this date.

**10/06/2023**  
DISTRICT WELL INSPECTOR



1772 4-17-85

LATITUDE 38° 52' 30"

1,825'

7 1/2 TOPO

NORTH

LONGITUDE 81° 12' 30"

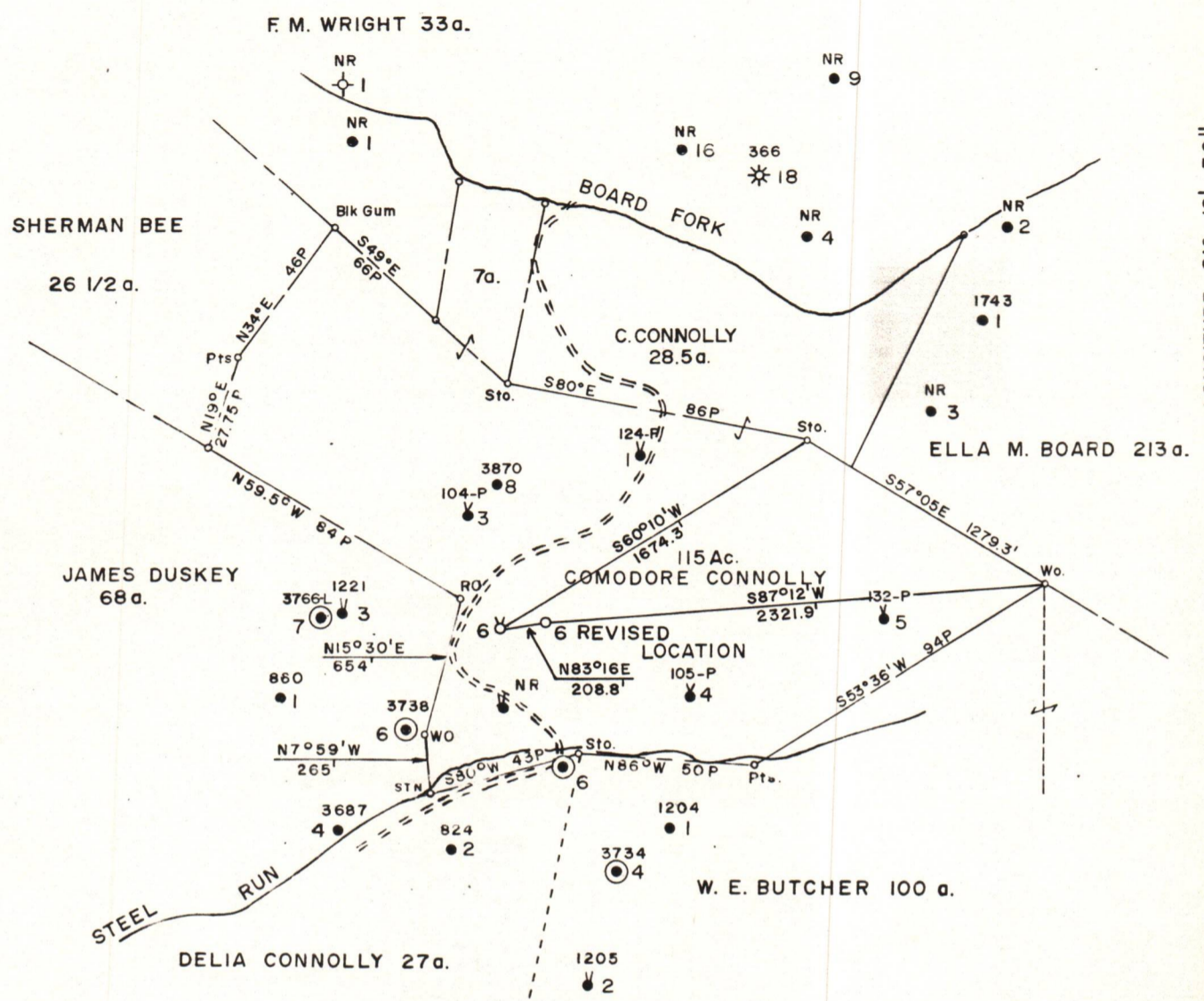

LOCATION REFERENCES  
 S73°23'W 106.7' 14" POPLAR  
 N45°20'W 120.2' 10" ASH

FILE NO. 1735  
 MAP 42 SQS S39 W35  
 SCALE 1"=800'  
 MINIMUM DEGREE OF ACCURACY 1 in 200  
 PROVEN SOURCE OF ELEVATION C. CONNOLLY NO. 8  
ELEV. 897'

I, THE UNDERSIGNED, HEREBY CERTIFY THAT THIS PLAT IS CORRECT TO THE BEST OF MY KNOWLEDGE AND BELIEF AND SHOWS ALL THE INFORMATION REQUIRED BY LAW AND THE REGULATIONS ISSUED AND PRESCRIBED BY THE DEPARTMENT OF MINES.  
 (SIGNED) Curtis A. Lucas  
 CURTIS A. LUCAS LLS 275

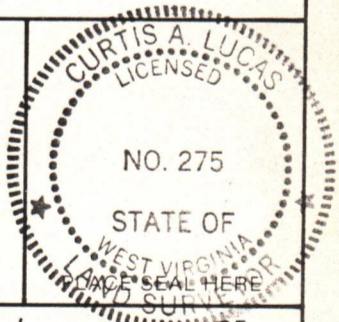

STATE OF WEST VIRGINIA  
 DEPARTMENT OF MINES  
 OIL AND GAS DIVISION



DATE APRIL 1, 1985  
 FARM C. CONNOLLY NO. 6-R  
 API WELL NO.

47 - 013 - 3785-R  
 STATE COUNTY PERMIT

(+) DENOTES LOCATION OF WELL ON UNITED STATES TOPOGRAPHIC MAPS  
 WELL TYPE: OIL  GAS  LIQUID INJECTION  WASTE DISPOSAL   
 (IF "GAS.") PRODUCTION  STORAGE  DEEP  SHALLOW   
 LOCATION: ELEVATION 899' WATER SHED STEEL RUN  
 DISTRICT LEE COUNTY CALHOUN  
 QUADRANGLE ARNOLDSBURG 7 1/2

SURFACE OWNER RANDALL CONNOLLY AGENT ACREAGE 151.5  
 OIL & GAS ROYALTY OWNER RANDALL CONNOLLY AGENT LEASE ACREAGE 151.5 **10/06/2023**  
 LEASE NO. 39870

PROPOSED WORK: DRILL  CONVERT  DRILL DEEPER  REDRILL  FRACTURE OR STIMULATE  PLUG OFF OLD FORMATION  PERFORATE NEW FORMATION  OTHER PHYSICAL CHANGE IN WELL (SPECIFY) \_\_\_\_\_

PLUG AND ABANDON  CLEAN OUT AND REPLUG   
 TARGET FORMATION BEREA ESTIMATED DEPTH 2,510'  
 WELL OPERATOR PENNZOIL COMPANY DESIGNATED AGENT JAMES A. CREWS  
 ADDRESS P.O. BOX 1588 ADDRESS P.O. BOX 1588  
PARKERSBURG, W.V. 26101 PARKERSBURG, W.V. 26101