



1) Date: April 25, 1984
 2) Operator's Well No. McCumber 1-A
 3) API Well No. 47 - 013 - 3741
 State County Permit

STATE OF WEST VIRGINIA
 DEPARTMENT OF MINES, OIL AND GAS DIVISION
 APPLICATION FOR A WELL WORK PERMIT

- 4) WELL TYPE: A Oil / Gas
 B (If "Gas", Production / Underground storage / Deep / Shallow)
- 5) LOCATION: Elevation: 1028 Watershed: Bear Run (LKW31C)
 District: Washington County: Calhoun Quadrangle: Millstone 7.5
- 6) WELL OPERATOR Franklin Adkins 7) DESIGNATED AGENT Franklin Adkins
 Address P. O. Box 68 Address P. O. Box 68
Ona, W. Va. 25545 Ona, W. Va. 25545
- 8) OIL & GAS INSPECTOR TO BE NOTIFIED 9) DRILLING CONTRACTOR:
 Name Deo Mace Name _____
 Address Route 1, Box 5 Address _____
Sandridge, W. V. 25274
- 10) PROPOSED WELL WORK: Drill / Drill deeper _____ / Redrill _____ / Stimulate _____
 Plug off old formation _____ / Perforate new formation _____
 Other physical change in well (specify) _____
- 11) GEOLOGICAL TARGET FORMATION, Injun Sand
- 12) Estimated depth of completed well, 2300 feet
 13) Approximate strata depths: Fresh, 50 feet; salt, _____ feet.
 14) Approximate coal seam depths: _____ Is coal being mined in the area? Yes No
- 15) CASING AND TUBING PROGRAM

RECEIVED
 MAY 30 1984
 OIL & GAS DIVISION
 DEPT. OF MINES

CASING OR TUBING TYPE	SPECIFICATIONS					FOOTAGE INTERVALS		CEMENT FILL-UP OR SACKS (Cubic feet)	PACKERS
	Size	Grade	Weight per ft.	New	Used	For drilling	Left in well		
Conductor									Kinds
Fresh water									
Coal									Sizes
Intermediate	8	H 40	20	x		250	250	100	CTS NEAT or as req. by rule 15.00
Production	4	J 55	10.5	x			2300	60	
Tubing	2	J 55	4.6	x			2300		
Liners									Perforations: Top Bottom

OFFICE USE ONLY
 DRILLING PERMIT

Permit number 47-013-3741 Date June 13, 19 84

This permit covering the well operator and well location shown below is evidence of permission granted to drill in accordance with the pertinent legal requirements subject to the conditions contained herein and on the reverse hereof. **Notification must be given to the District Oil and Gas Inspector, (Refer to No. 8) Prior to the construction of roads, locations and pits for any permitted work.** In addition, the well operator or his contractor shall notify the proper district oil and gas inspector 24 hours before actual permitted work has commenced.)

The permitted work is as described in the Notice and Application, plat, and reclamation plan, subject to any modifications and conditions specified on the reverse hereof.
 Permit expires June 13, 1986 unless well work is commenced prior to that date and prosecuted with due diligence.

Bond: BLANKET	Agent: <u>LOMH</u>	Plat: <u>MH</u>	Casing: <u>MH</u>	Fee: <u>1474</u>
----------------------	--------------------	-----------------	-------------------	------------------

[Signature]
 Administrator, Office of Oil and Gas

NOTE: Keep one copy of this permit posted at the drilling location.



OFFICE USE ONLY

PERMIT MODIFICATIONS AND CONDITIONS (IF ANY) TO THE PROPOSED WELL WORK

1) WELL LOCATION: District: WASHINGTON County: WASHINGTON

2) WELL OPERATOR: Name: F. O. BOX 5000 Address: WASHINGTON, W. V. 25200

3) DRILLING CONTRACTOR: Name: J. J. BOX 5000 Address: WASHINGTON, W. V. 25200

4) DESIGNATED AGENT: Name: F. O. BOX 5000 Address: WASHINGTON, W. V. 25200

5) PROPOSED WELL WORK: Drilling, completion, etc.

6) GEOLOGICAL TARGET FORMATION: [Blank]

7) ESTIMATED DEPTH OF COMPLETED WELL: [Blank]

8) APPROXIMATE UTD DEPTH: [Blank]

9) APPROXIMATE UTD DEPTH: [Blank]

10) CASING AND TUBING PROGRAM: [Blank]

RECEIVED
MAY 30 1984

DEPT. OF MINES
OIL & GAS DIVISION

OFFICE USE ONLY

This part of Form IV-2(b) is to record the dates of certain occurrences and any follow-up inspections.

Date	Date(s)
Application received	Follow-up inspection(s)
Well work started	" "
Completion of the drilling process	" "
Well Record received	" "
Reclamation completed	" "

OTHER INSPECTIONS

Reason: _____

Reason: _____

Board	Asst. Sec.	Blk.	Casing	Rec.
Blank	Blank	Blank	Blank	Blank

05/10/2024



DATE NOV. 29, 1983

WELL NO. McCUMBERS 1-A

API NO. 47-013-3741

State of West Virginia

Department of Mines
Oil and Gas Division

CONSTRUCTION AND RECLAMATION PLAN

COMPANY NAME FRANKLIN ADKINS

Address Box 68, ONA, W.V. 25545

Telephone 655-8973

LANDOWNER STEVE McCUMBERS

Revegetation to be carried out by FRANKLIN ADKINS (Agent)

DESIGNATED AGENT FRANKLIN ADKINS

Address Box 68, ONA, W.V. 25545

Telephone 655-8973

SOIL CONS. DISTRICT LITTLE KANAWHA

This plan has been reviewed by Little Kanawha SCD. All corrections

and additions become a part of this plan: 12-21-83

(Date)

Jarrett Newton
(SCD Agent)

ACCESS ROAD

LOCATION

Structure CULVERT (A)

Structure DIVERSION DITCH (1)

Spacing AS REQUIRED BY TABLE 4

Material EARTHEN

Page Ref. Manual 2.9 + 2-7

Page Ref. Manual 2-13

Structure DRAINAGE DITCH (B)

Structure RIPRAP

Spacing EARTHEN

Material ROCK

Page Ref. Manual 2.9 + 2-12

Page Ref. Manual 2.9

Structure RIPRAP (C)

Structure _____

Spacing ROCK

Material _____

Page Ref. Manual 2.9

Page Ref. Manual _____

All structures should be inspected regularly and repaired if necessary. All commercial timber is to be cut and stacked and all brush and small timber to be cut and removed from the site before dirt work begins.

REVEGETATION

Treatment Area I

Treatment Area II

Line _____ Tons/acre
or correct to pH 6.5

Line _____ Tons/acre

Fertilizer 600-800 lbs/acre
(10-20-20 or equivalent)

or correct to pH 6.5

Mulch HAY 2 Tons/acre

Fertilizer 600-800 lbs/acre
(10-20-20 or equivalent)

Seed* KY 31 40 lbs/acre

Mulch HAY 2 Tons/acre

LADINO CLOVER 5 lbs/acre

Seed* KY 31 40 lbs/acre

_____ lbs/acre

LADINO CLOVER 5 lbs/acre

_____ lbs/acre

*Inoculate all legumes such as vetch, trefoil and clovers with the proper bacterium. Inoculate with 3X recommended amount.

05/10/2024

PLAN PREPARED BY WALLACE BOARD LAND SURV

ADDRESS 343 MAIN ST

SPENCER, W.V. 25276

PHONE NO. 927-5730

NOTES: Please request landowners' cooperation to protect new seedling for one growing season. Attach separate sheets as necessary for comments.

ATTACH OR PHOTOCOPY SECTION OF
INVOLVED TOPOGRAPHIC MAP.
QUADRANGLE MILLSTONE & CHLOE 7.5'

LEGEND

Well Site ⊕

Access Road ———



WELL SITE PLAN

Sketch to include well location, existing access road, roads to be constructed, wellsite, drilling pits and necessary structures numbered or lettered to correspond with the first part of this plan. Include all natural drainage.

LEGEND

- | | |
|---------------------------|----------------------|
| Property boundary ———▲——— | Diversion ———/——— |
| Road = = = = = | Spring ⊕→ |
| Existing fence — x — x — | Wet spot ⊕ |
| Planned fence — / — / — | Building ■ |
| Stream ~ ~ ~ ~ ~ | Drain pipe — ○ — ○ — |
| Open ditch — ···· —· | Waterway ⊕ = = = = |

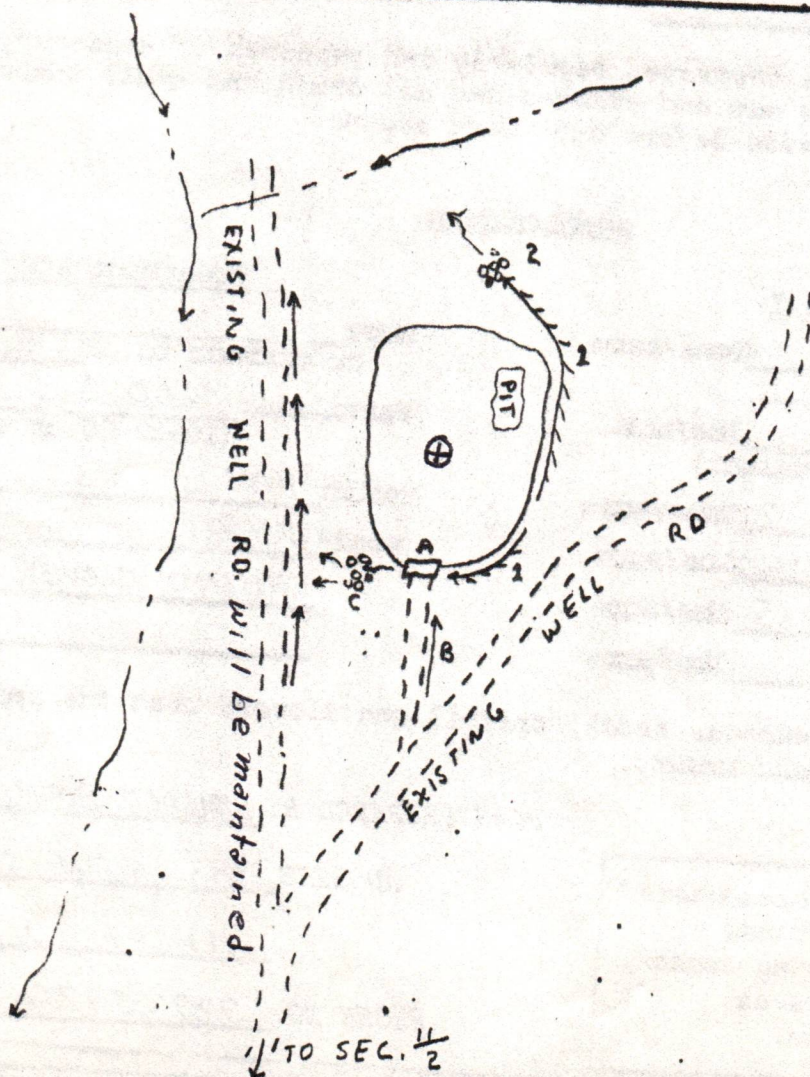

05/10/2024

1) Date: April 25, 1984
2) Operator's Well No. McCumber 1-A
3) API Well No. 47-013-374 State County Permit

STATE OF WEST VIRGINIA
DEPARTMENT OF MINES, OFFICE OF OIL & GAS
NOTICE OF APPLICATION FOR A WELL WORK PERMIT

- 4) SURFACE OWNER(S) OF RECORD TO BE SERVED
- (i) Name Steve McCumbers
Address Orma, W. Va.
 - (ii) Name _____
Address _____
 - (iii) Name _____
Address _____
- 5(i) COAL OPERATOR None
Address _____
- 5(ii) COAL OWNER(S) WITH DECLARATION ON RECORD:
Name Hunter Bennett
Address P.O. BOX 166
Weston, W. Va.
- Name _____
Address _____
- 5(iii) COAL LESSEE WITH DECLARATION ON RECORD:
Name None
Address _____

TO THE PERSON(S) NAMED ABOVE: You should have received this Form and the following documents:

- (1) The Application for a Well Work Permit on Form IV-2(B) (or Form IV-4 if the well is to be plugged, which sets out the parties involved in the drilling or other work, and describes the well and its location and, if applicable, the proposed casing and cementing program;
- (2) The plat (surveyor's map) showing the well location on Form IV-6; and
- (3) The Construction and Reclamation Plan on Form IV-9 (unless the well work is only to plug a well), which sets out the plan for erosion and sediment control and for reclamation for the site and access road.

THE REASON YOU RECEIVED THESE DOCUMENTS IS THAT YOU HAVE RIGHTS REGARDING THE APPLICATION WHICH ARE SUMMARIZED IN THE "INSTRUCTIONS" ON THE REVERSE SIDE OF THE COPY OF THE APPLICATION (FORM IV-2(B) OR FORM 4, DESIGNATED FOR YOU. HOWEVER, YOU ARE NOT REQUIRED TO TAKE ANY ACTION AT ALL.

Take notice that under Chapter 22 of the West Virginia Code, the undersigned well operator proposes to file or has filed this Notice and Application and accompanying documents for a Well Work Permit with the Administrator of the Office of Oil and Gas, West Virginia Department of Mines, with respect to a well at the location described on attached Application and depicted on attached Form IV-6. Copies of this Notice, the Application, the plat, and the Construction and Reclamation Plan have been mailed by registered or certified mail or delivered by hand to the person(s) named above (or by publication in certain circumstances) on or before the day of mailing or delivery to the Administrator.

The truth of the information on the Notice and Application is verified and sworn to and the Notice is signed on behalf of the Well Operator in my County and State by

WELL OPERATOR Franklin Adkins
By Franklin Adkins
Its Agent
Address P.O. Box 69
Orma, W. Va.
Telephone 743-3843

this 14 day of April 25, 1984
My commission expires May 24, 1986.

Rae Dean
Notary Public, Wayne County,
State of West Virginia

RECEIVED

MAY 30 1984

OIL & GAS DIVISION
DEPT. OF MINES

6) EXTRACTION RIGHTS

Check and provide one of the following:

- Included is the lease or leases or other continuing contract or contracts by which I hold the right to extract oil or gas.
- The requirement of Code 22-4-1-(c) (1) through (4). (See reverse side for specifics.)

7) ROYALTY PROVISIONS

Is the right to extract, produce or market the oil or gas based upon a lease or leases or other contract or contracts providing for flat well royalty or any similar provision for compensation to the owner of the oil or gas in place which is not inherently related to the volume of oil or gas so extracted, produced or marketed? Yes No

If the answer above is No, nothing additional is needed. If the answer is Yes, you may use Affidavit Form IV-60.

05/10/2024

See reverse side for line
7) copies of the Ne
Plan

Instructions, and
Application, p

Provisions concern
Construction and

INSTRUCTIONS TO APPLICANTS

CONCERNING THE LEASE ITEMS:

- 1) Date of Notice.
- 2) Your well name and number.
- 3) To be filled out by the Office of Oil & Gas.
- 4) & 5) Use separate sheet if necessary.
- 4) Surface owner(s) of record to be served with Notice and Application. However, see also Code § 22-4-1b(b) if "more than three tenants in common or other co-owners of interest described in subsection (a) of this section hold interests in such lands".
- 5(i) "Coal Operator" means any person, firm, partnership, partnership association or corporation that proposes to or does operate a coal mine.
- 5(ii, iii) See Code § 22-4-20.
- 6) See Code § 22-4-11(c). However, in lieu of filing the lease(s) or other continuing contract(s), the Applicant may fill out the information in the space provided below.
- 7) See Code § § 22-4-11(d, e).

CONCERNING THE REQUIRED COPIES FOR FILING AND SERVICE:

Filing. Code § 22-4-1k and Regulation 7.02 provide that the original and required copies of the Notice and Application must be filed with the Administrator, accompanied by (i) a plat in the form prescribed by Regulation 11, (ii) a bond in one of the forms prescribed by Regulation 12, or in lieu thereof the other security allowed by Code § 22-4-1k(d) and the reclamation required by Code § 22-4-12b and Regulation 23, (iv) unless previously paid on the same well, the fees required by Code § 22-4-1a(c) and 22-3-12a, and (v) if applicable, the consent required by Code § 22-4-8a from the owner of any water well on dwelling within 200 feet of the proposed well.

Service. In addition, service must be made on the surface owner(s) and the person(s) with an interest in the coal. See Code § § 22-4-1m, 22-4-2, 22-4-2a, and 22-4-2b.

INFORMATION SUPPLIED UNDER CODE § 22-4-11(d)

IN LIEU OF FILING LEASE(S) AND OTHER CONTINUING CONTRACT(S)

Under the oath required to make the verification on the obverse side of this Notice, I depose and say that I am the person who signed the Notice for the Applicant, and that—

- (1) the tract of land is the same tract described in the Application to which this Notice applies, partly or wholly depicted in the accompanying plat, and described in the Construction and Reclamation Plan;
- (2) the parties and recordation data (if recorded) for lease(s) or other continuing contract(s) by which the Applicant claims the right to extract, produce or market the oil or gas are as follows:

<u>Grantor, lessor, etc.</u>	<u>Grantee, lessee, etc.</u>	<u>Royalty</u>	<u>Book</u>	<u>Page</u>
Louis Bennett	Hope Natural Gas Co.	12.5%	56	246
Consolidated Gas Transmission Corp.	Franklin Adkins	3.125%	Not Recorded	



1) Date: April 25, 1984
 2) Operator's Well No. McCumber 1-A
 3) API Well No. 47 State _____ County _____ Permit _____

**STATE OF WEST VIRGINIA
 DEPARTMENT OF MINES, OIL AND GAS DIVISION
 APPLICATION FOR A WELL WORK PERMIT**

- 4) WELL TYPE: A Oil / Gas
 B (If "Gas", Production _____ / Underground storage _____ / Deep _____ / Shallow)
- 5) LOCATION: Elevation: 1025 Watershed: Peep Run
 District: Washington County: Calhoun Quadrangle: Hillstone 7.5
- 6) WELL OPERATOR Franklin Adkins 7) DESIGNATED AGENT Franklin Adkins
 Address: P. O. Box 68 Address: P. O. Box 68
Ona, W. Va. 25545 Ona, W. Va. 25545
- 8) OIL & GAS INSPECTOR TO BE NOTIFIED 9) DRILLING CONTRACTOR:
 Name: Deo Mace Name: _____
 Address: Route 1, Box 5 Address: _____
Sandridge, W. V. 25274
- 10) PROPOSED WELL WORK: Drill / Drill deeper _____ / Redrill _____ / Stimulate _____
 Plug off old formation _____ / Perforate new formation _____
 Other physical change in well (specify) _____
- 11) GEOLOGICAL TARGET FORMATION, _____
 12) Estimated depth of completed well, 2300 feet
 13) Approximate trata depths: Fresh, 50 feet; salt, _____ feet.
 14) Approximate coal seam depths: _____ Is coal being mined in the area? Yes _____

RECEIVED
 MAY 30 1984
 OIL & GAS DIVISION
 DEPT. OF MINES

15) CASING AND TUBING PROGRAM

CASING OR TUBING TYPE	SPECIFICATIONS					FOOTAGE INTERVALS		CEMENT FILL-UP OR SACKS (Cubic feet)	PACKERS
	Size	Grade	Weight per ft.	New	Used	For drilling	Left in well		
Conductor									Kinds
Fresh water									Sizes
Coal									
Intermediate	8	H 40	20	x		250	250	100	
Production	4	J 55	10.5	x			2300	60	Depths set
Tubing	2	J 55	4.6	x			2300		Perforations:
Liners									Top Bottom

The law requires a comment period for surface owners. However, the permit can be issued in less than 15 days from the filing of the Application if the surface owner(s) of record sign(s) the following "Voluntary Statement of No Objection" on a facsimile of this surface owner's copy of the Application.

VOLUNTARY STATEMENT OF NO OBJECTION

I hereby state that I have read the instructions to surface owners on the reverse side of this Application for a Well Work Permit, and that I have received copies of (1) a Notice of Application for a Well Work Permit on Form IV-2(A), (2) an Application for a Well Work Permit on Form IV-2(B), (3) a survey plat on Form IV-6, and (4) a Construction and Reclamation Plan on Form IV-9, all for proposed well work on my surface land as described therein.
 I further state that I have no objection to the planned work described in these materials, and I have no objection to a permit being issued based on those materials.

(For execution by corporation, partnership, etc.)
 NAME: _____
 By _____
 Its _____ Date _____

(For execution by natural persons)
Steve McCumber Date: _____
 (Signature)
W. J. McCumber Date: May-26-84
 (Signature)

**INSTRUCTIONS TO SURFACE OWNERS
AND
EXPLANATION OF METHODS AND TIME LIMITS TO COMMENT
ON OIL AND GAS WELL WORK PERMIT**

The well operator named in the Notice and this Application and the attached materials is applying for a permit from the State to do oil or gas well drilling or other well work. You are being served with these materials because surface owners have the right to file comments before the permit is issued. (**NOTE:** If the surface tract is owned by more than three persons, in multiple heirship for example, then these materials were served on you because your name appeared on the Sheriff's tax ticket on the land or because you actually occupy the surface tract. In either case, you may be the only owner who will actually receive these materials.) See Chapter 22, Article 4 of the W. Va. Code. Permits are valid for 24 months.

If you do not own any interest in the surface tract, please forward these materials to the true owner immediately if you know who it is. Also, please notify the well operator named in the materials and the Administrator of the Office of Oil and Gas in the West Virginia Department of Mines immediately.

NOTE: You are not required to file any comment at all.

Where to file comments and obtain additional information:

Administrator of the Office of Oil and Gas
West Virginia Department of Mines
1615 Washington Street East
Charleston, West Virginia 25311
(304) 348-2057

Who may file comments? If you wish to file comments, you must be an owner of record of (1) an interest in the surface tract on which the well already is or is about to be located, or (2) an interest in any other surface tract under the same oil or gas lease which will be utilized for roads or other land disturbances.

Time limits for comments. The law requires these materials to be delivered on or before the date the operator files his Application. You have **FIFTEEN (15) DAYS** after the filing date to file your comments as provided in **Methods for Filing Comments** below. You may call the Administrator's office at the above telephone number to be sure of the date. However, if you have been contacted by the well operator, and if you have signed a "voluntary statement of no objection" to any of the planned work described in these materials, then the permit may be issued at any time.

Comments must be in writing. Your comments must include your name, address and telephone number, the well operator's name and well number, and the approximate location of the proposed well site including district and county from the application. You may add other documents, such as sketches, maps or photographs to support your comments.

Methods for filing comments. Comments must be filed in person or received in the mail at the Administrator's office by the time stated above. Check with your postmaster to ensure adequate delivery time or to arrange special expedited handling.

The Administrator for Oil and Gas has the power to deny or condition a well work permit based on your comments on the following grounds:

- "(1) The proposed well work will constitute a hazard to the safety of persons; or
- "(2) The plan for soil erosion and sediment control is not adequate or effective; or
- "(3) Damage would occur to publicly owned lands or resources; or
- "(4) The proposed well work fails to protect fresh water sources or supplies."

If you want a copy of the permit as it is finally issued, or a copy of the order denying the permit, you should request a copy from the Administrator.

List of Water Testing Laboratories. The Administrator maintains a list of water testing laboratories which you can hire to test your water to establish water quality prior to and after drilling. Contact the Administrator's office or an Oil and Gas Inspector to obtain a copy of the list.

05/10/2024

DATE 6/24/04 **WELL SERVICE CO.**
 19TH FLOOR KANAWHA VALLEY BLDG., CHARLESTON, W. VA. 25301

FIELD SERVICE TICKET NO. **DA**
W **075**
 Permit No. 17103-3741
 05/10/2024

Company Frank Adkins Time called for _____ Time on job _____
 P. O. - Street BIA CS Job started _____ Finished _____
 City - State OMA MO 65055 Waiting time _____ Road Condition _____
 Lease McCluney Well No. 1-A Tractor Used _____
 County Callaway State MO Contractor Mize Unit No. _____

SALES SERVICE ENGINEER WORK DATA

It is mutually agreed by both parties involved that WELL SERVICE, CO., equipment No. _____ is leased to _____ and will operate under their supervision. Our Engineer, and his crew will, in a competent and cooperative manner, efficiently operate the equipment and with additional assistance, if needed, to be furnished by the lessee. Due to many unknown and variable conditions, of which we have no mutual knowledge or control, it requires WELL SERVICE, CO. not to assume any responsibility toward unsuccessful results or incompletion of the operation.

Sales Service Engineer Don Harry Crew Dave Pumphrey
 Company _____ Supervisor Walter Phillips

Materials: _____ **General Charges:** _____

Casing pressure cement Name Cement Job _____ Type _____
 Casing Balance cement Type Portland Extra Pumping _____ Hrs. _____
 Casing Comb. Gel-cement Sacks 75 Wait on Job _____ Hrs. _____
 Casing Squeeze cement Gallons _____ Mileage _____ R. T. _____
 Prepare Mud Wt. per gal. _____ Material Name 1900 # Calcium

Plugging Gel-cement Ad-mix _____ Material Name _____
 Pumping Casing-Tubing Other Specialties Material Name _____
 Formation Cement Squeeze Viscosity _____ Material Name _____
 Formation Chem. Squeeze Temp. _____ Xtra Unit _____ Hrs. _____
 Killing well mud-water Acidizing _____ Stand By Unit _____ Type _____

Cement Plug Back _____ Fluid _____ Type _____
 _____ Trans. _____ Type _____
 _____ Gas @ _____ Gals. _____
 _____ Pipe leaking _____ Special Plugs _____ Type _____
 _____ Shoe leaking _____

Normal pump pressure 150 Max. 300 **COMPLETION REPORT**
 Return circulation at surface Cement

Return circulation of materials _____

General Remarks: 75 Sks. Cement / 1 Sk. Calcium Displaced
Outside 88" casing

Casing Size 8 1/2" WT. _____
 Depth 210
 TUBING SIZE _____
 PACKER SET _____
 Size of Open Hole _____
 Total Depth _____
 Bridge Top _____

Acidizing or Chemical Data

Name Formation _____
 Character Formation _____
 Gas/Oil Volume _____
 Rock Pressure _____
 Type Acid/Chemical _____
 Gallons _____ %
 #1 Stage _____ #2 _____
 1st Pay _____
 2nd Pay _____
 Injection Rate _____

Company of 1911

Company of 1911

COMPETITION RECORD

Company of 1911

JOY & CHAIRS

Company of 1911

Company of 1911

Company of 1911

Company of 1911

Company of 1911

Company of 1911

Company of 1911

Company of 1911

Company of 1911

Company of 1911

Company of 1911

Company of 1911

Company of 1911

Company of 1911

Company of 1911

Company of 1911

Company of 1911

Company of 1911

Company of 1911

Company of 1911

Company of 1911

Company of 1911

Company of 1911

Company of 1911

Company of 1911

Company of 1911

Weighting by Commercial Dept

1. 1000

2. 1000

3. 1000

4. 1000

5. 1000

6. 1000

7. 1000

8. 1000

9. 1000

10. 1000

WELLS SERVICE CO

M 052

IV-35
(Rev 8-81)

RECEIVED

DEC 10 1984

OIL & GAS DIVISION
DEPT. OF MINES



State of West Virginia

Department of Mines
Oil and Gas Division

Date Nov. 1, 1984
Operator's McCumber 1-A
Well No. McCumber 1-A
Farm Okey McCumber
API No. 47 - 013 - 3741

WELL OPERATOR'S REPORT
OF
DRILLING, FRACTURING AND/OR STIMULATING, OR PHYSICAL CHANGE

WELL TYPE: Oil x / Gas x / Liquid Injection / Waste Disposal /
(If "Gas," Production / Underground Storage / Deep / Shallow x /)

LOCATION: Elevation: 1028 Watershed Bear Run
District: Washington County Calhoun Quadrangle Millstone

COMPANY Franklin Adkins
ADDRESS P. O. Box 68, Ona, W.V. 25545
DESIGNATED AGENT Franklin Adkins
ADDRESS P. O. Box 68, Ona, W. Va. 25545
SURFACE OWNER Okey McCumber
ADDRESS Orma, W. Va.
MINERAL RIGHTS OWNER Hunter Bennett Et Al
ADDRESS P.O. Box 166, Weston, W.V.
OIL AND GAS INSPECTOR FOR THIS WORK Dep
Mace ADDRESS Sand Ridge, W.V.
PERMIT ISSUED June 13, 1984
DRILLING COMMENCED 6-28-1984
DRILLING COMPLETED 7- 6-1984

Casing & Tubing	Used in Drilling	Left in Well	Cement fill up Cu. ft.
Size 20-16 Cond.			
13-10"			
9 5/8			
8 5/8	264	264	75 sks. B.T.S
7			
5 1/2			
4 1/2		2326	100 cf
3			
2		2324	
Liners used			

GEOLOGICAL TARGET FORMATION Injun Sand Depth 2207-2256 feet
Depth of completed well 2328 feet Rotary x / Cable Tools
Water strata depth: Fresh 150 feet; Salt 1980 feet
Coal seam depths: No Is coal being mined in the area? No

OPEN FLOW DATA

Producing formation Injun Sand Pay zone depth 2207 2256 feet
Gas: Initial open flow show Mcf/d Oil: Initial open flow show Bbl/d
Final open flow 307,000 Mcf/d Final open flow 2 Bbl/d
Time of open flow between initial and final tests 4 hours
Static rock pressure 320 psig (surface measurement) after 24 hours shut in
(If applicable due to multiple completion--)
Second producing formation Pay zone depth feet
Gas: Initial open flow Mcf/d Oil: Initial open flow Bbl/d
Final open flow Mcf/d Oil: Final open flow Bbl/d
Time of open flow between initial and final tests hours
Static rock pressure psig (surface measurement) after hours shut in

(Continue on reverse side)

CAL-3741

DETAILS OF PERFORATED INTERVALS, FRACTURING OR STIMULATING, PHYSICAL CHANGE, ETC.

Fractured Injun Sand: 1500 gals., of acid, 30,000 lbs., of 20/40 mesh sand, 15 gal., U42, 5 gal., A200, 20 gal., W22. 15 gal., F-78, 600 gals., of water.

WELL LOG

FORMATION	COLOR	HARD OR SOFT	TOP FEET	BOTTOM FEET	REMARKS
					Including indication of all fresh and salt water, coal, oil and gas
Shale & Sand			0	952	Show of Water 150 ft.
Sand			952	1160	
Sand & Shale			1160	1296	
Shale			1296	1884	
Salt Sand			1884	1928	
Shale			1928	1960	
Salt Sand			1960	1998	
Shale			1998	2024	
Maxton Sand			2024	2060	
Shale			2060	2072	
Big Lime			2072	2158	
Kenner Sand			2158	2207	
Injun Sand			2207	2256	
Shale & T. D.			2256	2328	

(Attach separate sheets as necessary)

Franklin Atkins
Well Operator

By: *Franklin Atkins, Agent*
Date: *Nov 1, 1984* 05/10/2024

Note: Regulation 2.02(i) provides as follows:
"The term 'log' or 'well log' shall mean a systematic detailed geological record of all formations, including coal, encountered in the drilling of a well."

STATE OF WEST VIRGINIA
DEPARTMENT OF ~~MINES~~ ENERGY
OIL AND GAS WELLS DIVISION

RECEIVED
DEPARTMENT OF ENERGY
OIL AND GAS

INSPECTOR'S WELL REPORT

JUN 17 1986

Permit No. 13-3741
6-13-84

Oil or Gas Well _____
(KIND)

Company <u>F. Adkins</u>	CASING AND TUBING	USED IN DRILLING	LEFT IN WELL	PACKERS
Address _____	Size			
Farm <u>Steve Mc Cumbers</u>	16			Kind of Packer _____
Well No. <u>1-A</u>	13			
District <u>Wash</u> County <u>Cal</u>	10			Size of _____
Drilling commenced _____	8 1/4			
Drilling completed _____ Total depth _____	6 3/8			Depth set _____
Date shot _____ Depth of shot _____	5 3/16			
Initial open flow _____ /10ths Water in _____ Inch	3			Perf. top _____
Open flow after tubing _____ /10ths Merc. in _____ Inch	2			Perf. bottom _____
Volume _____ Cu. Ft.	Liners Used			Perf. top _____
Rock pressure _____ lbs. _____ hrs.				Perf. bottom _____
Oil _____ bbls., 1st 24 hrs.	CASING CEMENTED _____ SIZE _____ No. FT. _____ Date _____			
Fresh water _____ feet _____ feet	NAME OF SERVICE COMPANY _____			
Salt water _____ feet _____ feet	COAL WAS ENCOUNTERED AT _____ FEET _____ INCHES			
	_____ FEET _____ INCHES _____ FEET _____ INCHES			
	_____ FEET _____ INCHES _____ FEET _____ INCHES			

Drillers' Names _____

Remarks:

Release Reclamation

6-14-86
DATE

D. W. Mace
DISTRICT WELL INSPECTOR

05/10/2024

REF. TO NEW WELL

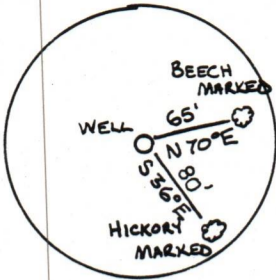

OTTICE TUCKER
53 AC

PERRY PARSONS
94 AC.

RAY COTTRELL
15 AC.

OKEY McCUMBERS
97 AC.
84 / 492

DARRELL NICHOLAS
33 AC

VANCE NICHOLAS
41 AC.

NORTH

LONGITUDE 81° 02' 30"

14,800

FILE NO. _____
 DRAWING NO. 83-177-1A
 SCALE 1" = 500'
 MINIMUM DEGREE OF ACCURACY 1 IN 200
 PROVEN SOURCE OF ELEVATION B.M. FROM CO. RT. 11 AT BEAR RUN ELY=784

I THE UNDERSIGNED, HEREBY CERTIFY THAT THIS PLAT IS CORRECT TO THE BEST OF MY KNOWLEDGE AND BELIEF AND SHOWS ALL THE INFORMATION REQUIRED BY LAW AND THE REGULATIONS ISSUED AND PRESCRIBED BY THE DEPARTMENT OF MINES.

(SIGNED) _____
 R.P.E. _____ L.L.S. _____

PLACE SEAL HERE

STATE OF WEST VIRGINIA
 DEPARTMENT OF MINES
 OIL AND GAS DIVISION



DATE NOV. 29, 19 83
 OPERATOR'S WELL NO. McCUMBERS 1-A
 API WELL NO. 47-013-3741
 STATE COUNTY PERMIT

(+) DENOTES LOCATION OF WELL ON UNITED STATES TOPOGRAPHIC MAPS
 WELL TYPE: OIL GAS LIQUID INJECTION _____ WASTE DISPOSAL _____
 (IF "GAS,") PRODUCTION STORAGE _____ DEEP _____ SHALLOW
 LOCATION: ELEVATION 1028 WATER SHED BEAR RUN
 DISTRICT WASHINGTON COUNTY CALHOUN
 QUADRANGLE MILLSTONE 7.5

SURFACE OWNER STEVE McCUMBERS ACREAGE 97 AC
 OIL & GAS ROYALTY OWNER HUNTER BENNETT LEASE ACREAGE 10510/2024
 LEASE NO. _____

PROPOSED WORK: DRILL CONVERT _____ DRILL DEEPER _____ REDRILL _____ FRACTURE OR STIMULATE PLUG OFF OLD FORMATION _____ PERFORATE NEW FORMATION _____ OTHER PHYSICAL CHANGE IN WELL (SPECIFY) _____

PLUG AND ABANDON _____ CLEAN OUT AND REPLUG _____
 TARGET FORMATION BIG INJUN ESTIMATED DEPTH 2400'
 WELL OPERATOR FRANKLIN ADKINS DESIGNATED AGENT FRANKLIN ADKINS
 ADDRESS BOX 68 ADDRESS BOX 68
ONA, W.V. 25545 ONA, W.V. 25545