

Latitude 38° 25'

Longitude 82° 15'

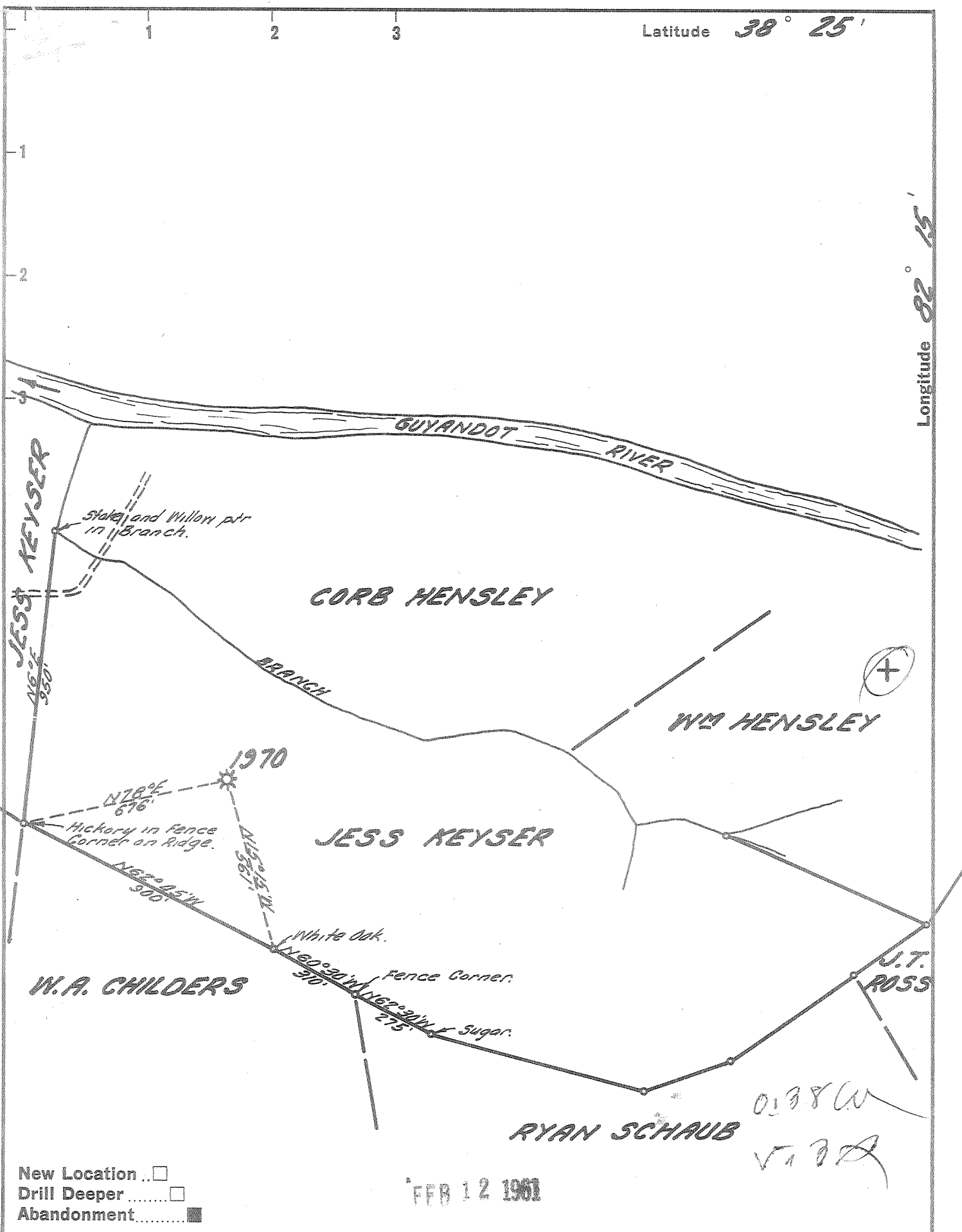

- New Location
- Drill Deeper
- Abandonment

FEB 12 1961

0.380
V. B. D.

Company UNITED FUEL GAS CO.
 Address CHARLESTON, W. VA.
 Farm JESS KEYSER
 Tract _____ Acres 70 Lease No. 20277
 Well (Farm) No. 1 Serial No. 1970
 Elevation (Spirit Level) 684.6'
 Quadrangle GUYANDOT
 County CABELL District MCCOMAS
 Engineer Paul E. Janczewski
 Engineer's Registration No. 669
 File No. 28-57 Drawing No. _____
 Date 1-13-61 Scale 1" = 400'

STATE OF WEST VIRGINIA
 DEPARTMENT OF MINES
 OIL AND GAS DIVISION
 CHARLESTON

WELL LOCATION MAP
 FILE NO. CAB-93-A

- + Denotes location of well on United States Topographic Maps, scale 1 to 62,500, latitude and longitude lines being represented by border lines as shown.
- Denotes one inch spaces on border line of original tracing.



536

STATE OF WEST VIRGINIA
DEPARTMENT OF MINES
OIL AND GAS DIVISION

Quadrangle Guyandot

Permit No. - Cabell 93-A

WELL RECORD

Oil or Gas Well Gas
(KIND)

Company United Fuel Gas Company
Address P.O. Box 1273; Charleston 25, W. Va.
Farm Jess Keyser Acres 70
Location (waters) Guyandot River
Well No. 1970 Elev. 684.6
District McComas County Cabell
The surface of tract is owned in fee by _____
Address _____
Mineral rights are owned by Jess Keyser
Address Salt Rock, W. Va.
Drilling commenced 11-27-29
Drilling completed 2-13-29
Date Shot 2-6-29 From _____ To _____
With 2200# Gello.
Open Flow 22 /10ths Water in _____ Inch
_____ /10ths Merc. in _____ Inch
Volume 223,104 Cu. Ft.
Rock Pressure 270# Shale lbs. _____ hrs.
345# Berea
Oil _____ bbls., 1st 24 hrs.
WELL ACIDIZED _____
WELL FRACTURED _____

Casing and Tubing	Used in Drilling	Left in Well	Packers
Size			Kind of Packer
16			<u>OWS Anchor</u>
18			Size of
10		<u>59'-11"</u>	<u>3" x 6-5/8"</u>
8 1/4	<u>868'</u>	<u>Pulled</u>	Depth set
6 3/4		<u>1838'</u>	<u>3390'</u>
5 3/16			Perf. top
3		<u>3449'</u>	Perf. bottom
2			Perf. top
Liners Used			Perf. bottom

CASING CEMENTED _____ SIZE _____ No. Ft. _____ Date _____
COAL WAS ENCOUNTERED AT 740 FEET 60 INCHES
_____ FEET _____ INCHES FEET _____ INCHES
_____ FEET _____ INCHES FEET _____ INCHES

RESULT AFTER TREATMENT _____

ROCK PRESSURE AFTER TREATMENT _____

Fresh Water _____ Feet Salt Water _____ Feet

Formation	Color	Hard or Soft	Top	Bottom	Oil, Gas or Water	Depth	Remarks
Surface			0	20			
Sand			20	36	No salt; sand shown on record book.		
Slate			36	46	Run 8-1/4" casing at 868 ft.		
Red Rock			46	50	On 10" and 8-1/4" casing no packer or casing shoe used. Bottom joints belled out.		
Sand			50	54	6-5/8" casing set on		
Slate			54	105	6-5/8" x 8-1/4" Paramaco Bottom hole packer at 1810" S.L. Measure.		
Slate & Sand			105	650	No water found in big line or big injun sand.		
Slate			650	673	6-5/8" casing run at		
Slate & Sand			673	740	above depth on account of water showing up at a well nearby, in big injun sand.		
Coal			740	745	Gas pay from 2298' to 2306'. Tested 4/10 W in 1", blew down to 2/10 W 1" just before getting first shale gas.		
Slate & Sand			745	1435			
Lime Shell			1435	1455			
Slate & Lime			1455	1490			
Slate			1490	1498			
Big Lime			1498	1660			
Slate			1660	1665			
Lime Sand			1665	1730			
Big Injun			1730	1800	Gas pay at 3120' to 3135'. Test 20/10 W 1" opening including Berea Gas and blew down to 7/10 W thru 1" before getting 2nd shale. Gas pay from 3150' to 3240'. Test 20/10 W thru 1" including Berea and 1st S&S Shale gas. Tubing anchor packer set at 2331'. Top of big lime, 6-5/8" casing gas pays and Total Depth, all steel line measure. Well tested 20/10 Water in 1" before shot. Shot with 2200# Gello. Tested 22/10 Water thru 2" when tubed. Top shot 3094, bottom 3369'		
Slate			1800	1805			
Black Lime			1805	1818			
Slate and Lime Shell			1818	2288			
Brown Shale			2288	2298			
Berea Sand			2298	2306			
Slate			2306	2335			
Hard Shell			2335	2355			
Slate & Shells			2355	2965			
Slate & Shale			2965	3100			
White Slate			3100	3120			
Brown Shale			3120	3135			
White Slate			3135	3240			

(over) AUG 2 1961

JESS KEYSER No. 1970

U. F. G. Co.

CAB 93-A

Formation	Color	Hard or Soft	Top	Bottom	Oil, Gas or Water	Depth Found	Remarks
White Shale			3240	3260			
Brown Shale			3260	3397			
White Slate			3397	3444			
Total Depth			3444'				

Date January 26, 19 61

APPROVED UNITED FUEL GAS COMPANY, Owner

By S.R. Jewell
(Title)

Supt., Civil Engineering Dept.