

Latitude 38 30  
 Longitude 82 15

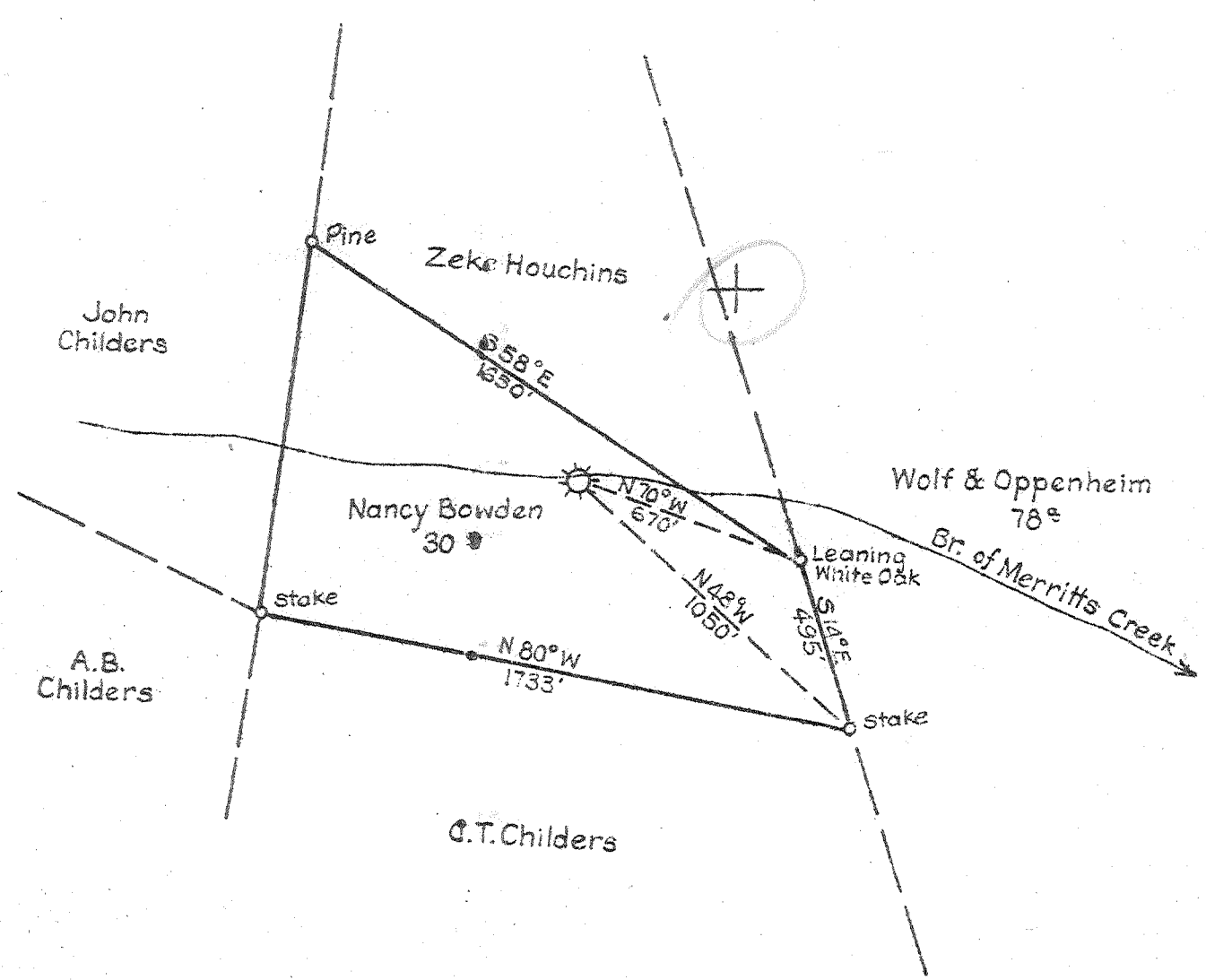

New Location   
 Drill Deeper   
 Abandonment

✓ 1948 3 1 1948

311 W  
 4158 D

Company D.H. BLAND  
 Address Charleston, W. Va.  
 Farm Nancy Bowden  
 Tract \_\_\_\_\_ Acres 30 Lease No. \_\_\_\_\_  
 Well (Farm) No. 1 Serial No. \_\_\_\_\_  
 Elevation (Spirit Level) 605'  
 Quadrangle Guyandot  
 County Cabell District Burboursville  
 Engineer Paul E. Joachim  
 Engineer's Registration No. 669  
 File No. \_\_\_\_\_ Drawing No. \_\_\_\_\_  
 Date Feb 14, 1948 Scale 1" = 500'

STATE OF WEST VIRGINIA  
 DEPARTMENT OF MINES  
 OIL AND GAS DIVISION  
 CHARLESTON

WELL LOCATION MAP  
 FILE NO. CAB-46-A

+ Denotes location of well on United States Topographic Maps, scale 1 to 62,500, latitude and longitude lines being represented by border lines as shown.

- Denotes one inch spaces on border line of original tracing.

6-6 Huntington (205)

NANCY BOWDEN No. 1 - D. H. BLAND - CAB-46-A



STATE OF WEST VIRGINIA  
DEPARTMENT OF MINES  
OIL AND GAS DIVISION

189

WELL RECORD

Oil or Gas Well Gas  
(KIND)

Permit No. 467

Company D. H. Bland  
Address Charleston, W. Va.  
Farm Nancy Bowden Acres 30  
Location (waters) Merritts Creek  
Well No. 1 Elev. 605  
District Barboursville County Cabell  
The surface of tract is owned in fee by Nancy Bowden  
Address Barboursville, W. Va.  
Mineral rights are owned by Nancy Bowden  
Address Barboursville, W. Va.  
Drilling commenced October 1930  
Drilling completed January 1931  
Date Shot Jan. 1931 From 2756 To 3049  
With 2300# Gelatin  
Open Flow 18 /10ths Water in 3" Inch  
/10ths Merc. in \_\_\_\_\_ Inch  
Volume 454,000 Cu. Ft.  
Rock Pressure \_\_\_\_\_ lbs. \_\_\_\_\_ hrs.  
Oil \_\_\_\_\_ bbls., 1st 24 hrs.  
Fresh water \_\_\_\_\_ feet \_\_\_\_\_ feet  
Salt water \_\_\_\_\_ feet \_\_\_\_\_ feet

Casing and Tubing	Used in Drilling	Left in Well	Packers
Size			Kind of Packer
16			
13			
10	60	60	Size of
6 3/8			Depth set
5 3/16	1705	1705	Perf. top
3	3130	3130	Perf. bottom
2			Perf. top
Liners Used			Perf. bottom

CASING CEMENTED \_\_\_\_\_ SIZE \_\_\_\_\_ No. Ft. \_\_\_\_\_ Date \_\_\_\_\_  
COAL WAS ENCOUNTERED AT \_\_\_\_\_ FEET \_\_\_\_\_ INCHES  
\_\_\_\_\_ FEET \_\_\_\_\_ INCHES \_\_\_\_\_ FEET \_\_\_\_\_ INCHES  
\_\_\_\_\_ FEET \_\_\_\_\_ INCHES \_\_\_\_\_ FEET \_\_\_\_\_ INCHES

Formation	Color	Hard or Soft	Top	Bottom	Oil, Gas or Water	Depth Found	Remarks
Surface			0	45			
Red Rock			45	150			
Slate & Sand			150	685			
Break			685	832			
Slate			832	1032			
Salt Sand			1032	1119			
Slate			1119	1503			
Big Lime			1503	1478			
Injun			1500	1605			
Berea			2083	2089			
Brown Shale			2756	3049	Gas	2756-3049	
Total Depth			3130				

