

LATITUDE 38° 25'

LONGITUDE 92° 05'

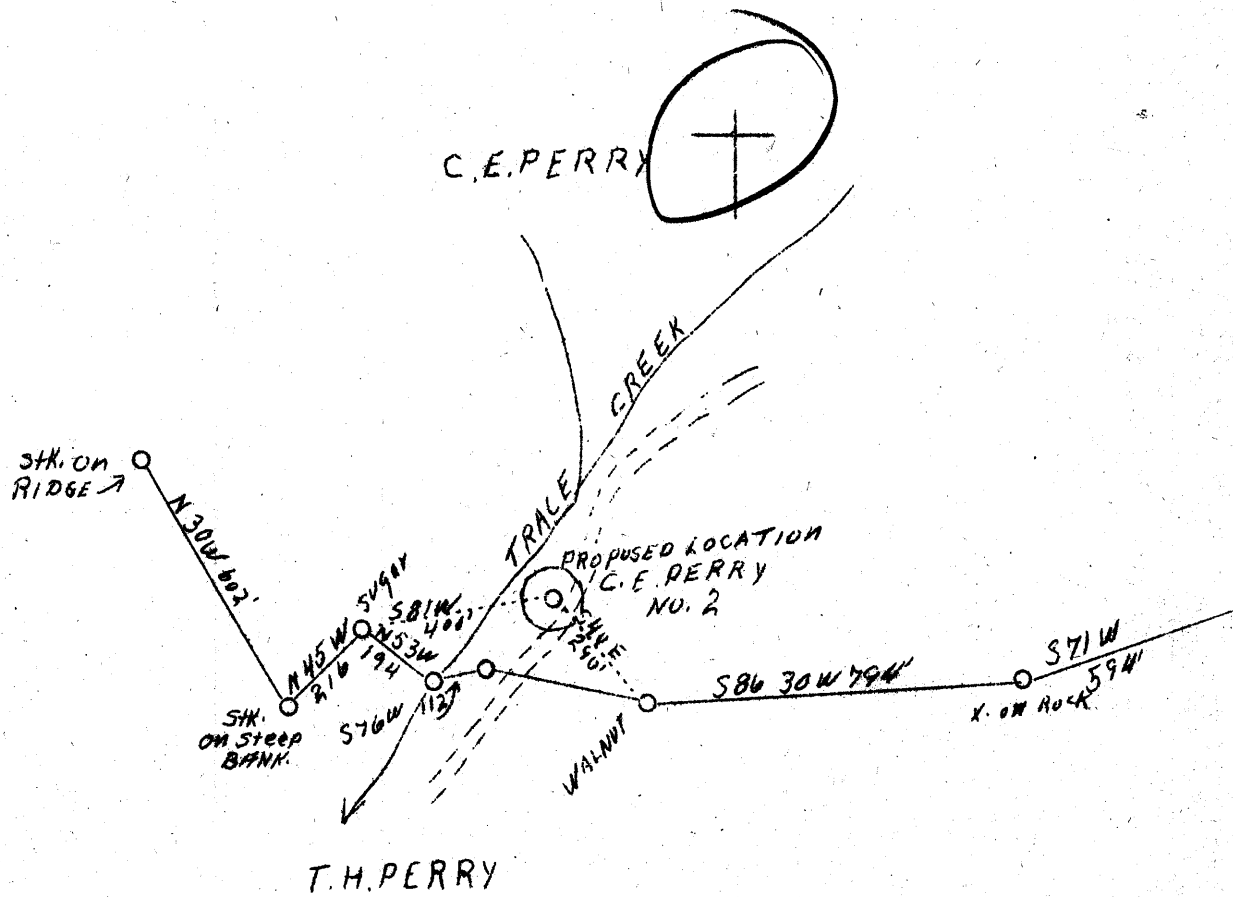

3.05 W
4.15 S

New Location

Company	Thermal Gas Co.
Address	Box 695, Charleston, W. Va.
Farm	C. E. Perry
Acres	48
Well No.	Two
Elevation (SP)	585
Quadrangle	Milton
County	Cabell
District	Grant
Engineer	J. D. Moore
Eng. Reg. No.	159
Date	Sept. 22, 1938
Scale	1" = 400'

STATE OF WEST VIRGINIA
 Department of Mines
 OIL & GAS DIVISION
 Charleston

WELL LOCATION MAP

File No. Cab-328

x Denotes location of well on U. S. Topographic Maps, scale 1 to 62,500, latitude and longitude lines being represented by border lines as shown.

- Denotes one inch spaces on border line of original tracing.

