

40°22'30"

Latitude

80°35'00"

Longitude

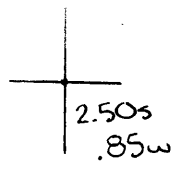

Topo Location

7.5' Loc. _____ 15' Loc. _____
 _____ (calc.) _____

Company Whooling Steed Corp

Farm Whooling Steed Corp #33

15' Quad _____
(sec.)

7.5' Quad Steubenville East

District Cross Creek

WELL LOCATION PLAT

County 009 **Permit** 30046

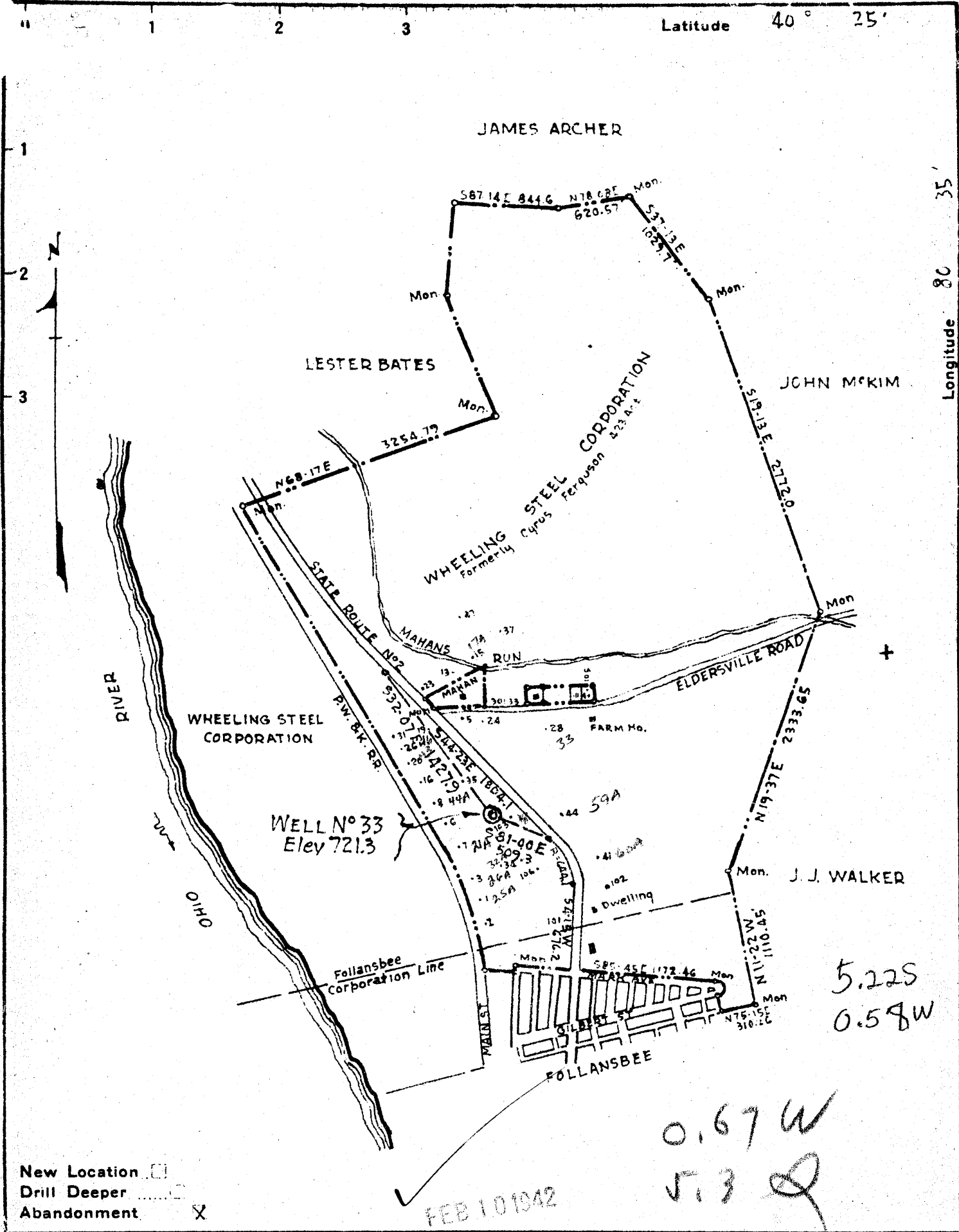

New Location
 Drill Deeper
 Abandonment

FEB 10 1942

Company WHEELING STEEL CORPORATION
 Address (General Office) Wheeling, W. Va
 Farm Wheeling Steel Corporation { Formerly Cyrus Ferguson }
 Tract Acres 423 Lease No. _____
 Well (Farm) No. 33 Serial No. _____
 Elevation (Spirit Level) 721.3
 Quadrangle Stuebenville
 County Brooke District Cross Creek
 Engineer Eugene M. Smith - C.C. Smith's Sons
 Engineer's Registration No. 290
 File No. _____ Drawing No. _____
 Date Jan. 16, 1941 Scale 1" = 1000'

STATE OF WEST VIRGINIA
 DEPARTMENT OF MINES
 OIL AND GAS DIVISION
 CHARLESTON
WELL LOCATION MAP
 FILE NO. BRO-46-A
 + Denotes location of well on United States Topographic Maps, scale 1 to 62,500, latitude and longitude lines being represented by border lines as shown.
 - Denotes one inch spaces on border line of original tracing.

WHEELING STEEL CORP. No. 33 — WHEELING STEEL CORP. — BRO-46-A

Latitude 40° 25'

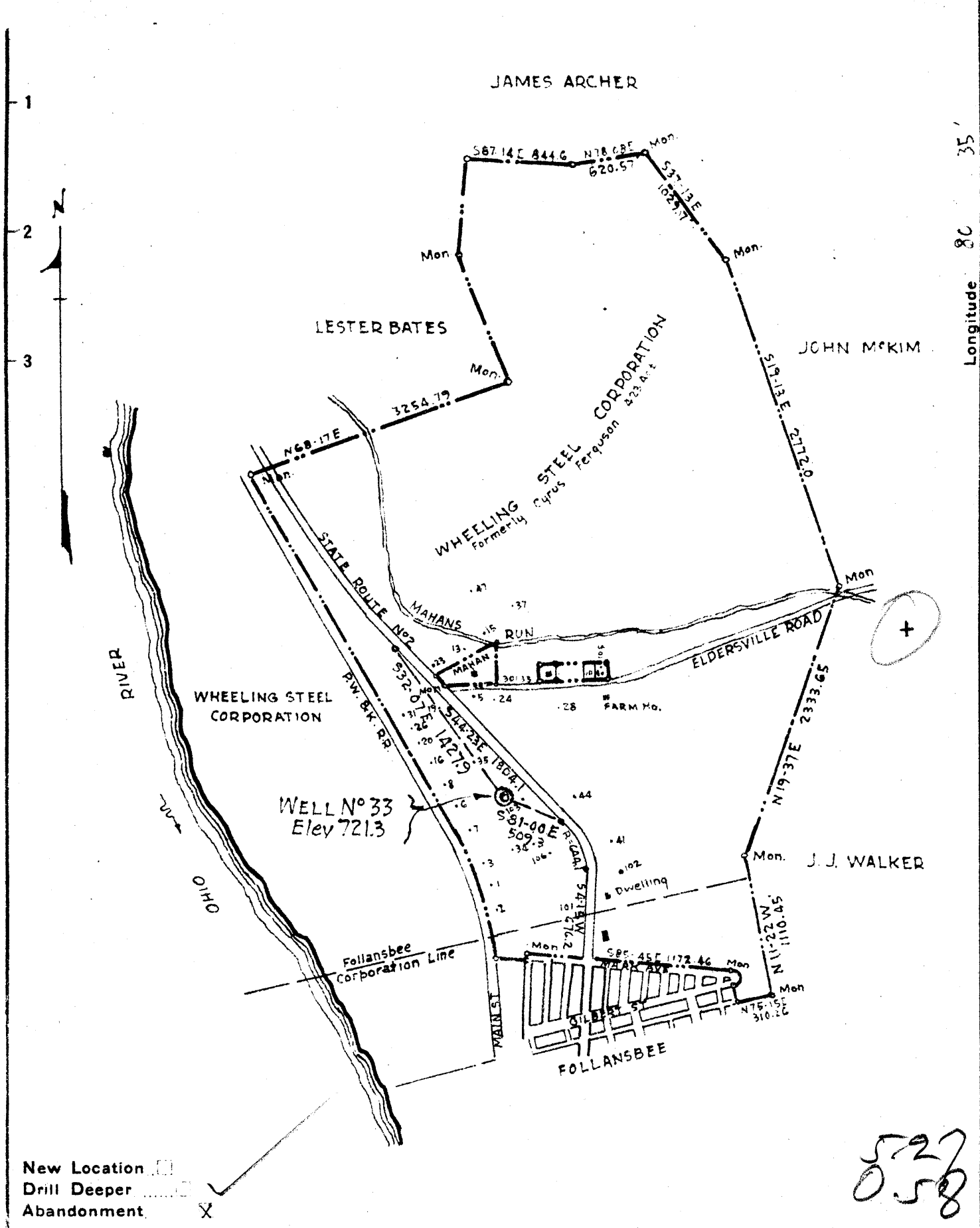

New Location
 Drill Deeper
 Abandonment

527
 058
 W

| | |
|----------------------------|--|
| Company | WHEELING STEEL CORPORATION |
| Address | (General Office) Wheeling, W. Va |
| Farm | Wheeling Steel Corporation { Formerly Cyrus Ferguson } |
| Tract | Acres 423 Lease No. |
| Well (Farm) No. | 33 Serial No. |
| Elevation (Spirit Level) | 721.3 |
| Quadrangle | Steubenville |
| County | Brooke District Cross Creek |
| Engineer | Eugene M. Smith - C.C. Smith's sons |
| Engineer's Registration No | 290 |
| File No. | Drawing No. |
| Date | Jan. 16, 1941 Scale 1" = 1000' |

STATE OF WEST VIRGINIA
 DEPARTMENT OF MINES
 OIL AND GAS DIVISION
 CHARLESTON

WELL LOCATION MAP
 FILE NO. B10-46-A

+ Denotes location of well on United States Topographic Maps, scale 1 to 62,500, latitude and longitude lines being represented by border lines as shown.

- Denotes one inch spaces on border line of original tracing.

STATE OF WEST VIRGINIA
DEPARTMENT OF MINES
OIL AND GAS DIVISION

36

WELL RECORD

Permit No. **No record.**

Oil or Gas Well **OIL**
(KIND)

Company **Wheeling Steel Corporation**
 Address **Wheeling, W. Va.**
 Farm **Corporation** Acres **425**
 Location (waters) **1/2 Mile East of Ohio River**
 Well No. **55** Elev. _____
 District **Cross Creek** County **Brooke**
 The surface of tract is owned in fee by **Wheeling Steel Corporation**
 Address **Wheeling, W. Va.**
 Mineral rights are owned by **Wheeling Steel Corporation**
 Address **Wheeling, W. Va.**
 Drilling commenced **Year, 1908.**
 Drilling completed _____
 Date Shot _____ From _____ To _____
 With _____
 Open Flow _____ /10ths Water in _____ Inch
 _____ /10ths Merc. in _____ Inch
 Volume _____ Cu. Ft.
 Rock Pressure _____ lbs. _____ hrs.
 Oil _____ bbls., 1st 24 hrs.
 Fresh water _____ feet _____ feet
 Salt water _____ feet _____ feet

| Casing and Tubing | Used in Drilling | Left in Well | Packers |
|-------------------|------------------|--------------|----------------|
| Size | | | |
| 16 | | | Kind of Packer |
| 13 | | | NONE |
| 9 1/2 | | | Size of |
| 8 1/2 | | | Depth set |
| 6 5/8 | | | |
| 5 3/16 | | | Perf. top |
| 3 | | | Perf. bottom |
| 2 | | | Perf. top |
| Liners Used | NONE | | Perf. bottom |

CASING CEMENTED **NO** SIZE _____ No. Ft. _____ Date _____
NO RECORD
 COAL WAS ENCOUNTERED AT _____ FEET _____ INCHES
 _____ FEET _____ INCHES _____ FEET _____ INCHES
 _____ FEET _____ INCHES _____ FEET _____ INCHES

| Formation | Color | Hard or Soft | Top | Bottom | Oil, Gas or Water | Depth Found | Remarks |
|---|-------|--------------|----------|--------|-------------------|-------------|---------|
| Top of Berea Sand | ----- | ----- | 1510 ft. | | | | |
| Bottom of Berea Sand | ----- | ----- | 1552 ft. | | | | |
| Total Depth of Well | ----- | ----- | 1540 ft. | | | | |
| Notes: | | | | | | | |
| This well was drilled during the year 1908 but there is no log nor other record available that would give any data, concerning same except what is shown above. | | | | | | | |
| WHEELING STEEL CORPORATION. | | | | | | | |



WHEELING STEEL CORP. NO. 33 WELL.

Cross Creek District, Brooke County, W. Va.

By Wheeling Steel Corp., Wheeling, W. Va.

Abandoned under permit Bro-46-A.

On 423 acres, $\frac{1}{2}$ mile east of Ohio River.

Surface and minerals owned by Wheeling Steel Corp., Wheeling, W. Va.

Drilled in 1908.

10" casing, 94'; 8 $\frac{1}{4}$ ", 665'; 6 $\frac{5}{8}$ ", 972'; all left in. No liners used.

No packer.

NOTE: This well was drilled during the year 1908 but there is no log nor other record available that would give any data concerning the same except what is shown above.

Oil well. Abandonment report to Dept. of Mines (filed) Jan. 31, 1942.

Record to RCT from Mrs. Griffith May 22, 1942. Old File No. 36.

| | Top. | Bottom. |
|-------------|------|---------|
| Berea Sand | 1310 | - 1332 |
| Total depth | | 1340 |