

40° 22' 30"

Latitude

80° 35' 00"

Longitude

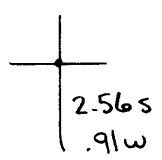

Topo Location

7.5' Loc. _____ 15' Loc. _____
 _____ (calc.) _____

Company Wheeling Steel Corp

Farm Wheeling Steel Corp B

15' Quad _____
(sec.)

7.5' Quad Stuebenville East

District Cross Creek

WELL LOCATION PLAT

County 009 Permit 30044

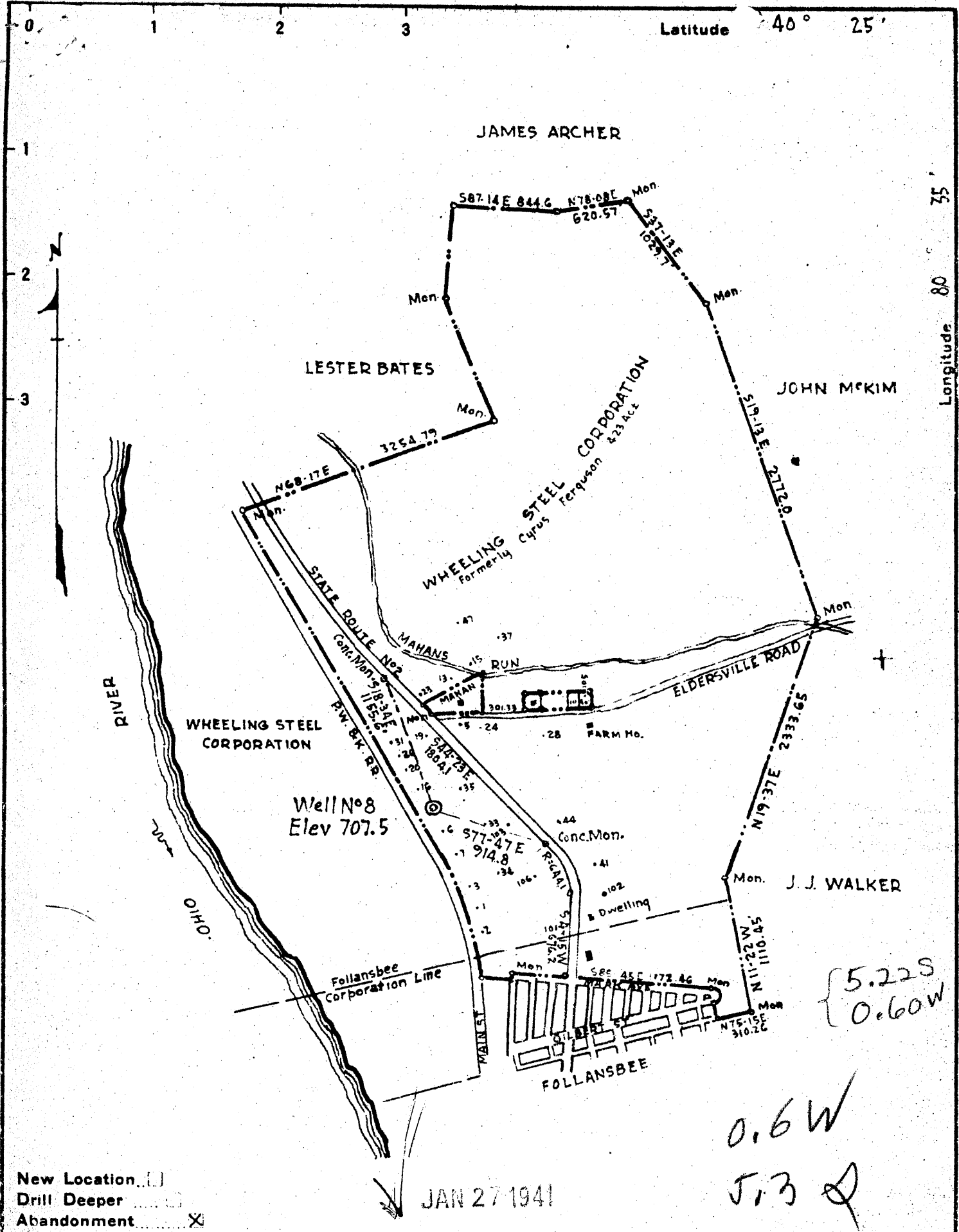

New Location
 Drill Deeper
 Abandonment

JAN 27 1941

Company	WHEELING STEEL CORPORATION
Address	(General Office) Wheeling, W. Va
Farm	Wheeling Steel Corporation { Formerly Cyrus Ferguson }
Tract	Acres 423 Lease No.
Well (Farm) No.	8 Serial No.
Elevation (Spirit Level)	707.5
Quadrangle	Steubenville
County	Brooke District Cross Creek
Engineer	Eugene M. Smith - C.C. Smith's Sons
Engineer's Registration No.	290
File No.	Drawing No.
Date	Jan. 16, 1941 Scale 1" = 1000'

STATE OF WEST VIRGINIA
 DEPARTMENT OF MINES
 OIL AND GAS DIVISION
 CHARLESTON

WELL LOCATION MAP
 FILE NO. **BRO-44A**

+ Denotes location of well on United States Topographic Maps, scale 1 to 62,500, latitude and longitude lines being represented by border lines as shown.

- Denotes one inch spaces on border line of original tracing.

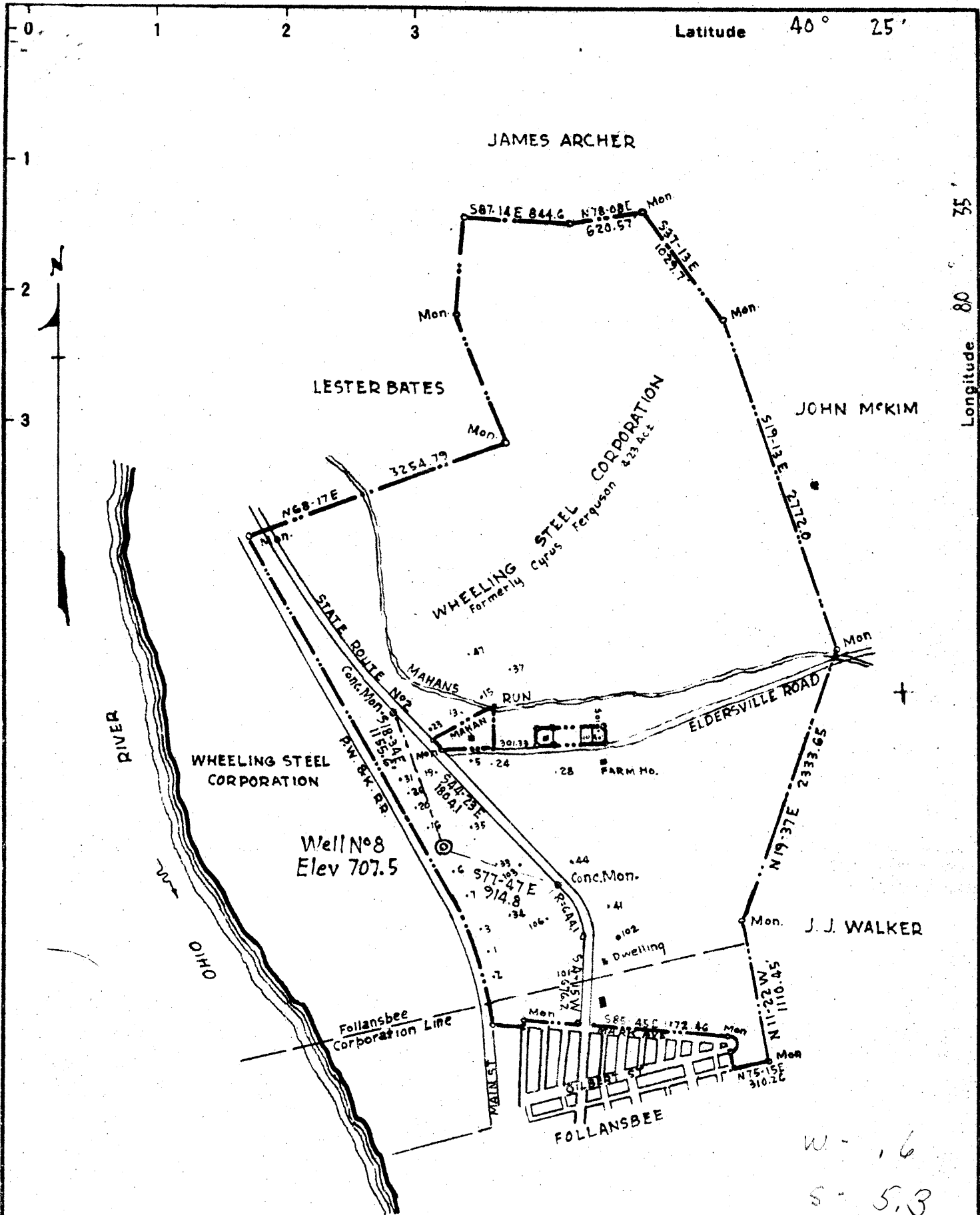

W - 1.6
S - 5.3

New Location
 Drill Deeper
 Abandonment

Company WHEELING STEEL CORPORATION
 Address (General Office) Wheeling, W. Va
 Farm Wheeling Steel Corporation { Formerly Cyrus Ferguson }
 Tract Acres 423 Lease No.
 Well (Farm) No. 8 Serial No.
 Elevation (Spirit Level) 707.5
 Quadrangle Stuebenville
 County Brooke District Cross Creek
 Engineer Eugene M. Smith - C.C. Smith's Sons
 Engineer's Registration No. 290
 File No. Drawing No.
 Date Jan. 16, 1941 Scale 1" = 1000'

STATE OF WEST VIRGINIA
 DEPARTMENT OF MINES
 OIL AND GAS DIVISION
 CHARLESTON

WELL LOCATION MAP
 FILE NO. BRO-64A

+ Denotes location of well on United States Topographic Maps, scale 1 to 62,500, latitude and longitude lines being represented by border lines as shown.
 - Denotes one inch spaces on border line of original tracing.