

JAMES ARCHER

LESTER BATES

JOHN McKIM

WHEELING STEEL CORPORATION
Formerly
Cyrus Ferguson 423 ac±

WHEELING STEEL CORPORATION

J. J. WALKER

FOLLANSBEE

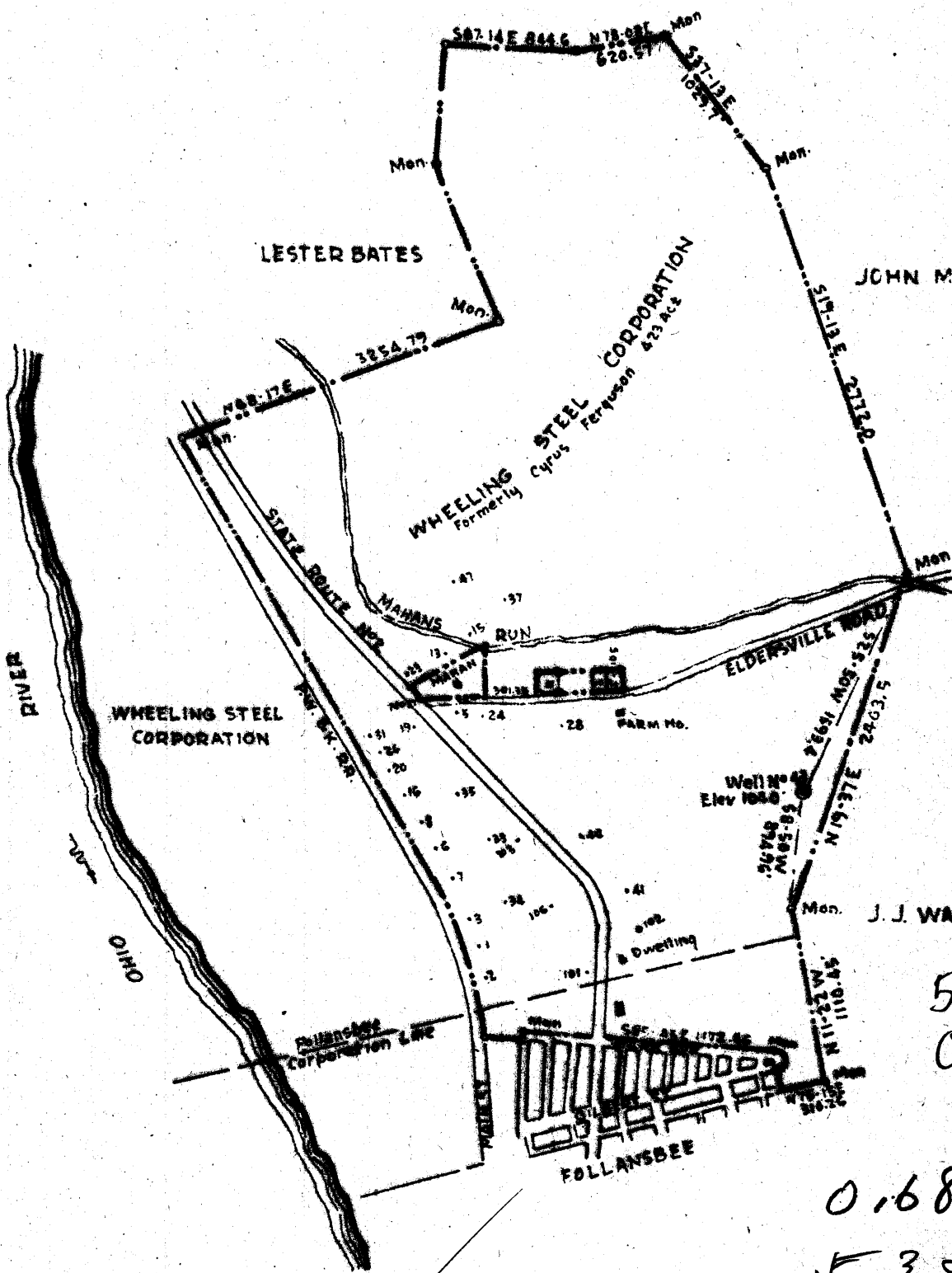

5.20S
0.58W

0.68W
V. 3

New Location
Drill Deeper
Abandonment

JUN 10 1940

Company WHEELING STEEL CORPORATION
 Address (General Office) Wheeling, W. Va.
 Farm Wheeling Steel Corporation Formerly Cyrus Ferguson
 Tract Acres 423 Lease No. _____
 Well (Farm) No. 43 Serial No. _____
 Elevation (Spirit Level) 1088.0
 Township Steubenville
 County Braxton District Cross Creek
 Engineer Eugene M. Smith - C.E. Smith's Sons
 Engineer's Registration No. 230
 File No. _____ Drawing No. _____

STATE OF WEST VIRGINIA
DEPARTMENT OF MINES
OIL AND GAS DIVISION
CHARLESTON

WELL LOCATION MAP
FILE NO. Beo-43A

⊕ Denotes location of well on United States Topographic Maps, scale 1 to 62,500, latitude and longitude lines being represented by border lines as shown.

— Denotes one inch square on border line of original map.

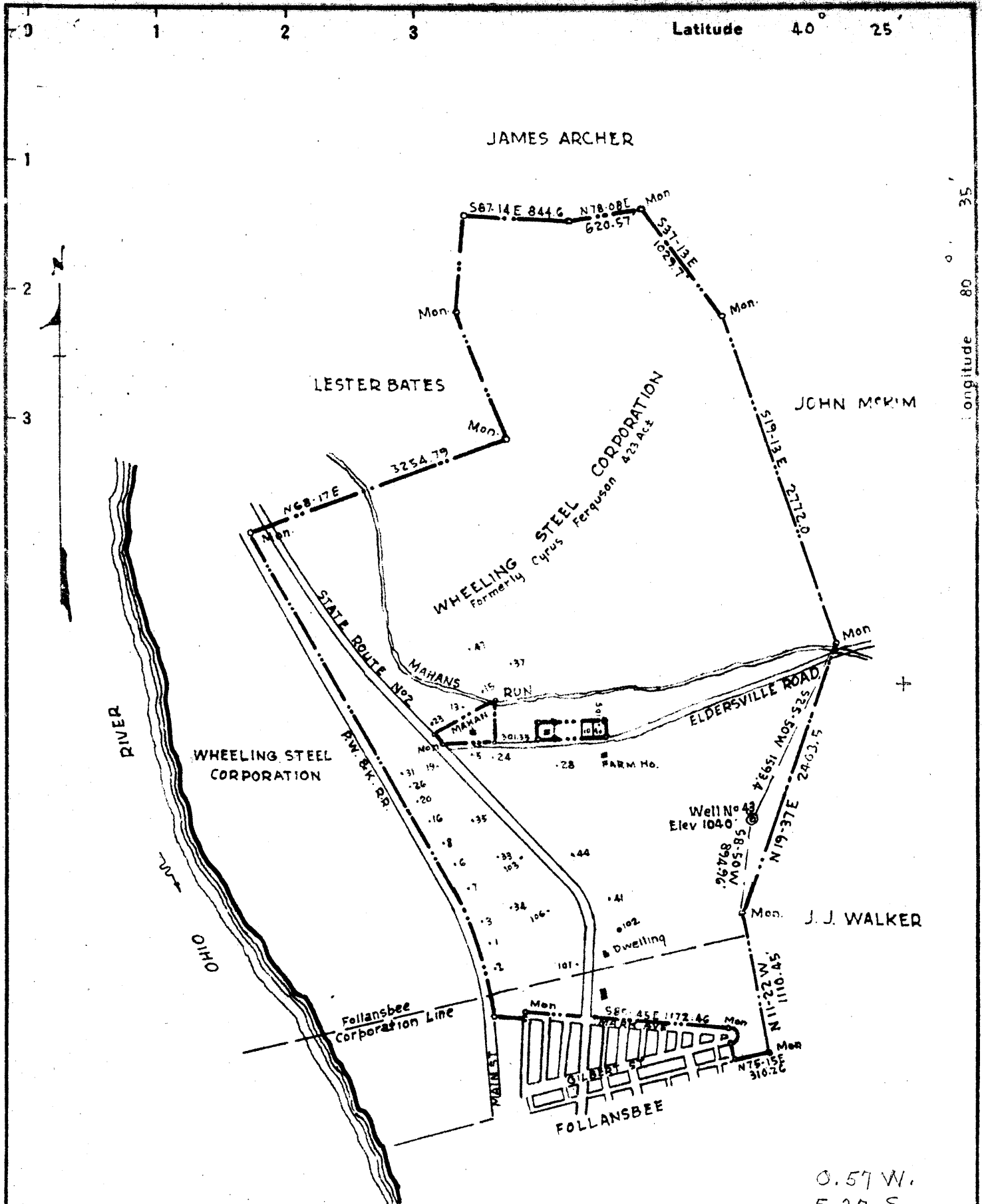

New Location
 Drill Deeper
 Abandonment

0.57 W.
 5.27 S.

Company	WHEELING STEEL CORPORATION
Address	(General Office) Wheeling, W. Va
Farm	Wheeling Steel Corporation { Formerly Cyrus Ferguson }
Tract	Acres 423 Lease No.
Well (Farm) No.	43 Serial No.
Elevation (Spirit Level)	1040.0'
Quadrangle	Steubenville
County	Brooke District Cross Creek
Engineer	Eugene M. Smith - C.C. Smith's sons
Engineer's Registration No.	290
File No.	Drawing No.
Date	May 28, 1940 Scale 1" = 1000'

STATE OF WEST VIRGINIA
 DEPARTMENT OF MINES
 OIL AND GAS DIVISION
 CHARLESTON

WELL LOCATION MAP
 FILE NO. BRO-43A

+ Denotes location of well on United States Topographic Maps, scale 1 to 62,500, latitude and longitude lines being represented by border lines as shown.
 - Denotes one inch spaces on border line of original tracing.