

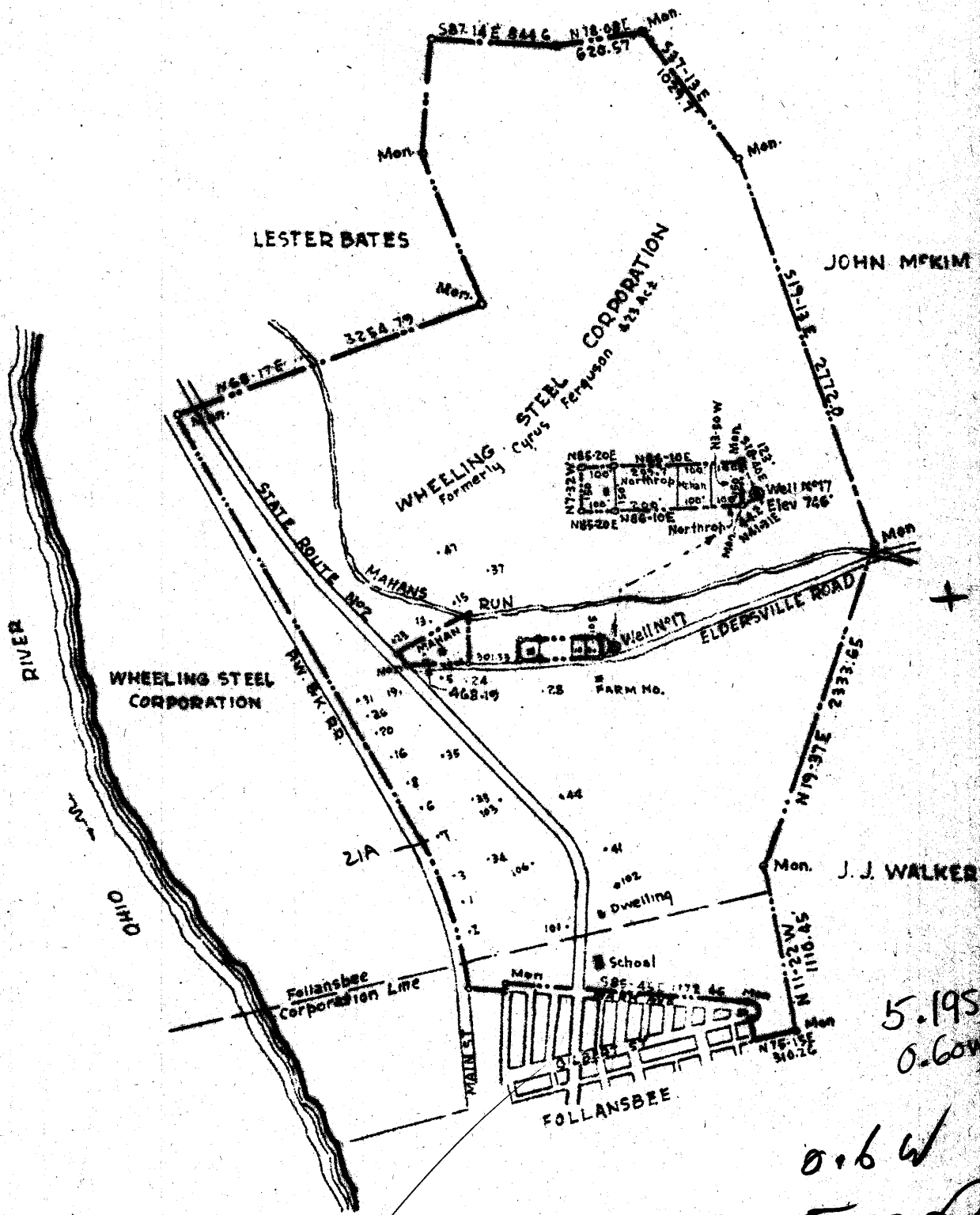

JAMES ARCHER



5.195  
0.60W

0.6W  
ring

JUN 10 1940

- New Location
- Drill Deeper
- Abandonment

Company	WHEELING STEEL CORPORATION		
Address	(General Office) Wheeling, W. Va.		
Farm	Wheeling Steel Corporation	Formerly	Cyrus Fergusson
Tract	Acres	423	Lease No.
Well (Farm) No.	17	Serial No.	
Elevation (Spirit Level)	748.0		
Quadrangle	Staubenville		
County	Brake	District	Cross Creek
Engineer	Eugene N. Smith - C.C. Smith's Sinal		
Engineer's Registration No.	278		
File No.	Drawing No.		

STATE OF WEST VIRGINIA  
DEPARTMENT OF MINES  
OIL AND GAS DIVISION  
CHARLESTON

WELL LOCATION MAP  
FILE NO. 300-42A

+ Denotes location of well on United States Topographic Maps; scale 1 to 62,500. Latitude and longitude lines being represented by border lines as shown.

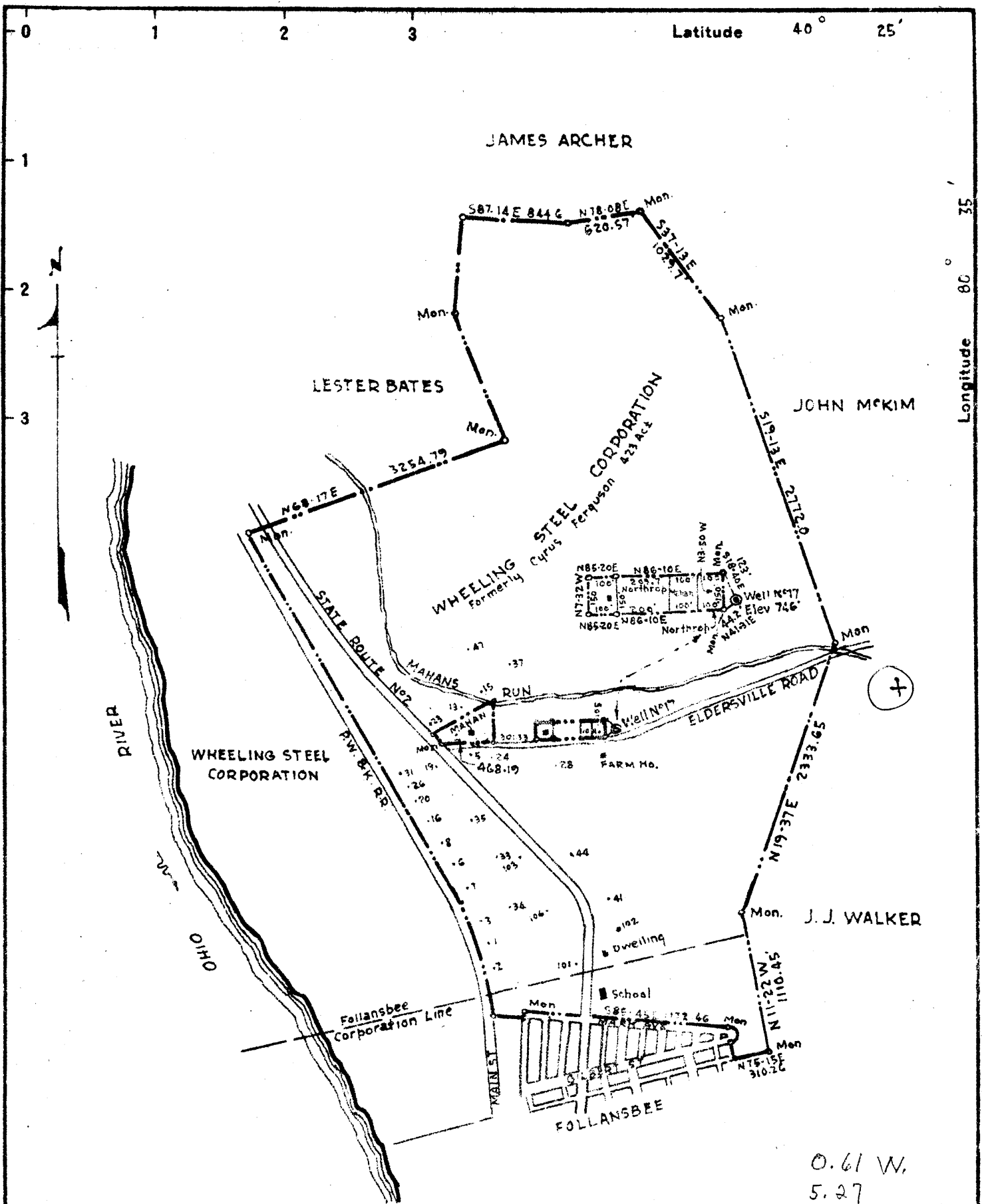

New Location   
 Drill Deeper   
 Abandonment

Company WHEELING STEEL CORPORATION  
 Address (General Office) Wheeling, W. Va  
 Farm Wheeling Steel Corporation { Formerly Cyrus Ferguson }  
 Tract            Acres 423 Lease No.             
 Well (Farm) No. 17 Serial No.             
 Elevation (Spirit Level) 746.0  
 Quadrangle Steubenville  
 County Brooke District Cross Creek  
 Engineer Eugene M. Smith - C.C. Smith's Sons  
 Engineer's Registration No. 290  
 File No.            Drawing No.             
 Date May 10, 1940 Scale 1" = 1000'

STATE OF WEST VIRGINIA  
 DEPARTMENT OF MINES  
 OIL AND GAS DIVISION  
 CHARLESTON

**WELL LOCATION MAP**  
 FILE NO. Bro-42A

+ Denotes location of well on United States Topographic Maps, scale 1 to 62,500, latitude and longitude lines being represented by border lines as shown.  
 — Denotes one inch spaces on border line of original tracing.

0.61 W,  
 5.27