

40°15'00"

Latitude

80°35'00"

Longitude

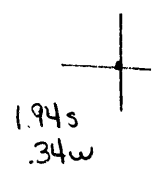

Topo Location

7.5' Loc. _____ 15' Loc. _____
 _____ (calc.) _____

Company Dunn Man O+G

Farm Winton Steel Co #1

15' Quad _____
(sec.)

7.5' Quad Bethany

District Buffalo

WELL LOCATION PLAT

County 009 **Permit** 30002

Buffalo Creek

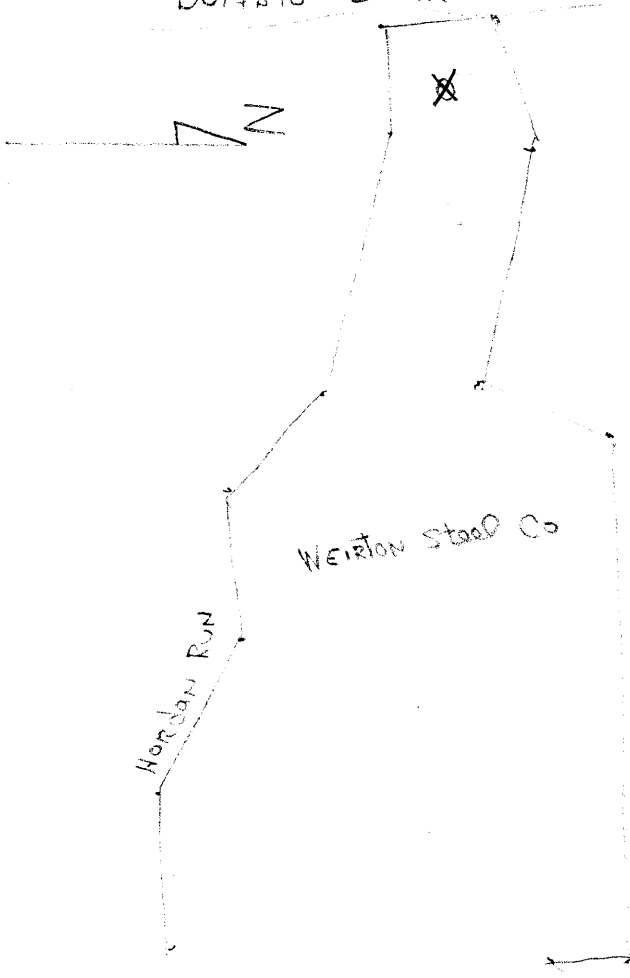

Brooke ZA

Buffalo District, Brooke County, W. Va. BRO-2-A
Dunn-mar Oil & Gas Co., Waynesburg, Pa. (John R. Conklin, Secy.)
On 120 acres, surface owned by Weirton Steel Co., Weirton, W. Va.,
and mineral rights by Mrs. P. G. Zinn, Pullman, W. Va.

Drilled in 1913.

Elevation, 732.15' L.

No record of casing.

No record of coal. Surface below coal.?

Abandonment reported to Dept. of Mines Oct. 11, 1930.

Preliminary sheet only filed. No record.

Write for completion data sheet No. 2.

WEIRTON STEEL CO. NO. 1 WELL.

No. 10 O.F.-Brooke.

Brooke 2A

Buffalo District, Brooke County, W. Va.

Dunn Mar Oil & Gas Co., Waynesburg, Pa. (John H. Conklin, Secy.)

On 120 acres, surface owned by Weirton Steel Co., Weirton, W. Va.,
and mineral rights by Mrs. P. G. Zimm, Pullman, W. Va.

Drilled in 1913.

Elevation, 732.15' L.

No record of casing.

No record of coal. Surface below coal.?

Abandonment reported to Dept. of Mines Oct. 11, 1930.

Preliminary sheet only filed. No record.

Write for completion data sheet No. 2.