

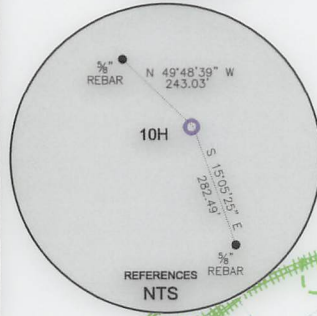

CIVIL & ENVIRONMENTAL CONSULTANTS, INC.
600 MARKETPLACE AVENUE, SUITE 200
BRIDGEPORT, WV 26330
304-933-3119



GRID NORTH
UTM, NAD83 DATUM, ZONE 17, US FT

SURFACE HOLE 10792'
BOTTOM HOLE 6394'

Top Hole Latitude: 40°17'30"
Bottom Hole Latitude: 40°15'00"

Bottom Hole Longitude: 80°35'00"
Top Hole Longitude: 80°35'00"

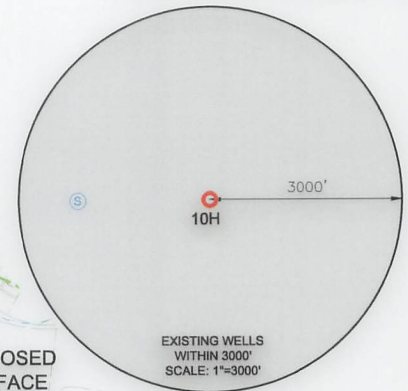

SURFACE HOLE LOCATION (SHL):
UTM (NAD83, ZONE 17, METERS): NORTHING: 4,455,775.425 EASTING: 532,147.647
LANDING POINT (LPL):
UTM (NAD83, ZONE 17, METERS): NORTHING: 4,456,689.626 EASTING: 532,129.204
TURNING POINT 1 LOCATION (TP1):
UTM (NAD83, ZONE 17, METERS): NORTHING: 4,454,260.179 EASTING: 533,129.855
TURNING POINT 2 LOCATION (TP2):
UTM (NAD83, ZONE 17, METERS): NORTHING: 4,453,645.564 EASTING: 533,240.467
BOTTOM HOLE LOCATION (BHL):
UTM (NAD83, ZONE 17, METERS): NORTHING: 4,452,966.358 EASTING: 533,500.721

WELL RESTRICTIONS

1. NO OCCUPIED DWELLINGS > 2500 SQ FT. WITHIN 625 FEET OF CENTER OF PAD.
2. NO AGRICULTURE BUILDINGS > 2500 SQ FT. WITHIN 625 FEET OF CENTER OF PAD.
3. WATER WELLS OR DEVELOPED SPRINGS ARE WITHIN 2,068 FEET OF PROPOSED WELL.
4. PERENNIAL STREAMS, LAKES, PONDS, OR RESERVOIRS WITHIN 800 FEET OF THE LIMITS OF DISTURBANCE.
5. NO NATURALLY PRODUCING TROUT STREAM WITHIN 300 FEET OF LIMITS OF DISTURBANCE.
6. NO GROUND INTAKE OR PUBLIC WATER SUPPLY WITHIN 1000 FEET OF WELL PAD, LIMITS OF DISTURBANCE, E & S CONTROLS OR PUBLIC WATER SUPPLY.

NOTES ON SURVEY

1. SURFACE AND ROYALTY OWNER INFORMATION AND THEIR BOUNDARIES SHOWN HEREON WERE PLOTTED FROM DEEDS AND/OR TAX PARCEL MAPS PROVIDED BY CLIENT AND/OR FIELD LOCATIONS.
2. THIS PLAT DOES NOT REPRESENT A BOUNDARY SURVEY OF THE PARCELS SHOWN HEREON.
4. ALL INSETS ARE GRID NORTH UNLESS OTHERWISE DEPICTED.

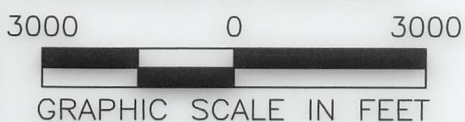

I, THE UNDERSIGNED, HEREBY CERTIFY THAT THIS PLAT IS CORRECT TO THE BEST OF MY KNOWLEDGE AND BELIEF AND SHOWS ALL THE INFORMATION REQUIRED BY LAW AND REGULATIONS ISSUED AND PRESCRIBED BY THE DEPARTMENT OF ENVIRONMENTAL PROTECTION.

P.S. 991 *Dennis E. Miller*

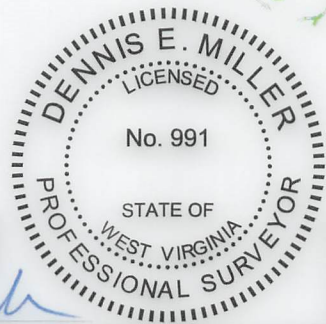

COMPANY:
SWN *Production Company, LLC* **SWN** *Production Company™*

<p>(+) DENOTES LOCATION OF WELL ON UNITED STATES TOPOGRAPHIC MAPS</p> <p>WVDEP OFFICE OF OIL & GAS 601 57TH STREET CHARLESTON, WV 25034</p>	<p>MINIMUM DEGREE OF ACCURACY: 1/200</p> <p>PROVEN SOURCE OF ELEVATION: SURVEY GRADE GPS (NAVD 88, US FT)</p>	<p>OPERATOR'S WELL #: VIOLET COSS BRK 10H</p> <p>API WELL #: 47 009 mod 00301 STATE COUNTY PERMIT</p>
---	---	---

WELL TYPE: OIL WASTE DISPOSAL PRODUCTION DEEP GAS LIQUID INJECTION STORAGE SHALLOW

WATERSHED: UPPER OHIO WHEELING ELEVATION: 1172.5'

DISTRICT: BUFFALO COUNTY: BROOKE QUADRANGLE: STEUBENVILLE EAST

SURFACE OWNER: LINDA COEN (LIFE ESTATE-VIOLET L COSS) ACREAGE: 224.303±

OIL & GAS ROYALTY OWNER: VIOLET L COSS ACREAGE: 224.303±

DRILL DRILL DEEPER REDRILL FRACTURE OR STIMULATE PLUG OFF OLD FORMATION PERFORATE NEW FORMATION

CONVERT PLUG & ABANDON CLEAN OUT & REPLUG OTHER CHANGE (SPECIFY)

TARGET FORMATION: MARCELLUS ESTIMATED DEPTH: 5,831.9 TVD 20,675.91 TMD

WELL OPERATOR: SWN PRODUCTION COMPANY, LLC	DESIGNATED AGENT: BRITTANY WOODY
ADDRESS: 1300 FORT PIERPONT DRIVE, STE 201	ADDRESS: 1300 FORT PIERPONT DRIVE, STE 201
CITY: MORGANTOWN STATE: WV ZIP CODE: 26508	CITY: MORGANTOWN STATE: WV ZIP CODE: 26508

LEGEND:	— SURVEYED BOUNDARY	REVISIONS:	DATE: 11-18-2019
○ PROPOSED SURFACE HOLE / BOTTOM HOLE	— DRILLING UNIT	▲ REVISED LAT AND LONG 02-05-2020	DRAWN BY: K.E.S.
⊙ EXISTING / PRODUCING WELLHEAD	==== LEASE BOUNDARY	▲ REVISED LATERAL 03-11-2020	SCALE: 1" = 3000'
LPL* LANDING POINT LOCATION	— PROPOSED PATH		DRAWING NO: 172-287
⊙ EXISTING WATER WELL	TP* TURNING POINT LOCATION		WELL LOCATION PLAT
⊙ EXISTING SPRING			



CIVIL & ENVIRONMENTAL CONSULTANTS, INC.
 600 MARKETPLACE AVENUE, SUITE 200
 BRIDGEPORT, WV 26330
 304-933-3119

WELL BORE TABLE FOR SURFACE / ROYALTY OWNERS			
TRACT	SURFACE OWNER (S) / ROYALTY OWNER (R)	TAX PARCEL	ACRES
1	EVERETT ALAN COEN, LORRIE ELLEN WOOLWINE, MELINDA WOOLWINE, MICHAEL TODD COEN (S&R)	3-B32-25	224.303
2	HFS LIMITED LIABILITY COMPANY	3-B27-12	67.95
3	BROOKE CO. RT. 2		
4	WEST VIRGINIA DEPARTMENT OF HIGHWAYS	3-B27-11	
5	CAMPBELL TRANSPORTATION COMPANY, INC.	3-B27-10	12.48
6	STATE OF WEST VIRGINIA		
7	NORMA JEAN LILLY, WIDOW	3-B27-17	45.72
8	GERTRUDE LOUISE MCSHANE ROBIE & PATRICK J. MCSHANE, TRUSTEE	3-B32-29	84.79
9	TONY J. CASTILLO; RICHARD R. OSTRANDER (S)	3-B32-28	20.83
10	TONY J. CASTILLO; RICHARD R. OSTRANDER (S)	3-B32-27	10
11	GREEN RUN ROAD		
12	JAMES GEAR (S)	3-B32-11.01	1.00
13	PENNY HAMILTON	3-B32-11	8.50
14	SCHIAPPA & COMPANY, INC	3-B32-09	214.83
15	LILLIAN L. MCCORD EST.	3-B32-185	36.42
16	ROBERT G. TREDWAY JR.	3-B32-188	42.01
17	RONALD H. REINANCHER & KAREN L. MAHLEY	3-B32-187	2.0
18	CITY OF WELLSBURG COMBINED WATER AND SEWER BOARD	3-B32-140.2	0.21
19	KOSUT KEVIN D. & BRIDGET	3-B37-42	34.259
20	SCHIAPPA AND COMPANY, INC.	3-B37-22	145.963

ADJOINING OWNERS TABLE			
TRACT	SURFACE OWNER	TAX PARCEL	ACRES
A	DANIEL P. LOMBARDI	3-B27K-211	6.62
B	PAUL DAVID FORSYTHE & ALLEN LEE FORSYTHE	3-B27K-210	2.35
C	ROBERT C. III & RONICA L. CRISS (SURV)	3-B27K-206	0.25
D	ROBERT C. III & RONICA L. CRISS (SURV)	3-B27K-205	0.18
E	RANDY AND BRENDA WILLIAMS	3-B27K-204	0.16
F	RANDY AND BRENDA WILLIAMS	3-B27K-203	0.10
G	RANDY M. & BRENDA WILLIAMS (SURV)	3-B27K-202	0.19
H	JOHN J. FRISCO SR (3/8); JOSEPHINE IWANYSN (2/3)	3-B27K-189	0.5344
I	WILLIAM, CAROLYN AND JESSICA WALNOHA	3-B32-7	2
J	ROBIE GERTRUDE LOUISE MCSHANE	3-B27P-30	136.00
K	DAVID B. JONES	3-B32-8	9.1
L	GERTRUDE LOUISE MCSHANE ROBIE	3-B32-30	1.68
M	SCHIAPPA AND COMPANY INC	3-B32-10	8.82
N	MELANIE J. LUNSFORD	3-B32-72	1.74
O	WILLIAM WHEAT AND CARRIE HIGGS	3-B32-71	1.738
P	WILLIAM WHEAT AND CARRIE HIGGS	3-B32-70	1.739
Q	PATRICIA SAUVAGEOT AND GLORIA PRAMESA	3-B32-69	1.721
R	JAY D. & KAREN SUE RECK	3-B32-68	2.22
S	JOSEPH & JEFFREY P. JACKFERT (SURV)	3-B32-67	1.13
T	KAREN AND JAY RECK	3-B32G-67.01	15.645
U	HERBERT MCGOWAN	3-B32G-67	58.965
V	VEMURI HOME & GARDEN, LLC	3-B32G-1	2.22
W	KAY A. ELLIOTT	3-B32G-3	0.17
X	KAY A. ELLIOTT	3-B32G-4	0.221
Y	LARRY REED AND DEBORAH REED	3-B32G-5	1.43
Z	LARRY REED AND DEBORAH REED	3-B32G-6	.892
AA	ROBERT F. & ANNA OHLER	3-B32G-7	0.74
BB	JOHN H. FOX	3-B32G-8	0.36
CC	JAMES AND ANNETTE BEST	3-B32G-9	0.52
DD	FEDERAL NATIONAL MORTGAGE ASSOCIATION	3-B32G-10	0.38
EE	MATHEW TOMSHACK	3-B32G-11	0.39
FF	MATHEW TOMSHACK	3-B32-88	1.21
GG	PAUL W. & SUSAN A. FODOR	3-B32-89	3.5
HH	KAREN L. REINACHER	3-B32-96	88.953
II	DAVID MCGOWAN	3-B32-190	6.27
JJ	DONALD C. BURKHART	3-B32-191	7.24
KK	ROBERT G. TREDWAY JR.	3-B32-189	1.01
LL	CHARLES M. & BARBARA J. TREDWAY	3-B32-186	3.0
MM	KURT YANO, FRANK YANO AND KATHERINE YANO	3-B32-40	0.757
NN	RALPH G. JOHNSTON; ROBERT JOHNSTON; KENNETH D. JOHNSTON, DANIEL JOHNSTON, ET AL	3-B32-180	39.862

ADJOINING OWNERS TABLE			
TRACT	SURFACE OWNER	TAX PARCEL	ACRES
OO	MASLO FARMS LLC A PENNSYLVANIA LLC	3-B32-19	59.66
PP	JOSEPH & MARY VIDERMAN	3-B32-13	43.38
QQ	PENNY HAMILTON	3-B32-12	.50
RR	JAMES SCOTT GEAR	3-B32-26	3.11
SS	WILLIAM & CAROLYN WALNOHA (SURV)	3-B32-14	1.34
TT	JOHN PORTER; BRIGITTE ROGERS (SURV)	3-B32-15	.568
UU	DOROTHY L. STEVENS	3-B32-16	2.09
VV	RUTH BERNADINE HART	3-B32-22.01	0.262
WW	WALNOHA WILLIAM RUSSELL; HART RUTH; THARP MARY FRANC	3-B32-22	0.244
XX	WILLIAM RUSSELL WALNOHA	3-B32-22.02	0.259
YY	HFS LIMITED LIABILITY COMPANY	3-B32-23	2
ZZ	HFS LIMITED LIABILITY COMPANY	3-B32-24	2
AAA	COSS ROAD FARM, LLC	3-B31-114	183.23
BBB	JAMES L. & SONDR A. ELLIOTT	3-B31-121	5.48
CCC	HFS LIMITED LIABILITY COMPANY	3-B31-1	23.87
DDD	CAMPBELL TRANSPORTATION COMPANY INC	3-B27-8	0.41
EEE	GREG PROVENZANO	3-B27-9	0.09
FFF	LIZON JOSEPH P. III & NIXON ERIN REBECCA (SURV)	3-B32-192	19.40
GGG	UHLLY REBECCA L.	3-B32-139	27.805
HHH	COLLINS KEVIN R. & SANDRA A. (SURV)	3-B32-130	24.04
III	OHLER JAMIE L.	3-B37-43	29.00
JJJ	CHRISTMAN MARK A.	3-B37-45	110.58
KKK	JOHNSTON WILLIAM E. & HAZEL E. (SURV)	3-B37-50	166.50
LLL	SCHIAPPA AND COMPANY INC	3-B37-23	90.91
MMM	LOUGHERY VICKIE C. & SHEENA R. (SURV)	3-B37-103	40.00
NNN	WALNOHA RALPH JR. & CAROL J.	3-B37-34	6.787
OOO	WALNOHA RALPH JR. & CAROL J.	3-B37-33	0.80
PPP	GIBSON JAMES W. & LISA (SURV)	3-B37-28	4.06
QQQ	LEMASTERS HARLEY J.	3-B37-21	31.17
RRR	CARBASHO THOMAS & CAROLYN (SURV)	3-B37-16	7.29
SSS	CARBASHO THOMAS & CAROLYN (SURV)	3-B37-15	5.00
TTT	MYERS JAMES W. & DENISE L. (SURV)	3-B37-14	5.00
UUU	LEMASTERS HARLEY J.	3-B37-13	33.54
VVV	BOYD NILA; MCCORD CLINTON; JOHN JOHN; REBA; JONES CA	3-B32-146	29.057
WWW	BOYD DAVID SMITH & NILA MCCORD	3-B32-142	5.09
XXX	JOHNSTON KENNETH D.	3-B32-141	4.91

API WELL #: **47** **009** *mod*
 STATE COUNTY PERMIT **00301**

REVISIONS: ▲ REVISED LAT AND LONG 02-05-2020 ▲ REVISED LATERAL 03-11-2020	COMPANY: 	DATE: 11-18-2019
	OPERATOR'S VIOLET COSS BRK	DRAWN BY: K.E.S.
	WELL #: 10H	SCALE: N/A
	DISTRICT: BUFFALO	DRAWING NO: 172-287
	COUNTY: BROOKE	WELL LOCATION PLAT 2
	STATE: WV	