



west virginia department of environmental protection

Office of Oil and Gas
601 57th Street, S.E.
Charleston, WV 25304
(304) 926-0450
fax: (304) 926-0452

Austin Caperton, Cabinet Secretary
www.dep.wv.gov

Tuesday, April 28, 2020
PERMIT MODIFICATION APPROVAL
Horizontal 6A / New Drill

SWN PRODUCTION COMPANY, LLC
POST OFFICE BOX 12359

SPRING, TX 773914954

Re: Permit Modification Approval for VIOLET COSS BRK 10H
47-009-00301-00-00

Modified lateral with additional leases to a TMD of 20,676'

SWN PRODUCTION COMPANY, LLC

The Office of Oil and Gas has reviewed the attached permit modification for the above referenced permit. The attached modification has been approved and well work may begin. Please be reminded that the oil and gas inspector is to be notified twenty-four (24) hours before permitted well work is commenced.

If there are any questions, please feel free to contact me at (304) 926- 0450.

James A. Martin
Chief

Operator's Well Number: VIOLET COSS BRK 10H
Farm Name: LINDA COEN (LIFE ESTATE-VIOLET COSS)
U.S. WELL NUMBER: 47-009-00301-00-00
Horizontal 6A New Drill
Date Modification Issued: April 28, 2020

Promoting a healthy environment.

STATE OF WEST VIRGINIA
DEPARTMENT OF ENVIRONMENTAL PROTECTION, OFFICE OF OIL AND GAS
WELL WORK PERMIT APPLICATION

1) Well Operator: SWN Production Co., LLC 494512924 009-Brook 01-Buffalo 620-Steubenville
Operator ID County District Quadrangle

2) Operator's Well Number: Violet Coss BRK 10H Well Pad Name: Violet Coss BRK

3) Farm Name/Surface Owner: Linda Coen (Life Estate-Violet L Coss) Public Road Access: Coss Road

4) Elevation, current ground: 1173' Elevation, proposed post-construction: 1173'

5) Well Type (a) Gas Oil Underground Storage
Other

(b) If Gas Shallow Deep
Horizontal

6) Existing Pad: Yes or No Yes

C. Hill 3-20-20

7) Proposed Target Formation(s), Depth(s), Anticipated Thickness and Expected Pressure(s):
Target Formation- Marcellus, Down-Dip Well to the South, Target Top TVD- 5792', Target Base TVD- 5854', Anticipated Thickness- 62'. Associated Pressure- 3805

8) Proposed Total Vertical Depth: 5832'

9) Formation at Total Vertical Depth: Marcellus

10) Proposed Total Measured Depth: 20,676'

11) Proposed Horizontal Leg Length: 11,010.83

12) Approximate Fresh Water Strata Depths: 334'

13) Method to Determine Fresh Water Depths: Deepest Nearby Springs

14) Approximate Saltwater Depths: 507' Princeton High Salinity Sandstone & Salinity Profile Calculation (Violet Coss 47-009-00146)
RECEIVED
Office of Oil and Gas

15) Approximate Coal Seam Depths: 209' **MAR 24 2020**

16) Approximate Depth to Possible Void (coal mine, karst, other): Possible Void 209'
WV Department of Environmental Protection

17) Does Proposed well location contain coal seams directly overlying or adjacent to an active mine? Yes No

(a) If Yes, provide Mine Info: Name: _____
Depth: _____
Seam: _____
Owner: _____

WW-6B
(04/15)

API NO. 47- 009 - 00301 mod
 OPERATOR WELL NO. Violet Coss BRK 10H
 Well Pad Name: Violet Coss BRK

18)

CASING AND TUBING PROGRAM

TYPE	Size (in)	New or Used	Grade	Weight per ft. (lb/ft)	FOOTAGE: For Drilling (ft)	INTERVALS: Left in Well (ft)	CEMENT: Fill-up (Cu. Ft.)/CTS
Conductor	20"	New	H-40	94#	100'	100'	CTS
Fresh Water	13 3/8"	New	H-40	48#	388'	388'	585 sx/CTS
Coal	See	Surface	Casing				
Intermediate	9 5/8"	New	J-55	36#	1630'	1630'	635 sx/CTS
Production	5 1/2"	New	HCP-110	20#	20,676'	20,676'	
Tubing							
Liners							

C. R. L. 3-20-20

TYPE	Size (in)	Wellbore Diameter (in)	Wall Thickness (in)	Burst Pressure (psi)	Anticipated Max. Internal Pressure (psi)	Cement Type	Cement Yield (cu. ft./k)
Conductor	20"	30"	0.25	2120	81	Class A	1.19/50% Excess
Fresh Water	13 3/8"	17.5"	0.380	2740	633	Class A	1.19/50% Excess
Coal	See	Surface	Casing				
Intermediate	9 5/8"	12 1/4"	0.395	3950	1768	Class A	1.19/50% Excess
Production	5 1/2"	8 3/4"	0.361	12360	9500	Class A	1.20/50% Excess
Tubing							
Liners							

RECEIVED
Office of Oil and Gas

MAR 24 2020

PACKERS

WV Department of Environmental Protection

Kind:				
Sizes:				
Depths Set:				

19) Describe proposed well work, including the drilling and plugging back of any pilot hole:

Drill and stimulate any potential zones between and including the Benson to Marcellus. **If we should encounter a void place basket above and below void area- balance cement to bottom of void and grout from basket to surface or run external casing packer/cementing stage tool above void interval and perform 2 stage cementing operation dependent upon depth of void. Run casing not less than 20' below void nor more than 75' below void. (*If freshwater is encountered deeper than anticipated it must be protected, set casing 50' below and cts.)

20) Describe fracturing/stimulating methods in detail, including anticipated max pressure and max rate:

Well will be perforated within the target formation and stimulated with a slurry of water, sand, and chemical additives at a high rate. This will be performed in stages with the plug and perf method along the wellbore until the entire lateral has been stimulated within the target formation. All stage plugs are then drilled out and the well is flowed back to surface. The well is produced through surface facilities consisting of high pressure production unites, horizontal separation units, water and oil storage tanks. Max press and anticipated max rate- 9000 lbs @ 100 barrels a minute.

21) Total Area to be disturbed, including roads, stockpile area, pits, etc., (acres): 7.09

22) Area to be disturbed for well pad only, less access road (acres): 5.91

23) Describe centralizer placement for each casing string:

All casing strings will be ran with a centralizer at a minimum of 1 per every 3 joints of casing.

24) Describe all cement additives associated with each cement type:

See Attachment ***

RECEIVED
Office of Oil and Gas
MAR 24 2020
WV Department of
Environmental Protection

25) Proposed borehole conditioning procedures:

All boreholes will be conditioned with circulation and rotation for a minimum of one bottoms up and continuing until operator is satisfied with borehole conditions.

*Note: Attach additional sheets as needed.

Southwestern Energy Company			Proposed Drilling Program		
Well:	VIOLET COSS BRK 10		Re-entry Rig:	TBD	
Field:	PANHANDLE FIELD WET		Prospect:	PANHANDLE	
County:	BROOKE		State:	WV	
SHL:	40.2518 Latitude	-80.6220 Longitude			
BHL:	40.2265 Latitude	-80.6062 Longitude			
KB Elev:	1,199 ft MSL	KB: 26 ft AGL	GL Elev:	1,173 ft MSL	

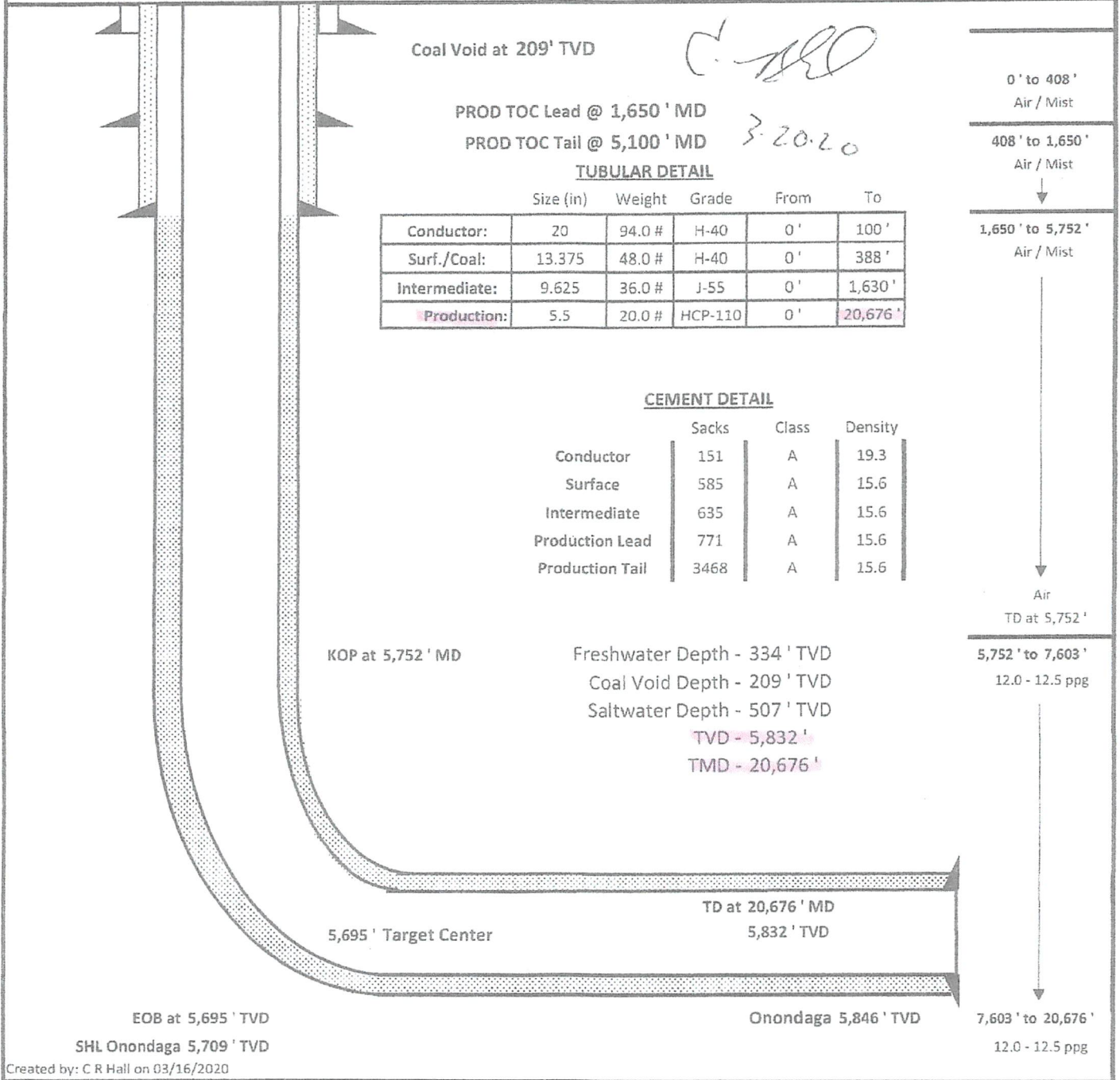

Coal Void at 209' TVD

PROD TOC Lead @ 1,650' MD

PROD TOC Tail @ 5,100' MD

3-20-20

TUBULAR DETAIL

	Size (in)	Weight	Grade	From	To
Conductor:	20	94.0 #	H-40	0'	100'
Surf./Coal:	13.375	48.0 #	H-40	0'	388'
Intermediate:	9.625	36.0 #	J-55	0'	1,630'
Production:	5.5	20.0 #	HCP-110	0'	20,676'

CEMENT DETAIL

	Sacks	Class	Density
Conductor	151	A	19.3
Surface	585	A	15.6
Intermediate	635	A	15.6
Production Lead	771	A	15.6
Production Tail	3468	A	15.6

RECEIVED
Office of Oil and Gas

MAR 24 2020

WV Department of
Environmental Protection

Created by: C R Hall on 03/16/2020

RECEIVED
Office of Oil and Gas

MAR 24 2020

WV Department of
Environmental Protection

WW-6A1
(5/13)

Operator's Well No. Violet Coss
BRK 10H

**INFORMATION SUPPLIED UNDER WEST VIRGINIA CODE
Chapter 22, Article 6A, Section 5(a)(5)
IN LIEU OF FILING LEASE(S) AND OTHER CONTINUING CONTRACT(S)**

Under the oath required to make the verification on page 1 of this Notice and Application, I depose and say that I am the person who signed the Notice and Application for the Applicant, and that –

- (1) the tract of land is the same tract described in this Application, partly or wholly depicted in the accompanying plat, and described in the Construction and Reclamation Plan;
- (2) the parties and recordation data (if recorded) for lease(s) or other continuing contract(s) by which the Applicant claims the right to extract, produce or market the oil or gas are as follows:

Lease Name or Number	Grantor, Lessor, etc.	Grantee, Lessee, etc.	Royalty	Book/Page
-------------------------	-----------------------	-----------------------	---------	-----------

See Exhibit A

**Acknowledgement of Possible Permitting/Approval
In Addition to the Office of Oil and Gas**

The permit applicant for the proposed well work addressed in this application hereby acknowledges the possibility of the need for permits and/or approvals from local, state, or federal entities in addition to the DEP, Office of Oil and Gas, including but not limited to the following:

- WV Division of Water and Waste Management
- WV Division of Natural Resources WV Division of Highways
- U.S. Army Corps of Engineers
- U.S. Fish and Wildlife Service
- County Floodplain Coordinator

The applicant further acknowledges that any Office of Oil and Gas permit in no way overrides, replaces, or nullifies the need for other permits/approvals that may be necessary and further affirms that all needed permits/approvals should be acquired from the appropriate authority before the affected activity is initiated.

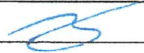
Well Operator: SWN Production Co., LLC
 By: 
 Its: Gary Nuckolls, Staff Landman

9-00301M00

Attached to and made a part of the State of West Virginia Oil and Gas Permit Form, WW-6A1, by SWN Production Company, LLC, as Operator
 EXHIBIT A
 Violet Coss BRK 10H
 Brooke County, West Virginia

8	03-0B32-0029-0000-0000	Lisa J. Packard	SWN Production Company, LLC	18%	33/618
		Lisa M. Brichta	SWN Production Company, LLC	18%	35/691
		Gertrude Louise McShane Robie	SWN Production Company, LLC	18%	33/605
9	03-0B32-0028-0000-0000	Charles David Blackburn	SWN Production Company, LLC	14%	40/616
		Christopher Reason Blackburn	SWN Production Company, LLC	14%	40/621
		Diane Melching Blackburn	SWN Production Company, LLC	14%	40/631
		Donna Chadwick	SWN Production Company, LLC	14%	41/330
		Edward Eugene Blackburn	SWN Production Company, LLC	14%	40/626
		Luanna Martindill	SWN Production Company, LLC	14%	42/154
		Phillip Simmons	SWN Production Company, LLC	15%	41/413
		Richard R. Ostrander	Chesapeake Appalachia, LLC	18%	21/443
		Roxann E. Hedimond	SWN Production Company, LLC	18%	30/480
		Ruth C. Starr	SWN Production Company, LLC	18%	41/438
		Scott Andrew Blackburn	SWN Production Company, LLC	14%	41/453
		Tony J. Castillo	SWN Production Company, LLC	14%	41/463
		Tyler Joseph Blackburn	Chesapeake Appalachia, LLC	18%	20/788
			SWN Production Company, LLC	18%	30/480
			SWN Production Company, LLC	14%	41/632
	Wyonna Vandruff Bassett	SWN Production Company, LLC	14%	40/636	

RECEIVED
 Office of Oil and Gas
 MAR 24 2020
 WV Department of
 Environmental Protection

EXHIBIT A

Attached to and made a part of the State of West Virginia Oil and Gas Permit Form, WW-6A1, by SWN Production Company, LLC, as Operator
 Violet Coss BRK 10H
 Brooke County, West Virginia

10	03-0B32-0027-0000-0000	Charles David Blackburn	SWN Production Company, LLC	14%	41/290
		Christopher Reason Blackburn	SWN Production Company, LLC		
		Diane Melching Blackburn	SWN Production Company, LLC	14%	41/320
		Donna Chadwick	SWN Production Company, LLC	14%	41/330
		Edward Eugene Blackburn	SWN Production Company, LLC	14%	41/667
		Luanna Martindill	SWN Production Company, LLC	17%	42/154
		Phillip Simmons	SWN Production Company, LLC	15%	41/413
		Richard R. Ostrander	Chesapeake Appalachia, LLC SWN Production Company, LLC	18%	21/785 30/480
		Roxann E. Hedmond	SWN Production Company, LLC	18%	41/438
		Ruth C. Starr	SWN Production Company, LLC	18%	41/453
		Scott Andrew Blackburn	SWN Production Company, LLC	14%	41/468
		Tony J. Castillo	Chesapeake Appalachia, LLC SWN Production Company, LLC	18%	21/292 30/480
		Tyler Joseph Blackburn	SWN Production Company, LLC	14%	41/632
		Wyonna Vandruff Bassett	SWN Production Company, LLC	14%	41/652
		Charles Alvin Russell	SWN Production Company, LLC	18%	49/730
11	Green Run Road	RIGHT OF WAY ONLY			
12	03-0B32-0011-0001-0000	Penny L. Hamilton	SWN Production Company, LLC	16%	41/378
13	03-0B32-0011-0000-0000	Penny L. Hamilton	Chesapeake Appalachia, LLC	18%	22/266

RECEIVED
 Office of Oil and Gas
 MAR 24 2020
 WV Department of
 Environmental Protection

9-00301MOD

EXHIBIT A

Attached to and made a part of the State of West Virginia Oil and Gas Permit Form, WW-6A1, by SWN Production Company, LLC, as Operator
 Violet Coss BRK 10H
 Brooke County, West Virginia

14	03-0B32-0009-0000-0000	Schiappa and Company, Inc.	SWN Production Company, LLC SWN Production Company, LLC	15.5%	30/480 33/356
15	03-0B32-0185-0000-0000	Joyce A. Brady Brian W. Johnston Daniel L. Johnston Kenneth D. Johnston Ralph G. Johnston Robert A. Johnston	Chesapeake Appalachia, LLC SWN Production Company, LLC Chesapeake Appalachia, LLC SWN Production Company, LLC Chesapeake Appalachia, LLC SWN Production Company, LLC Chesapeake Appalachia, LLC SWN Production Company, LLC	18%	29/792 30/480 30/7 30/480 30/13 30/480 30/26 30/480 21/711 30/480 21/716 30/480
16	3-B32-188	Robert G. Tredway, Jr.	Chesapeake Appalachia, LLC SWN Production Company, LLC	12.5%	26/585 30/480
17	3-B32-187	Theresa Ann McCloud Donna Blackburn	Chesapeake Appalachia, LLC SWN Production Company, LLC	12.5%	26/511 33/492 26/516 33/492
18	3-B32-140.2	Ronald H. Reinacher and Karen L. Reinacher Edward C. Zatta and Susan Zatta	Chesapeake Appalachia, LLC SWN Production Company, LLC	14.0%	10/752 30/480
18	3-B37-42	Marilyn Rosetta McCord Ina Grace Walker James C. Ditty Ina McCord Walker	Great Lakes Energy Partners, L.L.C. Chesapeake Appalachia, LLC SWN Production Company, LLC Chesapeake Appalachia, LLC SWN Production Company, LLC Chesapeake Appalachia, LLC SWN Production Company, LLC Chesapeake Appalachia, LLC SWN Production Company, LLC	12.5%	10/55 10/552 30/480 18/254 30/480 18/265 30/480 18/260 30/480
20	3-B37-22	Schiappa and Company, Inc.	Chesapeake Appalachia, LLC SWN Production Company, LLC	12.5%	10/468 30/480

RECEIVED
 Office of Oil and Gas
 MAR 24 2020
 WV Department of
 Environmental Protection



CIVIL & ENVIRONMENTAL CONSULTANTS, INC.
600 MARKETPLACE AVENUE, SUITE 200
BRIDGEPORT, WV 26330
304-933-3119

RECEIVED
Office of Oil and Gas

MAR 24 2020

WV Department of
Environmental Protection

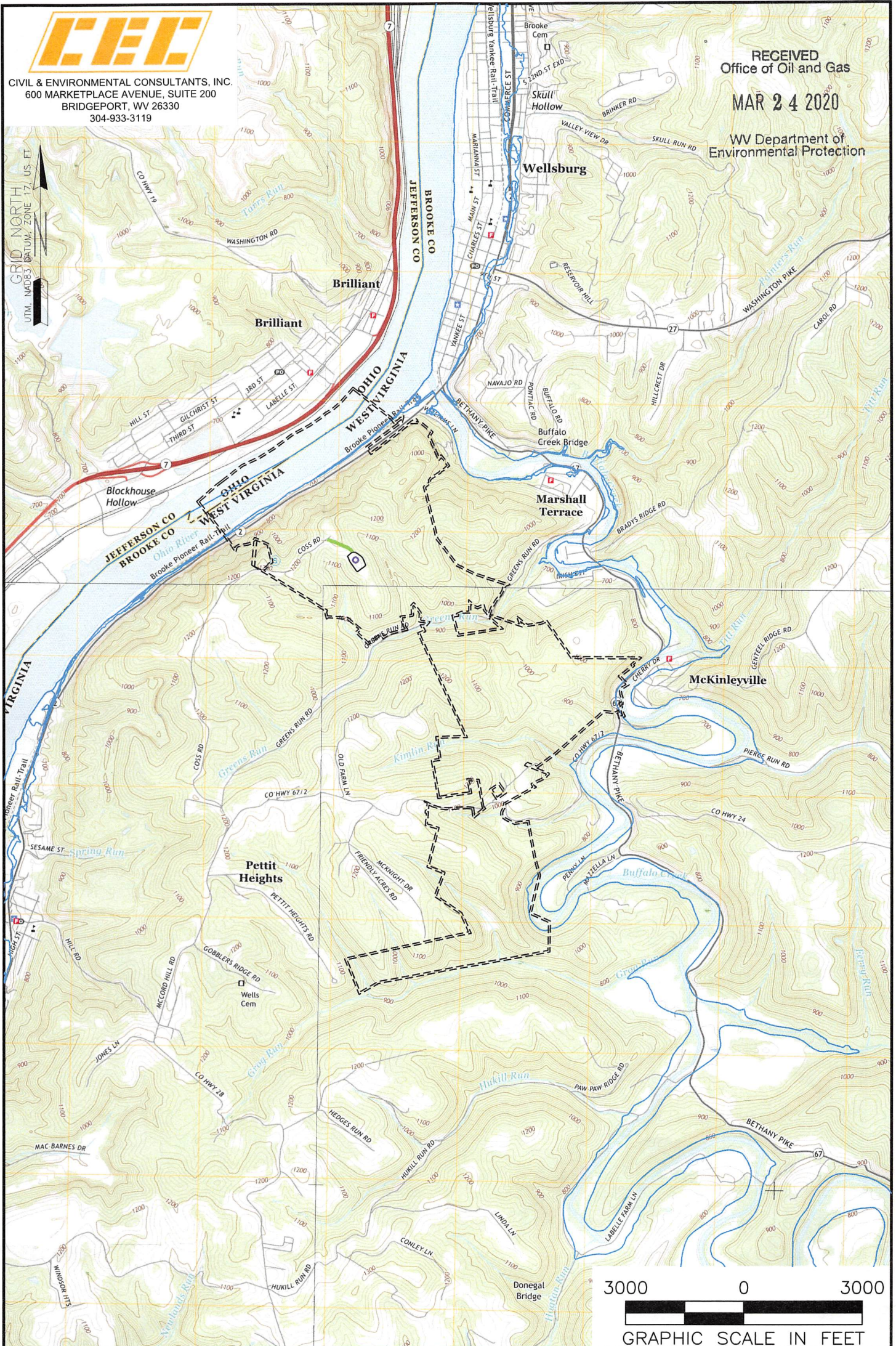

NOTES ON SURVEY

1. SURFACE AND ROYALTY OWNER INFORMATION AND THEIR BOUNDARIES SHOWN HEREON WERE PLOTTED FROM DEEDS AND/OR TAX PARCEL MAPS PROVIDED BY CLIENT AND/OR FIELD LOCATIONS.
2. THIS PLAT DOES NOT REPRESENT A BOUNDARY SURVEY OF THE PARCELS SHOWN HEREON.
3. ALL INSETS ARE GRID NORTH UNLESS OTHERWISE DEPICTED.

LEGEND:

- PROPOSED SURFACE HOLE / BOTTOM HOLE
- ACCESS ROAD
- PUBLIC ROAD
- ACCESS ROAD TO PREV. SITE
- EXISTING / PRODUCING WELLHEAD
- LEASE BOUNDARY
- PROPOSED PATH
- LPL* LANDING POINT LOCATION
- FLOOD PLAIN

WELL OPERATOR: SWN PRODUCTION COMPANY, LLC	WELL (FARM) NAME: VIOLET COSS BRK	WELL # 10H	SERIAL # XXXX
ADDRESS: 1300 FORT PIERPONT DRIVE, STE 201 MORGANTOWN, WV 26508	COUNTY - CODE BROOKE - 009	DISTRICT; BUFFALO	
SURFACE OWNER: LINDA COEN (LIFE ESTATE-VIOLET L COSS)	USGS 7 1/2 QUADRANGLE MAP NAME STEBENVILLE EAST, WV		



CIVIL & ENVIRONMENTAL CONSULTANTS, INC.
600 MARKETPLACE AVENUE, SUITE 200
BRIDGEPORT, WV 26330
304-933-3119

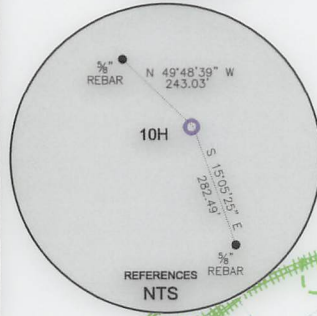

GRID NORTH
UTM, NAD83 DATUM, ZONE 17, US FT

SURFACE HOLE 10792'
BOTTOM HOLE 6394'

Top Hole Latitude: 40°17'30"
Bottom Hole Latitude: 40°15'00"

Bottom Hole Longitude: 80°35'00"
Top Hole Longitude: 80°35'00"

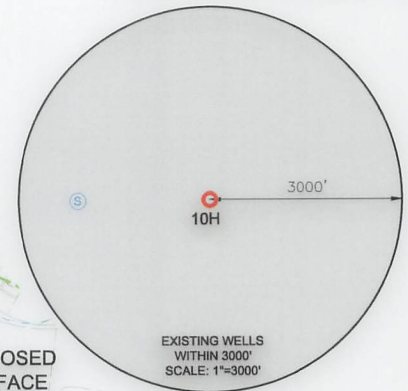

SURFACE HOLE LOCATION (SHL):
UTM (NAD83, ZONE 17, METERS): NORTHING: 4,455,775.425 EASTING: 532,147.647
LANDING POINT (LPL):
UTM (NAD83, ZONE 17, METERS): NORTHING: 4,456,689.626 EASTING: 532,129.204
TURNING POINT 1 LOCATION (TP1):
UTM (NAD83, ZONE 17, METERS): NORTHING: 4,454,260.179 EASTING: 533,129.855
TURNING POINT 2 LOCATION (TP2):
UTM (NAD83, ZONE 17, METERS): NORTHING: 4,453,645.564 EASTING: 533,240.467
BOTTOM HOLE LOCATION (BHL):
UTM (NAD83, ZONE 17, METERS): NORTHING: 4,452,966.358 EASTING: 533,500.721

WELL RESTRICTIONS

1. NO OCCUPIED DWELLINGS > 2500 SQ FT. WITHIN 625 FEET OF CENTER OF PAD.
2. NO AGRICULTURE BUILDINGS > 2500 SQ FT. WITHIN 625 FEET OF CENTER OF PAD.
3. WATER WELLS OR DEVELOPED SPRINGS ARE WITHIN 2,068 FEET OF PROPOSED WELL.
4. PERENNIAL STREAMS, LAKES, PONDS, OR RESERVOIRS WITHIN 800 FEET OF THE LIMITS OF DISTURBANCE.
5. NO NATURALLY PRODUCING TROUT STREAM WITHIN 300 FEET OF LIMITS OF DISTURBANCE.
6. NO GROUND INTAKE OR PUBLIC WATER SUPPLY WITHIN 1000 FEET OF WELL PAD, LIMITS OF DISTURBANCE, E & S CONTROLS OR PUBLIC WATER SUPPLY.

NOTES ON SURVEY

1. SURFACE AND ROYALTY OWNER INFORMATION AND THEIR BOUNDARIES SHOWN HEREON WERE PLOTTED FROM DEEDS AND/OR TAX PARCEL MAPS PROVIDED BY CLIENT AND/OR FIELD LOCATIONS.
2. THIS PLAT DOES NOT REPRESENT A BOUNDARY SURVEY OF THE PARCELS SHOWN HEREON.
4. ALL INSETS ARE GRID NORTH UNLESS OTHERWISE DEPICTED.

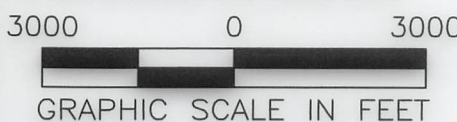

I, THE UNDERSIGNED, HEREBY CERTIFY THAT THIS PLAT IS CORRECT TO THE BEST OF MY KNOWLEDGE AND BELIEF AND SHOWS ALL THE INFORMATION REQUIRED BY LAW AND REGULATIONS ISSUED AND PRESCRIBED BY THE DEPARTMENT OF ENVIRONMENTAL PROTECTION.

P.S. 991 *Dennis E. Miller*

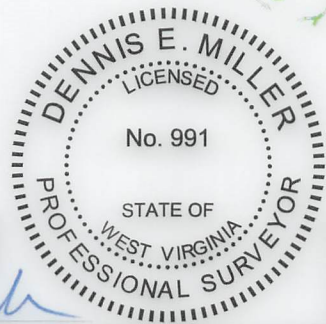

COMPANY: **SWN** Production Company, LLC **SWN** Production Company™

<p>(+) DENOTES LOCATION OF WELL ON UNITED STATES TOPOGRAPHIC MAPS</p> <p>WVDEP OFFICE OF OIL & GAS 601 57TH STREET CHARLESTON, WV 25034</p>	<p>MINIMUM DEGREE OF ACCURACY: 1/200</p> <p>PROVEN SOURCE OF ELEVATION: SURVEY GRADE GPS (NAVD 88, US FT)</p>	<p>OPERATOR'S WELL #: VIOLET COSS BRK 10H</p> <p>API WELL #: 47 009 mod 00301</p> <p>STATE COUNTY PERMIT</p>
	<p>WELL TYPE: OIL <input type="checkbox"/> WASTE DISPOSAL <input type="checkbox"/> PRODUCTION <input checked="" type="checkbox"/> DEEP <input type="checkbox"/> GAS <input checked="" type="checkbox"/> LIQUID INJECTION <input type="checkbox"/> STORAGE <input type="checkbox"/> SHALLOW <input checked="" type="checkbox"/></p> <p>WATERSHED: UPPER OHIO WHEELING</p> <p>DISTRICT: BUFFALO COUNTY: BROOKE</p> <p>SURFACE OWNER: LINDA COEN (LIFE ESTATE-VIOLET L COSS)</p> <p>OIL & GAS ROYALTY OWNER: VIOLET L COSS</p> <p>DRILL <input checked="" type="checkbox"/> DRILL DEEPER <input type="checkbox"/> REDRILL <input type="checkbox"/> FRACTURE OR STIMULATE <input checked="" type="checkbox"/> PLUG OFF OLD FORMATION <input type="checkbox"/> PERFORATE NEW FORMATION <input type="checkbox"/></p> <p>CONVERT <input type="checkbox"/> PLUG & ABANDON <input type="checkbox"/> CLEAN OUT & REPLUG <input type="checkbox"/> OTHER CHANGE <input type="checkbox"/> (SPECIFY)</p> <p>TARGET FORMATION: MARCELLUS ESTIMATED DEPTH: 5,831.9 TVD 20,675.91 TMD</p>	<p>DESIGNATED AGENT: BRITTANY WOODY</p> <p>ADDRESS: 1300 FORT PIERPONT DRIVE, STE 201</p> <p>CITY: MORGANTOWN STATE: WV ZIP CODE: 26508</p>

<p>LEGEND:</p> <ul style="list-style-type: none"> ○ PROPOSED SURFACE HOLE / BOTTOM HOLE ⊙ EXISTING / PRODUCING WELLHEAD LPL* LANDING POINT LOCATION ⊙ EXISTING WATER WELL ⊙ EXISTING SPRING — SURVEYED BOUNDARY — DRILLING UNIT ==== LEASE BOUNDARY — PROPOSED PATH TP* TURNING POINT LOCATION 	<p>REVISIONS:</p> <ul style="list-style-type: none"> ▲ REVISED LAT AND LONG 02-05-2020 ▲ REVISED LATERAL 03-11-2020 <p>DATE: 11-18-2019</p> <p>DRAWN BY: K.E.S.</p> <p>SCALE: 1" = 3000'</p> <p>DRAWING NO: 172-287</p> <p>WELL LOCATION PLAT</p>
--	---



CIVIL & ENVIRONMENTAL CONSULTANTS, INC.
 600 MARKETPLACE AVENUE, SUITE 200
 BRIDGEPORT, WV 26330
 304-933-3119

WELL BORE TABLE FOR SURFACE / ROYALTY OWNERS			
TRACT	SURFACE OWNER (S) / ROYALTY OWNER (R)	TAX PARCEL	ACRES
1	EVERETT ALAN COEN, LORRIE ELLEN WOOLWINE, MELINDA WOOLWINE, MICHAEL TODD COEN (S&R)	3-B32-25	224.303
2	HFS LIMITED LIABILITY COMPANY	3-B27-12	67.95
3	BROOKE CO. RT. 2		
4	WEST VIRGINIA DEPARTMENT OF HIGHWAYS	3-B27-11	
5	CAMPBELL TRANSPORTATION COMPANY, INC.	3-B27-10	12.48
6	STATE OF WEST VIRGINIA		
7	NORMA JEAN LILLY, WIDOW	3-B27-17	45.72
8	GERTRUDE LOUISE MCSHANE ROBIE & PATRICK J. MCSHANE, TRUSTEE	3-B32-29	84.79
9	TONY J. CASTILLO; RICHARD R. OSTRANDER (S)	3-B32-28	20.83
10	TONY J. CASTILLO; RICHARD R. OSTRANDER (S)	3-B32-27	10
11	GREEN RUN ROAD		
12	JAMES GEAR (S)	3-B32-11.01	1.00
13	PENNY HAMILTON	3-B32-11	8.50
14	SCHIAPPA & COMPANY, INC	3-B32-09	214.83
15	LILLIAN L. MCCORD EST.	3-B32-185	36.42
16	ROBERT G. TREDWAY JR.	3-B32-188	42.01
17	RONALD H. REINANCHER & KAREN L. MAHLEY	3-B32-187	2.0
18	CITY OF WELLSBURG COMBINED WATER AND SEWER BOARD	3-B32-140.2	0.21
19	KOSUT KEVIN D. & BRIDGET	3-B37-42	34.259
20	SCHIAPPA AND COMPANY, INC.	3-B37-22	145.963

ADJOINING OWNERS TABLE			
TRACT	SURFACE OWNER	TAX PARCEL	ACRES
A	DANIEL P. LOMBARDI	3-B27K-211	6.62
B	PAUL DAVID FORSYTHE & ALLEN LEE FORSYTHE	3-B27K-210	2.35
C	ROBERT C. III & RONICA L. CRISS (SURV)	3-B27K-206	0.25
D	ROBERT C. III & RONICA L. CRISS (SURV)	3-B27K-205	0.18
E	RANDY AND BRENDA WILLIAMS	3-B27K-204	0.16
F	RANDY AND BRENDA WILLIAMS	3-B27K-203	0.10
G	RANDY M. & BRENDA WILLIAMS (SURV)	3-B27K-202	0.19
H	JOHN J FRISCO SR (3/5); JOSEPHINE IWANYSN (2/5)	3-B27K-189	0.5344
I	WILLIAM, CAROLYN AND JESSICA WALNOHA	3-B32-7	2
J	ROBIE GERTRUDE LOUISE MCSHANE	3-B27P-30	136.00
K	DAVID B JONES	3-B32-8	9.1
L	GERTRUDE LOUISE MCSHANE ROBIE	3-B32-30	1.68
M	SCHIAPPA AND COMPANY INC	3-B32-10	8.82
N	MELANIE J. LUNSFORD	3-B32-72	1.74
O	WILLIAM WHEAT AND CARRIE HIGGS	3-B32-71	1.738
P	WILLIAM WHEAT AND CARRIE HIGGS	3-B32-70	1.739
Q	PATRICIA SAUVAGEOT AND GLORIA PRAMESA	3-B32-69	1.721
R	JAY D. & KAREN SUE RECK	3-B32-68	2.22
S	JOSEPH & JEFFREY P. JACKFERT (SURV)	3-B32-67	1.13
T	KAREN AND JAY RECK	3-B32G-67.01	15.645
U	HERBERT MCGOWAN	3-B32G-67	58.965
V	VEMURI HOME & GARDEN, LLC	3-B32G-1	2.22
W	KAY A. ELLIOTT	3-B32G-3	0.17
X	KAY A. ELLIOTT	3-B32G-4	0.221
Y	LARRY REED AND DEBORAH REED	3-B32G-5	1.43
Z	LARRY REED AND DEBORAH REED	3-B32G-6	.892
AA	ROBERT F. & ANNA OHLER	3-B32G-7	0.74
BB	JOHN H. FOX	3-B32G-8	0.36
CC	JAMES AND ANNETTE BEST	3-B32G-9	0.52
DD	FEDERAL NATIONAL MORTGAGE ASSOCIATION	3-B32G-10	0.38
EE	MATHEW TOMSHACK	3-B32G-11	0.39
FF	MATHEW TOMSHACK	3-B32-88	1.21
GG	PAUL W. & SUSAN A. FODOR	3-B32-89	3.5
HH	KAREN L. REINACHER	3-B32-96	88.953
II	DAVID MCGOWAN	3-B32-190	6.27
JJ	DONALD C. BURKHART	3-B32-191	7.24
KK	ROBERT G. TREDWAY JR.	3-B32-189	1.01
LL	CHARLES M. & BARBARA J. TREDWAY	3-B32-186	3.0
MM	KURT YANO, FRANK YANO AND KATHERINE YANO	3-B32-40	0.757
NN	RALPH G. JOHNSTON; ROBERT JOHNSTON; KENNETH D. JOHNSTON, DANIEL JOHNSTON, ET AL	3-B32-180	39.862

ADJOINING OWNERS TABLE			
TRACT	SURFACE OWNER	TAX PARCEL	ACRES
OO	MASLO FARMS LLC A PENNSYLVANIA LLC	3-B32-19	59.66
PP	JOSEPH & MARY VIDERMAN	3-B32-13	43.38
QQ	PENNY HAMILTON	3-B32-12	.50
RR	JAMES SCOTT GEAR	3-B32-26	3.11
SS	WILLIAM & CAROLYN WALNOHA (SURV)	3-B32-14	1.34
TT	JOHN PORTER; BRIGITTE ROGERS (SURV)	3-B32-15	.568
UU	DOROTHY L. STEVENS	3-B32-16	2.09
VV	RUTH BERNADINE HART	3-B32-22.01	0.262
WW	WALNOHA WILLIAM RUSSELL; HART RUTH; THARP MARY FRANC	3-B32-22	0.244
XX	WILLIAM RUSSELL WALNOHA	3-B32-22.02	0.259
YY	HFS LIMITED LIABILITY COMPANY	3-B32-23	2
ZZ	HFS LIMITED LIABILITY COMPANY	3-B32-24	2
AAA	COSS ROAD FARM, LLC	3-B31-114	183.23
BBB	JAMES L. & SONDR A. ELLIOTT	3-B31-121	5.48
CCC	HFS LIMITED LIABILITY COMPANY	3-B31-1	23.87
DDD	CAMPBELL TRANSPORTATION COMPANY INC	3-B27-8	0.41
EEE	GREG PROVENZANO	3-B27-9	0.09
FFF	LIZON JOSEPH P. III & NIXON ERIN REBECCA (SURV)	3-B32-192	19.40
GGG	UHLLY REBECCA L.	3-B32-139	27.805
HHH	COLLINS KEVIN R. & SANDRA A. (SURV)	3-B32-130	24.04
III	OHLER JAMIE L.	3-B37-43	29.00
JJJ	CHRISTMAN MARK A.	3-B37-45	110.58
KKK	JOHNSTON WILLIAM E. & HAZEL E. (SURV)	3-B37-50	166.50
LLL	SCHIAPPA AND COMPANY INC	3-B37-23	90.91
MMM	LOUGHERY VICKIE C. & SHEENA R. (SURV)	3-B37-103	40.00
NNN	WALNOHA RALPH JR. & CAROL J.	3-B37-34	6.787
OOO	WALNOHA RALPH JR. & CAROL J.	3-B37-33	0.80
PPP	GIBSON JAMES W. & LISA (SURV)	3-B37-28	4.06
QQQ	LEMASTERS HARLEY J.	3-B37-21	31.17
RRR	CARBASHO THOMAS & CAROLYN (SURV)	3-B37-16	7.29
SSS	CARBASHO THOMAS & CAROLYN (SURV)	3-B37-15	5.00
TTT	MYERS JAMES W. & DENISE L. (SURV)	3-B37-14	5.00
UUU	LEMASTERS HARLEY J.	3-B37-13	33.54
VVV	BOYD NILA; MCCORD CLINTON; JOHN JOHN; REBA; JONES CA	3-B32-146	29.057
WWW	BOYD DAVID SMITH & NILA MCCORD	3-B32-142	5.09
XXX	JOHNSTON KENNETH D.	3-B32-141	4.91

API WELL #: **47** **009** *mod*
 STATE COUNTY PERMIT **00301**

REVISIONS: ▲ REVISED LAT AND LONG 02-05-2020 ▲ REVISED LATERAL 03-11-2020	COMPANY: 	DATE: 11-18-2019
	OPERATOR'S VIOLET COSS BRK	DRAWN BY: K.E.S.
	WELL #: 10H	SCALE: N/A
	DISTRICT: BUFFALO	DRAWING NO: 172-287
	COUNTY: BROOKE	WELL LOCATION PLAT 2
	STATE: WV	