

State of West Virginia
Department of Environmental Protection - Office of Oil and Gas
Well Operator's Report of Well Work

API 47 - 009 - 00275 County BROOKE District BUFFALO
Quad BETHANY Pad Name KATHY MAYHEW BRK PAD Field/Pool Name PANHANDLE FIELD WET
Farm name KATHY LYNN & MICHAEL MAYHEW, ET AL Well Number KATHY MAYHEW BRK 6H
Operator (as registered with the OOG) SWN PRODUCTION COMPANY, LLC
Address PO BOX 12359 City SPRING State TX Zip 77391-2359

As Drilled location NAD 83/UTM Attach an as-drilled plat, profile view, and deviation survey
Top hole Northing 4449160.41 Easting 532116.77
Landing Point of Curve Northing 4449049.64 Easting 531914.30
Bottom Hole Northing 4445239.15 Easting 533588.23

Elevation (ft) 1,281.2' GL Type of Well New Existing Type of Report Interim Final
Permit Type Deviated Horizontal Horizontal 6A Vertical Depth Type Deep Shallow
Type of Operation Convert Deepen Drill Plug Back Redrilling Rework Stimulate
Well Type Brine Disposal CBM Gas Oil Secondary Recovery Solution Mining Storage Other _____
Type of Completion Single Multiple Fluids Produced Brine Gas NGL Oil Other _____
Drilled with Cable Rotary

Drilling Media Surface hole Air Mud Fresh Water Intermediate hole Air Mud Fresh Water Brine
Production hole Air Mud Fresh Water Brine
Mud Type(s) and Additive(s)
SOBM

Date permit issued 3/27/2019 Date drilling commenced 7/29/2019 Date drilling ceased 8/10/2019
Date completion activities began 10/12/2019 Date completion activities ceased 11/23/2019
Verbal plugging (Y/N) N Date permission granted N/A Granted by N/A

Please note: Operator is required to submit a plugging application within 5 days of verbal permission to plug

Freshwater depth(s) ft 370' Open mine(s) (Y/N) depths N
Salt water depth(s) ft 622' Void(s) encountered (Y/N) depths N
Coal depth(s) ft 454' Cavern(s) encountered (Y/N) depths N
Is coal being mined in area (Y/N) N

RECEIVED
Office of Oil and Gas
JAN 28 2020
WV Department of
Environmental Protection

Reviewed by:

5-11-20

API 47-009 - 00275 Farm name KATHY LYNN & MICHAEL MAYHEW, ET AL Well number KATHY MAYHEW BRK 6H

CASING STRINGS	Hole Size	Casing Size	Depth	New or Used	Grade wt/ft	Basket Depth(s)	Did cement circulate (Y/ N) * Provide details below*
Conductor	24	20	126	NEW	J-55/94#		Y
Surface	17.5	13.375	529	NEW	J-55/54.50#		Y, 29 BBLs
Coal	SEE SURFACE						
Intermediate 1	12.25	9.625	1801	NEW	J-55/36#		Y, 40 BBLs
Intermediate 2							
Intermediate 3							
Production	8.75/8.50	5.5	20087	NEW	HCP-110/20#		Y
Tubing		2.875	6370	NEW	P-110/6.50#		N
Packer type and depth set							

Comment Details _____

CEMENT DATA	Class/Type of Cement	Number of Sacks	Slurry wt (ppg)	Yield (ft ³ /sks)	Volume (ft ³)	Cement Top (MD)	WOC (hrs)
Conductor	CLASS A	GROUT TO SURFACE				SURFACE	24
Surface	CLASS A	517	15.60	1.20	620.4	SURFACE	8
Coal	SEE SURFACE						
Intermediate 1	CLASS A	721	15.60	1.19	857.99	SURFACE	8
Intermediate 2							
Intermediate 3							
Production	CLASS A	3,402	15.60	1.19	4,048.38	SURFACE	24
Tubing							

Drillers TD (ft) 20,087' Loggers TD (ft) 20,087'
 Deepest formation penetrated Marcellus Shale Plug back to (ft) N/A
 Plug back procedure N/A

Kick off depth (ft) 5,422'

Check all wireline logs run caliper density deviated/directional induction
 neutron resistivity gamma ray temperature sonic

Well cored Yes No Conventional Sidewall Were cuttings collected Yes No

DESCRIBE THE CENTRALIZER PLACEMENT USED FOR EACH CASING STRING _____

SURFACE: 7 CENTRALIZERS - EVERY THIRD JOINT OF CASING
 INTERMEDIATE: 24 CENTRALIZERS - EVERY THIRD JOINT OF CASING
 PRODUCTION: 181 CENTRALIZERS - EVERY THIRD JOINT FROM SURFACE TO TOP OF CURVE, THEN EVERY JOINT UNTIL TD

WAS WELL COMPLETED AS SHOT HOLE Yes No DETAILS _____

WAS WELL COMPLETED OPEN HOLE? Yes No DETAILS _____

WERE TRACERS USED Yes No TYPE OF TRACER(S) USED _____

RECEIVED
Office of Oil and Gas
JAN 29 2009
WV Department of Environmental Protection

Hydraulic Fracturing Fluid Product Component Information Disclosure

Job Start Date:	10/12/2019
Job End Date:	11/13/2019
State:	West Virginia
County:	Brooke
API Number:	47-009-00275-00-00
Operator Name:	Southwestern Energy
Well Name and Number:	Kathy Mayhew BRK 6
Latitude:	40.19222046
Longitude:	-80.62268827
Datum:	NAD83
Federal Well:	NO
Indian Well:	NO
True Vertical Depth:	6,073
Total Base Water Volume (gal):	19,268,508
Total Base Non Water Volume:	0

Hydraulic Fracturing Fluid Composition:

Trade Name	Supplier	Purpose	Ingredients	Chemical Abstract Service Number (CAS #)	Maximum Ingredient Concentration in Additive (% by mass)**	Maximum Ingredient Concentration in HF Fluid (% by mass)**	Comments
Econo-C1200	SWN Well Services	Corrosion Inhibitor		Listed Below			
SCAL 16486A	Nalco	Scale Inhibitor		Listed Below			



RECEIVED
Office of Oil and Gas

JAN 28 2020

WV Department of
Environmental Protection

Ecopol-FEAC	SWN Well Services	Iron Control		Listed Below				
Base Water	Operator	Base Fluid		Listed Below				
HCL	SWN Well Services	Solvent		Listed Below				
BIOC11219A	Nalco	Biocide		Listed Below				
SWN FRW-11LC	SWN Well Services	Friction Reducer		Listed Below				
Sand	SWN Well Services	Proppant		Listed Below				
RECEIVED Office of Oil and Gas JAN 28 2020 WV Department of Environmental Protection								
Items above are Trade Names with the exception of Base Water. Items below are the individual ingredients.								
		Water		7732-18-5	100.00000	85.37687	Density = 8.345	
		Crystalline Silica, quartz		14808-60-7	100.00000	14.24518		
		Water		7732-18-5	85.00000	0.28092		
		Hydrochloric Acid		7647-01-0	15.00000	0.03734		
		Petroleum Distillates, Hydrotreated		64742-47-8	25.00000	0.02376		
		Methanol		67-56-1	60.00000	0.01593		
		Benzyl-(C12-C16 Alky)-Dimethyl-Ammonium		68424-85-1	30.00000	0.00797		
		Chloride Glutaraldehyde		111-30-8	10.00000	0.00266		

	Ammonium Chloride	12125-02-9	2.00000	0.00190	
	Amine Triphosphate	Proprietary	30.00000	0.00173	
	Ethylene glycol	107-21-1	30.00000	0.00173	
	Alcohols, C-12-1, ethoxylated	68551-12-2	1.50000	0.00143	
	Oleic Acid Diethanolamide	93-83-4	1.50000	0.00143	
	Acetic Acid	64-19-7	37.50000	0.00050	
	Methanol	67-56-1	80.00000	0.00031	
	Citric Acid	77-92-9	22.50000	0.00030	
	Oxyalkylated fatty acid	68951-67-7	9.67400	0.00004	
	Fatty acids	61790-12-3	5.02700	0.00002	
	Modified thiourea polymer	68527-49-1	4.74600	0.00002	
	Potassium acetate	127-08-2	0.02200	0.00000	
	Formaldehyde	50-00-0	0.00400	0.00000	

* Total Water Volume sources may include various types of water including fresh water, produced water, and recycled water

** Information is based on the maximum potential for concentration and thus the total may be over 100%

*** If you are calculating a percentage of total ingredients do not add the water volume below the green line to the water volume above the green line

Note: For Field Development Products (products that begin with FDP), MSDS level only information has been provided.

Ingredient information for chemicals subject to 29 CFR 1910.1200(i) and Appendix D are obtained from suppliers Material Safety Data Sheets (MSDS)

RECEIVED
Office of Oil and Gas

JAN 28 2020

WV Department of
Environmental Protection

**KATHY MAYHEW BRK 6H
ATTACHMENT 1
PERF REPORT**

STAGE NUM	Perf Date	Perf Top MD	Perf Bottom MD	# SHOTS PER STG
1	9/29/2019	20,038	19,945	36
2	10/12/2019	19,912	19,732	36
3	10/13/2019	19,698	19,518	36
4	10/13/2019	19,484	19,304	36
5	10/24/2019	19,268	19,090	36
6	10/28/2019	19,062	18,884	36
7	10/28/2019	18,850	18,672	36
8	10/30/2019	18,638	18,460	36
9	10/31/2019	18,427	18,248	36
10	10/31/2019	18,215	18,036	36
11	10/31/2019	18,003	17,823	36
12	10/31/2019	17,785	17,613	36
13	11/1/2019	17,579	17,401	36
14	11/1/2019	17,368	17,193	36
15	11/1/2019	17,156	16,977	36
16	11/1/2019	16,942	16,766	36
17	11/1/2019	16,732	16,554	36
18	11/2/2019	16,520	16,342	36
19	11/2/2019	16,309	16,130	36
20	11/2/2019	16,092	15,918	36
21	11/2/2019	15,885	15,706	36
22	11/2/2019	15,673	15,497	36
23	11/3/2019	15,461	15,283	36
24	11/3/2019	15,250	15,071	36
25	11/3/2019	15,038	14,859	36
26	11/3/2019	14,826	14,648	36
27	11/3/2019	14,609	14,436	36
28	11/4/2019	14,402	14,224	36
29	11/4/2019	14,191	14,017	36
30	11/4/2019	13,979	13,800	36
31	11/4/2019	13,764	13,589	36
32	11/4/2019	13,555	13,377	36
33	11/5/2019	13,343	13,165	36
34	11/5/2019	13,132	12,953	36
35	11/5/2019	12,920	12,741	36
36	11/5/2019	12,705	12,530	36
37	11/5/2019	12,496	12,318	36
38	11/6/2019	12,284	12,106	36
39	11/6/2019	12,073	11,894	36
40	11/6/2019	11,862	11,682	36
41	11/6/2019	11,648	11,471	36
42	11/6/2019	11,437	11,259	36
43	11/7/2019	11,225	11,047	36

RECEIVED
Office of Oil and Gas

JAN 28 2020

WV Department of
Environmental Protection

**KATHY MAYHEW BRK 6H
ATTACHMENT 1
PERF REPORT**

STAGE NUM	Perf Date	Perf Top MD	Perf Bottom MD	# SHOTS PER STG
44	11/7/2019	11,014	10,835	36
45	11/7/2019	10,802	10,619	36
46	11/7/2019	10,590	10,412	36
47	11/7/2019	10,373	10,200	36
48	11/8/2019	10,166	9,988	36
49	11/8/2019	9,955	9,776	36
50	11/8/2019	9,743	9,564	36
51	11/9/2019	9,531	9,353	36
52	11/9/2019	9,319	9,141	36
53	11/9/2019	9,107	8,934	36
54	11/9/2019	8,896	8,717	36
55	11/9/2019	8,683	8,505	36
56	11/10/2019	8,472	8,294	36
57	11/10/2019	8,260	8,082	36
58	11/11/2019	8,048	7,870	36
59	11/11/2019	7,837	7,661	36
60	11/12/2019	7,625	7,444	36
61	11/12/2019	7,413	7,235	36
62	11/12/2019	7,201	7,023	36
63	11/13/2019	6,989	6,811	36
64	11/13/2019	6,778	6,599	36
65	11/13/2019	6,566	6,392	36

RECEIVED
Office of Oil and Gas
JAN 28 2020
WV Department of
Environmental Protection

KATHY MAYHEW BRK 6H

ATTACHMENT 2

STIM REPORT

STAGE NUM	Stim Date	Ave Pump Rate (BPM)	Ave Treatment	Max Breakdown	ISIP (PSI)	Amount of Proppant (lbs)	Amount of water bbls	Amount of nitrogen/othe
1	10/12/2019	75	7,852	7,025	3,568	240,729	6,263	0
2	10/12/2019	88	8,207	5,689	5,102	425,635	7,776	0
3	10/13/2019	87	8,317	6,025	5,074	414,516	7,259	0
4	10/13/2019	86	7,907	5,132	4,097	420,020	7,807	0
5	10/28/2019	85	7,790	5,915	4,270	421,228	7,787	0
6	10/28/2019	85	7,532	4,382	4,613	421,093	7,264	0
7	10/29/2019	72	7,330	5,151	4,003	159,851	9,933	0
8	10/30/2019	92	8,085	5,026	4,414	419,820	7,233	0
9	10/31/2019	86	7,827	5,427	4,320	418,685	7,005	0
10	10/31/2019	86	8,237	5,596	4,486	420,338	7,380	0
11	10/31/2019	86	8,160	5,565	4,266	423,916	7,332	0
12	10/31/2019	86	8,062	5,288	4,454	421,286	8,317	0
13	11/1/2019	89	8,055	5,432	4,112	413,037	7,551	0
14	11/1/2019	86	8,028	5,095	4,636	419,945	7,504	0
15	11/1/2019	84	8,016	5,443	4,720	418,135	7,411	0
16	11/1/2019	84	7,663	5,486	4,382	419,865	6,822	0
17	11/2/2019	85	7,858	5,656	4,425	418,420	6,778	0
18	11/2/2019	86	7,917	5,634	4,481	415,082	6,900	0
19	11/2/2019	86	7,879	5,441	4,352	417,470	7,487	0
20	11/2/2019	85	8,042	5,450	4,503	419,880	7,212	0
21	11/2/2019	84	7,826	5,520	4,410	420,790	6,951	0
22	11/2/2019	89	7,758	5,506	4,685	412,043	6,770	0
23	11/3/2019	92	7,698	5,238	4,356	421,402	6,900	0
24	11/3/2019	90	7,694	5,089	4,452	419,235	7,246	0
25	11/3/2019	89	8,033	5,112	4,922	420,010	7,222	0
26	11/3/2019	89	7,699	5,310	4,364	420,685	6,961	0
27	11/3/2019	93	7,847	5,294	4,348	419,485	6,813	0
28	11/4/2019	92	7,821	5,296	4,256	420,505	6,810	0
29	11/4/2019	87	7,886	5,411	4,310	429,545	7,248	0
30	11/4/2019	89	8,014	5,584	4,415	418,150	7,226	0
31	11/4/2019	95	7,831	5,893	4,347	417,325	6,852	0
32	11/4/2019	93	7,960	5,862	4,170	420,185	6,738	0
33	11/5/2019	92	7,588	5,938	4,351	419,715	6,577	0
34	11/5/2019	93	7,907	5,818	4,550	419,035	7,074	0
35	11/5/2019	92	7,892	5,805	4,468	418,970	7,141	0
36	11/5/2019	93	7,812	5,881	4,443	417,980	7,227	0
37	11/5/2019	90	7,738	5,496	4,398	417,820	6,859	0
38	11/6/2019	94	7,553	5,353	4,388	417,600	7,262	0
39	11/6/2019	96	7,690	5,016	4,423	419,748	6,949	0
40	11/6/2019	92	7,953	5,118	4,336	422,523	6,584	0
41	11/6/2019	94	7,457	5,440	4,460	419,514	6,544	0
42	11/7/2019	92	7,528	5,345	4,076	417,885	6,871	0
43	11/7/2019	95	7,545	5,191	4,510	418,525	6,940	0
44	11/7/2019	94	7,422	4,516	4,468	420,693	6,461	0
45	11/7/2019	93	7,353	5,011	4,464	421,390	6,395	0
46	11/7/2019	95	7,229	4,931	4,589	420,936	6,732	0
47	11/7/2019	95	7,286	5,128	4,285	418,310	6,869	0
48	11/8/2019	93	7,292	5,260	4,582	421,369	6,361	0
49	11/8/2019	95	7,210	5,485	4,368	414,905	6,965	0
50	11/9/2019	93	7,268	5,556	4,480	418,110	6,835	0
51	11/9/2019	93	7,036	5,419	4,437	420,370	6,825	0
52	11/9/2019	88	7,725	5,035	4,355	420,530	6,202	0
53	11/9/2019	91	7,108	4,981	4,452	419,470	6,084	0

RECEIVED
Office of Oil and Gas

JAN 28 2020

WV Department of
Environmental Protection

KATHY MAYHEW BRK 6H

ATTACHMENT 2

STIM REPORT

STAGE NUM	Stim Date	Ave Pump Rate (BPM)	Ave Treatment	Max Breakdown	ISIP (PSI)	Amount of Proppant (lbs)	Amount of water bbls	Amount of nitrogen/othe
54	11/9/2019	94	6,787	5,098	4,225	423,335	6,836	0
55	11/10/2019	95	6,964	5,016	4,233	419,025	7,341	0
56	11/10/2019	92	6,926	4,811	4,507	422,457	6,309	0
57	11/11/2019	96	6,973	5,258	4,467	419,707	6,863	0
58	11/11/2019	92	7,156	5,029	4,398	415,415	6,419	0
59	11/12/2019	93	6,928	5,376	4,178	418,525	6,712	0
60	11/12/2019	71	7,202	4,790	4,398	419,305	8,686	0
61	11/12/2019	94	6,622	5,215	4,264	419,163	6,482	0
62	11/13/2019	93	6,485	5,316	4,258	419,105	6,454	0
63	11/13/2019	94	6,668	4,986	4,279	420,710	8,731	0
64	11/13/2019	78	6,725	5,091	4,461	419,340	7,943	0
65	11/13/2019	93	6,795	5,310	4,188	419,058	6,733	0

RECEIVED
Office of Oil and Gas
JAN 28 2020
WV Department of
Environmental Protection



Well Name: Kathy Mayhew BRK 6H

47009002750000

LITHOLOGY/FORMATION	TOP DEPTH, MD (FT)	TOP DEPTH, TVD (FT)	BOTTOM DEPTH, MD (FT)	BOTTOM DEPTH, TVD (FT)	QUANTITY AND TYPE OF FLUID
Base of Fresh Water	0.00	0.00	370.00	370.00	
Pittsburgh Coal	454.00	454.00	459.00	459.00	
Top of Salt Water	622.00	622.00	NA	NA	
Pottsville (ss)	622.00	622.00	745.00	745.00	
Raven Cliff (ss)	940.00	939.00	1111.00	1110.00	
Maxton (ss)	1212.00	1210.00	1457.00	1455.00	
Big Lime (ls)	1457.00	1455.00	1596.00	1594.00	
Big Injun (ss)	1596.00	1594.00	1751.00	1749.00	
Berea (siltstone)	2049.00	2038.00	2156.00	2144.00	
Rhinestreet (shale)	5527.00	5454.00	5777.00	5693.00	
Cashagua (shale)	5777.00	5693.00	5833.00	5741.00	
Middlesex (shale)	5833.00	5741.00	5915.00	5806.00	
Burket (shale)	5915.00	5806.00	5938.00	5824.00	
Tully (ls)	5938.00	5824.00	6018.00	5877.00	
Mahantango (shale)	6018.00	5877.00	6191.00	5965.00	
Marcellus (shale)	6191.00	5965.00	NA	NA	GAS

RECEIVED
Office of Oil and Gas
JAN 28 2020
M/V Department of
Environmental Protection

(2,000' SCALE) LATITUDE: 40°10'00" BOTTOM HOLE

6214'

(2,000' SCALE) LATITUDE: 40°12'30" SURFACE HOLE

10985'

3576'

5871'

(2,000' SCALE) LONGITUDE: -80°35'00" SURFACE HOLE

(2,000' SCALE) LONGITUDE: -80°35'00" BOTTOM HOLE



68011 Vineyard Road
St. Clairsville, Ohio 43950
740-695-6100

GRID NORTH
UTM, NAD83 DATUM, ZONE 17, US FT

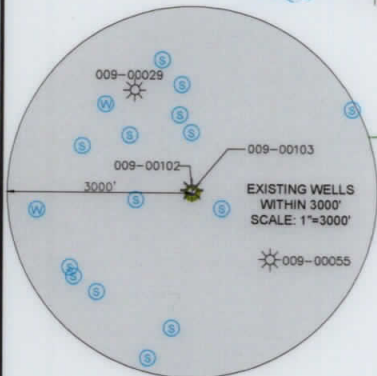

NOTES ON SURVEY

- COORDINATE SYSTEM IS UTM NAD 83 DATUM, ZONE 17, U.S. FOOT AND WELL COORDINATES ESTABLISHED USING SURVEY GRADE GPS.
- SURFACE AND ROYALTY OWNER INFORMATION AND THEIR BOUNDARIES SHOWN HEREON WERE PLOTTED FROM DEEDS AND/OR TAX PARCEL MAPS PROVIDED BY CLIENT AND/OR FIELD LOCATIONS.
- THIS PLAT DOES NOT REPRESENT A BOUNDARY SURVEY OF THE PARCELS SHOWN HEREON.
- NO DWELLINGS OR BUILDINGS WITHIN 625 FEET OF PROPOSED CENTER OF PAD
- NO PERENNIAL STREAMS, LAKES, PONDS, RESERVOIRS OR WETLANDS WITHIN 100 FEET OF THE LIMITS OF DISTURBANCE.
- NO NATURALLY PRODUCING TROUT STREAM WITHIN 300 FEET OF THE LIMITS OF DISTURBANCE.
- NO WATER WELLS OR DEVELOPED SPRINGS WITHIN 250 FEET OF PROPOSED WELL.

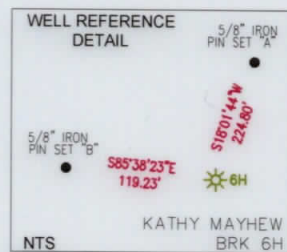
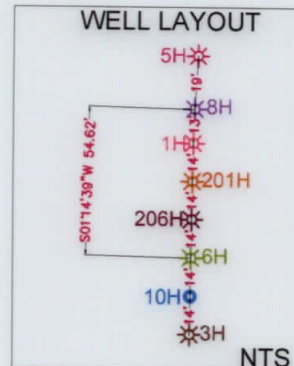

LINE	BEARING	DISTANCE
L1	N23°04'48"E	1906.54'
L2	N04°01'20"W	2523.58'

SURFACE HOLE LOCATION (SHL): UTM (NAD83, ZONE 17, METERS): NORTHING: 4449160.41 EASTING: 532116.77
LANDING POINT LOCATION (LPL): UTM (NAD83, ZONE 17, METERS): NORTHING: 4449049.64 EASTING: 531914.30
BOTTOM HOLE LOCATION (BHL): UTM (NAD83, ZONE 17, METERS): NORTHING: 4445239.15 EASTING: 533588.23
SURFACE HOLE LOCATION (SHL): UTM (NAD83, ZONE 17, METERS): NORTHING: 4449160.41 EASTING: 532116.77
LANDING POINT LOCATION (LPL): UTM (NAD83, ZONE 17, METERS): NORTHING: 4449051.32 EASTING: 531925.41
BOTTOM HOLE LOCATION (BHL): UTM (NAD83, ZONE 17, METERS): NORTHING: 4445235.32 EASTING: 533575.14



I, THE UNDERSIGNED, HEREBY CERTIFY THAT THIS PLAT IS CORRECT TO THE BEST OF MY KNOWLEDGE AND BELIEF AND SHOWS ALL THE INFORMATION REQUIRED BY LAW AND REGULATIONS ISSUED AND PRESCRIBED BY THE DEPARTMENT OF ENVIRONMENTAL PROTECTION.

P.S. 2041

SWN Production Company, LLC **SWN** Production Company™

	(+) DENOTES LOCATION OF WELL ON UNITED STATES TOPOGRAPHIC MAPS	MINIMUM DEGREE OF ACCURACY: 1/200	OPERATOR'S WELL #: KATHY MAYHEW BRK 6H
	WVDEP OFFICE OF OIL & GAS 601 57TH STREET CHARLESTON, WV 25034	PROVEN SOURCE OF ELEVATION: SURVEY GRADE GPS (NAVD 88, US FT)	API WELL #: 47 009 00275 STATE COUNTY PERMIT

WELL TYPE: OIL WASTE DISPOSAL PRODUCTION DEEP GAS LIQUID INJECTION STORAGE SHALLOW

WATERSHED: UPPER OHIO SOUTH ELEVATION: 1,281.2'

DISTRICT: BUFFALO COUNTY: BROOKE QUADRANGLE: BETHANY, WV

SURFACE OWNER: KATHY LYNN & MICHAEL MAYHEW, ET AL ACREAGE: ±84.74

OIL & GAS ROYALTY OWNER: KATHY LYNN & MICHAEL MAYHEW, ET AL ACREAGE: ±84.74

DRILL DRILL DEEPER REDRILL FRACTURE OR STIMULATE PLUG OFF OLD FORMATION PERFORATE NEW FORMATION

CONVERT PLUG & ABANDON CLEAN OUT & REPLUG OTHER CHANGE (SPECIFY) AS-DRILLED

TARGET FORMATION: MARCELLUS ESTIMATED DEPTH: 6,119' TVD 20,087' TMD

WELL OPERATOR: SWN PRODUCTION COMPANY, LLC	DESIGNATED AGENT: BRITTANY WOODY
ADDRESS: 1300 FORT PIERPONT DRIVE, SUITE 201	ADDRESS: 1300 FORT PIERPONT DRIVE, SUITE 201
CITY: MORGANTOWN STATE: WV ZIP CODE: 26508	CITY: MORGANTOWN STATE: WV ZIP CODE: 26508

LEGEND: EXISTING BOTTOM HOLE EXISTING / PRODUCING WELLHEAD EXISTING LANDING POINT LOCATION PROPOSED SURFACE HOLE / BOTTOM HOLE PROPOSED LANDING POINT LOCATION ACCESS ROAD PUBLIC ROAD FLOOD PLAIN LEASE BOUNDARY ASDRILLED PATH PROPOSED PATH	REVISIONS:	DATE: 01-15-2020
		DRAWN BY: R. GRIMES
		SCALE: 1" = 3000'
		DRAWING NO: 2018-341
		WELL LOCATION PLAT

WELL BORE TABLE FOR SURFACE / ROYALTY OWNERS		
TRACT	SURFACE OWNER (S) / ROYALTY OWNER (R)	TAX PARCEL
1	KATHY LYNN & MICHAEL MAYHEW, ETAL	03-B42-0027.0000
TRACT	SURFACE OWNER	TAX PARCEL
2	JAY GLEN COLLINS	03-B41-0080.0000
3	JAMES LAMONT	03-B47-0001.0000
4	ROBERT FINSLEY, JR.	03-B47-0001.0001
5	WEST VIRGINIA DEPARTMENT OF TRANSPORTATION, DIVISION OF HIGHWAYS	HUFF RUN ROAD
6	JOSEPH S. & JANE M. BUREK	03-B47-0019.0000
7	MARK A. WADE & MARY IVA SMITH	03-B47-0004.0000
8	DAVID A. & CRYSTAL G. DUNN (SURV)	03-B47-0007.0000
9	DAVID A. & CRYSTAL G. DUNN (SURV)	03-B47-0006.0000
10	WEST VIRGINIA DEPARTMENT OF TRANSPORTATION, DIVISION OF HIGHWAYS	GIRTSY POINT ROAD
11	DALE M. SAMPSON	03-L1-0002-0000-0000
12	DALE M. SAMPSON	04-R6-0013-0000-0000
13	DALE M. SAMPSON	03-L1-0024-0000-0000
14	DALE M. SAMPSON	09-WL6-0012-0000-00
15	DANIEL S. TEMPLETON	09-WL10-0001-0000-00
16	DEBRA DAGUE	09-WL10-0016-0000-00
17	BEN J. & NANCY S. MAZZELLA	09-WL10-0007-0000-00
18	WEST VIRGINIA DEPARTMENT OF TRANSPORTATION, DIVISION OF HIGHWAYS	OGLEBAY DRIVE
19	WILLIAM H. DORSEY, II & STEPHANIE A. DORSEY	09-WL10-0008-0000-00
20	ELIZABETH HESTICK & JANET HONECKER	03-L4-0103-0000-0000

ADJOINING OWNERS TABLE		
TRACT	SURFACE OWNER	TAX PARCEL
A	LUTHER GRIZZEL	03-B42-0030.0000
B	LUTHER GRIZZEL	03-B42-0031.0000
C	LUTHER GRIZZEL	03-B42-0029.0000
D	ELIZABETH ELLEN FLUHARTY	03-B47-0018.0000
E	MIKE RYNAWEC	03-B42-0033.0000
F	MIKE RYNAWEC	03-B42-0034.0000
G	LAWRENCE GRANT PAUGH	03-B47-0020.0000
H	LAWRENCE G. & CATHIE SUE PAUGH (SURV)	03-B47-0021.0000
I	STETSON E. & WENDY S. SUTER (SURV)	03-B47-0023.0000
J	CAROL DWYER	03-B47-0025.0000
K	LAWRENCE & MARTHA SAYRE (SURV)	03-B47-0014.0000
L	LAWRENCE & MARTHA J. SAYRE (SURV)	03-B47-0012.0000
M	SANDRA LINDA SMITH; EARLENE NICHOLSON	03-B47-0011.0000
N	JODY L. & JANIE L. BRITTON (SURV)	03-B47-0010.0000
O	JACK KLEIN & JENNIFER GEORGE (SURV)	03-B47-0008.0000
P	JODY L. & JANIE L. BRITTON (SURV)	03-B47-0009.0000
Q	MANUFACTURERS LIGHT & HEAT COMPANY	03-B47-0050.0000
R	CHRISTIAN FAITH FELLOWSHIP TRUSTEES	03-B47-0004.0001
S	ROXIE MCCAULEY	03-B47-0016.0000
T	PATRICK E. & DONNA M. KING (SURV)	03-B47-0015.0000
U	ALBERT H. POSTLEWAIT, JR. & CINDY S. POSTLEWAIT	04-R6-0018-0001-0000
V	WINDSOR POWER HOUSE COAL CO	03-L1-0001-0000-0000
W	CHARLES W. & M. C. NICHOLSON	03-L1-0002-0004-0000
X	PHARES D. EVANS	03-L1-0002-0002-0000
Y	FRANK W. PATTERSON	03-L1-0003-0000-0000
Z	CHARLES BONAR	03-L1-0004-0000-0000
AA	BERNIE D. METZ	03-L1-0022-0000-0000
AB	WALTER R. & J. M. UTTERMOHLEN	03-L1-0023-0000-0000
AC	DALE M. SAMPSON	09-WL6-0008-0001-0000
AD	WEST LIBERTY STATE COLLEGE	03-L1-0035-0005-0000
AE	ROBERT LEE JR. & DIANE L. VARNER	09-WL6-0011-0000-0000
AF	WEST LIBERTY STATE COLLEGE	03-L1-0035-0003-0000
AG	WEST LIBERTY STATE COLLEGE	03-L1-0035-0002-0000
AH	CONNIE L. YOUNG	09-WL10-0017-0000-0000
AI	DOROTHY FRANCIS	09-WL10-0004-0000-0000
AJ	DOROTHY I. FRANCIS	09-WL10-0003-0000-0000
AK	OHIO COUNTY PUBLIC SERV DIST	09-WL10-0006-0000-0000
AL	WM R. & R. L. MYERS	09-WL10-0009-0000-0000
AM	CYNTHIA L. JOHNSON	09-WL10-0011-0001-0000
AN	TIMOTHY L. MONROE, ET AL	09-WL10-0011-0000-0000
AO	WEST LIBERTY STATE COLLEGE	03-L1-0035-0000-0000
AP	KAREN S. & DONALD R. GRUBB	03-L4-0104-0001-0000
AQ	CARDLYN AND DENVER BARKER	03-L4-0104-0006-0000
AR	DENNY A. WARNER	03-L4-0104-0003-0000
AS	ELIZABETH L. HONECKER & ELIZABETH H. HESTICK	03-L4-0104-0000-0000
AT	ELIZABETH L. HONECKER & ELIZABETH H. HESTICK	03-L4-104.4-0000-0000
AU	PAUL M. MCCAY, DEBORAH A. MCCAY & JANET L. HONECKER	03-L4-0123-0000-0000
AV	ELIZABETH R. HONECKER & ELIZABETH HESTICK	03-L4-0124-0000-0000
AW	DEBRA & DAVID HAMSTEAD	03-L1-0042-0001-0000
AX	BENJAMIN R. HONECKER	03-L1-0042-0000-0000
AY	JANET L. AND ELIZABETH HONECKER	03-L4-0103-0000-0000
AZ	NANCY R. & B. J. MAZZELLA	09-WL10-0015-0000-0000
BA	DALE M. SAMPSON	03-L1-0024-0000-0000
BB	TOWN OF WEST LIBERTY	09-WL9-0001-0000-0000
BC	DALE M. SAMPSON	04-R6-0032-0000-0000
BD	CHARLES B. DAVIS, JR. & MADONA DAVIS	04-R6-0014-0000-0000
BE	CHAS B. & MADONA DAVIS	04-R6-0014-0001-0000
BF	WINDSOR COAL COMPANY	04-R6-0012-0000-0000
BG	MARK A. WADE & MARY WADE SMITH	04-R6-0011-0000-0000
BH	MELISSA KERNS; CHRISTINA A. LE-TIMOTHY & JEANETTE KERNS	03-B46-0040.0001
BI	JEFFREY A. HORNICK	03-B47-0005.0000
BJ	ERIC J. TUSTIN	03-B46-0029.0001
BK	JOHN E. SHARIER III	03-B47-0003.0000
BL	BETSY D. TUSTIN	03-B47-0002.0001
BM	DALE T. & MARY R. WOOD	03-B46-0046.0000
BN	DALE T. & MARY R. WOOD	03-B41-0084.0000
BO	BARRY L. & PATRICIA A. GREATHOUSE (SURV)	03-B41-0082.0000
BP	JAY GLEN COLLINS	03-B41-0080.0000
BQ	ROBERT J. JR. & LINDA MILLER	03-B41-0047.0000
BR	WILLIAM & DAMNA MILLER (SURV)	03-B41-0061.0000
BS	JOSEPH P. SR. & ROBIN M. SCRIP (SURV)	03-B41-0080.0002
BT	SANDRA W. BUTLER	03-B41-0071.0000
BU	SANDRA W. BUTLER	03-B41-0078.0000
BV	JAY G. COLLINS	03-B41-0079.0000
BW	SHAWN M. SINES	03-B41-0085.0000
BX	HENRY MIKELS; BONNIE J. BURKETT (SURV)	03-B41-0086.0001
BY	JASON D. & MARY E. WHITE (SURV)	03-B41-0086.0000
BZ	ROBERT D. II & LESLIE C. HILDEBRAND (SURV)	03-B42-0083.0000
CA	FRANK G. & KELLY L. AINSCOUGH (SURV)	03-B42-0071.0000
CB	HENRY HEINZROTH	03-B42-0032.0000

REVISIONS:

COMPANY:

SWN
Production Company, LLC

SWN *R-V+*
Production Company™

OPERATOR'S KATHY MAYHEW BRK

DATE: 01-15-2020

WELL #: 6H

DRAWN BY: R. GRIMES

DISTRICT:
BUFFALO

COUNTY:
BROOKE

STATE:
WV

SCALE: N/A
DRAWING NO: 2018-341
WELL LOCATION PLAT

WELL BORE TABLE FOR SURFACE ROYALTY OWNERS	
TRACT	SURFACE OWNER (S) ROYALTY OWNER (R)
1	KATHY LYNN & MICHAEL MAYHEW, ETAL
2	JAY GLEN COLLINS
3	JAMES LAMONT
4	ROBERT FISHEL, JR.
5	WEST VIRGINIA DEPARTMENT OF TRANSPORTATION DIVISION OF HIGHWAYS
6	HUFF RUM ROAD
7	JOSEPH S & JANE M BURK
8	MARK A WADE & MARY IVA SMITH
9	DAVID A & CRYSTAL C DUNN (SURV)
10	DAVID A & CRYSTAL C DUNN (SURV)
11	WEST VIRGINIA DEPARTMENT OF TRANSPORTATION DIVISION OF HIGHWAYS
12	DALE M SAMPSON
13	DALE M SAMPSON
14	DALE M SAMPSON
15	DANIEL S TEMPLETON
16	DEBRA DACUS
17	BEN J & NANCY S MAZZELLA
18	WEST VIRGINIA DEPARTMENT OF TRANSPORTATION DIVISION OF HIGHWAYS
19	WILLIAM H DORSEY, II & STEPHANIE A DORSEY
20	ELIZABETH HESTICK & JANET HONECKER

ADJOINING OWNERS TABLE	
TRACT	SURFACE OWNER
A	LUTHER GRIZZEL
B	LUTHER GRIZZEL
C	LUTHER GRIZZEL
D	ELIZABETH ELLEN LUTHERLY
E	MIKE RYANWEC
F	MIKE RYANWEC
G	LAWRENCE DRAVI PAUGH
H	LAWRENCE G & CATIE SUE PAUGH (SURV)
I	STETSON E & WENDY S STUTER (SURV)
J	CAROL DWYER
K	LAWRENCE & MARTHA SARE (SURV)
L	LAWRENCE & MARTHA J SARE (SURV)
M	SANDRA LINDA SMITH EARLENE NICHOLSON
N	JODY L & JANE L BRITTON (SURV)
O	JACK KLEIN & JENNIFER GEORGE (SURV)
P	JODY L & JANE L BRITTON (SURV)
Q	MANUFACTURERS LIGHT & HEAT COMPANY
R	CHRISTIAN FAITH FELLOWSHIP TRUSTEES
S	ROXIE MCCOULEY
T	PATRICK E & DONNA M KING (SURV)
U	ALBERT H POSTLEWANT, JR & CINDY S POSTLEWANT
V	WINDSOR POWER HOUSE COAL CO
W	CHARLES W & M C NICHOLSON
X	PHARES O EWING
Y	FRANK W PATTERSON
Z	CHARLES BONAR
AA	BERNIE D METZ
AB	WALTER R & J M GUTERMOHLEN
AC	DALE M SAMPSON
AD	WEST LIBERTY STATE COLLEGE
AE	ROBERT LEE JR & DIANE J VARNER
AF	WEST LIBERTY STATE COLLEGE
AG	WEST LIBERTY STATE COLLEGE
AH	CONNIE J YOUNG
AI	DOROTHY FRANCIS
AJ	DOROTHY I FRANCIS
AK	OHIO COUNTY PUBLIC SERV DIST
AL	WM R & R J MYERS
AM	CYNTHIA L JOHNSON
AN	TIMOTHY L MOWRE, ET AL
AO	WEST LIBERTY STATE COLLEGE
AP	KAREN S & DONALD R DRUBB
AQ	CAROLYN AND DENVER BARKER
AR	DENNY A WARNER
AS	ELIZABETH J HONECKER & ELIZABETH H HESTICK
AT	ELIZABETH J HONECKER & ELIZABETH H HESTICK
AU	PAUL M MCCAY, DEBORAH A MCCAY & JANET L HONECKER
AV	ELIZABETH R HONECKER & ELIZABETH HESTICK
AW	DEBRA & DAVID HANSTAD
AX	BENJAMIN R HONECKER
AY	JANET I AND ELIZABETH HONECKER
AZ	NANCY R & B J MAZZELLA
BA	DALE M SAMPSON
BB	TOWN OF WEST LIBERTY
BC	DALE M SAMPSON
BD	CHARLES B DAVIS, JR & MADONA DAVIS
BE	CHAS B & MADONA DAVIS
BF	WINDSOR COAL COMPANY
BG	MARK A WADE & MARY WADE SMITH
BH	MELISSA KERNS CHRISTINA A LE-TIMOTHY & LEMELLE KERNS
BI	JEFFREY A HORNECK
BJ	ERIC J LUSTIN
BK	JOHN E SHARPER III
BL	BETSY D LUSTIN
BM	DALE T & MARY R WOOD
BN	DALE T & MARY R WOOD
BO	BARRY J & PATRICIA A GRETATHOUSE (SURV)
BP	JAY GLEN COLLINS
BQ	ROBERT J JR & LINDA MILLER
BR	WILLIAM & DAMIAN MILLER (SURV)
BS	JOSEPH P SR & ROBIN M SCRIP (SURV)
BT	SANDOR W BUTLER
BU	SANDOR W BUTLER
BV	JAY G COLLINS
BW	SHAWN M SNEZ
BX	HENRY MKELZ, BONNIE J BURKETT (SURV)
BY	JASON D & MARY E WHITE (SURV)
BZ	ROBERT D II & LESLIE C HILDEBRAND (SURV)
CA	FRANK C & KELLY J HANSCOUGH (SURV)
CB	HENRY HEINRICH

COMPANY: SWN Production Company, LLC		REVISIONS:	
OPERATOR: KATHY MAYHEW BRK			
WELL #: 09			
DISTRICT: BUFFALO	COUNTY: BROOKE		
STATE: WV			
DATE: 01-12-2020			
DRAWN BY: R. GRIMES			
SCALE: N/A			
DRAWING NO: 2018-341			
WELL LOCATION PLAT			

