



CIVIL & ENVIRONMENTAL CONSULTANTS, INC.  
600 MARKETPLACE AVENUE, SUITE 200  
BRIDGEPORT, WV 26330  
304-833-3118

**SURFACE HOLE LOCATION (SHL):**  
UTM (NAD83, ZONE 17, METERS):  
NORTHING: 4,447,793.843  
EASTING: 540,731.095

**LANDING POINT (LPL):**  
UTM (NAD83, ZONE 17, METERS):  
NORTHING: 4,447,781.617  
EASTING: 540,291.164

**BOTTOM HOLE LOCATION (BHL):**  
UTM (NAD83, ZONE 17, METERS):  
NORTHING: 4,450,526.755  
EASTING: 539,497.152

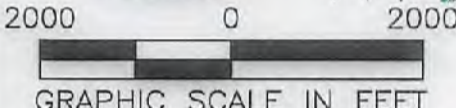
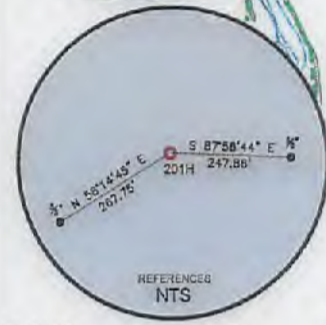

**WELL RESTRICTIONS**

1. NO OCCUPIED DWELLINGS > 2500 SQ FT, WITHIN 625 FEET OF CENTER OF PAD.
2. NO AGRICULTURE BUILDINGS > 2500 SQ FT, WITHIN 625 FEET OF CENTER OF PAD.
3. WATER WELLS OR DEVELOPED SPRINGS ARE WITHIN 960 FEET OF PROPOSED WELL.
4. PERENNIAL STREAMS, LAKES, PONDS, OR RESERVOIRS WITHIN 800 FEET OF THE LIMITS OF DISTURBANCE.
5. NO NATURALLY PRODUCING TROUT STREAM WITHIN 300 FEET OF LIMITS OF DISTURBANCE.
6. NO GROUND INTAKE OR PUBLIC WATER SUPPLY WITHIN 1000 FEET OF WELL PAD, LIMITS OF DISTURBANCE, E & S CONTROLS OR PUBLIC WATER SUPPLY.

**NOTES ON SURVEY**

1. SURFACE AND ROYALTY OWNER INFORMATION AND THEIR BOUNDARIES SHOWN HEREON WERE PLOTTED FROM DEEDS AND/OR TAX PARCEL MAPS PROVIDED BY CLIENT AND/OR FIELD LOCATIONS.
2. THIS PLAT DOES NOT REPRESENT A BOUNDARY SURVEY OF THE PARCELS SHOWN HEREON.
3. ALL INSETS ARE GRID NORTH UNLESS OTHERWISE DEPICTED.

I, THE UNDERSIGNED, HEREBY CERTIFY THAT THIS PLAT IS CORRECT TO THE BEST OF MY KNOWLEDGE AND BELIEF AND SHOWS ALL THE INFORMATION REQUIRED BY LAW AND REGULATIONS ISSUED AND PRESCRIBED BY THE DEPARTMENT OF ENVIRONMENTAL PROTECTION.

P.S. 991

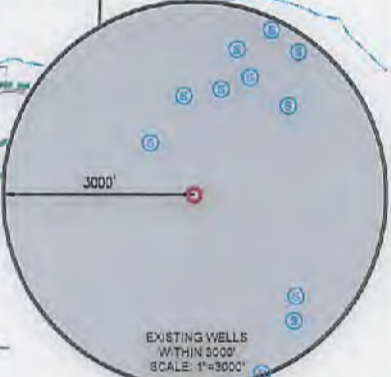

COMPANY: **SWN** Production Company, LLC

OPERATOR'S WELL #: SANDRA PARR BRK 201H

API WELL #: 47 009 00251 #6A

STATE COUNTY PERMIT

(+) DENOTES LOCATION OF WELL ON UNITED STATES TOPOGRAPHIC MAPS

WVDEP  
OFFICE OF OIL & GAS  
601 57TH STREET  
CHARLESTON, WV 25034

MINIMUM DEGREE OF ACCURACY: 1/200

PROVEN SOURCE OF ELEVATION: SURVEY GRADE GPS (NAVD 88, US FT)

WELL TYPE: OIL  WASTE DISPOSAL  PRODUCTION  DEEP  GAS  LIQUID INJECTION  STORAGE  SHALLOW

WATERSHED: BUFFALO CREEK ELEVATION: 1276.1' Staked

DISTRICT: BUFFALO DISTRICT COUNTY: BROOKE QUADRANGLE: BETHANY

SURFACE OWNER: ANTHONY BRUCE PARR, ET AL ACREAGE: 132.00±

OIL & GAS ROYALTY OWNER: ANTHONY BRUCE PARR, ET AL ACREAGE: 132.00±

DRILL  DRILL DEEPER  REDRILL  FRACTURE OR STIMULATE  PLUG OFF OLD FORMATION  PERFORATE NEW FORMATION

CONVERT  PLUG & ABANDON  CLEAN OUT & REPLUG  OTHER CHANGE  (SPECIFY)

TARGET FORMATION: MARCELLUS ESTIMATED DEPTH: 6,425 TVD 16,334.21 TMD

WELL OPERATOR: SWN PRODUCTION COMPANY, LLC DESIGNATED AGENT: DEE SOUTHALL

ADDRESS: P.O. BOX 1300 ADDRESS: P.O. BOX 1300

CITY: JANE LEW STATE: WV ZIP CODE: 26378 CITY: JANE LEW STATE: WV ZIP CODE: 26378

LEGEND:

- PROPOSED SURFACE HOLE / BOTTOM HOLE
- EXISTING / PRODUCING WELLHEAD
- LANDING POINT LOCATION
- EXISTING WATER WELL
- EXISTING SPRING
- SURVEYED BOUNDARY
- DRILLING UNIT
- LEASE BOUNDARY
- PROPOSED PATH

REVISIONS:

DATE: 03-13-2018

DRAWN BY: K.E.S.

SCALE: 1" = 2000'

DRAWING NO: 172-289

WELL LOCATION PLAT

477 209 00257



CIVIL & ENVIRONMENTAL CONSULTANTS, INC.  
 600 MARKETPLACE AVENUE, SUITE 200  
 BRIDGEPORT, WV 26330  
 304-933-3119

WELL BORE TABLE FOR SURFACE OWNERS		
TRACT	SURFACE OWNER	TAX PARCEL
1	ANTHONY BRUCE PARR, SANDRA L. PARR, RAYMOND LEE, NANCY J. PARR, MICHAEL MAHAN AND PAULA MAHAN	03-B49-0005
2	ANTHONY PARR, SANDRA PARR, RAYMOND PARR, NANCY PARR, LEONARD BOYCE AND KAREN BOYCE	03-B49-0004
3	WARREN JAMES AND PATRICIA MCKEEN	03-B49-0003
4	CLIFFORD E. COUNSELMAN	03-B49-0002
5	CLIFFORD E. COUNSELMAN	03-B44-0013
6	STATE OF WEST VIRGINIA DEPARTMENT OF COMMERCE, DIVISION OF NATURAL RESOURCES, WILDLIFE RESOURCES SECTION	03-B44-0014
7	GENE CHARLES VALENTINE TRUST	03-B43-0028

ADJOINING OWNERS TABLE		
TRACT	SURFACE OWNER	TAX PARCEL
A	PHILLIS A. SWAIN	03-B44-0010
B	PHILLIS A. SWAIN	03-B44-0009
C	PHILLIS A. SWAIN	03-B44-0008
D	NEEL CURTIS LEE & LOUANN L.	03-B44-0007
E	MAIN MILDRED	03-B44-0006
F	CHARLES TOWARD JR. AND JAYME L. DEVOS	03-B44-0012
G	LELAND MACKAY	03-B44-0014.1
H	ANTHONY BRUCE PARR, SANDRA L. PARR, RAYMOND LEE, NANCY J. PARR, MICHAEL MAHAN AND PAULA MAHAN	024-00-00-0007
I	WEST VIRGINIA BUREAU OF COMMERCE, DIVISION OF NATURAL RESOURCES, PUBLIC LAND CORPORATION	03-B49-0001
J	DONNI SAMUEL J. & MELANE	03-B43-0057
K	GENE CHARLES VALENTINE TRUST	03-B43-0049.3
L	MARY E. COLLINS	03-B43-0049
M	BETHANY COLLEGE	03-B38-0031
N	UNKNOWN HEIRS OR ASSIGNS OF CLYDE B. ROBERTS	03-B43-29
O	OWEN MARK W. (1/2) AND KRUETZ VIRGINIA BEALL (1/2)	03-B38-0024

06/08/2018

REVISIONS:	COMPANY:		
	OPERATOR'S	SANDRA PARR BRK	
	WELL #:	201H	
	DISTRICT:	COUNTY:	STATE:
	BUFFALO DISTRICT	BROOKE	WV
			DATE: 03-13-2018
			DRAWN BY: K.E.S.
			SCALE: N/A
			DRAWING NO: 172-289
			WELL LOCATION PLAT 2