

Longitude: 80°35'00" (SHL)

SURFACE HOLE 10823'

BOTTOM HOLE 8961'

Longitude: 80°35'00" (BHL)



CIVIL & ENVIRONMENTAL CONSULTANTS, INC.
600 MARKETPLACE AVENUE, SUITE 200
BRIDGEPORT, WV 26330
304-933-3119

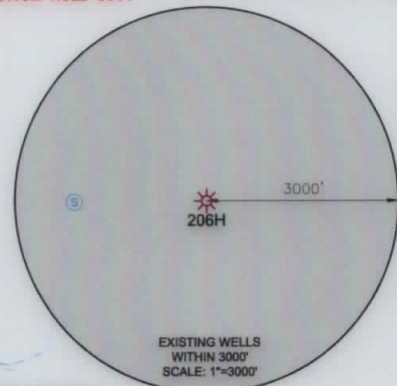
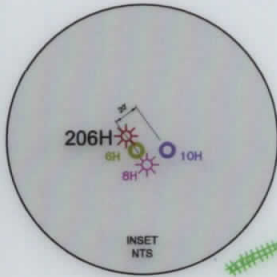

EXISTING WELLS WITHIN 3000' SCALE: 1"=3000'

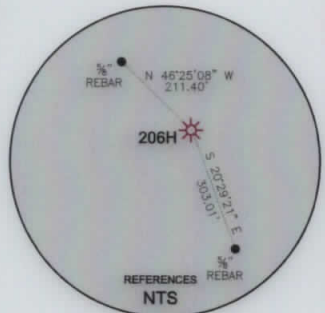

REFERENCES NTS

GRID NORTH
UTM, NAD83 DATUM, ZONE 17, US FT

BOTTOM HOLE 8068'

SURFACE HOLE 14507'

Latitude: 40°15'00" (BHL)

Latitude: 40°17'30" (SHL)

Table with 6 rows: SURFACE HOLE LOCATION (SHL), LANDING POINT (LPL), BOTTOM HOLE LOCATION (BHL), SURFACE HOLE LOCATION (SHL), LANDING POINT (LPL), BOTTOM HOLE LOCATION (BHL). Each row contains UTM coordinates.

WELL RESTRICTIONS

- 1. NO OCCUPIED DWELLINGS > 2500 SQ FT. WITHIN 625 FEET OF CENTER OF PAD.
2. NO AGRICULTURE BUILDINGS > 2500 SQ FT. WITHIN 625 FEET OF CENTER OF PAD.
3. WATER WELLS OR DEVELOPED SPRINGS ARE WITHIN 2,068 FEET OF PROPOSED WELL.
4. PERENNIAL STREAMS, LAKES, PONDS, OR RESERVOIRS WITHIN 800 FEET OF THE LIMITS OF DISTURBANCE.
5. NO NATURALLY PRODUCING TROUT STREAM WITHIN 300 FEET OF LIMITS OF DISTURBANCE.
6. NO GROUND INTAKE OR PUBLIC WATER SUPPLY WITHIN 1000 FEET OF WELL PAD, LIMITS OF DISTURBANCE, E & S CONTROLS OR PUBLIC WATER SUPPLY.

NOTES ON SURVEY

- 1. SURFACE AND ROYALTY OWNER INFORMATION AND THEIR BOUNDARIES SHOWN HEREON WERE PLOTTED FROM DEEDS AND/OR TAX PARCEL MAPS PROVIDED BY CLIENT AND/OR FIELD LOCATIONS.
2. THIS PLAT DOES NOT REPRESENT A BOUNDARY SURVEY OF THE PARCELS SHOWN HEREON.
4. ALL INSETS ARE GRID NORTH UNLESS OTHERWISE DEPICTED.

3000 0 3000



GRAPHIC SCALE IN FEET

I, THE UNDERSIGNED, HEREBY CERTIFY THAT THIS PLAT IS CORRECT TO THE BEST OF MY KNOWLEDGE AND BELIEF AND SHOWS ALL THE INFORMATION REQUIRED BY LAW AND REGULATIONS ISSUED AND PRESCRIBED BY THE DEPARTMENT OF ENVIRONMENTAL PROTECTION.

P.S. 991

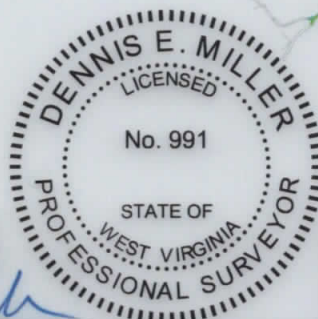

AS-DRILLED

COMPANY:

SWN

SWN R+V+
A

Production Company, LLC

Production Company™



(+) DENOTES LOCATION OF WELL ON UNITED STATES TOPOGRAPHIC MAPS

WVDEP
OFFICE OF OIL & GAS
601 57TH STREET
CHARLESTON, WV 25034

MINIMUM DEGREE OF ACCURACY: 1/200
PROVEN SOURCE OF ELEVATION: SURVEY GRADE GPS (NAVD 88, US FT)

OPERATOR'S WELL #: VIOLET COSS BRK 206H
API WELL #: 47 STATE 009 COUNTY 00241 PERMIT

Form with well details: WELL TYPE (Production), WATERSHED (Upper Ohio Wheeling), DISTRICT (Buffalo), COUNTY (Brooke), SURFACE OWNER (Linda Coen), OIL & GAS ROYALTY OWNER (Violet L Coen), DRILL (Asdrilled), TARGET FORMATION (Marcellus), ESTIMATED DEPTH (5,809.52 TVD).

WELL OPERATOR: SWN PRODUCTION COMPANY, LLC
ADDRESS: 1300 FORT PIERPONT DRIVE, STE 201
CITY: MORGANTOWN STATE: WV ZIP CODE: 26508
DESIGNATED AGENT: BRITTANY WOODY
ADDRESS: 1300 FORT PIERPONT DRIVE, STE 201
CITY: MORGANTOWN STATE: WV ZIP CODE: 26508

Table with 2 columns: LEGEND (Proposed surface hole, Existing wellhead, Landing point, Existing water well, Existing spring, Surveyed boundary, Drilling unit, Lease boundary, Asdrilled path, Proposed path) and REVISIONS (Date: 4-14-2021, Drawn by: K.E.S., Scale: 1" = 3000', Drawing no: 172-287, Well location plat).



CIVIL & ENVIRONMENTAL CONSULTANTS, INC.
 600 MARKETPLACE AVENUE, SUITE 200
 BRIDGEPORT, WV 26330
 304-933-3119

WELL BORE TABLE FOR SURFACE / ROYALTY OWNERS			
TRACT	SURFACE OWNER (S) / ROYALTY OWNER (R)	TAX PARCEL	ACRES
1	EVERETT ALAN COEN, LORRIE ELLEN WOOLWINE, MELINDA WOOLWINE, MICHAEL TODD COEN (S&R)	3-B32-25	224.303
2	HFS LIMITED LIABILITY COMPANY	3-B27-12	67.95
3	BROOKE CO. RT. 2		
4	WEST VIRGINIA DEPARTMENT OF HIGHWAYS	3-B27-11	
5	CAMPBELL TRANSPORTATION COMPANY, INC.	3-B27-10	12.48
6	STATE OF WEST VIRGINIA		
7	COSS ROAD FARM, LLC	3-B31-114	183.23
8	CHARLES D. BLACKBURN	3-B32-21	10.00
9	GREEN RUN ROAD		
10	MASLO FARMS LLC A PENNSYLVANIA LLC	3-B32-20	78.86
11	MICHAEL & MELISSA BILAK	3-B32-174	21.83
12	MICHAEL S. & MELISSA A. BILAK (SURV)	3-B32-177	1.47
13	MC CORD HILL ROAD		
14	BOYD NILA; MCCORD CLINTON; JOHN JOHN; REBA; JONES CA	3-B32-146	29.057
15	RONALD D. & JEAN A. TAYLOR	3-B37-11	11.96
16	HARLEY J. LEMASTERS	3-B37-12	2.00
17	HARLEY J. LEMASTERS	3-B37-13	33.54

ADJOINING OWNERS TABLE			
TRACT	SURFACE OWNER	TAX PARCEL	ACRES
A	DANIEL P. LOMBARDI	3-B27K-211	6.62
B	NORMA JEAN LILLY, WIDOW	3-B27-17	45.72
C	GERTRUDE LOUISE MCSHANE ROBIE & PATRICK J. MCSHANE, TRUSTEE	3-B32-29	84.79
D	TONY J. CASTILLO; RICHARD R. OSTRANDER (S)	3-B32-28	20.83
E	TONY J. CASTILLO; RICHARD R. OSTRANDER (S)	3-B32-27	10
F	JAMES SCOTT GEAR	3-B32-26	3.11
G	WILLIAM & CAROLYN WALNOHA (S)	3-B32-14	1.34
H	JOHN PORTER & BRIGITTE ROGERS (S)	3-B32-15	0.568
I	DOROTHY L. STEVENS	3-B32-16	2.09
J	RUTH BERNADINE HART	3-B32-22.01	0.262
K	WALNOHA WILLIAM RUSSELL, HART RUTH; THARP MARY FRANC	3-B32-22	0.244
L	WILLIAM RUSSELL WALNOHA	3-B32-22.02	0.259
M	CAROLYN SUE WALNOHA	3-B32-17	4.00
N	MARY CATHERINE WALNOHA	3-B32-18	2.00
O	JOSEPH G. VINDERMAN, JR., JERRY VINDERMAN, DAVID G. VINDERMAN AND LINDA J.R. VINDERMAN, ARNOLD VINDERMAN, LAWRENCE VINDERMAN, GEORGE VINDERMAN, THERESA MCQUILLAN	3-B32-13	43.38
P	MASLO FARMS, LLC	3-B32-19	59.66
Q	RALPH G. JOHNSTON; ROBERT JOHNSTON; KENNETH D. JOHNSTON, DANIEL JOHNSTON, ET AL	3-B32-180	39.862
R	ROBERT A. JOHNSTON, RALPH G. JOHNSTON, JOYCE A. BRADY, BRIAN W. JOHNSTON, DANIEL L. JOHNSTON, KENNETH D. JOHNSTON	3-B32-179	1.17
S	RALPH G. & TRACY A. JOHNSTON	3-B32-181	0.602
T	ROBERT A. & JANICE K. JOHNSTON	3-B32-183	0.403
U	ROBERT A. & JANICE K. JOHNSTON	3-B32-182	0.72
V	NILA H. MCCORD BOYD	3-B32-145	2.42
W	NILA H. MCCORD BOYD	3-B32-144	2.21
X	NILA H. MCCORD BOYD	3-B32-142	5.09
Y	CITY OF WELLISBURG COMBINE WATER AND SEWER BOARD	3-B32-140.2	89.58
Z	SCHIAPPA AND COMPANY INC	3-B37-22	145.963
AA	JAMES W. & DENISE L. MYERS (S)	3-B37-14	5.00
BB	THOMAS & CAROLYN CARBASHO (S)	3-B37-15	5.00
CC	MICHAEL MCCLLOUD	3-B37-18	1.08
DD	RONALD D. & JEAN A. TAYLOR	3-B37-19	1.08
EE	HARLEY J. LEMASTERS	3-B37-20	1.20
FF	EDWARD MICHAEL EVANKA SR.	3-B37-05	5.44
GG	HARLEY J. LEMASTERS	3-B37-09	4.14

ADJOINING OWNERS TABLE			
TRACT	SURFACE OWNER	TAX PARCEL	ACRES
HH	ALICE AND PRESLY BRYAN	3-B37-10	0.556
II	HARLEY J. LEMASTERS	3-B32-149	11.13
JJ	KEVIN S. WEEKLEY	3-B32-151	10.20
KK	JOHN AND NEELEY BROWN	3-B32-154	10.00
LL	KENNETH IVERSON	3-B32-155	2.39
MM	VINCE AND PEARL GALLOWAY	3-B32-156	1.90
NN	VIOLET I. BLAKE	3-B32-148	1.61
OO	THOMAS MURDOCK	3-B32-147	1.41
PP	MICHAEL S. & MELISSA D. BIELAK (S)	3-B32-176	0.49
QQ	SHIRLEY SPENCER	3-B32-175	1.50
RR	HUNTER WALLACE	3-B32-159	1.386
SS	WILLIAM L. & CATHERINE SPENCER	3-B32-160	0.31
TT	WILLIAM L. & CATHERINE SPENCER	3-B32-161	0.30
UU	DOROTHY J. MACGREGOR	3-B32-162	1.36
VV	DONALD THOMAS AND STEVEN THOMAS	3-B32-169	1.105
WW	JOSEPH PETTINI	3-B32-172	2.006
XX	PAMELA J. HUFF	3-B32-172.1	0.531
YY	PAMELA J. HUFF	3-B32-173	1.146
ZZ	CHERYLL L. STEMPEL	3-B31-102	3.48
AAA	STEVEN S. AND DEBRA L. IVERSON	3-B31-101	2.09
BBB	HAROLD STARKEY	3-B31-104	34.04
CCC	JOSEPH C. & KRISTIE J. GASVODA	3-B31-111	0.94
DDD	JOSEPH C. & KRISTIE J. GASVODA	3-B31-112	0.17
EEE	KEITH R. FRANCIS	3-B31-113	26.33
FFF	THOMAS & PAULINE SALEM	3-B31-138	7.73
GGG	RODGER & CONNIE SUMMERS	3-B31-137	11.35
HHH	JERRY C. & ANGEL L. MCCLELLAND	3-B31-136	9.18
III	CURTIS R. & DONNA J. BARONIO (S)	3-B31-135	7.32
JJJ	RONALD C. PARKS	3-B31-134	8.15
KKK	ROBERT J. SR. & MARGARET E. STEWART (S)	3-B31-133	7.88
LLL	ROBERT J. SR. & MARGARET E. STEWART (S)	3-B31-132	7.39
MMM	RAY WALNOHA	3-B31-115	9.27
NNN	AUDREY L. HOLDEN	3-B31-116	0.736
OOO	BARBARA A. TAYLOR	3-B31-117	5.0
PPP	COSS ROAD FARM, LLC	3-B31-118	17.18
QQQ	COSS ROAD FARM, LLC	3-B31-119	5.35
RRR	EDWARD MACIAK	3-B31-120	1.37
SSS	JAMES L. & SONDR A. ELLIOTT	3-B31-121	5.48
TTT	HFS LIMITED LIABILITY COMPANY	3-B31-1	23.87
UUU	CAMPBELL TRANSPORTATION COMPANY INC	3-B27-8	0.41
VVV	GREG PROVENZANO	3-B27-9	0.09

API WELL #: **47** **009** **00241**
 STATE COUNTY PERMIT

08/27/2021

REVISIONS:	COMPANY:		
	OPERATOR'S		DATE: 4-14-2021
	WELL #:		DRAWN BY: K.E.S.
	DISTRICT:	COUNTY:	SCALE: N/A
	BUFFALO	BROOKE	DRAWING NO: 172-287
		STATE:	WELL LOCATION PLAT 2
		WV	