

THRASHER

THE THRASHER GROUP, INC.
600 WHITE OAKS BLVD.
BRIDGEPORT, WV 26330
PHONE 304-624-4108

NOTES ON SURVEY

- COORDINATES SYSTEM IS UTM, NAD 83 DATUM, ZONE 17, U.S. FOOT AND WELL COORDINATES ESTABLISHED USING SURVEY GRADE GPS.
- SURFACE AND ROYALTY OWNER INFORMATION AND THEIR BOUNDARIES SHOWN HEREON WERE PLOTTED FROM DEEDS AND/OR TAX PARCEL MAPS PROVIDED BY CLIENT AND FIELD LOCATIONS.
- THIS PLAT DOES NOT REPRESENT A BOUNDARY SURVEY OF THE PARCELS SHOWN HEREON.
- NO DWELLINGS AND BUILDINGS WITHIN 625 FEET OF PROPOSED CENTER OF PAD.
- NO WATER WELLS OR DEVELOPED SPRINGS WITHIN 250 FEET OF PROPOSED WELL.
- NO PERENNIAL STREAMS, LAKES, PONDS, RESERVOIRS OR WETLANDS WITHIN 100 FEET OF THE LIMITS OF DISTURBANCE.
- NO NATURALLY PRODUCING TROUT STREAM WITHIN 300 FEET OF LIMITS OF DISTURBANCE.

ADJOINING OWNERS TABLE

TRACT	SURFACE OWNER	TAX PARCEL	ACRES
A	JOHN D. & KAREN DUFFIELD	04-CC12-39	0.485
B	JOHN D. & KAREN DUFFIELD	04-CC12-40	0.417
C	DAVID A. & GERALDINE ODD	04-CC12-41	0.47
D	MARTY R. & DIANE L. LONGWELL	04-CC12-42	3.169
E	BRIAN B. & STEPHANIE J. BUBECK	04-CC12-39	0.34
F	TIMOTHY BRIAN CUNNINGHAM	04-CC16-15	1.22
G	STATE OF WV DNR PUBLIC LAND CORP.	04-CC16-18	2.16
H	STATE OF WV DNR PUBLIC LAND CORP.	04-CC16-17	1.187
I	STATE OF WV DNR PUBLIC LAND CORP.	04-CC16-21	0.19
J	STATE OF WV DNR PUBLIC LAND CORP.	04-CC16-20	1.81

SURFACE HOLE LOCATION (SHL):

UTM (NAD83, ZONE 17, METERS):
NORTHING: 4,465,691.351
EASTING: 540,102.815

LANDING POINT (LPL):

UTM (NAD83, ZONE 17, METERS):
NORTHING: 4,465,499.613
EASTING: 539,706.123

BOTTOM HOLE LOCATION (BHL):

UTM (NAD83, ZONE 17, METERS):
NORTHING: 4,463,323.647
EASTING: 540,811.236



WELL BORE TABLE FOR SURFACE / ROYALTY OWNERS

TRACT	SURFACE OWNER (S) / ROYALTY OWNER (R)	TAX PARCEL	ACRES
1	STATE OF WEST VIRGINIA BUREAU OF COMMERCE-DIVISION OF NATURAL RESOURCE PUBLIC LAND CORPORATION	04-CC16-19	169.43
2	DANNY D. & MARCIA TICE	04-CC16-16	6.243
3	NATHANAEI J. & AMY KUZMA	04-CC16-26.1	5.001
4	ARRISSA M. SUTER & KENNETH H. COCHRN	04-CC16-27	6.10
5	KURT STECIK	04-CC16-29	2.80
6	FAMILY CONNECTION INC.	04-CC16-26	6.04
7	DOMINIC A. & ALICIA F. ABATE	04-CC16-30	2.76
8	JAME A. & GERALDINE A. RAHR	04-CC16-34	2.468
9	DONNA K. ROSS & WILLIAM J. PAULES	04-CC16-14	2.00
10	STATE OF WEST VIRGINIA BUREAU OF COMMERCE-DIVISION OF NATURAL RESOURCE PUBLIC LAND CORPORATION	04-CC16-11	77.882
11	STATE OF WEST VIRGINIA BUREAU OF COMMERCE-DIVISION OF NATURAL RESOURCE PUBLIC LAND CORPORATION	04-CC16-23.1	117.72
12	STATE OF WEST VIRGINIA BUREAU OF COMMERCE-DIVISION OF NATURAL RESOURCE PUBLIC LAND CORPORATION	04-CC16-23	80.10
13	STATE OF WEST VIRGINIA BUREAU OF COMMERCE-DIVISION OF NATURAL RESOURCE PUBLIC LAND CORPORATION	04-CC16-24	74.00

LINE	BEARING	DISTANCE
L1	S 64°12'13\" W	1445.53'
L2	S 26°55'29\" E	8006.91'
L3	N 34°44'08\" W	1286.40'
L4	S 47°38'09\" E	1458.90'

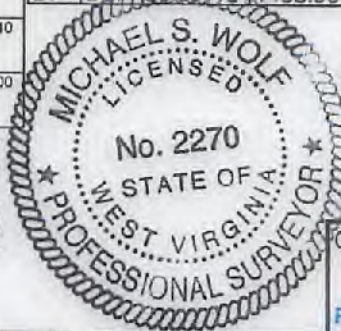

I, THE UNDERSIGNED, HEREBY CERTIFY THAT THIS PLAT IS CORRECT TO THE BEST OF MY KNOWLEDGE AND BELIEF AND SHOWS ALL THE INFORMATION REQUIRED BY LAW AND REGULATIONS ISSUED AND PRESCRIBED BY THE DEPARTMENT OF ENVIRONMENTAL PROTECTION.

P.S. 2270



(+) DENOTES LOCATION OF WELL ON UNITED STATES TOPOGRAPHIC MAPS
WVDEP
OFFICE OF OIL & GAS
601 57TH STREET
CHARLESTON, WV 25034

MINIMUM DEGREE OF ACCURACY: 1/200
PROVEN SURVEY SOURCE OF GRADE GPS ELEVATION: (NAVD 88, US FT)

COMPANY: SWN Production Company, LLC

STATE OF WV DNR B BRK
OPERATOR'S WELL #: 206H
API WELL #: 47 009 00238
STATE COUNTY PERMIT

WELL TYPE: OIL WASTE DISPOSAL PRODUCTION DEEP GAS LIQUID INJECTION STORAGE SHALLOW
WATERSHED: UPPER OHIO NORTH ELEVATION: 1200.8'
DISTRICT: CROSS CREEK COUNTY: BROOKE QUADRANGLE: STEUBENVILLE EAST
SURFACE OWNER: STATE OF WV BUREAU OF COMMERCE-DNR PUBLIC LAND CORPORATION ACREAGE: ± 169.43
OIL & GAS ROYALTY OWNER: STATE OF WV BUREAU OF COMMERCE-DNR PUBLIC LAND CORPORATION ACREAGE: ± 169.43
DRILL DRILL DEEPER REDRILL FRACTURE OR STIMULATE PLUG OFF OLD FORMATION PERFORATE NEW FORMATION
CONVERT PLUG & ABANDON CLEAN OUT & REPLUG OTHER CHANGE (SPECIFY)
TARGET FORMATION: MARCELLUS ESTIMATED DEPTH: 5,789 TVD 14,260 TMD

WELL OPERATOR: SWN PRODUCTION COMPANY, LLC DESIGNATED AGENT: DEE SOUTHALL
ADDRESS: P.O. BOX 1300 ADDRESS: P.O. BOX 1300
CITY: JANE LEW STATE: WV ZIP CODE: 26378 CITY: JANE LEW STATE: WV ZIP CODE: 26378

LEGEND:
○ PROPOSED SURFACE HOLE / BOTTOM HOLE
* EXISTING / PRODUCING WELLHEAD
LPL LANDING POINT LOCATION
W EXISTING WATER WELL
S EXISTING SPRING
--- SURVEYED BOUNDARY
--- DRILLING UNIT
--- LEASE BOUNDARY
--- PROPOSED PATH

REVISIONS: DATE: 12-18-2017
DRAWN BY: R. DOERR
SCALE: 1" = 2000'
DRAWING NO: 030-3233
WELL LOCATION PLAT

SHL 7,803'

BHL 5,479'
Latitude: 40°22'30"

GRID NORTH
UTM, NAD83 DATUM, ZONE 17, US FT

Longitude: 80°30'00"

SHL 12,525'

BHL 20,293'

GRAPHIC SCALE IN FEET

01/05/2018

THRASHER

THE THRASHER GROUP, INC.
600 WHITE OAKS BLVD.
BRIDGEPORT, WV 26330
PHONE 304-624-4108

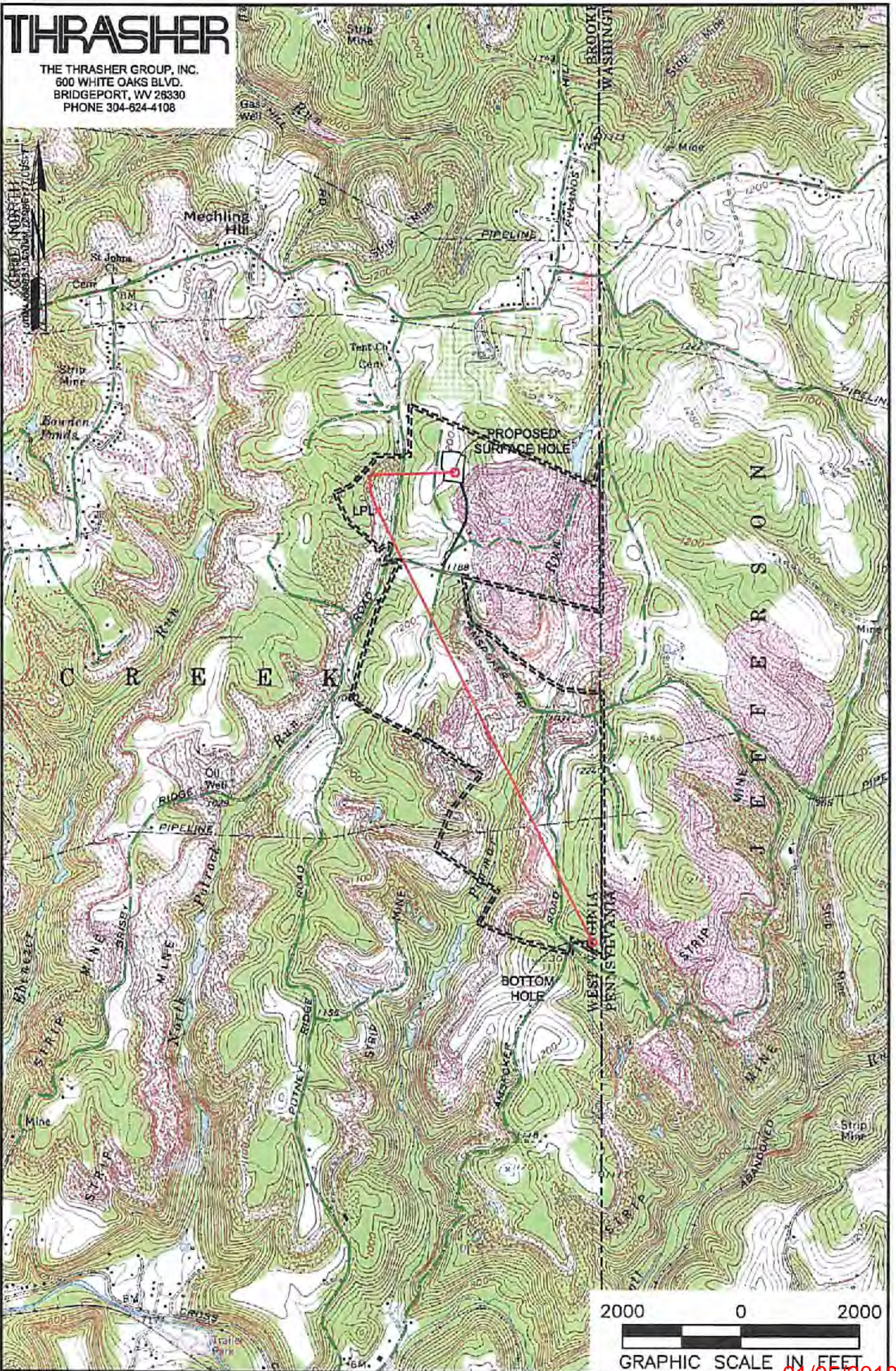

NOTES ON SURVEY

1. SURFACE AND ROYALTY OWNER INFORMATION AND THEIR BOUNDARIES SHOWN HEREON WERE PLOTTED FROM DEEDS AND/OR TAX PARCEL MAPS PROVIDED BY CLIENT AND/OR FIELD LOCATIONS.
2. THIS PLAT DOES NOT REPRESENT A BOUNDARY SURVEY OF THE PARCELS SHOWN HEREON.
3. ALL INSETS ARE GRID NORTH UNLESS OTHERWISE DEPICTED.

LEGEND:

- PROPOSED SURFACE HOLE / BOTTOM HOLE
- EXISTING / PRODUCING WELLHEAD
- LPL*
- FLOOD PLAIN
- ACCESS ROAD
- PUBLIC ROAD
- ACCESS ROAD TO PREV. SITE
- LEASE BOUNDARY
- PROPOSED PATH

WELL OPERATOR: SWN PRODUCTION COMPANY, LLC	WELL (FARM) NAME: STATE OF WV DNR B BRK	WELL # 206H	SERIAL # XXXX
ADDRESS: P.O. BOX 1300 JANE LEW, WV 26378	COUNTY - CODE BROOKE - 009	DISTRICT; CROSS CREEK	
SURFACE OWNER: STATE OF WV BUREAU OF COMERCE-DNR PUBLIC LAND CORP.	USGS 7 1/2 QUADRANGLE MAP NAME STEBENVILLE, WV		

01/05/2018