

Longitude: 80°32'30" SURFACE HOLE 8493'

Longitude: 80°32'30" BOTTOM HOLE 11239'

Latitude: 40°15'00" SURFACE HOLE 1203'

Latitude: 40°17'30" BOTTOM HOLE 7262'



CIVIL & ENVIRONMENTAL CONSULTANTS, INC.  
600 MARKETPLACE AVENUE, SUITE 200  
BRIDGEPORT, WV 26330  
304-933-3119

**SURFACE HOLE LOCATION (SHL):**

UTM (NAD83, ZONE 17, METERS):  
NORTHING: 4,455,197.663  
EASTING: 536,399.034  
LANDING POINT (LPL):

UTM (NAD83, ZONE 17, METERS):  
NORTHING: 4,455,441.004  
EASTING: 535,746.122

**BOTTOM HOLE LOCATION (BHL):**

UTM (NAD83, ZONE 17, METERS):  
NORTHING: 4,458,002.006  
EASTING: 535,545.388

**PERMIT SURFACE HOLE LOCATION (SHL):**

UTM (NAD83, ZONE 17, METERS):  
NORTHING: 4,455,197.616  
EASTING: 536,399.017

**PERMIT LANDING POINT (LPL):**

UTM (NAD83, ZONE 17, METERS):  
NORTHING: 4,455,311.339  
EASTING: 536,777.891

**PERMIT BOTTOM HOLE LOCATION (BHL):**

UTM (NAD83, ZONE 17, METERS):  
NORTHING: 4,458,001.461  
EASTING: 535,544.269

GRID NORTH  
UTM, NAD83 DATUM, ZONE 17, US FT

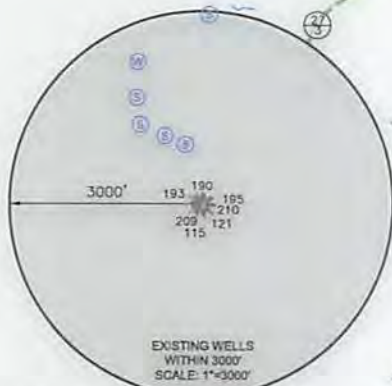
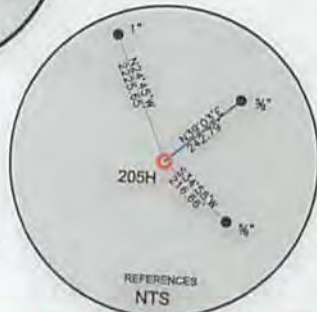
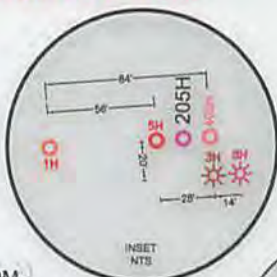

**AS-DRILLED**

**WELL RESTRICTIONS**

1. NO OCCUPIED DWELLINGS > 2500 SQ FT, WITHIN 625 FEET OF CENTER OF PAD.
2. NO AGRICULTURE BUILDINGS > 2500 SQ FT, WITHIN 625 FEET OF CENTER OF PAD.
3. WATER WELLS OR DEVELOPED SPRINGS ARE WITHIN 957 FEET OF PROPOSED WELL.
4. PERENNIAL STREAMS, LAKES, PONDS, OR RESERVOIRS WITHIN 800 FEET OF THE LIMITS OF DISTURBANCE.
5. NO NATURALLY PRODUCING TROUT STREAM WITHIN 300 FEET OF LIMITS OF DISTURBANCE.
6. NO GROUND INTAKE OR PUBLIC WATER SUPPLY WITHIN 1000 FEET OF WELL PAD, LIMITS OF DISTURBANCE, E & S CONTROLS OR PUBLIC WATER SUPPLY.

**NOTES ON SURVEY**

1. SURFACE AND ROYALTY OWNER INFORMATION AND THEIR BOUNDARIES SHOWN HEREON WERE PLOTTED FROM DEEDS AND/OR TAX PARCEL MAPS PROVIDED BY CLIENT AND/OR FIELD LOCATIONS.
2. THIS PLAN DOES NOT REPRESENT A BOUNDARY SURVEY OF THE PARCELS SHOWN HEREON.
3. ALL INSETS ARE GRID NORTH UNLESS OTHERWISE DEPICTED.

I, THE UNDERSIGNED, HEREBY CERTIFY THAT THIS PLAT IS CORRECT TO THE BEST OF MY KNOWLEDGE AND BELIEF AND SHOWS ALL THE INFORMATION REQUIRED BY LAW AND REGULATIONS ISSUED AND PRESCRIBED BY THE DEPARTMENT OF ENVIRONMENTAL PROTECTION.

P.S. 991



GRAPHIC SCALE IN FEET

COMPANY:



Production Company, LLC Production Company™

<p>(+) DENOTES LOCATION OF WELL ON UNITED STATES TOPOGRAPHIC MAPS WVDEP OFFICE OF OIL &amp; GAS 601 57TH STREET CHARLESTON, WV 25034</p>	MINIMUM DEGREE OF ACCURACY: 1/200 PROVEN SOURCE OF ELEVATION: SURVEY GRADE GPS (NAVD 88, US FT)	COMPANY: ALAN H. DEGARMO BRK OPERATOR'S WELL #: 205H API WELL #: 47 STATE 009 COUNTY 00191 PERMIT
	WELL TYPE: OIL <input type="checkbox"/> WASTE DISPOSAL <input type="checkbox"/> PRODUCTION <input checked="" type="checkbox"/> DEEP <input type="checkbox"/> GAS <input checked="" type="checkbox"/> LIQUID INJECTION <input type="checkbox"/> STORAGE <input type="checkbox"/> SHALLOW <input checked="" type="checkbox"/> WATERSHED: UPPER OHIO SOUTH DISTRICT: BUFFALO COUNTY: BROOKE SURFACE OWNER: ALAN H. DEGARMO & MARY KAY DEGARMO, LIFE ESTATE OIL & GAS ROYALTY OWNER: ALAN H. DEGARMO DRILL <input type="checkbox"/> DRILL DEEPER <input type="checkbox"/> REDRILL <input type="checkbox"/> FRACTURE OR STIMULATE <input type="checkbox"/> PLUG OFF OLD FORMATION <input type="checkbox"/> PERFORATE NEW FORMATION <input type="checkbox"/> CONVERT <input type="checkbox"/> PLUG & ABANDON <input type="checkbox"/> CLEAN OUT & REPLUG <input type="checkbox"/> OTHER CHANGE <input checked="" type="checkbox"/> (SPECIFY) <b>ASDRILLED</b> TARGET FORMATION: MARCELLUS ESTIMATED DEPTH: 5,838.04 TVD 15,675 TMD	WELL OPERATOR: SWN PRODUCTION COMPANY, LLC ADDRESS: P.O. BOX 1300 CITY: JANE LEW STATE: WV ZIP CODE: 26378 DESIGNATED AGENT: DEE SOUTHALL ADDRESS: P.O. BOX 1300 CITY: JANE LEW STATE: WV ZIP CODE: 26378
LEGEND: ○ PROPOSED SURFACE HOLE / BOTTOM HOLE * EXISTING / PRODUCING WELLHEAD LPL* LANDING POINT LOCATION ⊕ EXISTING WATER WELL ⊙ EXISTING SPRING	— SURVEYED BOUNDARY - - - DRILLING UNIT = = = LEASE BOUNDARY - - - ASDRILLED PATH - - - PROPOSED PATH	REVISIONS:  DATE: 04-18-2018 DRAWN BY: K.E.S. SCALE: 1" = 2000' DRAWING NO: 164-764 WELL LOCATION PLAT



CIVIL & ENVIRONMENTAL CONSULTANTS, INC.  
 600 MARKETPLACE AVENUE, SUITE 200  
 BRIDGEPORT, WV 26330  
 304-933-3119

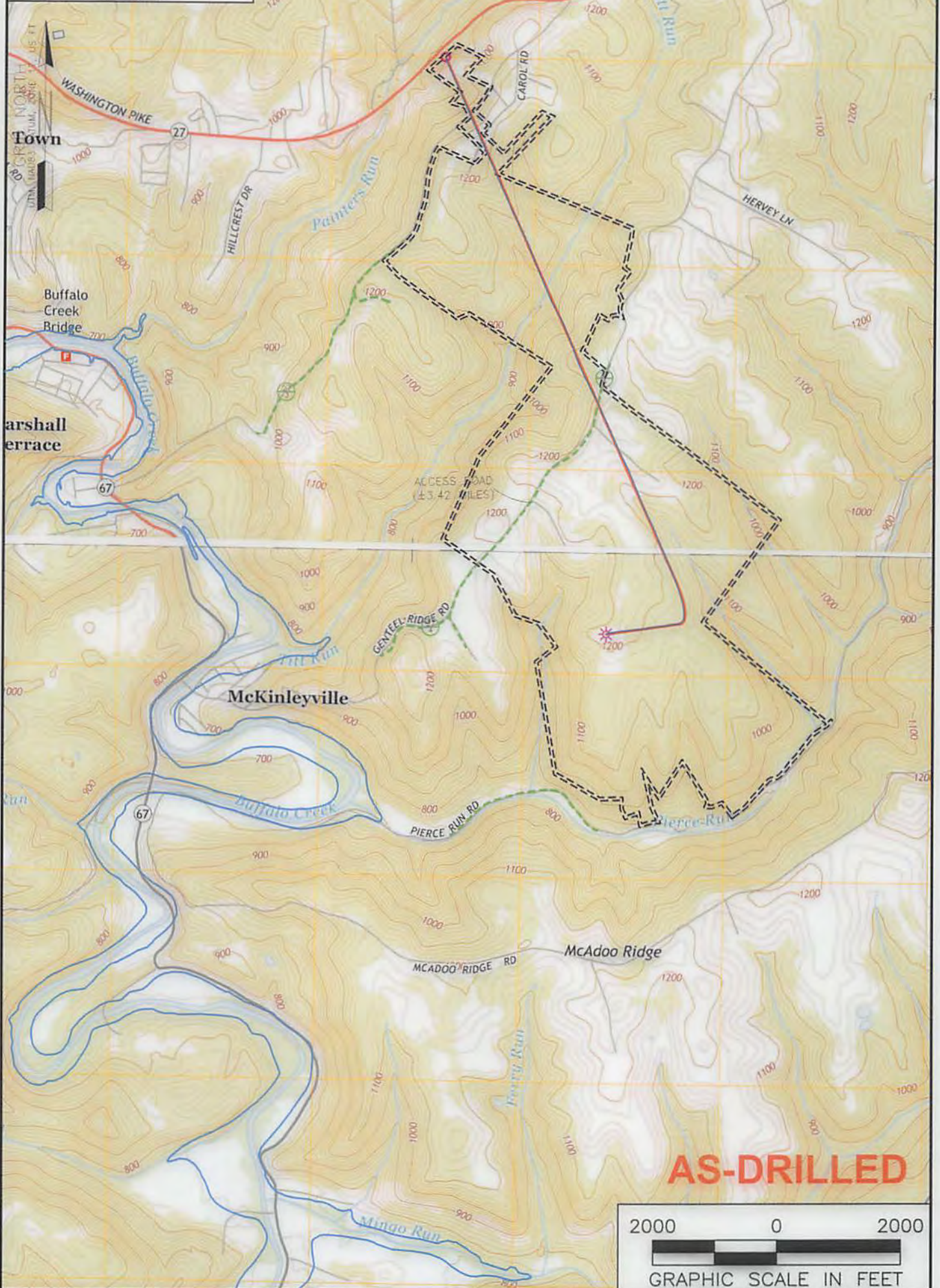

**AS-DRILLED**



**NOTES ON SURVEY**  
 SURFACE AND ROYALTY OWNER INFORMATION AND THEIR BOUNDARIES SHOWN HEREON WERE PLOTTED FROM DEEDS AND/OR TAX PARCEL MAPS PROVIDED BY CLIENT AND/OR FIELD LOCATIONS.  
 1. THIS PLAT DOES NOT REPRESENT A BOUNDARY SURVEY OF THE PARCELS SHOWN HEREON.  
 4. ALL INSERTS ARE GRID NORTH UNLESS OTHERWISE DEPICTED.

**LEGEND:**  
 ○ PROPOSED SURFACE HOLE / BOTTOM HOLE  
 ☆ EXISTING / PRODUCING WELLHEAD  
 LPL ☆ LANDING POINT LOCATION  
 (Blue outline) FLOOD FLAIN  
 (Green dashed line) ACCESS ROAD  
 (Black dashed line) PUBLIC ROAD  
 (Red dashed line) ACCESS ROAD TO PREV. SITE  
 (Black dashed line) LEASE BOUNDARY  
 (Red solid line) PROPOSED PATH

<b>WELL OPERATOR:</b> SWN PRODUCTION COMPANY, LLC	<b>WELL (FARM) NAME:</b> ALAN H. DEGARMO BRK	<b>WELL #</b> 205H	<b>SERIAL #</b> XXXX
<b>ADDRESS:</b> P.O. BOX 1300 JANE LEW, WV 26378	<b>COUNTY - CODE</b> BROOKE - 009	<b>DISTRICT;</b> BUFFALO	
<b>SURFACE OWNER:</b> ALAN H. DEGARMO & MARY KAY DEGARMO, LIFE ESTATE	<b>USGS 7 1/2 QUADRANGLE MAP NAME</b> BETHANY, WV		

07/20/2018