

# THRASHER

THE THRASHER GROUP, INC.  
600 WHITE OAKS BLVD.  
BRIDGEPORT, WV 26330  
PHONE 304-624-4108

TRACT	SURFACE OWNER	TAX PARCEL	ACRES
1	THURMAN O. SPEECE JR, GOLDIE M. STANLEY	3-B42-43	15.57
2	THURMAN O. SPEECE JR, GOLDIE M. STANLEY	3-B42-45	14.20
3	WILLIAM A. SPERRINGER II & JENNA L. SPERRINGER	3-B37-78	2.36
4	BENJAMIN M. MOSA & CHRISTINE L. HEISE	3-B37-74	24.41
5	BENJAMIN M. MOSA & CHRISTINE L. HEISE	3-B37-75	1.29

**NOTES ON SURVEY**

- COORDINATES SYSTEM IS UTM, NAD 83 DATUM, ZONE 17, U.S. FOOT AND WELL COORDINATES ESTABLISHED USING SURVEY GRADE GPS.
- SURFACE AND ROYALTY OWNER INFORMATION AND THEIR BOUNDARIES SHOWN HEREON WERE PLOTTED FROM DEEDS AND/OR TAX PARCEL MAPS PROVIDED BY CLIENT AND FIELD LOCATIONS.
- THIS PLAT DOES NOT REPRESENT A BOUNDARY SURVEY OF THE PARCELS SHOWN HEREON.
- NO DWELLINGS AND BUILDINGS WITHIN 625 FEET OF PROPOSED OF CENTER OF PAD.
- NO WATER WELLS OR DEVELOPED SPRINGS WITHIN 250 FEET OF PROPOSED WELL.
- NO PERENNIAL STREAMS, LAKES, PONDS, RESERVOIRS OR WETLANDS WITHIN 100 FEET OF THE LIMITS OF DISTURBANCE.
- NO NATURALLY PRODUCING TROUT STREAM WITHIN 300 FEET OF LIMITS OF DISTURBANCE.

GRID NORTH  
UTM, NAD83 DATUM, ZONE 17, US FT

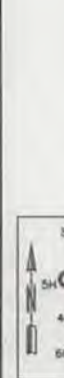

**SWN PRODUCTION COMPANY, LLC SURFACE HOLES**  
1. THURMAN SPEECE BRK 5H  
2. THURMAN SPEECE BRK 205H  
3. THURMAN SPEECE BRK 405H  
4. THURMAN SPEECE BRK 605H

LOCATION	UTM (NAD83, ZONE 17, METERS):
<b>SURFACE HOLE LOCATION (SHL):</b>	NORTHING: 4,448,885.599 EASTING: 534,895.273
<b>LANDING POINT LOCATION (LPL):</b>	UTM (NAD83, ZONE 17, METERS): NORTHING: 4,449,403.020 EASTING: 535,282.619
<b>BOTTOM HOLE LOCATION (BHL):</b>	UTM (NAD83, ZONE 17, METERS): NORTHING: 4,452,164.217 EASTING: 534,121.088

**THURMAN SPEECE BRK 205H SURFACE HOLE**

LOCATION	UTM (NAD83, ZONE 17, METERS):
<b>SURFACE HOLE LOCATION (SHL):</b>	NORTHING: 4,448,885.599 EASTING: 534,895.273
<b>LANDING POINT LOCATION (LPL):</b>	UTM (NAD83, ZONE 17, METERS): NORTHING: 4,449,535.361 EASTING: 535,234.561
<b>BOTTOM HOLE LOCATION (BHL):</b>	UTM (NAD83, ZONE 17, METERS): NORTHING: 4,452,164.205 EASTING: 534,126.623

ID	ADJACENT	TAX PARCEL
A	CAROL SALER, CAROL MCDONALD, JENNIFER FERDINAND	3-B37-71
B	WILLIAM E. JOHNSTON AND HAZEL E. JOHNSTON	3-B37-73
C	THEODORE W. BURNELL	3-B37-68
D	LOUISE KATH	3-B37-67
E	JOHN B. SAUGHERTY	3-B37-65
F	WINDSOR POWER HOUSE COAL CO	3-B42-48
G	THURMAN O. SPEECE, JR. AND GOLDIE M. STANLEY	3-B42-47

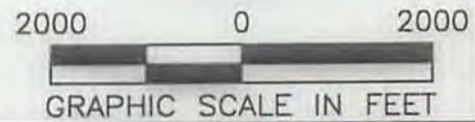
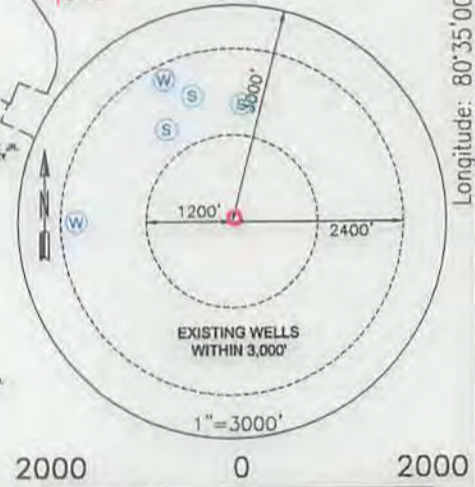

I, THE UNDERSIGNED, HEREBY CERTIFY THAT THIS PLAT IS CORRECT TO THE BEST OF MY KNOWLEDGE AND BELIEF AND SHOWS ALL THE INFORMATION REQUIRED BY LAW AND REGULATIONS ISSUED AND PRESCRIBED BY THE DEPARTMENT OF ENVIRONMENTAL PROTECTION.



P.S. 2270

<p>(+) DENOTES LOCATION OF WELL ON UNITED STATES TOPOGRAPHIC MAPS</p> <p>WVDEP OFFICE OF OIL &amp; GAS 601 57TH STREET CHARLESTON, WV 25034</p>	MINIMUM DEGREE OF ACCURACY: 1/200 PROVEN SURVEY SOURCE OF ELEVATION: SURVEY GRADE GPS (NAVD 88, US FT)	COMPANY: SWN Production Company, LLC OPERATOR'S WELL #: THURMAN SPEECE BRK 205H API WELL #: 47 STATE COUNTY PERMIT
	WELL TYPE: OIL <input type="checkbox"/> WASTE DISPOSAL <input type="checkbox"/> PRODUCTION <input checked="" type="checkbox"/> DEEP <input type="checkbox"/> GAS <input checked="" type="checkbox"/> LIQUID INJECTION <input type="checkbox"/> STORAGE <input type="checkbox"/> SHALLOW <input checked="" type="checkbox"/>	WATERSHED: BUFFALO CREEK DISTRICT: BUFFALO COUNTY: BROOKE SURFACE OWNER: THURMAN O. SPEECE JR & GOLDIE M. STANLEY OIL & GAS ROYALTY OWNER: THURMAN O. SPEECE JR & GOLDIE M. STANLEY

DRILL <input checked="" type="checkbox"/> DRILL DEEPER <input type="checkbox"/> REDRILL <input type="checkbox"/> FRACTURE OR STIMULATE <input checked="" type="checkbox"/> PLUG OFF OLD FORMATION <input type="checkbox"/> PERFORATE NEW FORMATION <input type="checkbox"/>	CONVERT <input type="checkbox"/> PLUG & ABANDON <input type="checkbox"/> CLEAN OUT & REPLUG <input type="checkbox"/> OTHER CHANGE <input checked="" type="checkbox"/> (SPECIFY) AS-DRILLED	TARGET FORMATION: MARCELLUS ESTIMATED DEPTH: 5,860' TVD 18,460' IMD
WELL OPERATOR: SWN PRODUCTION COMPANY, LLC ADDRESS: P.O. BOX 1300 CITY: JANE LEW STATE: WV ZIP CODE: 26378	DESIGNATED AGENT: DEE SOUTHALL ADDRESS: P.O. BOX 1300 CITY: JANE LEW STATE: WV ZIP CODE: 26378	DATE: 05-03-2018 DRAWN BY: K. POTH SCALE: 1" = 2000' DRAWING NO: 030-2888 WELL LOCATION PLAT

LEGEND:	REVISIONS:	DATE:
<ul style="list-style-type: none"> <li>○ PROPOSED SURFACE HOLE / BOTTOM HOLE</li> <li>⊙ EXISTING / PRODUCING WELLHEAD</li> <li>LPL* LANDING POINT LOCATION</li> <li>W EXISTING WATER WELL</li> <li>S EXISTING SPRING</li> <li>— SURVEYED BOUNDARY</li> <li>— DRILLING UNIT</li> <li>— LEASE BOUNDARY</li> <li>— PROPOSED PATH</li> <li>— AS-DRILLED PATH</li> </ul>	_____ _____ _____	_____ _____ _____