

THRASHER

THE THRASHER GROUP, INC.
600 WHITE OAKS BLVD.
BRIDGEPORT, WV 26330
PHONE 304-624-4108

Latitude: 40°17'30"

4,260'

7,404'

NOTES ON SURVEY

- COORDINATES SYSTEM IS UTM, NAD 83 DATUM, ZONE 17, U.S. FOOT AND WELL COORDINATES ESTABLISHED USING SURVEY GRADE GPS.
- SURFACE AND ROYALTY OWNER INFORMATION AND THEIR BOUNDARIES SHOWN HEREON WERE PLOTTED FROM DEEDS AND/OR TAX PARCEL MAPS PROVIDED BY CLIENT AND FIELD LOCATIONS.
- THIS PLAT DOES NOT REPRESENT A BOUNDARY SURVEY OF THE PARCELS SHOWN HEREON.
- NO DWELLINGS AND BUILDINGS WITHIN 625 FEET OF PROPOSED OF CENTER OF PAD.
- NO WATER WELLS OR DEVELOPED SPRINGS WITHIN 250 FEET OF PROPOSED WELL.
- NO PERENNIAL STREAMS, LAKES, PONDS, RESERVOIRS OR WETLANDS WITHIN 100 FEET OF THE LIMITS OF DISTURBANCE.
- NO NATURALLY PRODUCING TROUT STREAM WITHIN 300 FEET OF LIMITS OF DISTURBANCE.

TRACT	SURFACE OWNER (S) / ROYALTY OWNER (R)	TAX PARCEL	ACRES
1	(S)RUSSELL D. HERVEY (R)CHESAPEAKE APPALACHIA, LLC	05-03-B28-0045-0000	37.84
2	(S)WILLIAM JUDSON HERVEY, III (R)CHESAPEAKE APPALACHIA, LLC	05-03-B28-0045-0002	111.50
3	(S)FREDERICK L. HERVEY (R)CHESAPEAKE APPALACHIA, LLC	05-03-B28-0045-0001	34.58
4	(S)CHARLIE D. FARRIS AND BRITNEY L. FARRIS (R)CHESAPEAKE APPALACHIA, LLC	05-03-B28-0045-0004	3.26
5	(S)THOMAS MILLER (R)CHESAPEAKE APPALACHIA, LLC	05-03-B28-0046-0000	0.13
6	(S)KENNETH DIGHT (R)CHESAPEAKE APPALACHIA, LLC	05-03-B28F-0036-0000	21.13
7	(S)SHERRY L. DENNIS (R)CHESAPEAKE APPALACHIA, LLC	05-03-B28F-0053-0000	2.51
8	(S)WALDO E. MILLER (R)CHESAPEAKE APPALACHIA, LLC	05-03-B28F-0055-0000	2.00
9	(S)MARY K. MILLER (R)CHESAPEAKE APPALACHIA, LLC	05-03-B28B-0039-0000	5.28
10	(S)MARY K. MILLER (R)CHESAPEAKE APPALACHIA, LLC	05-03-B28B-0040-0000	5.98
11	(S)RANDA J. BOZDO (R)JOANNE R. DUNKEL AND DONALD K. DUNKEL (R)WILLIAM S. BACH (R)MOLLIE ROBISON	05-03-B28B-0023-0000	1.00
12	(S)NATHAN GADICH (R)JOANNE R. DUNKEL AND DONALD K. DUNKEL (R)WILLIAM S. BACH (R)MOLLIE ROBISON	05-03-B28B-0022-0000	1.00
13	(S)WILLIAM J. WELLS AND PATRICIA L. WELLS (R)JOANNE R. DUNKEL AND DONALD K. DUNKEL (R)WILLIAM S. BACH (R)MOLLIE ROBISON	05-03-B28B-0021-0000	1.00
14	(S)PHILIP A. CONLEY, ET AL (R)JOANNE R. DUNKEL AND DONALD K. DUNKEL (R)WILLIAM S. BACH (R)MOLLIE ROBISON	05-03-B28B-0020-0000	1.00
15	(S)DONALD SMITH (R)JOANNE R. DUNKEL AND DONALD K. DUNKEL (R)WILLIAM S. BACH (R)MOLLIE ROBISON	05-03-B28B-0019-0000	1.00
16	(S)COREY P. ROMAN (R)COREY P. ROMAN AND DONNA M. ROMAN (R)JOANNE R. DUNKEL AND DONALD K. DUNKEL (R)WILLIAM S. BACH (R)MOLLIE ROBISON	05-03-B28B-0014-0000	23.06
17	(S)ROBERT CLARK (R)JOANNE R. DUNKEL AND DONALD K. DUNKEL (R)WILLIAM S. BACH (R)MOLLIE ROBISON	05-03-B23P-0029-0000	1.11
18	(S)RONALD MISCH AND DENNIS MISCH (R)JOANNE R. DUNKEL AND DONALD K. DUNKEL (R)WILLIAM S. BACH (R)MOLLIE ROBISON	05-03-B23P-0030-0000	1.03
19	(S)KAREN S. KIRCHNER AND CHARLES D. KIRCHNER (R)JOANNE R. DUNKEL AND DONALD K. DUNKEL (R)WILLIAM S. BACH (R)MOLLIE ROBISON	05-03-B23P-0031-0000	1.03
20	(S)COREY P. ROMAN AND DONNA M. ROMAN (R)JOANNE R. DUNKEL AND DONALD K. DUNKEL (R)WILLIAM S. BACH (R)MOLLIE ROBISON	05-03-B23P-0032-0000	1.00
21	(S)MERRY A. SMITH (R)JOANNE R. DUNKEL AND DONALD K. DUNKEL (R)WILLIAM S. BACH (R)MOLLIE ROBISON	05-03-B23P-0033-0000	1.08
22	(S)JOHN P. HUNDAGEN AND TERRY HUNDAGEN (R)JOANNE R. DUNKEL AND DONALD K. DUNKEL (R)WILLIAM S. BACH (R)MOLLIE ROBISON	05-03-B23P-0022-0000	1.11
23	(S)DIANE L. ALMAN (R)JOANNE R. DUNKEL AND DONALD K. DUNKEL (R)WILLIAM S. BACH (R)MOLLIE ROBISON	05-03-B23P-0021-0000	1.12
24	(S)JUDITH A. GRAY AND EDMOND M. GRAY, SR. (R)JOANNE R. DUNKEL AND DONALD K. DUNKEL (R)WILLIAM S. BACH (R)MOLLIE ROBISON	05-03-B23P-0011-0000	1.12



SURFACE HOLE LOCATION (SHL):	
UTM (NAD83, ZONE 17, METERS):	NORTHING: 4,456,504.276
	EASTING: 537,705.303
LANDING POINT LOCATION (LPL):	
UTM (NAD83, ZONE 17, METERS):	NORTHING: 4,456,737.802
	EASTING: 537,482.036
BOTTOM HOLE LOCATION (BHL):	
UTM (NAD83, ZONE 17, METERS):	NORTHING: 4,458,690.943
	EASTING: 536,734.689

LINE	BEARING	DISTANCE
L1	S 75°01'24" W	33.61'
L2	S 56°33'54" W	24.49'
L3	N 70°38'18" W	3690.15'
L4	N 32°53'21" W	2674.36'
L5	N 43°42'48" W	1059.98'
L6	N 22°08'24" W	6861.00'

SWN PRODUCTION COMPANY, LLC
"RUSSELL HERVEY BRK 3H"
SURFACE HOLE
1166' (AS-DRILLED)

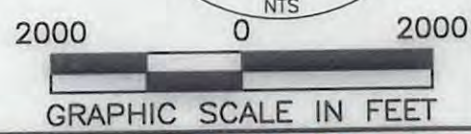
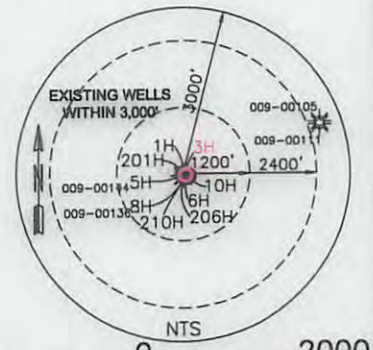
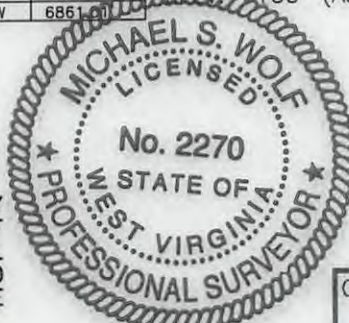

I, THE UNDERSIGNED, HEREBY CERTIFY THAT THIS PLAT IS CORRECT TO THE BEST OF MY KNOWLEDGE AND BELIEF AND SHOWS ALL THE INFORMATION REQUIRED BY LAW AND REGULATIONS ISSUED AND PRESCRIBED BY THE DEPARTMENT OF ENVIRONMENTAL PROTECTION.

P.S. 2270 *MSW* 6/30/17

<p>(+) DENOTES LOCATION OF WELL ON UNITED STATES TOPOGRAPHIC MAPS</p> <p>WVDEP OFFICE OF OIL & GAS 601 57TH STREET CHARLESTON, WV 25034</p>	<p>MINIMUM DEGREE OF ACCURACY: 1/200</p> <p>PROVEN SOURCE OF ELEVATION: SURVEY GRADE GPS (NAVD 88, US FT)</p>	<p>COMPANY: SWN Production Company, LLC</p> <p>RUSSELL HERVEY BRK</p> <p>OPERATOR'S WELL #: 3H</p> <p>API WELL #: 47 009 00179</p> <p>STATE COUNTY PERMIT</p>
	<p>WELL TYPE: OIL <input type="checkbox"/> WASTE DISPOSAL <input type="checkbox"/> PRODUCTION <input type="checkbox"/> DEEP <input type="checkbox"/> GAS <input checked="" type="checkbox"/> LIQUID INJECTION <input type="checkbox"/> STORAGE <input type="checkbox"/> SHALLOW <input checked="" type="checkbox"/></p> <p>WATERSHED: BUFFALO CREEK</p> <p>DISTRICT: BUFFALO COUNTY: BROOKE</p> <p>SURFACE OWNER: RUSSELL D. HERVEY</p> <p>OIL & GAS ROYALTY OWNER: RUSSELL D. & LISA K. HERVEY</p> <p>DRILL <input checked="" type="checkbox"/> DRILL DEEPER <input type="checkbox"/> REDRILL <input type="checkbox"/> FRACTURE OR STIMULATE <input checked="" type="checkbox"/> PLUG OFF OLD FORMATION <input type="checkbox"/> PERFORATE NEW FORMATION <input type="checkbox"/></p> <p>CONVERT <input type="checkbox"/> PLUG & ABANDON <input type="checkbox"/> CLEAN OUT & REPLUG <input type="checkbox"/> OTHER CHANGE <input type="checkbox"/> (SPECIFY)</p> <p>TARGET FORMATION: MARCELLUS</p> <p>ESTIMATED DEPTH: 5,822' TVD 13,262' TMD</p>	<p>DESIGNATED AGENT: DEE SOUTHALL</p> <p>ADDRESS: P.O. BOX 1300 CITY: JANE LEW STATE: WV ZIP CODE: 26378</p>
<p>WELL OPERATOR: SWN PRODUCTION COMPANY, LLC</p> <p>ADDRESS: P.O. BOX 1300 CITY: JANE LEW STATE: WV ZIP CODE: 26378</p>		<p>DATE: 06-28-2017</p> <p>DRAWN BY: R.DOERR</p> <p>SCALE: 1" = 2000'</p> <p>DRAWING NO: 050-5495</p> <p>WELL LOCATION PLAT</p>