



RETTEW Associates, Inc.
27 Travato Street, Suite 101
Bridgeport, WV 26330
Phone (800) 738-8395
Email: rettew@rettew.com
Website: www.rettew.com

SURFACE HOLE LOCATION (SHL):

UTM (NAD83, ZONE 17, METERS):
NORTHING: 4,452,326.655
EASTING: 539,868.683

KICKOFF POINT LOCATION (KOP):

UTM (NAD83, ZONE 17, METERS):
NORTHING: 4,452,212.525
EASTING: 539,628.405

LANDING POINT LOCATION (LPL):

UTM (NAD83, ZONE 17, METERS):
NORTHING: 4,452,025.484
EASTING: 539,634.654

BOTTOM HOLE LOCATION (BHL):

UTM (NAD83, ZONE 17, METERS):
NORTHING: 4,449,398.737
EASTING: 540,749.642

GRID NORTH
UTM, NAD83 DATUM, ZONE 17, US FT

Table with columns: TRACT, SURFACE OWNERS, TAX PARCEL, ACRES. Contains 7 rows of land ownership data.

Table with columns: LINE, BEARING, DISTANCE, DESCRIPTION, MONUMENT. Contains 6 rows of survey line data.

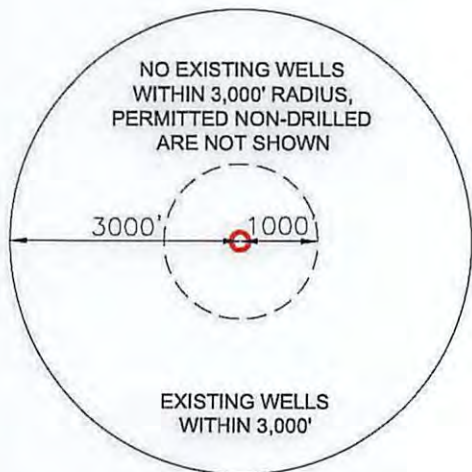
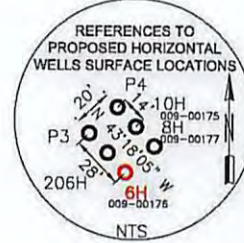
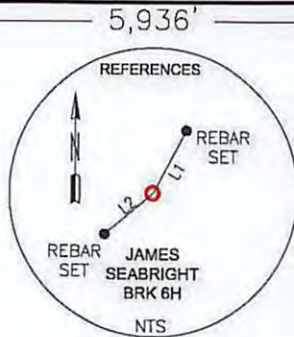

NOTES ON SURVEY

- 1. COORDINATES SYSTEM IS UTM, NAD 83 DATUM, ZONE 17, U.S. FOOT AND WELL COORDINATES ESTABLISHED USING SURVEY GRADE GPS.
2. SURFACE AND ROYALTY OWNER INFORMATION AND THEIR BOUNDARIES SHOWN HEREON WERE PLOTTED FROM DEEDS AND/OR TAX PARCEL MAPS PROVIDED BY CLIENT AND FIELD LOCATIONS.
3. THIS PLAT DOES NOT REPRESENT A BOUNDARY SURVEY OF THE PARCELS SHOWN HEREON.
4. NO DWELLINGS AND BUILDINGS WITHIN 625 FEET OF PROPOSED OF CENTER OF PAD.
5. NO WATER WELLS OR DEVELOPED SPRINGS WITHIN 250 FEET OF PROPOSED WELL.
6. NO PERENNIAL STREAMS, LAKES, PONDS, RESERVOIRS OR WETLANDS WITHIN 100 FEET OF THE LIMITS OF DISTURBANCE.
7. NO NATURALLY PRODUCING TROUT STREAM WITHIN 300 FEET OF LIMITS OF DISTURBANCE.

I, THE UNDERSIGNED, HEREBY CERTIFY THAT THIS PLAT IS CORRECT TO THE BEST OF MY KNOWLEDGE AND BELIEF AND SHOWS ALL THE INFORMATION REQUIRED BY LAW AND REGULATIONS ISSUED AND PRESCRIBED BY THE DEPARTMENT OF ENVIRONMENTAL PROTECTION.

P.S. 2313



SEE ADJOINING SURFACE OWNERS SHEET FOR NAMES

2500 0 2500

GRAPHIC SCALE IN FEET

COMPANY: SWN SWN Production Company, LLC Production Company™

(+) DENOTES LOCATION OF WELL ON UNITED STATES TOPOGRAPHIC MAPS
WVDEP
OFFICE OF OIL & GAS
601 57TH STREET
CHARLESTON, WV 25034

MINIMUM DEGREE OF ACCURACY: 1/200
PROVEN SURVEY SOURCE OF GRADE GPS ELEVATION: (NAVD 88, US FT)

JAMES SEABRIGHT BRK
OPERATOR'S WELL #: 6H
API WELL #: 47 9 00176M00
STATE COUNTY PERMIT

WELL TYPE: OIL [] WASTE DISPOSAL [] PRODUCTION [] DEEP [] GAS [x] LIQUID INJECTION [] STORAGE [] SHALLOW [x]
WATERSHED: SUGARCAMP RUN, BUFFALO CREEK ELEVATION: 1129.0' (DESIGN)±
DISTRICT: BUFFALO COUNTY: BROOKE QUADRANGLE: BETHANY, WV-PA
SURFACE OWNER: JAMES K. & MARTHA MAY SEABRIGHT; LIFE INTEREST & JAMES H. SEABRIGHT ACREAGE: 173.00±
OIL & GAS ROYALTY OWNER: MARTHA MAY SEABRIGHT, LE, & JAMES H. SEABRIGHT ACREAGE: 173.00±
DRILL [x] DRILL DEEPER [] REDRILL [] FRACTURE OR STIMULATE [x] PLUG OFF OLD FORMATION [] PERFORATE NEW FORMATION []
CONVERT [] PLUG & ABANDON [] CLEAN OUT & REPLUG [] OTHER CHANGE [] (SPECIFY) 01/06/2017
TARGET FORMATION: MARCELLUS ESTIMATED DEPTH: 6,053' TVD 15,943' TMD

WELL OPERATOR: SWN PRODUCTION COMPANY, LLC DESIGNATED AGENT: DEE SOUTHALL
ADDRESS: P.O. BOX 1300 ADDRESS: P.O. BOX 1300
CITY: JANE LEW STATE: WV ZIP CODE: 26378 CITY: JANE LEW STATE: WV ZIP CODE: 26378

LEGEND: PROPOSED SURFACE HOLE / BOTTOM HOLE, EXISTING / PRODUCING WELLHEAD, ABANDONED WELL, PLUGGED & ABANDONED WELL, CUT CONDUCTOR, TIE LINE, LEASE BOUNDARY, MARCELLUS DHP, ABANDONED PATH
REVISIONS: DATE: 10-14-2016
DRAWN BY: B. HERMAN
SCALE: 1" = 2500'
DRAWING NO: 087569036
WELL LOCATION PLAT

RETTEW

RETTEW Associates, Inc.
 27 Travato Street, Suite 101
 Bridgeport, WV 26330
 Phone (800) 738-8395
 Email: rette@rette.com
 Website: www.rette.com

GRID NORTH
 UTM, NAD83 DATUM, ZONE 17, US FT

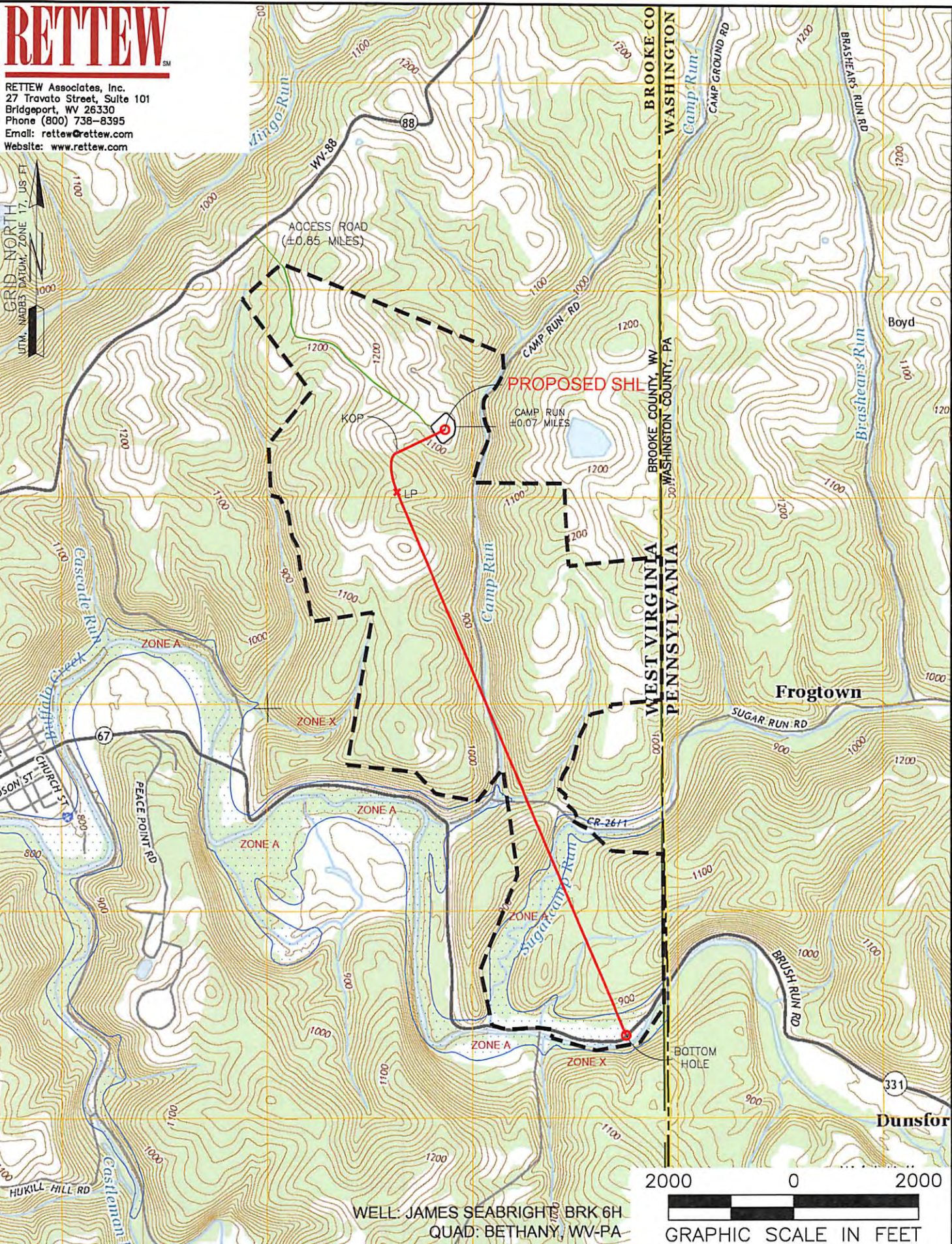

WELL: JAMES SEABRIGHT BRK 6H
 QUAD: BETHANY, WV-PA



| | | | | | |
|---|--|--|--|---|--|
| NAME AND DISTANCE TO THE NEAREST STREAM: CAMP RUN IS LOCATED ±0.07 MILES EAST OF THE CENTER OF THE DRILL PAD. | | STREAM CROSSING COORDINATES (NAD 83): NO NEW CROSSINGS. | | COMPANY: | |
| WELL RESTRICTIONS: WELL PAD, LOD, & E & S CONTROL FEATURES TO PERENNIAL STREAM, LAKE, POND, RESERVOIR OR WETLAND: >100 FEET WELL PAD, LOD, & E & S CONTROL FEATURES TO NATURALLY PRODUCING TROUT STREAM: >300 FEET WELL PAD, LOD, & E & S CONTROL FEATURES TO GROUNDWATER INTAKE OR PUBLIC WATER SUPPLY: >1000 FEET WELL SHL TO EXISTING WATER WELL OR DEVELOPED SPRING: >250 FEET CENTER OF PAD TO OCCUPIED DWELLING STRUCTURE: >625 FEET CENTER OF PAD TO AGRICULTURAL BUILDINGS LARGER THAN 2500 SQ FT: >625 FEET | | OPERATOR'S JAMES SEABRIGHT BRK WELL #: 6H 9-00176 MOD | | LOCATION: BUFFALO DISTRICT, BROOKE COUNTY, WEST VIRGINIA | |
| FEMA FLOOD INFORMATION: BY GRAPHIC PLOTTING ONLY FEMA FIRM INCORPORATED AREA OF BROOKE COUNTY, WEST VIRGINIA; MAP NUMBER 54009C0135D; EFFECTIVE DATE: APRIL 19, 2010. FLOOD ZONES A & X ARE SITUATED WITHIN THE UNIT. | | SURFACE HOLE LOCATION: GEOGRAPHIC (NAD83): LATITUDE: 40.220413° LONGITUDE: -80.531424° DATE: 01/06/2017 | | BOTTOM HOLE LOCATION: GEOGRAPHIC (NAD83): LATITUDE: 40.193993° LONGITUDE: -80.521256° | |
| LEGEND: PROPOSED SURFACE HOLE / BOTTOM HOLE EXISTING / PRODUCING WELLHEAD ABANDONED WELL PLUGGED & ABANDONED WELL CUT CONDUCTOR | | LEASE BOUNDARY MARCELLUS DHP ACCESS ROAD HIGHWAY/INTERSTATE COUNTY ROAD | | REVISIONS: DATE: 10-14-2016 DRAWN BY: B. HERMAN SCALE: 1" = 2000' DRAWING NO: 087569036 TOPOGRAPHIC MAP | |