

THRASHER

THE THRASHER GROUP, INC.
600 WHITE OAKS BLVD.
BRIDGEPORT, WV 26330
PHONE 304-624-4108

LINE	BEARING	DISTANCE	DESCRIPTION	MONUMENT
L1	N 34°41'34" W	46.91'	SHL TO REF. PNT.	BRK BH #09-00111
L2	S 18°52'21" W	292.98'	SHL TO REF. PNT.	REBAR SET
L3	N 28°36'22" E	4753.26'	SHL TO LANDMARK	CONC. MONUMENT
L4	N 31°30'37" E	3939.00'	SHL TO LANDMARK	REBAR FOUND
LINE	BEARING	DISTANCE	CURVE LENGTH	DESCRIPTION
L5	N 77°14'48" E	1487.31'		SHL TO LP
L6	S 20°02'35" E	4657.81'		LP TO BHL

NOTES ON SURVEY

- COORDINATES SYSTEM IS UTM, NAD 83 DATUM, ZONE 17, U.S. FOOT AND WELL COORDINATES ESTABLISHED USING SURVEY GRADE GPS.
- SURFACE AND ROYALTY OWNER INFORMATION AND THEIR BOUNDARIES SHOWN HEREON WERE PLOTTED FROM DEEDS AND/OR TAX PARCEL MAPS PROVIDED BY CLIENT AND FIELD LOCATIONS.
- THIS PLAT DOES NOT REPRESENT A BOUNDARY SURVEY OF THE PARCELS SHOWN HEREON.
- NO DWELLINGS AND BUILDINGS WITHIN 625 FEET OF PROPOSED OF CENTER OF PAD.
- NO WATER WELLS OR DEVELOPED SPRINGS WITHIN 250 FEET OF PROPOSED WELL.
- NO PERENNIAL STREAMS, LAKES, PONDS, RESERVOIRS OR WETLANDS WITHIN 100 FEET OF THE LIMITS OF DISTURBANCE.
- NO NATURALLY PRODUCING TROUT STREAM WITHIN 300 FEET OF LIMITS OF DISTURBANCE.

TRACT	SURFACE OWNER (S) / ROYALTY OWNER (R)	TAX PARCEL	ACRES
1	(S) BROOKE COUNTY PARK COMMISSION (R) RICHARD P. GIST (R) VIRGINIA GIST ABBLITT (R) ANN GIST LEVIN	05-03-028-0084-0000	135.00
2	(S) BROOKE COUNTY COURT (R) RICHARD P. GIST (R) VIRGINIA GIST ABBLITT (R) ANN GIST LEVIN	05-03-028-0085-0000	135.50
3	(S) BROOKE COUNTY COURT (R) BROOKE COUNTY PARK & RECREATION COMMISSION	05-03-028-0081-0000	51.32
4	(S) KEITH SMITH & KATHY SMITH (R) LAURA G. INMAN & JAMES C. INMAN JR. (R) KAREN C. YOUNGERS & TERRY D. YOUNGERS	05-03-034-0001-0000	55.77
5	(S) KEITH SMITH & KATHY SMITH (R) LAURA G. INMAN & JAMES C. INMAN JR. (R) KAREN C. YOUNGERS & TERRY D. YOUNGERS	05-03-034-0016-0002	20.84
6	(S) KEITH SMITH & KATHY SMITH (R) LAURA G. INMAN & JAMES C. INMAN JR. (R) KAREN C. YOUNGERS & TERRY D. YOUNGERS	05-03-034-0016-0005	3.35
7	(S) DAVID L. RAGAN (R) LAURA G. INMAN & JAMES C. INMAN JR. (R) KAREN C. YOUNGERS & TERRY D. YOUNGERS	05-03-034-0016-0003	34.74

GRID NORTH
UTM, NAD83 DATUM, ZONE 17, US FT

SWN PRODUCTION COMPANY, LLC
"BROOKE COUNTY PARKS BRK 210H"
SURFACE HOLE
ELEV: 1206'

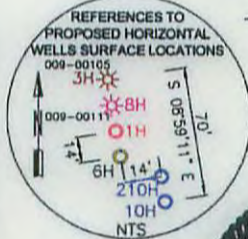
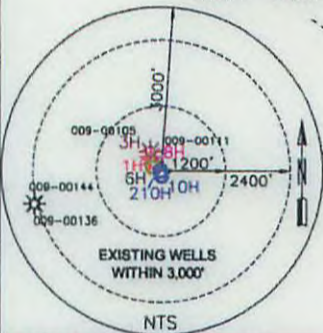

SURFACE HOLE LOCATION (SHL):	
UTM (NAD83, ZONE 17, METERS):	
NORTHING: 4,456,762.235	
EASTING: 538,454.048	
LANDING POINT LOCATION (LPL):	
UTM (NAD83, ZONE 17, METERS):	
NORTHING: 4,456,862.310	
EASTING: 538,896.198	
BOTTOM HOLE LOCATION (BHL):	
UTM (NAD83, ZONE 17, METERS):	
NORTHING: 4,455,528.591	
EASTING: 539,382.767	

I, THE UNDERSIGNED, HEREBY CERTIFY THAT THIS PLAT IS CORRECT TO THE BEST OF MY KNOWLEDGE AND BELIEF AND SHOWS ALL THE INFORMATION REQUIRED BY LAW AND REGULATIONS ISSUED AND PRESCRIBED BY THE DEPARTMENT OF ENVIRONMENTAL PROTECTION.



P.S. 2270 *M.S. Wolf* 10/28/15

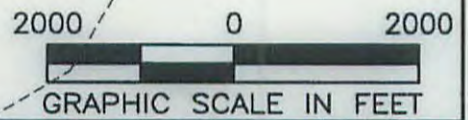

COMPANY: **SWN** Production Company, LLC **SWN** Production Company, LLC

(+) DENOTES LOCATION OF WELL ON UNITED STATES TOPOGRAPHIC MAPS
WVDEP
OFFICE OF OIL & GAS
601 57TH STREET
CHARLESTON, WV 25034

MINIMUM DEGREE OF ACCURACY: 1/200
PROVEN SURVEY SOURCE OF GRADE GPS
ELEVATION: (NAVD 88, US FT)

BROOKE COUNTY PARKS BRK
OPERATOR'S WELL #: 210H
API WELL #: 47 STATE 009 COUNTY 00165 PERMIT HGA

WELL TYPE: OIL WASTE DISPOSAL PRODUCTION DEEP GAS LIQUID INJECTION STORAGE SHALLOW
WATERSHED: BUFFALO CREEK ELEVATION: 1206'
DISTRICT: BUFFALO COUNTY: BROOKE QUADRANGLE: STEUBENVILLE EAST & BETHANY
SURFACE OWNER: BROOKE COUNTY PARKS COMMISSION ACREAGE: ±135.00
OIL & GAS ROYALTY OWNER: RICHARD P. GIST, VIRGINIA GIST ABBLITT, ANN GIST LEVIN ACREAGE: ±438.27
DRILL DRILL DEEPER REDRILL FRACTURE OR STIMULATE PLUG OFF OLD FORMATION PERFORATE NEW FORMATION
CONVERT PLUG & ABANDON CLEAN OUT & REPLUG OTHER CHANGE (SPECIFY)
TARGET FORMATION: MARCELLUS ESTIMATED DEPTH: 5,983' TVD 12/14/2015

WELL OPERATOR: SWN PRODUCTION COMPANY, LLC DESIGNATED AGENT: DEE SOUTHALL
ADDRESS: P.O. BOX 1300 ADDRESS: P.O. BOX 1300
CITY: JANE LEW STATE: WV ZIP CODE: 26378 CITY: JANE LEW STATE: WV ZIP CODE: 26378

LEGEND:	REVISIONS:	DATE:
○ PROPOSED SURFACE HOLE / BOTTOM HOLE		10-28-2015
⊙ EXISTING / PRODUCING WELLHEAD	----- LEASE BOUNDARY	
⊘ ABANDONED WELL	----- 500' DHP BUFFER	
⊙ PLUGGED & ABANDONED WELL	-MAR 210- MARCELLUS DHP	
△ CUT CONDUCTOR	----- ABANDONED PATH	
		DRAWN BY: E. LYTLE
		SCALE: 1" = 2000'
		DRAWING NO: 050-5525
		WELL LOCATION PLAT

THRASHER

THE THRASHER GROUP, INC.
600 WHITE OAKS BLVD.
BRIDGEPORT, WV 26330
PHONE 304-624-4108

4700900165

TRACT	ADJOINER	TAX PARCEL
A	JOHN C WALES SR AND BARBARA A WALES	05-03-B34-0017-0000
B	BRIAN SMITH	05-03-B33-0114-0001
C	KEITH R SMITH AND KATHY J SMITH	05-03-B33-0114-0000
D	KEITH SMITH AND KATHY SMITH	05-03-B34-0016-0001
E	BROOKE COUNTY PARK AND RECREATION COMMISSION	05-03-B33-0117-0000
F	BROOKE COUNTY PARK AND RECREATION COMMISSION	05-03-B28-0060-0000
G	STARVAGGI INDUSTRIES	05-03-B28-0063-0000
H	STARVAGGI INDUSTRIES INC.	05-03-B28-0062-0000
I	RUSSELL D HERVEY	05-03-B28-0045-0000
J	BERNARD J. KNORR III & NICHOLE C. KNORR	05-03-B28-0059-0000
K	RUBY FAYE KNORR & BERNARD JOHN KNORR JR	05-03-B28-0058-0000
L	BERNARD J. KNORR JR & RUBY F KNORR	05-03-B28-0057-0001
M	BROOKE COUNTY COURT	05-03-B28-0066-0000
N	JOHN PAUL POTTER; PENNY POTTER SUAVE; JAY M POTTER II	05-03-B29E-0001-0000
O	JOHN G RADVANSKY AND BARBARA J RADVANSKY	05-03-B29J-0007-0000
P	GEORGE GIPALO AND RHODA GIPALO	05-03-B29J-0024-0000
Q	GEORGE GIPALO AND RHODA GIPALO	05-03-B29J-0025-0000
R	BROOKE COUNTY COURT	05-03-B29-0014-0000
S	DAVID L RAGAN	05-03-B34-0001-0001
T	DAVID L RAGAN	05-03-B34-0016-0004
U	WILLOW SPRINGS INC	05-03-B34-0010-0002
V	WILLIAM CURTIS HUNT & SUSAN L HUNT	05-03-B34-0007-0000
W	DELORES JEANNE BUYAN; SARAH LYNN LYCANS STENGER; JUDITH LEE BRINKLEY	05-03-B34-0010-0000
X	NANCY J AMBROSE	05-03-B34-0011-0000
Y	DAVID L RAGAN	05-03-B34-0016-0000

RECEIVED
Office of Oil and Gas
NOV 02 2015
WV Department of
Environmental Protection

COMPANY:
SWN **SWN**
Production Company, LLC Production Company™

12/11/2015

REVISIONS:	DATE: 10-28-2015
	SHEET 2 OF 2
	DRAWN BY: E. LYTLE
	SCALE: 1" = 2000'
	DRAWING NO: 050-5525
	WELL LOCATION PLAT