

REFERENCE LINES

L1	N82°18'25"W	1371'
L2	S52°16'33"W	690'
L3	S26°50'27"W	805'
L4	S05°57'11"E	507'
L5	N49°30'22"W	371'

<b>SURFACE HOLE LOCATION (SHL)</b>	
GEOGRAPHIC (NAD83):	
LATITUDE: 40.204117°	
LONGITUDE: -80.612529°	
UTM (NAD83, ZONE 17, FEET):	
NORTHING: 14,601,305.010	
EASTING: 1,750,140.250	
UTM (NAD83, ZONE 17, METERS):	
NORTHING: 4,450,486.668	
EASTING: 533,443.815	
<b>LANDING POINT LOCATION (LPL)</b>	
GEOGRAPHIC (NAD83):	
LATITUDE: 40.207044°	
LONGITUDE: -80.612514°	
UTM (NAD83, ZONE 17, FEET):	
NORTHING: 14,602,364.040	
EASTING: 1,748,604.110	
UTM (NAD83, ZONE 17, METERS):	
NORTHING: 4,450,809.461	
EASTING: 532,975.599	
<b>BOTTOM HOLE LOCATION (BHL)</b>	
GEOGRAPHIC (NAD83):	
LATITUDE: 40.225176°	
LONGITUDE: -80.622527°	
UTM (NAD83, ZONE 17, FEET):	
NORTHING: 14,608,955.050	
EASTING: 1,745,780.420	
UTM (NAD83, ZONE 17, METERS):	
NORTHING: 4,452,818.410	
EASTING: 532,114.936	

GRID NORTH  
UTM, NAD83 DATUM, ZONE 17, US FT

Longitude: W 80°35'00"

EXISTING SURFACE LOCATION LAT. N 40°12'14.57" (NAD 27)

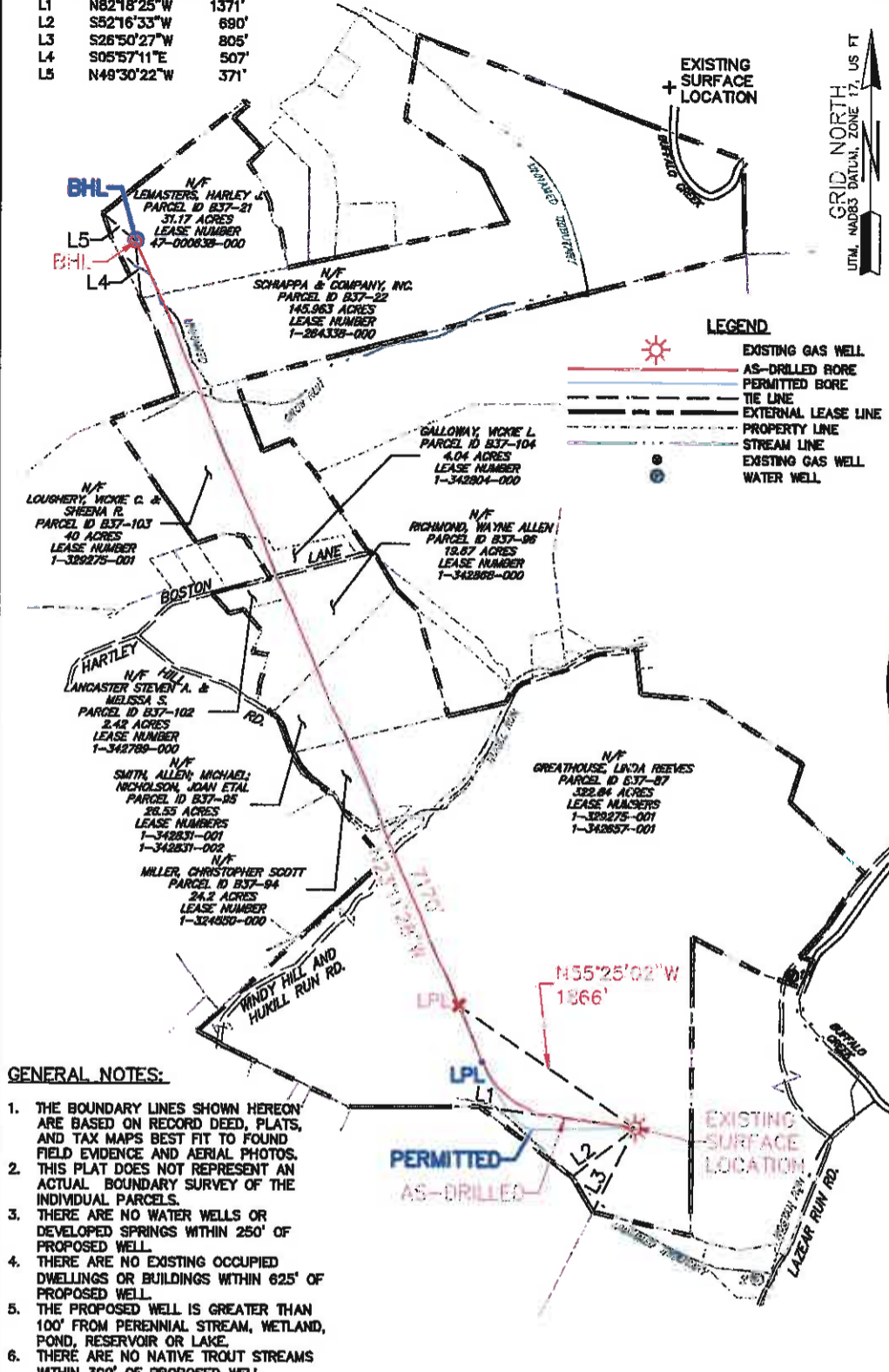

**LEGEND**

	EXISTING GAS WELL
	AS-DRILLED BORE
	PERMITTED BORE
	TIE LINE
	EXTERNAL LEASE LINE
	PROPERTY LINE
	STREAM LINE
	EXISTING GAS WELL
	WATER WELL

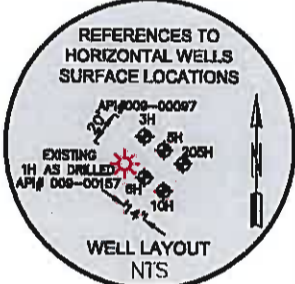
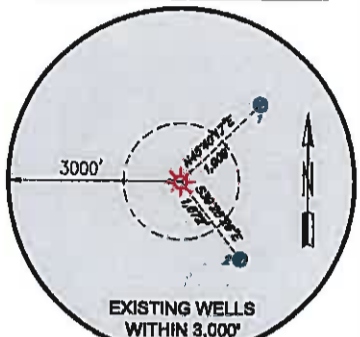

**GENERAL NOTES:**

1. THE BOUNDARY LINES SHOWN HEREON ARE BASED ON RECORD DEED, PLATS, AND TAX MAPS BEST FIT TO FOUND FIELD EVIDENCE AND AERIAL PHOTOS.
2. THIS PLAT DOES NOT REPRESENT AN ACTUAL BOUNDARY SURVEY OF THE INDIVIDUAL PARCELS.
3. THERE ARE NO WATER WELLS OR DEVELOPED SPRINGS WITHIN 250' OF PROPOSED WELL.
4. THERE ARE NO EXISTING OCCUPIED DWELLINGS OR BUILDINGS WITHIN 625' OF PROPOSED WELL.
5. THE PROPOSED WELL IS GREATER THAN 100' FROM PERENNIAL STREAM, WETLAND, POND, RESERVOIR OR LAKE.
6. THERE ARE NO NATIVE TROUT STREAMS WITHIN 300' OF PROPOSED WELL.

FILE #: 087569015

DRAWING #: 087569015-SV-1H AS-DRILL

SCALE: 1" = 1,400'

MINIMUM DEGREE OF ACCURACY: 1/200

PROVEN SOURCE OF ELEVATION: SUBMETER MAPPING SURVEY GPS

I, THE UNDERSIGNED, HEREBY CERTIFY THAT THIS PLAT IS CORRECT TO THE BEST OF MY KNOWLEDGE AND BELIEF AND SHOWS ALL THE INFORMATION REQUIRED BY LAW AND THE RULES ISSUED AND PRESCRIBED BY THE DEPARTMENT OF ENVIRONMENTAL PROTECTION.

SIGNED:

R.P.E.: \_\_\_\_\_ L.L.S.: 2313

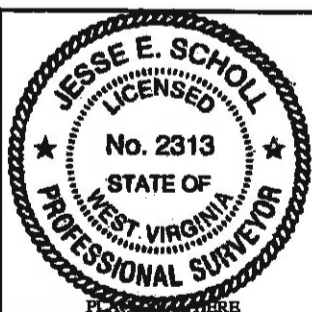

(+) DENOTES LOCATION OF WELL ON UNITED STATES TOPOGRAPHIC MAPS WVDEP  
OFFICE OF OIL & GAS  
601 57TH STREET  
CHARLESTON, WV 25304



DATE: MARCH 15, 2016

OPERATOR'S WELL #: LINDA GREATHOUSE BRK-1H

API WELL #: 47 RECEIVED 00157

STATE: \_\_\_\_\_ OFFICE OF OIL AND GAS

WELL TYPE:  OIL  GAS  WASTE DISPOSAL  LIQUID INJECTION  PRODUCTION  STORAGE  DEEP WELLS INSTALLATION

WATERSHED: UPPER OHIO SOUTH

COUNTY/DISTRICT: BROOKE/ BUFFALO

SURFACE OWNER: GREATHOUSE, LINDA REEVES

OIL & GAS ROYALTY OWNER: GREATHOUSE, LINDA REEVES

CONVERT  DRILL DEEPER  REDRILL  FRACTURE OR STIMULATE  PERFORATE NEW FORMATION  PLUG & ABANDON

DRILL  PLUG OFF OLD FORMATION  CLEAN OUT & REPLUG  OTHER CHANGE  (SPECIFY): \_\_\_\_\_

TARGET FORMATION: MARCELLUS ESTIMATED DEPTH: TVD: 5,856' TMD: 14,073'

WELL OPERATOR: SWN PRODUCTION COMPANY, LLC DESIGNATED AGENT: DEE SOUTHAL

ADDRESS: P.O. BOX 1300 ADDRESS: P.O. BOX 1300

CITY: JANE LEW STATE: WV ZIP CODE: 26378 CITY: JANE LEW STATE: WV ZIP CODE: 26378

WELL: LINDA GREATHOUSE 1H  
 QUAD: BETHANY, WV

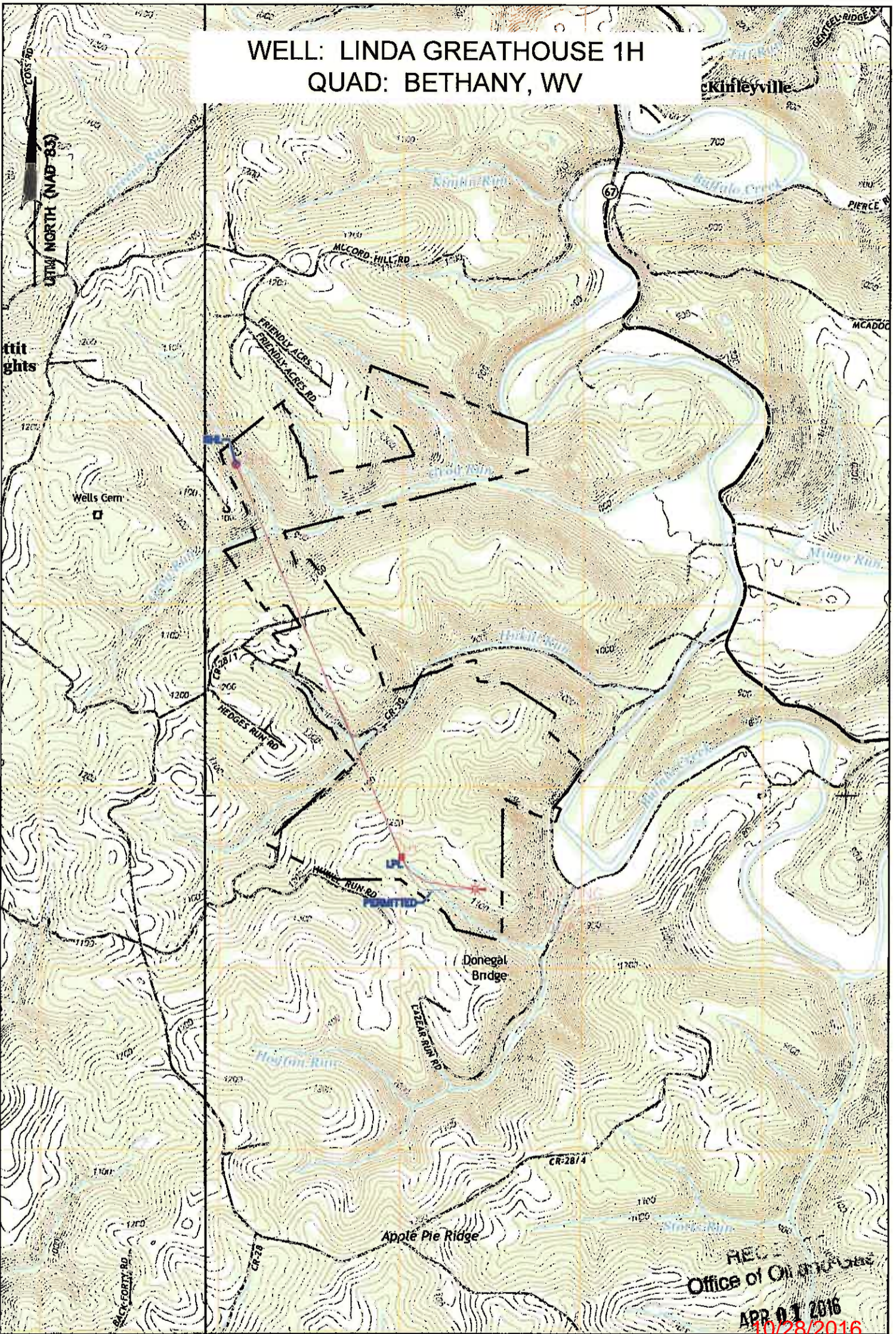

REC'D  
 Office of Oil and Gas  
 APR 01 2016  
 10/28/2016

NOTE:  
 THE PURPOSE OF THIS PLAT IS FOR THE LOCATION OF PROPOSED GAS  
 WELLS AND DOES NOT REPRESENT A CLOSED BOUNDARY SURVEY.  
 PROPERTY LINES AND OWNERS WERE OBTAINED FROM VARIOUS FIELD  
 EVIDENCE, TAX RECORDS AND AERIAL MAPPING.

LEGEND  
 - - - - - EXTERNAL LEASE LINE

Applicant / Well Operator Name SWN PRODUCTION COMPANY, LLC	Well (Farm) Name LINDA GREATHOUSE BRK	Well # 1H	Serial #
Address PO BOX 1300 JANE LEW, WV 26378	County - Code BROOKE - 009	District BUFFALO	
Surface Landowner / Lessor LINDA GREATHOUSE	USGS 71/2 Quadrangle Map Name BETHANY, W.V.A.		