

<b>TOP HOLE (MAD 88)</b> N) 664976.8 E) 1679861.8 LAT.) 40°19'15.8" LONG.) 80°32'06.4" DEC. LAT.) 40.321063 DEC. LONG.) 80.535123	<b>BOTTOM HOLE (MAD 89)</b> N) 672031.7 E) 1676086.0 LAT.) 40°20'25.1" LONG.) 80°32'56.3" DEC. LAT.) 40.340307 DEC. LONG.) 80.548958
<b>TOP HOLE (MAD 87)</b> N) 664939.6 E) 1711295.9 LAT.) 40°19'15.6" LONG.) 80°32'07.2" DEC. LAT.) 40.320994 DEC. LONG.) 80.535331	<b>BOTTOM HOLE (MAD 87)</b> N) 671994.6 E) 1707520.2 LAT.) 40°20'24.9" LONG.) 80°32'57.0" DEC. LAT.) 40.340237 DEC. LONG.) 80.549165

<b>TH (UTM-NAD 83)</b> N) 4463496.8 E) 539495.3
<b>BOTTOM HOLE (UTM-NAD 83)</b> N) 4465626.7 E) 538309.0

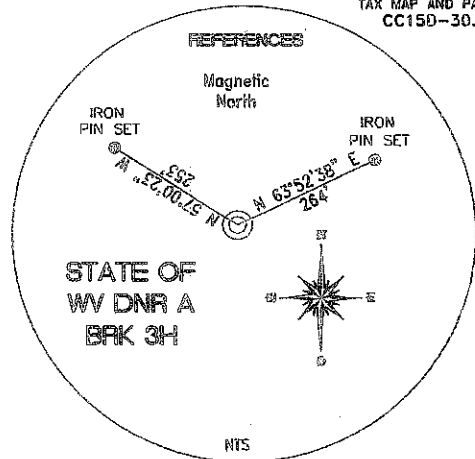

**REFERENCE NOTES**  
Boundaries as shown taken from deeds, tax maps and field locations. A full boundary survey is not expressed nor implied. All bearings are based on true north. Ownership taken from public records Brooke County, West Virginia MARCH 2012. State Plane Coordinates & NAD 83 Lat/Long by differential submeter mapping; grade GPS. Drafted by: E.A.M.

**ROBERT J. & DEBORAH L. CRISS**  
42.64 TOTAL ACRES  
LEASE NUMBER  
47-000940-001  
47-000940-002  
47-000940-003  
47-000940-004  
TAX MAP AND PARCEL  
CC15D-30

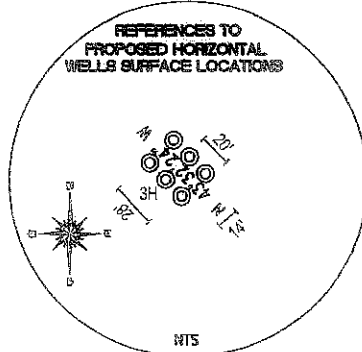

**JOSEPH A. JR. & TRACY BIRMINGHAM**  
10.545 TOTAL ACRES  
LEASE NUMBER  
47-001068-001  
47-001068-002  
47-001068-003  
47-001068-004  
TAX MAP AND PARCEL  
CC15D-30.2

**GEHLING REED FAMILY TRUST**  
40 TOTAL ACRES  
LEASE NUMBER  
1-324508-000  
TAX MAP AND PARCEL  
CC16-32

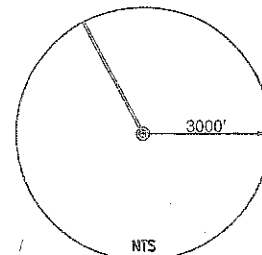

**LARRY E. REED**  
40.0 TOTAL ACRES  
LEASE NUMBER  
1-324492-000  
TAX MAP AND PARCEL  
CC15-68.1

**DENNIS, JR AND ANNA PALFALVY**  
33 TOTAL ACRES  
LEASE NUMBER  
47-001029-000  
TAX MAP AND PARCEL  
CC16-5

**BUREAU OF THE STATE OF WV**  
63.110 TOTAL ACRES  
LEASE NUMBER  
1-342967-000  
TAX MAP AND PARCEL  
CC16-7

**BUREAU OF THE STATE OF WV**  
94.555 TOTAL ACRES  
LEASE NUMBER  
1-324527-000  
TAX MAP AND PARCEL  
CC16-6

**STATE OF WV DNR A BRK 3H**

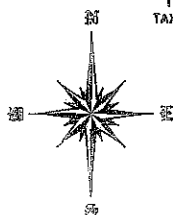

FILE #: CHE 094

DRAWING #: 2019

SCALE: 1" = 1600'

MINIMUM DEGREE

OF ACCURACY: 1/200

PROVEN SOURCE SUBMETER MAPPING

OF ELEVATION: GRADE GPS

I, THE UNDERSIGNED, HEREBY CERTIFY THAT THIS PLAT IS CORRECT TO THE BEST OF MY KNOWLEDGE AND BELIEF AND SHOWS ALL THE INFORMATION REQUIRED BY LAW AND THE REGULATIONS ISSUED AND PRESCRIBED BY THE DEPARTMENT OF ENVIRONMENTAL PROTECTION.

Signed: \_\_\_\_\_

L.L.S. #2124 : Ernest J. Benckek III

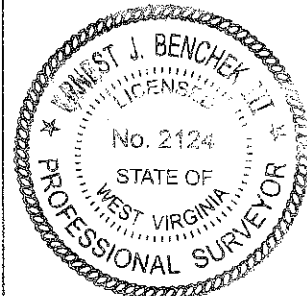

(+) DENOTES LOCATION OF WELL ON UNITED STATES TOPOGRAPHIC MAPS WVDEP OFFICE OF OIL & GAS 601 57TH STREET CHARLESTON, WV 25304

DATE: APRIL 6, 2012

OPERATOR'S WELL #: STATE OF WV DNR A BRK 3H

API WELL #: 47 09 00147-H6A  
STATE COUNTY PERMIT

Well Type:  Oil  Waste Diposal  Production  Deep  Gas  Liquid Injection  Storage  Shallow

WATERSHED: UPPER OHIO SOUTH

ELEVATION: 1,140'

COUNTY/DISTRICT: BROOKE / CROSS CREEK

QUADRANGLE: STEUBENVILLE EAST, WV.

SURFACE OWNER: STATE OF WEST VIRGINIA DNR

ACREAGE: 63.11 +/-

OIL & GAS ROYALTY OWNER: STARVAGGI INDUSTRIES INC

ACREAGE: 323.85 +/-

LEASE NUMBERS:

DRILL  CONVERT  DRILL DEEPER  REDRILL  FRACTURE OR STIMULATE   
PLUG OFF FORMATION  PERFORATE NEW FORMATION  PLUG & ABANDON   
CLEAN OUT & REPLUG  OTHER CHANGE  (SPECIFY): \_\_\_\_\_

TARGET FORMATION: MARCELLUS

ESTIMATED DEPTH: TVD: 5,720' TMD: 13,517'

WELL OPERATOR: CHESAPEAKE APPALACHIA, LLC.

DESIGNATED AGENT: ERIC GILLESPIE

ADDRESS: PO BOX 18496

ADDRESS: PO BOX 6070

CITY: OKLAHOMA CITY STATE: OK ZIP CODE: 73154-0496

CITY: CHARLESTON STATE: WV ZIP CODE: 25362



WALLACE COUNTY

