

WEST VIRGINIA DEPARTMENT OF MINES

OIL & GAS DIVISION

WELL RECORD

Permit No. Bro-16

Oil Well

Steubenville Quad.

CASING & TUBING

Company	Wheeling Steel Corp.,	10	42	42
Address	Wheeling, W. Va.	8-1/4	325	325
Farm	Corporation ACRES 423	6-5/8	705	705
Location	1/2 mile East of Ohio River	5-3/16	980	980
Well No.	102 ELEV. 730			
District	Cross Creek - Brooke County	COAL ENCOUNTERED:		
Surface & Mineral	Wheeling Steel Corp., Wheeling, W. Va.		242'	
Drilling commenced	Dec. 13, 1938		260	
Drilling completed	Feb. 2, 1939		305	
Open Flow	Not recorded		370	
Volume	Small			
Rock Pressure	Not recorded			
Oil	Small showing			
Fresh Water	To 325			
Salt Water	From 375			

Formation Color ^{Har} TOP Base Result					Formation Color ^{Har} TOP Base Result				
Sand&Gravel	s		42		Slate&Shells	drk	m	1070	1095
Red Rock & Shale	av	42	110		Lime	drk	h	1095	1105
Shale	gray	m	110	115	Slate&Shells	"	m	1105	1118
Sand	dark	s	115	145	Lime	"	m	1118	1132
Shale	blk	m	145	150	Slate&Shells	"	m	1132	1160
Shale	gray	m	150	160	Lime	blue	m	1160	1181
Slate	blk	m	160	190	Shale	gray	m	1181	1253
Lime	blue	m	190	200	Sand	dark	m	1253	1268
Slate&Shells	drk	m	200	225	Sand	dark	h	1268	1291
Shale	lgt	m	225	242	Slate	blk	m	1291	1314
Coal	blk	m	242	247	Upper Freeport	blk	h	1314	1325 ¹ / ₂
Shale	brn	m	247	250	Sand	lgt	h	1325 ¹ / ₂	1327
Shale	lgt	m	250	260	Sand	lgt	s	1327	1329
Coal	blk	m	260	263	Sand	lgt	h	1329	1349
Shale	gray	m	263	290	Freeport	Shale	blk	m	1349
Slate	blk	m	290	305					
Slate&Coal	blk	m	305	310	Kittaning				
Lime	lgt	h	310	325					
Shale	lgt	m	325	355	Sh. gas @ 355	Well plugged back to 1330' and will be used for pressure well.			
Slate	blk	m	355	370		Small showing of oil with tract of gas present in Berea pay.			
Coal	blk	m	370	375	Kittaning				
Lime	drk	h	375	385					
Sand	lgt	m	385	460					
Slate	drk	m	460	464					
Slate&Shells	"	m	464	485					
Slate	blk	m	485	490					
White Mud	-	s	490	495					
Shale	blk	m	495	529					
Slate	blk	m	529	574					
Sand	lgt	m	574	595					
Slate	blk	m	595	610					
Sand	lgt	m	610	645	Salt				
Lime	blk	m	645	655					
Sand	lgt	m	655	657					
Sand	lgt	h	657	667					
Lime	lgt	h	667	692	Gritty				
Sand&Lime	lgt	m	692	695					
Sand	lgt	h	695	705					
Lime	blk	h	705	722					
Lime	white	h	722	766	Gritty				
Lime	white	m	766	815					
Slate&Shells	drk	m	815	825					
Sand	lgt.	m	825	974	B. Injun				
Slate	gray	m	974	994					
Slate&Shells	lgt	m	994	1030					
Lime	blue	m	1030	1070					

FEB 8 1939

1325
730
595

WEST VIRGINIA DEPARTMENT OF MINES
OIL AND GAS DIVISION

WELL RECORD

Permit No. WRO-16

Oil or Gas Well OIL
(Kind)

Company.....	WHEELING STEEL CORPORATION	Casing and Tubing	Used in Drilling	Left in Well	Packers
Address.....	WHEELING, W. VA.	Size			
Farm.....	CORPORATION Acres. 423	16.....			Kind of Packer <u>NONE</u>
Location (waters).....	1/2 mile East of Ohio River	13.....			Size of.....
Well No.....	102 Elev. 730 ft.	10.....	42'	42'	Depth set.....
District.....	CROSS CREEK County BROOKE	8 1/2.....	325'	325'	Depth set.....
The surface of tract is owned in fee by.....	WHEELING STEEL CORPORATION Address WHEELING, W. VA.	6 5/8.....	705'	705'	Perf. top.....
Mineral rights are owned by.....	SAME Address.....	5 3/16.....	980'	980'	Perf. bottom.....
Drilling commenced.....	Dec. 13, 1938	3.....			Perf. top.....
Drilling completed.....	Feb. 2, 1939	2.....			Perf. bottom.....
Date shot.....	NOT SHOT Depth of shot.....	Liners Used.....	NONE	NONE	Perf. top.....
Open Flow /10ths Water in.....	NOT RECORDED Inch				Perf. bottom.....
/10ths Merc. in.....	Inch				
Volume.....	SMALL Cu. Ft.	CASING CEMENTED.....	NONE	NONE	NO SIZE No. FT. Date
Rock Pressure.....	NOT RECORDED lbs. hrs.				
Oil.....	SMALL SHOWING bbls., 1st 24 hrs.	COAL WAS ENCOUNTERED AT.....			242 FEET INCHES
Fresh water.....	TO 325 feet			260 FEET INCHES 305 FEET INCHES
Salt water.....	FROM 375 feet			370 FEET INCHES FEET INCHES

Formation	Color	Hard or Soft	Top	Bottom	Oil Gas or Water	Depth Found	Remarks
Sand & Gravel	-	soft	surface	42'			
Red Rock & Shale	-	average	42'	110'			
Shale	gray	medium	110'	115'			
Sand	dark	soft	115'	145'			
Shale	black	medium	145'	150'			
Shale	gray	medium	150'	160'			
Slate	black	medium	160'	190'			
Lime	blue	medium	190'	200'			
Slate & Shells	dark	medium	200'	225'			
Shale	light	medium	225'	242'			
Coal	black	medium	242'	247'	(Upper Freeport)		
Shale	brown	medium	247'	250'			
Shale	light	medium	250'	260'			
Coal	black	medium	260'	263'	(Freeport)		
Shale	gray	medium	263'	290'			
Slate	black	medium	290'	305'			
Slate & Coal	black	medium	305'	310'	(Kittaning)		
Lime	light	hard	310'	325'			
Shale	light	medium	325'	355'	(Show of gas at 355')		
Slate	black	medium	355'	370'			
Coal	black	medium	370'	375'	(Kittaning)		
Lime	dark	hard	375'	385'			
Sand	light	medium	385'	460'			
Slate	dark	medium	460'	464'			
Slate & Shells	dark	medium	464'	485'			
Slate	black	medium	485'	490'			
White Mud	-	soft	490'	495'			
Shale	black	medium	495'	529'			
Slate	black	medium	529'	574'			
Sand	light	medium	574'	595'			
Slate	black	medium	595'	610'			
Sand	light	medium	610'	645'	(Salt)		
Lime	black	medium	645'	655'			
Sand	light	medium	655'	657'			
Sand	light	hard	657'	667'			
Lime	light	hard	667'	692'	(Gritty)		
Sand & Lime	light	medium	692'	695'			
Sand	light	hard	695'	705'			
Lime	black	hard	705'	722'			
Lime	white	hard	722'	766'	(Gritty)		

(Over)

Formation	Color	Hard or Soft	Top	Bottom	Oil, Gas or Water	Depth Found	Remarks
(CONTINUED)							
Lime	white	medium	766'	815'			
Slate & Shells	dark	medium	815'	825'			
Sand	light	medium	825'	974'	(Big Injun)		
Slate	gray	medium	974'	994'			
Slate & Shells	light	medium	994'	1030'			
Lime	blue	medium	1030'	1070'			
Slate & Shells	dark	medium	1070'	1095'			
Lime	dark	hard	1095'	1105'			
Slate & Shells	dark	medium	1105'	1118'			
Lime	dark	medium	1118'	1132'			
Slate & Shells	dark	medium	1132'	1160'			
Lime	blue	medium	1160'	1181'			
Shale	gray	medium	1181'	1253'			
Sand	dark	medium	1253'	1268'			
Sand	dark	hard	1268'	1291'			
Slate	black	medium	1291'	1314'			
Slate	black	hard	1314'	1325 $\frac{1}{2}$ '	(Cap Rock)		
Sand	light	hard	1325 $\frac{1}{2}$ '	1327'	(Berea)		
Sand	light	soft	1327'	1329'	(Berea Pay)		
Sand	light	hard	1329'	1349'	(Berea)		
Shale	black	medium	1349'	1353'			

WELL PLUGGED BACK TO 1330' AND WILL BE USED FOR PRESSURE WELL.

SMALL SHOWING OF OIL WITH TRACE OF GAS PRESENT IN BEREA PAY.

Date....., 19.....

APPROVED....., Owner

By.....
(Title)

NOTICE OF PROPOSED LOCATION OF OIL AND GAS WELL
(REQUIRED BY SECTION 2, CHAPTER 22, CODE 1931)
WEST VIRGINIA DEPARTMENT OF MINES
OIL AND GAS SECTION

To THE DEPARTMENT OF MINES,
Charleston, W. Va.

Wheeling Steel Corporation
COAL OPERATOR OR COAL OWNER

Wheeling, W. Va.
ADDRESS

COAL OPERATOR OR COAL OWNER

ADDRESS

Wheeling Steel Corporation
OWNER OF MINERAL RIGHTS

Wheeling, W. Va.
ADDRESS

Wheeling Steel Corporation
NAME OF WELL OPERATOR

Wheeling, W. Va.
COMPLETE ADDRESS

October 22, 1938
PROPOSED LOCATION

Cross Creek District

Brooke County

Well No. 102

Corporation Farm

GENTLEMEN:

The undersigned well operator is entitled to drill upon the above named farm or tract of land for oil and gas, having fee title thereto, (or as the case may be) under grant or lease dated

April 10, 1923, made by La Belle Iron Works, to

Wheeling Steel Corporation, and recorded on the 24th day

of July, 1923, in the office of the County Clerk for said County in

Book 53, page 266

The enclosed plat was prepared by a competent engineer and shows the proposed location of a well to be drilled for oil and gas by the undersigned well operator on the farm and in the Magisterial District and County above named, determined by survey and courses and distances from two permanent points, or land marks.

The undersigned well operator is informed and believes there are no coal operators operating beds of coal beneath said farm or tract of land on which said well is located, or within 500 feet of the boundaries of the same, who have mapped their workings and filed their maps as required by law, excepting the coal operators or coal owners (if any) above named as addressees.

The above named coal operators or coal owners (if any) are notified that any objections they may desire to make to such proposed location, or which they are required to make by Section 3 of said Code, if the drilling of a well at said proposed location will cause a dangerous condition in or about their respective coal mines, must be received by, or filed with the Department of Mines within ten days from the receipt of a copy of this notice and accompanying plat by said Department. Said coal operators are further notified that forms for use in making such objections will be furnished to them by the Department of Mines promptly on request and that all such objections must set forth as definitely as is reasonably possible the ground or grounds on which such objections are based and indicate the direction and distance the proposed location should be moved to overcome same.

(The next paragraph is to be completed only in Department's copy.)

Copies of this notice and the enclosed plat were mailed by registered mail, or delivered to the above named coal operators or coal owners at their above shown respective address day before, or on the same day with the mailing or delivery of this copy to the Department of Mines at Charleston, West Virginia.

Very truly yours,

Wheeling Steel Corporation
WELL OPERATOR

Address of Well Operator

STREET

Wheeling
CITY OR TOWN

W. Va.
STATE

*Section 3 If no such objections be filed, or be found by the department of mines, within said period of ten days from the receipt of said notice and plat by the department of mines, to said proposed location, the department shall forthwith issue to the well operator a drilling permit reciting the filing of such plat, that no objections have been made by the coal operators to the location, or found thereto by the department, and that the same is approved and the well operator authorized to proceed to drill at said location.

PROPOSED MANNER OF PLUGGING AND FILLING WELL

(REQUIRED BY RULES AND REGULATIONS)

WEST VIRGINIA DEPARTMENT OF MINES

OIL AND GAS DIVISION

WORK ORDER

Well to be plugged and filled as follows:

This well was drilled in December, 1938, and January and February, 1939, and has been used as a gas input well since then.

The total depth of the well is 1330 ft. with Berea sand at 1325½' to 1329'. This well was not shot.

Clay will be used as filling material from bottom of hole to 1305 ft. depth, which is 20 ft. above top of Berea sand, where a cement plug will be placed. After this plug hardens, the 5 3/16" casing will be pulled and clay used to fill hole to depth point, 805 ft. located 20 ft. above Injun sand, where another cement plug will be placed. From this plug, clay will again be used to fill hole to 590 ft. depth or 20 ft. above Salt sand, where the third cement plug will be placed. Clay will then be used as filler to 303 ft. depth, which is 40 ft. below Lower Freeport coal. Solid, pure cement plug will then be used, extending from 303 ft. depth point to 222 ft. depth or a distance of 20 ft. above Upper Freeport coal. Clay will be used to fill hole from this coal plug to the surface.

No gas present in this well so escape pipe will not be necessary.

The 6-5/8" casing had previously been removed from this well. The 8¼" casing will be pulled after setting of cement plug over Salt sand.

After plugging is completed, permanent concrete marker will be placed at well site.

To the Department of Mines
Coal Owner or Operator,
Lease or Property Owner.

Gentlemen:

This "work order" is submitted for your approval and concurrence and unless notified of your disapproval or non-concurrence, the undersigned will proceed with the plugging and filling of said well in the above described manner on the date stated in the notice of intention to plug and abandon the said well on opposite side of this sheet.

Very truly yours,

Wheeling Steel Corporation

By: *E. W. Huggins* Well Operator, Field Supt.

No objections have been filed by the coal owner or coal operator, or any available adjacent lease or property owners or interposed by the Department of Mines to the manner herein described for the plugging and filling of the well above mentioned. Therefore, the same is hereby approved this

21st day of July, 1944

DEPARTMENT OF MINES
Oil and Gas Division

By: *Marie E. Huggins*

NOTE: This "work order" shall be filed in triplicate, one copy for the files of the Department of Mines; one to be approved or corrected and returned to the well operator as his authority for plugging said well; and one for the well inspector.



STATE OF WEST VIRGINIA
 DEPARTMENT OF MINES
 OIL AND GAS DIVISION

NOTICE OF INTENTION TO PLUG AND ABANDON WELL

(REQUIRED BY SECTION 9, ARTICLE 4, CHAPTER 22 OF THE CODE)

To THE DEPARTMENT OF MINES,
 Charleston, W. Va.

Wheeling Steel Corporation
COAL OPERATOR OR COAL OWNER

Wheeling, W. Va.
ADDRESS

COAL OPERATOR OR COAL OWNER

ADDRESS

Wheeling Steel Corporation
LEASE OR PROPERTY OWNER

Wheeling, W. Va.
ADDRESS

Wheeling Steel Corporation
NAME OF WELL OPERATOR

Wheeling, W. Va.
COMPLETE ADDRESS

July 18, 194⁴

WELL TO BE ABANDONED

Cross Creek District

Brooke County

Well No. 102

Corporation Farm

NOTE: If plugging cannot begin on the date specified below, please notify
 Inspector D. F. Meist, Clarksburg, telephone 3053-R, or notify
 Oil & Gas Division, telephone 34-741.

Gentlemen:—

The undersigned well operator is about to abandon the above described well and will commence
 the work of plugging and abandoning said well on the 25th day of July, 194⁴,
 (which date shall not be less than five days after the day on which this notice so mailed is received,
 or in due course should be received by the Department of Mines.)

This notice is given you in order that your respective representatives may be present at the
 plugging and filling of said well. You are further notified that whether you are represented or not
 represented the undersigned will proceed on that date, or shortly thereafter, to plug and fill said
 well in the manner required by Section 10, Article 4, Chapter 22 of the Code and given in detail on the
 reverse side of this notice, in "Work Order."

This notice is being mailed by registered mail to each of you at the above addresses on the
 above date.

Very truly yours,

Wheeling Steel Corporation
 By: *J. H. Nugent* Well Operator.
 Field Spt.



NOTE: Upon the abandonment of all wells drilled prior to June 1, 1929, a plat prepared by a competent
 engineer, showing the district and county in which the tract of land is located, the name and acreage of same,
 the names of the owners and adjacent tracts, and the location of the about to be abandoned well, determined
 by survey, and the courses and distances of such well from two permanent points or landmarks on said tract, shall
 be submitted with this notice.

(Over)

Pro-16 -P PERMIT NUMBER

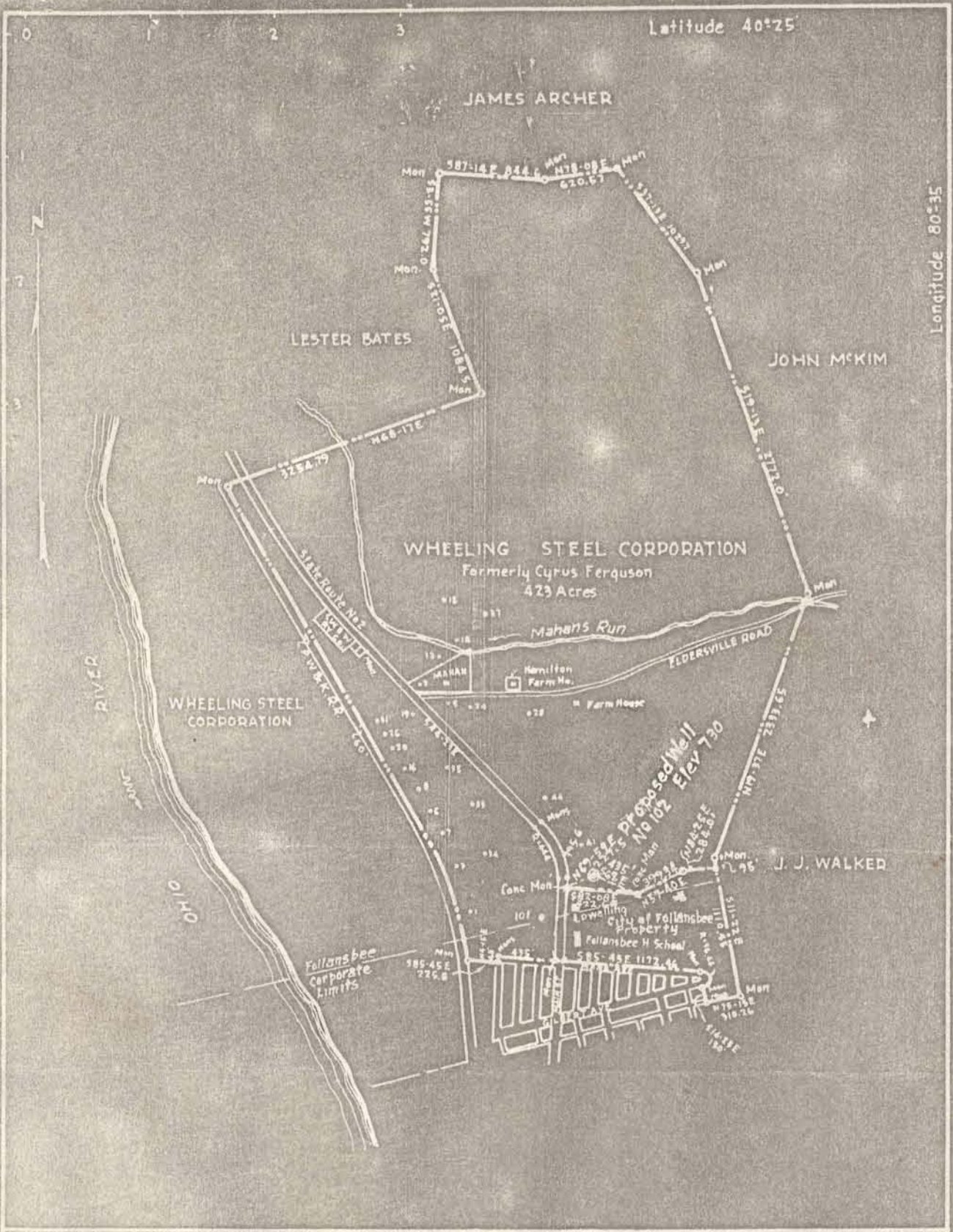

COMPANY Wheeling Steel Corporation
 ADDRESS (General Office) Wheeling, W. Va
 FARM Wheeling Steel Corporation (Formerly Cyrus Ferguson)
 TRACT _____ ACRES 423 LEASE NO. _____
 WELL (Farm) No 102 SERIAL No _____
 QUADRANGLE Staubenville
 COUNTY Brooke
 DISTRICT Cross Crack
 ENGINEER Eugene M. Smith - C.C. Smith's Sons
 ENGINEERS REGISTRATION No 390
 FILE No _____ DRAWING No _____
 DATE Oct 20, 1938 SCALE - 1" = 1000'

STATE OF WEST VIRGINIA
 DEPARTMENT OF MINES
 OIL AND GAS DIVISION
 CHARLESTON

WELL LOCATION MAP
 FILE NO. _____

+ Denotes location of well on United States Topographic Maps, Scale 1 to 62,500 latitude and longitude lines being represented by border lines as shown.
 - Denotes one inch spaces on border line of original tracing.