

LATITUDE

LONGITUDE

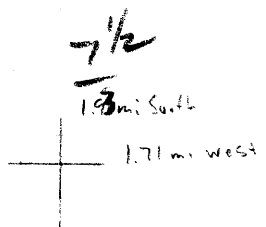

located from
1929 Equitable
Resources
Property Map

7'5 OGIS topo location

7.5' 10C	<u>1.935</u>	15' 10C	_____
	<u>1.71W</u>	(calc.)	_____

Company	<u>Pure Oil Co</u>
Farm	<u>La Follette Robson Perchard 'C'</u>
	<u>#1</u>
SECTION MAP	
Quad	<u>Sylvester (7 1/2)</u>
County	<u>Boone</u>
District	<u>Sherman</u>

WELL LOCATION MAP

File No. 005-70004 Bifarm

Sherman
District, Boone County, W. Va.

The Pure Oil Co., Jas. H. Dye, Mgr., Charleston, W. Va.

Well located on waters of Threemile Branch of Big White Oak Creek.

Elevation, surface, 943'; Big Lime, -1162'; Big Injun, -1392';

Berea, -1847'.

Rig commenced by D. Huffman.

Drilling commenced June 13, 1921 - Walter Lipscomb; completed,

Oct. 18, 1921 - Fred Hall.

Contractor: P. O. Drilling Div., Newark, Ohio.

Well dry in all sands.

Conductor, 16' of 16" (left in); 10" casing, 430' (left in); 8 $\frac{1}{4}$ "

1440' (pulled); 6-5/8", 2130' (pulled).

	Top.	Bottom.
Gravel	0	18
Sand	18	50
Coal	50	54
Sand	54	86
Slate and lime	86	310
Sand	310	385
Slate	385	392
Coal	392	396
Lime	396	410
Coal	410	413
Sand	413	473
Slate and lime	473	595
Sand	595	704
Slate and lime	704	730
Sand	730	855
Slate	855	859
Sand (Grampus)	859	950
Lime shells	950	1040
Salt Sand (yellow)	1040	1430
Slate, black	1430	1440
Lime and sand	1440	1565
Slate and lime	1565	1680
Red rock	1680	1708
Slate	1708	1745
Maxton Sand	1745	1890
Lime	1890	1905
Red rock	1905	1909
White slate	1909	1915
Red rock	1915	1930
Slate and lime	1930	2010
Little Lime	2010	2100
Pencil Cave	2100	2105
Big Lime	2105	2335
Big Injun Sand	2335	2375
Lime and shells	2375	2565
Weir Sand (broken and shell)	2565	2650
Slate and shells	2650	2790
Berea Sand	2790	2795
Slate and shells, to bottom	2795	3210