

Latitude 38° 05'

Longitude 81° 45'

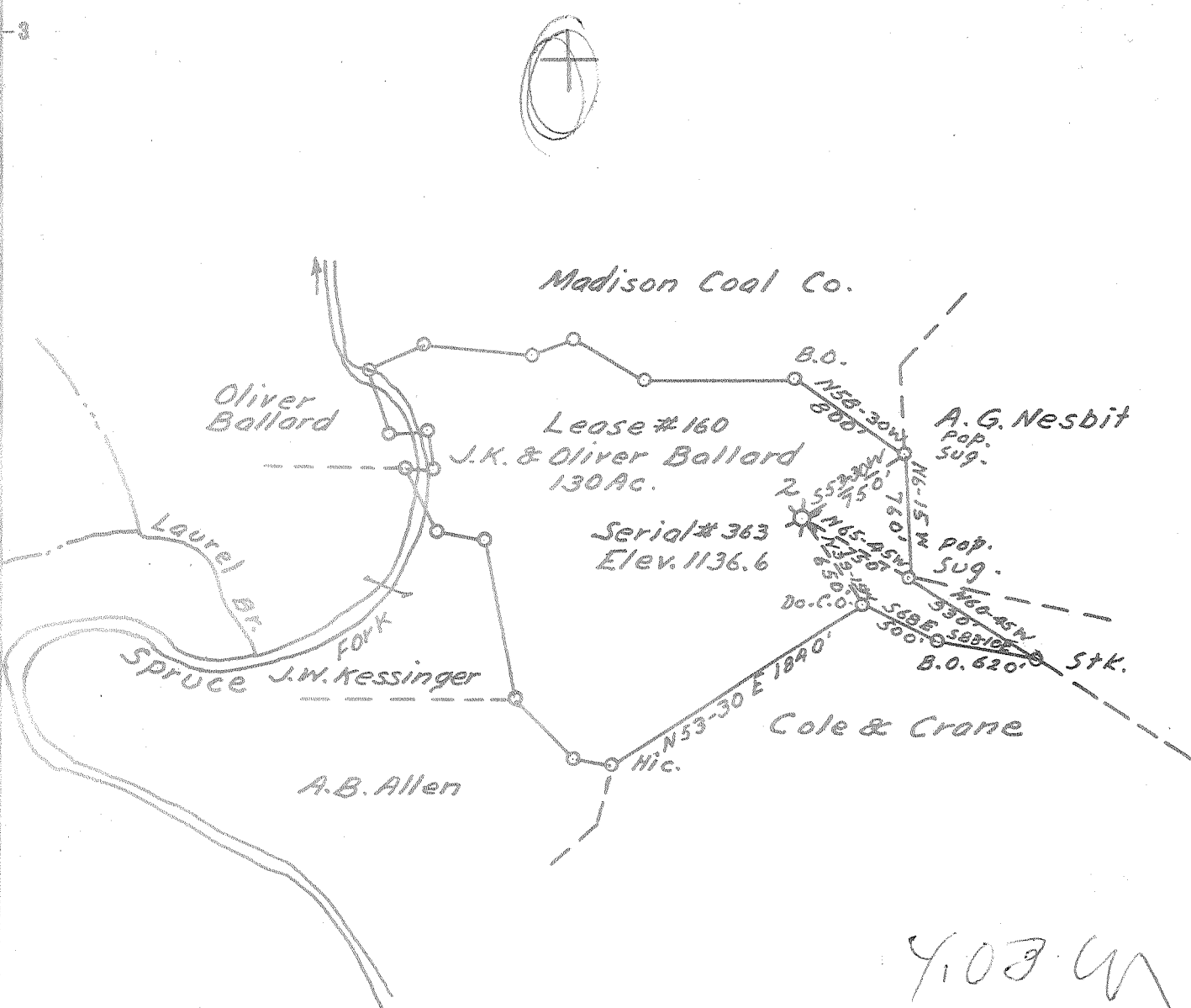

- New Location
- Drill Deeper
- Abandonment

4103 W  
3.77 D

Company	<u>E.L. Spurlock</u>
Address	<u>Charleston W.Va.</u>
Farm	<u>J.K. &amp; Oliver Ballard</u>
Tract	Acres <u>130</u> Lease No. <u>160</u>
Well (Farm) No.	<u>2</u> Serial No. <u>363</u>
Elevation (Spirit Level)	<u>1136.6</u>
Quadrangle	<u>Madison 7-53.30 "W 45"</u>
County	<u>Boone</u> District <u>Washington</u>
Engineer	<u>Stuel Ramsey</u>
Engineer's Registration No.	<u>1540</u>
File No.	Drawing No.
Date	<u>Jan. 3, 1963</u> Scale <u>1" = 1000 Ft.</u>

APR 3 1964

STATE OF WEST VIRGINIA  
DEPARTMENT OF MINES  
OIL AND GAS DIVISION  
CHARLESTON

**WELL LOCATION MAP**  
FILE NO. Boo-415-A

+ Denotes location of well on United States Topographic Maps, scale 1 to 62,500, latitude and longitude lines being represented by border lines as shown.

- Denotes one inch spaces on border line of original tracing.

J.K. & OLIVER BALLARD No. 2 (363) — R.L. SPURLOCK — Boo-415-A