

Latitude 38° 10'

Longitude 81° 35'

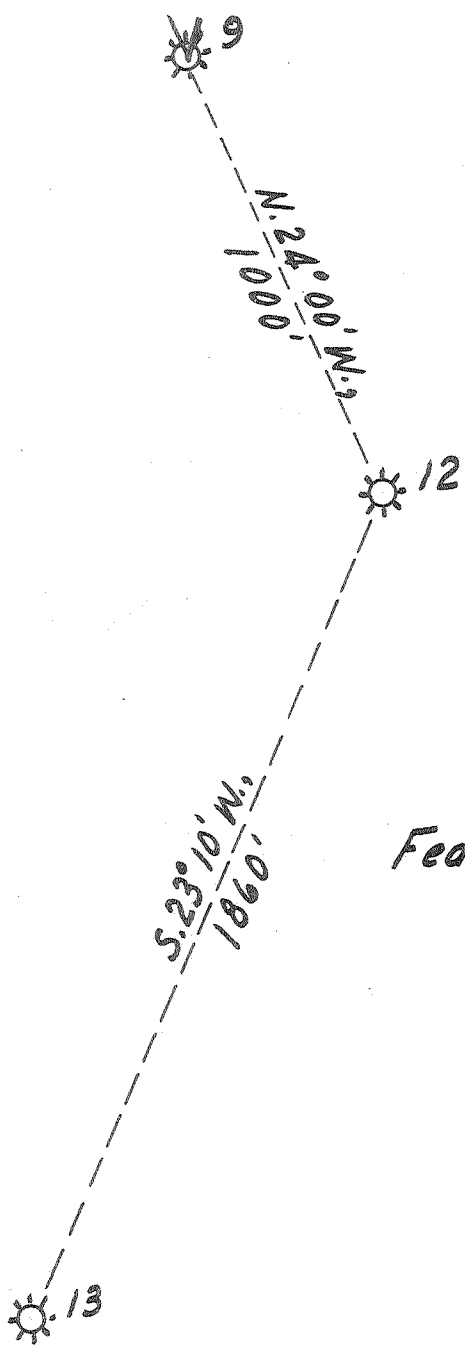

+ 538 S
1.5 W

Federal Coal Co
11,849.47^{ac.}

New Location
 Drill Deeper
 Abandonment

Company	Pure Oil Co.	
Address	Reed City, Michigan RFD 1	
Farm	Federal Coal Co.	
Tract	Acres 11849.47	Lease No. Old 236 New 43213
Well (Farm) No.	12	Serial No. 550
Elevation (Spirit Level)	1561	
Quadrangle	Peytona	
County	Boone	District Sherman
Engineer	J. B. Hunter	
Engineer's Registration No.	Ohio 2912	
File No.	Drawing No.	
Date 6-1-61	Scale 1" = 400'	

STATE OF WEST VIRGINIA
 DEPARTMENT OF MINES
 OIL AND GAS DIVISION
 CHARLESTON

WELL LOCATION MAP
 FILE NO. 800-385-A

+ Denotes location of well on United States Topographic Maps, scale 1 to 62,500, latitude and longitude lines being represented by border lines as shown.

- Denotes one inch spaces on border line of original tracing.