

Latitude 38° 05'

Longitude 81° 45'

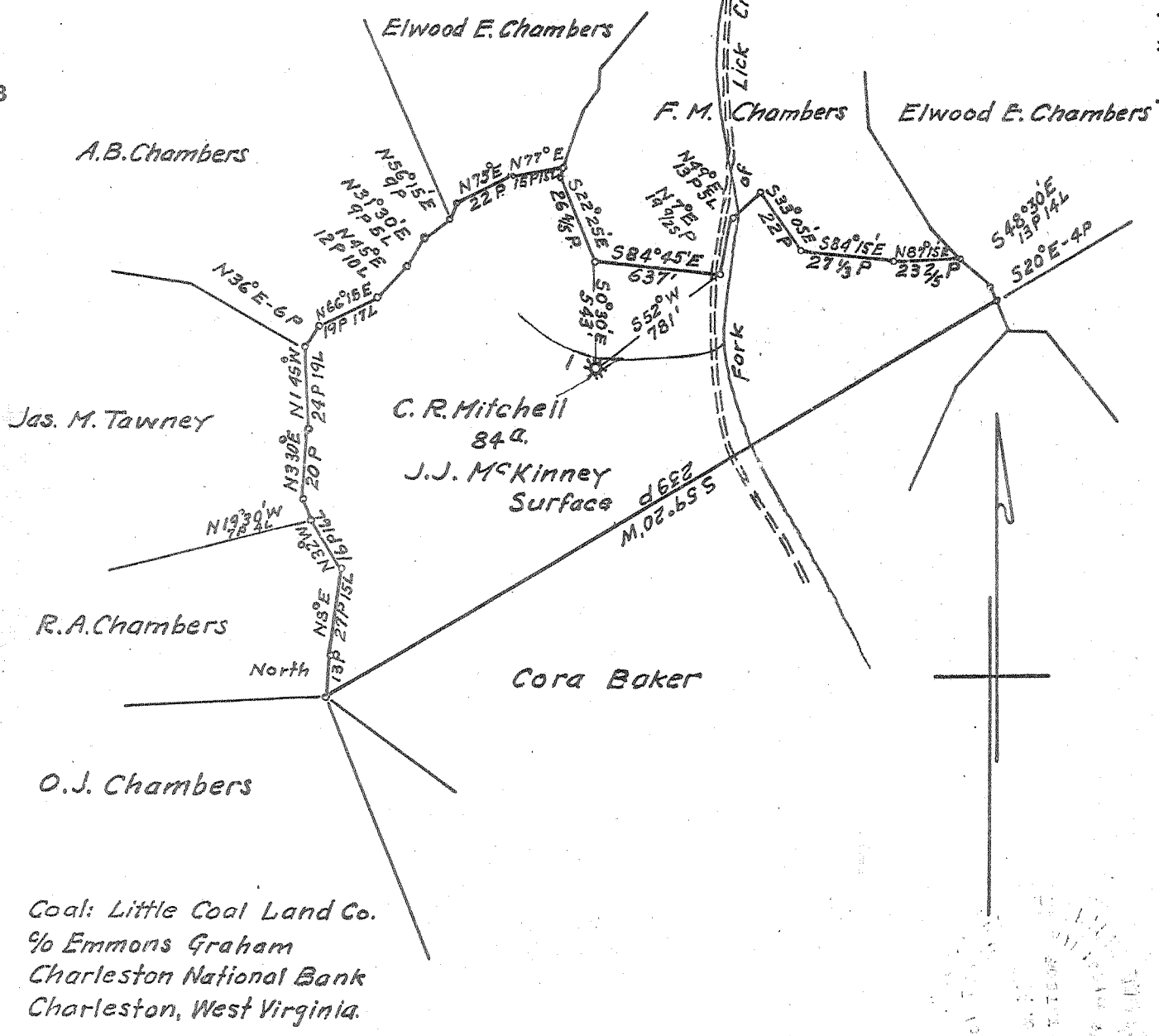

Coal: Little Coal Land Co.
 % Emmons Graham
 Charleston National Bank
 Charleston, West Virginia.

- New Location...
- Drill Deeper.....
- Abandonment.....

South 93 West 72

Company	<u>South Penn Natural Gas Co.</u>
Address	<u>Parkersburg, W. Va.</u>
Farm	<u>C.R. Mitchell</u>
Tract	Acres <u>84</u> Lease No. <u>72925</u>
Well (Farm) No.	<u>1</u> Serial No. _____
Elevation (Spirit Level)	<u>823.0 Ground</u>
Quadrangle	<u>Madison</u>
County	<u>Boone</u> District <u>Scott</u>
Engineer	<u>Thos. D. Hayes</u>
Engineer's Registration No.	<u>1429</u>
File No.	_____ Drawing No. _____
Date	<u>3-3-55</u> Scale <u>1"=800'</u>

STATE OF WEST VIRGINIA
 DEPARTMENT OF MINES
 OIL AND GAS DIVISION
 CHARLESTON

WELL LOCATION MAP
 FILE NO. B00-237-A

- + Denotes location of well on United States Topographic Maps, scale 1 to 62,500, latitude and longitude lines being represented by border lines as shown.
- Denotes one inch spaces on border line of original tracing.

Medison
Boo-237A

687

SOUTH PENN NATURAL GAS CO.
WELL REPORT
NEW WELL REPORT

LEASE NO. 72925 84 ACRES WORKING DISTRICT Freeman #2

C. R. Mitchell FARM WELL NO. 1 N. S. 95 E. W. 72

Scott DISTRICT OR TOWNSHIP Boone COUNTY QUAD.

LOCATION MADE 84 ac - 19 DRILLING COMMENCED August 4, 1928 19

RIG COMMENCED Elmer 893' 50' 19 DRILLING COMPLETED October 4, 1928 19

RIG COMPLETED 19 DEPTH 1964 SAND Berea Grit

RIG CONTRACTOR DRILLING CONTRACTOR

ELEVATION: FLOOR GROUND WORK ORDER NO.

FORMATION RECORD

KIND	TOP	BOTTOM	STEEL LINE MEAS.	TEST	KIND	TOP	BOTTOM	STEEL LINE MEAS.	TEST
Gravel		20							
Sand	20	70							
Slate	70	120							
Sand	120	155							
Slate & Shel	155	305							
Sand	305	410							
Slate	410	415							
Sand	415	565							
Slate & Shel	565	710							
Salt Sand	710	1012							
Water (Salty)		760		Hole Full					
Red Rock	1012	1018							
Lime	1018	1025							
Red Rock	1025	1030							
Slate & Shell	1030	1090							
Maxon Sand	1090	1135							
Little Lime	1135	1226							
Big Lime	1226	1417	1226						
Gas		1580		6/10 W. 2" 103 me5					
Big Injun	1417	1454							
Slate & Shell	1454	1550							
Lime	1550	1595							
Slate & Shel	1595	1874							
Brown Shale	1874	1894							
Berea Sand	1894	1922	1894						
Gas	1896	1908							
Lime	1922	1932							
Slate	1932	1964							
Total Depth		1964	1964						

MAR 1955
RECEIVED
WEST VIRGINIA
DEPT. OF MINES
MAR 23 1957

NEW WELL REPORT - CONTINUED

INITIAL TORPEDO RECORD		CASING AND TUBING RECORD						
		SIZE	PUT IN WELL			PULLED OUT		
Date of Shot	10-5, 1928		TRANSFER NO.	FEET	INCH	TRANSFER NO.	FEET	INCH
Name of Torpedo Co.		XXXXX		XXXXXX			XXXX	
No. of Quarts 90		XXXXX		XXXXXX			XXXX	
Length of Shell		XXXXX		XXXXXX				
Diameter of Shell		XXXXX		XXXXXX				
Length of Anchor		10"		290			293	
Top of Shot 1895 $\frac{1}{2}$		8 $\frac{1}{2}$ "		1022			1031	
Bottom of Shot 1918		6 5/8"		1261				
Feet of Fluid in Hole When Shot								
Results: O. F.								

PACKER RECORD				
INITIAL PRODUCTION FIRST 24 HOURS	KIND	SIZE	DEPTH SET	DATE SET
Oil	Gas Anchor	2x6-5/8x16	1566	
Gas				

REMARKS:

APPROVED



SUPERINTENDENT