

A. N 13-39-39E 7181.203
 B. N 58-16-04E 112.767
 C. S 14-17-09W 9261.918

*Janil
10/1/97*

LATITUDE 37-59-30
 39

COAL CO-ORDINATES

N 603200.00
 E 3201930.00

1" SOLID BAR MON. FOUND ON STRIP WIRE

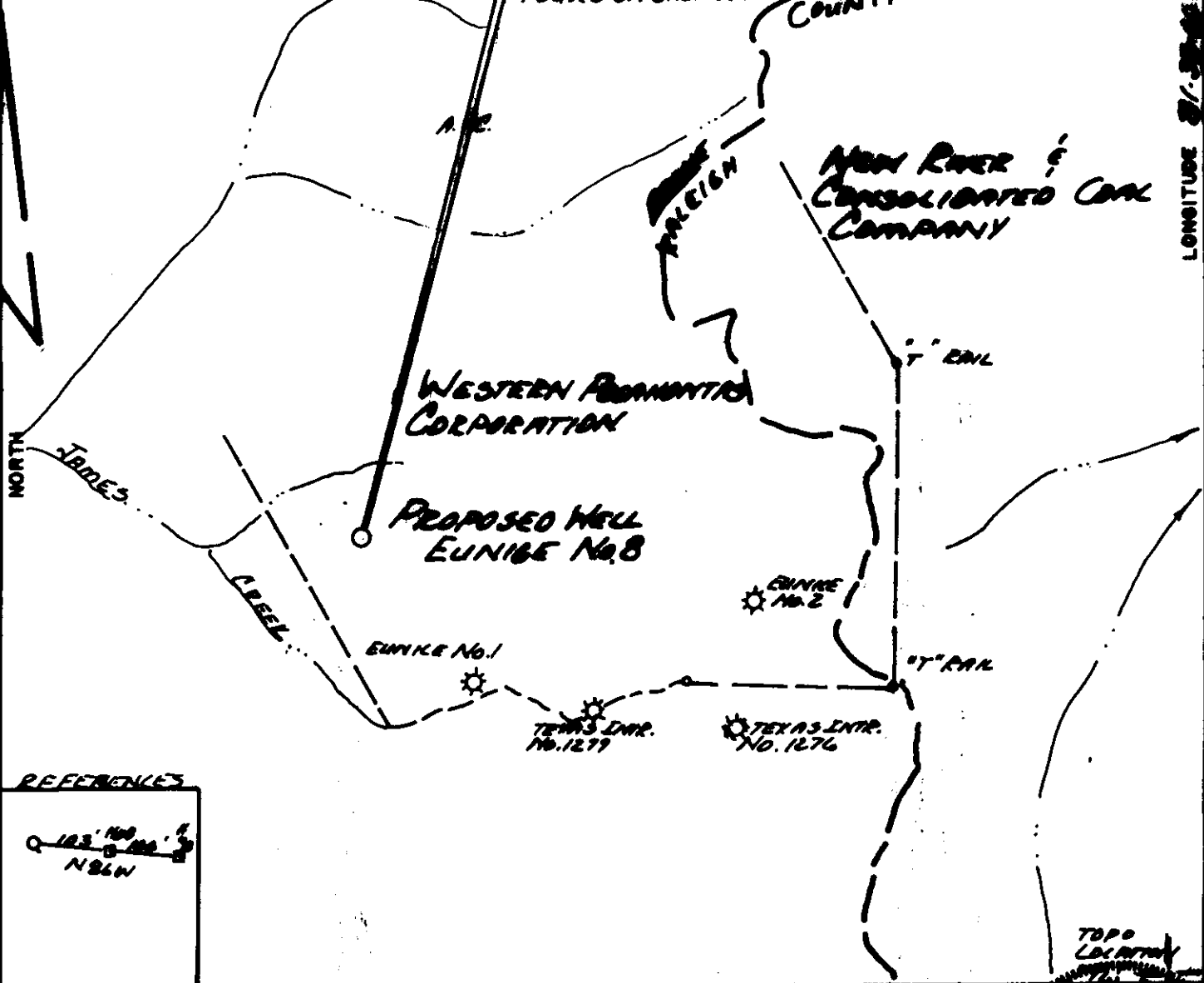

REFERENCES

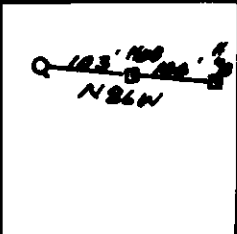

FILE NO. _____
 DRAWING NO. _____
 SCALE 1-2000
 MINIMUM DEGREE OF ACCURACY 1-2500
 PROVEN SOURCE OF ELEVATION 2233 HIGH PT EAST OF LOCATION

I THE UNDERSIGNED, HEREBY CERTIFY THAT THIS PLAT IS CORRECT TO THE BEST OF MY KNOWLEDGE AND BELIEF AND SHOWS ALL THE INFORMATION REQUIRED BY LAW AND THE REGULATIONS ISSUED AND PRESCRIBED BY THE DEPARTMENT OF MINES.
 (SIGNED) Suzanne Swannan
 R.P.E. _____ L.L.S. 736

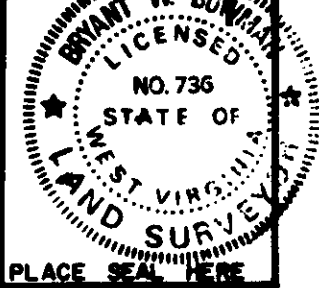

WEST VIRGINIA
 DIVISION OF ENVIRONMENTAL PROTECTION
 OFFICE OF OIL AND GAS
 #10 McJUNKIN ROAD
 NITRO, WEST VIRGINIA 25143-2506



DATE 6/2 1981
 OPERATOR'S WELL NO. EUNICE No. 8
 API WELL NO. _____
47 - 005 01436 P
 STATE COUNTY PERMIT

WELL TYPE: OIL ___ GAS LIQUID INJECTION ___ WASTE DISPOSAL ___
 (IF "GAS", PRODUCTION ___ STORAGE ___ DEEP ___ SHALLOW ___)
 LOCATION: ELEVATION 2081 WATER SHED JAMES CREEK OF WEST FORK
 DISTRICT C. CROOK COUNTY BOONE
 QUADRANGLE WHITESVILLE 7 1/2'
 SURFACE OWNER WESTERN POCAHONTAS ACREAGE 2.001-
 OIL & GAS ROYALTY OWNER WESTERN POCAHONTAS LEASE ACREAGE 2.001-
 LEASE NO. _____
 PROPOSED WORK: DRILL CONVERT ___ DRILL DEEPER ___ REDRILL ___ FRACTURE OR STIMULATE ___ PLUG OFF OLD FORMATION ___ PERFORATE NEW FORMATION ___ OTHER PHYSICAL CHANGE IN WELL (SPECIFY) Well drilled in 1981. Annular formation of WVA
 PLUG AND ABANDON ___ CLEAN OUT AND REPLUG ___
 TARGET FORMATION DEVONIAN SHALES ESTIMATED DEPTH 587' 3968'
 Peake Operating Company
 P.o. Box 8
 Ravenswood, wva. 26164-0008
 ESN Thomas Liberatore
 DDW Same Address
 PH: 304-273-5371

Permanent plugging

BOONE 1436

7/13/84
 A. N 13-39-39E 7181.203
 B. N 58-16-04E 112.767
 C. S 14-17-09W 9261.918

LATITUDE 39-59-30

COAL COORDINATES
 N 603200.00
 E 3201930.00

1" SOLID BAR MON. FOUND ON STRIP WALL
 1" SOLID BAR MON. FOUND ON STRIP WALL

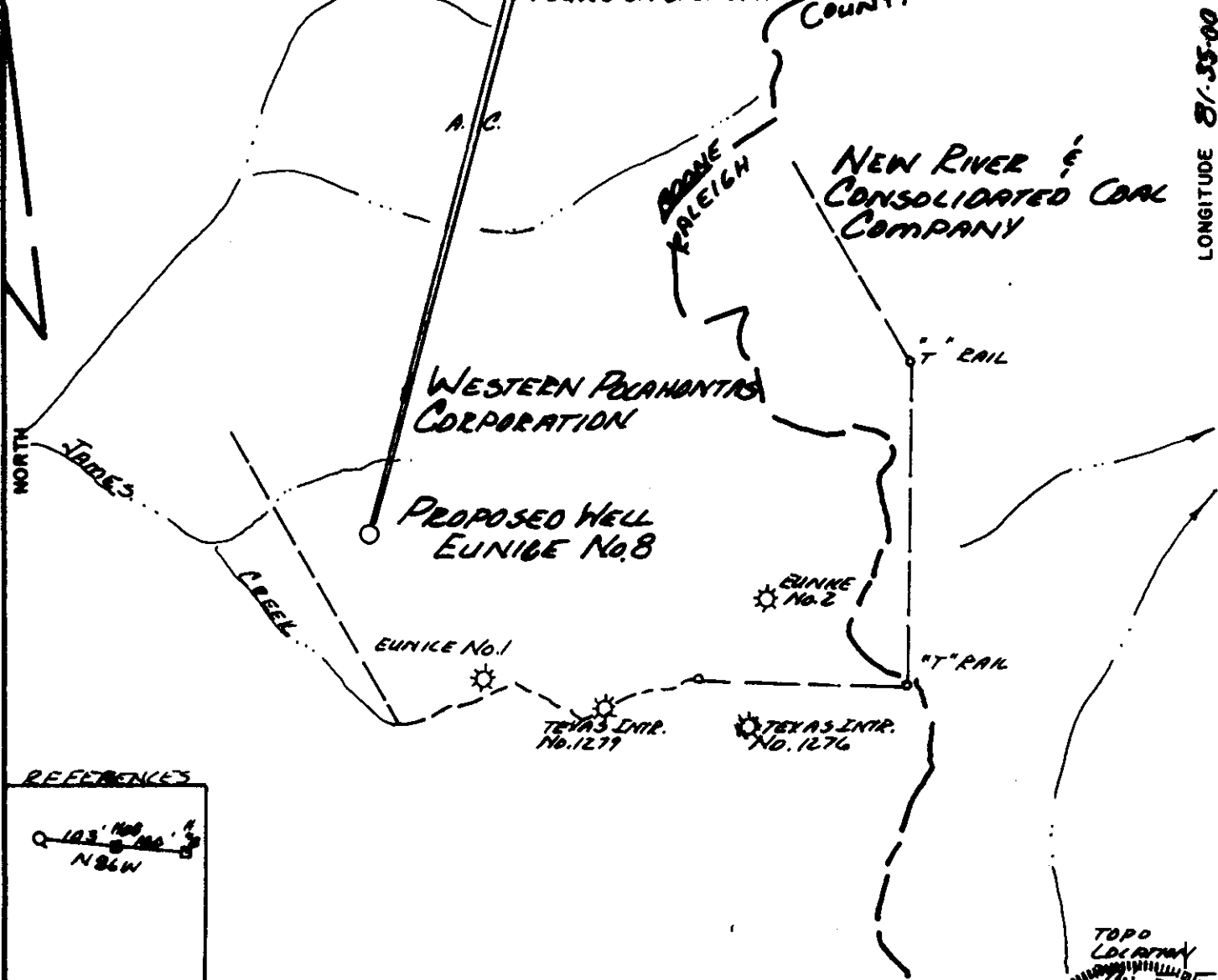

LONGITUDE 81-55-00

00051

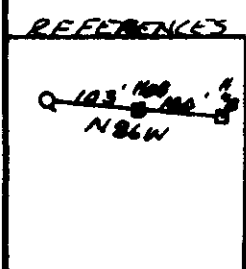

FILE NO. _____
 DRAWING NO. _____
 SCALE 1-2000
 MINIMUM DEGREE OF ACCURACY 1-2500
 PROVEN SOURCE OF ELEVATION 22.3 HIG. H. PT. EAST OF LOCATION

I THE UNDERSIGNED, HEREBY CERTIFY THAT THIS PLAT IS CORRECT TO THE BEST OF MY KNOWLEDGE AND BELIEF AND SHOWS ALL THE INFORMATION REQUIRED BY LAW AND THE REGULATIONS ISSUED AND PRESCRIBED BY THE DEPARTMENT OF MINES.
 (SIGNED) [Signature]
 R.P.E. _____ L.L.S. 736

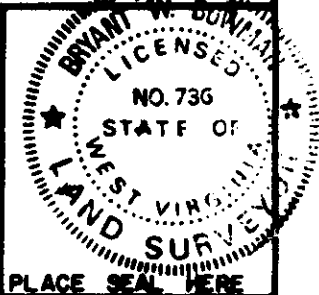

(+) DENOTES LOCATION OF WELL ON UNITED STATES TOPOGRAPHIC MAPS
 FORM IV-6 (8-78)

WELL TYPE: OIL _____ GAS LIQUID INJECTION _____ WASTE DISPOSAL _____
 (IF "GAS", PRODUCTION _____ STORAGE _____ DEEP _____ SHALLOW _____)

LOCATION: ELEVATION 2081 WATER SHED JAMES CREEK OF WEST FORK
 DISTRICT CROOK COUNTY BOONE
 QUADRANGLE WHITESVILLE 7 1/2' Bald Knob NC

SURFACE OWNER WESTERN POCHANONTAS ACREAGE 2.200+-
 OIL & GAS ROYALTY OWNER WESTERN POCHANONTAS LEASE ACREAGE 2.200+-
 LEASE NO. _____

PROPOSED WORK: DRILL CONVERT _____ DRILL DEEPER _____ REDRILL _____ FRACTURE OR STIMULATE _____ PLUG OFF OLD FORMATION _____ PERFORATE NEW FORMATION OTHER, PHYSICAL CHANGE IN WELL (SPECIFY) _____

PLUG AND ABANDON _____ CLEAN OUT AND REPLUG _____

TARGET FORMATION DEVONIAN SHALES ESTIMATED DEPTH 5899
 WELL OPERATOR PEAKE OPERATING CO. DESIGNATED AGENT FLOYD WILCOX
 ADDRESS 423 CHAS. NAT. PLAZA ADDRESS 423 CHAS. NAT. PLAZA
CHARLESTON, W.V.A. CHARLESTON, W.V.A.

DATE 4/2 1981
 OPERATOR'S WELL NO. EUNICE No. 8
 API WELL NO. _____
47 - 005 - 1436 REVISED
 STATE COUNTY PERMIT

Department of Mines
 Oil & Gas Division

PLACE SEAL HERE

BOONE 1436

IV-35
(Rev 8-81)

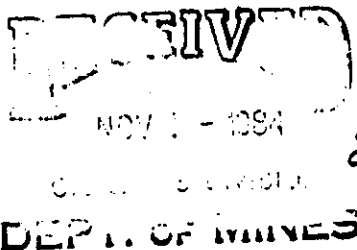

State of West Virginia

Department of Mines
Oil and Gas Division

Date Oct 26 1984
Operator's Well No. #8-A
Farm EUNICE
API No. 47-005-1436

WELL OPERATOR'S REPORT
OF
DRILLING, FRACTURING AND/OR STIMULATING, OR PHYSICAL CHANGE

WELL TYPE: Oil / Gas / Liquid Injection / Waste Disposal
(If "Gas," Production / Underground Storage / Deep / Shallow)

LOCATION: Elevation: 2081 Watershed JAMES CREEK OF WEST FORK
District: CROOK County BOONE Quadrangle WHITESVILLE 7 1/2'

COMPANY PEAKE OPERATING CO
ADDRESS #423 CHARLESTON NATL PLAZA
CHARLESTON WV
DESIGNATED AGENT FLOYD B WILCOX
ADDRESS (SAME)
SURFACE OWNER WESTERN PEACHTAS CORP
ADDRESS HUNTINGTON WV
MINERAL RIGHTS OWNER SAME
ADDRESS _____
OIL AND GAS INSPECTOR FOR THIS WORK
ARTHUR ST CLAIR ADDRESS BRENTON WV
PERMIT ISSUED 7/17/84
DRILLING COMMENCED 8/19/84
DRILLING COMPLETED 9/11/84
IF APPLICABLE: PLUGGING OF DRY HOLE ON CONTINUOUS PROGRESSION FROM DRILLING OR REWORKING. VERBAL PERMISSION OBTAINED ON _____

Casing & Tubing	Used in Drilling	Left in Well	Cement fill up Cu. ft.
Size 20-16 Cond.	30	30	25 SKS
13-10"	130	130	145 SKS
9 5/8	1105	1105	325 SKS
8 5/8			
7	2524	2524	230 SKS
5 1/2			
4 1/2		3500	
3			
2			
Liners used			

GEOLOGICAL TARGET FORMATION DEVONIAN SHALE Depth NOT REACHED feet
Depth of completed well 3958 feet Rotary / Cable Tools _____
Water strata depth: Fresh _____ feet; Salt 2691' feet
Coal seam depths: 85', 1053' Is coal being mined in the area?

OPEN FLOW DATA
Producing formation WEIR Pay zone depth 3714-3755 feet
Gas: Initial open flow 52 Mcf/d Oil: Initial open flow _____ Bbl/d
Final open flow 273 Mcf/d Final open flow _____ Bbl/d
Time of open flow between initial and final tests 4 hours
Static rock pressure 735 psig (surface measurement) after _____ hours shut in
(If applicable due to multiple completion--)
Second producing formation _____ Pay zone depth _____ feet
Gas: Initial open flow _____ Mcf/d Oil: Initial open flow _____ Bbl/d
Final open flow _____ Mcf/d Oil: Final open flow _____ Bbl/d
Time of open flow between initial and final tests _____ hours
Static rock pressure _____ psig (surface measurement) after _____ hours shut in

(Continue on reverse side)

DETAILS OF PERFORATED INTERVALS, FRACTURING OR STIMULATING, PHYSICAL CHANGE, ETC.

PERFORATED WEIR 3715-3723 WITH 2.2 HOLES

FRACT WEIR: 1000 g 15% HCL, 324 bbl water, 20,000 # 2 1/4" round

BDP - HYDROSTATIC HEAD; ATP 1200 PSI; MTP 1700 PSI

AVERAGE RATE 22.3 BPM. USED 850 # GEL

BLENDER BROKE DOWN MIDWAY THRU JOB.

WELL LOG

FORMATION	COLOR	HARD OR SOFT	TOP FEET	BOTTOM FEET	REMARKS Including indication of all fresh and salt water, coal, oil and gas
SHALE			0	60	
SANDY SHALE			60	1053	
SHALE			1053	1241	
SANDY SHALE			1241	1845	
SAND			1845	1970	
SANDY SHALE			1970	2019	
SAND			2019	2334	
SHALE			2334	2348	
SAND			2348	2530	
SANDY SHALE			2530	2648	GAS CHECKS:
RAVENCLIFF			2648	2673	3196' NO SHOW
SHALE			2673	2698	3611' TST G
AUIS LIME			2698	2724	3768' 51.68 M
SANDY SHALE			2724	2830	3927 39.43 M
SAND			2830	2924	
LIMEY SHALE			2924	2960	
SAND			2960	3218	
BIG LIME			3218	3578	
SHALE			3578	3714	
WEIR			3714	3756	
SHALE			3756	T.D	
	DTD		3958		
	LTD		3968		

(Attach separate sheets as necessary)

PEAKE OPERATING CO
Well Operator

By: Flayd B Wilen

Date: OCT 26 1984

Note: Regulation 2.02(i) provides as follows:
"The term 'log' or 'well log' shall mean a systematic detailed geological record of all formations, including coal, encountered in the drilling of a well."