

2020'

Latitude 38° 10"

Jamie
6/5/44

HORSE CR. COAL & LAND CO.
LINCOLN BOONE CO.

*1673

LOC. 15

1597.5
81° 55'

6470

Longitude

POPLAR
561° 28' E
898 FT.

N 83° 09' E
1319 FT.

ROCKPILE

542° 30' W
900 FT.

7.5
1.245
0.370

HORSE CR.
N 29° 55' W
2317 FT.

W.O.
N 53° 50' W
650 FT.

LOC. *4A

1674 *

GEO. P. ALDERSON

428 AC.

LINCOLN CO.

COAL & LAND CO.

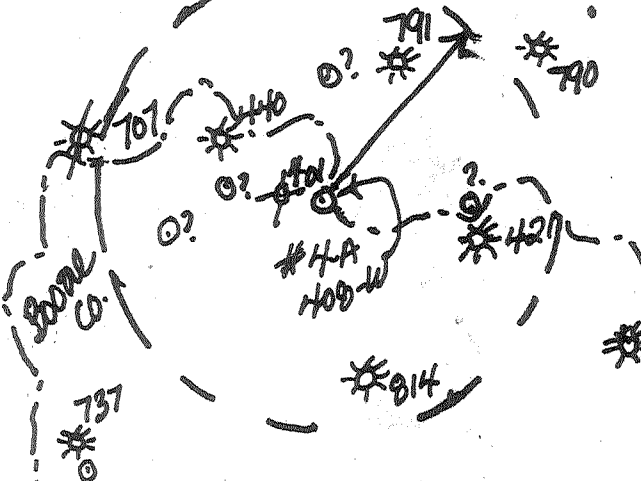

COAL NOT OPERATED

*6

- New Location...
- Drill Deeper...
- Abandonment...

Company **CAMERON OIL & GAS CO.** 154
 Address *120 Commerce Bank Bldg, W. 25301*
 Farm **GEO. P. ALDERSON**
 Tract **428** Acres _____ Lease No. _____
 Well (Farm) No. **4A** Serial No. _____
 Elevation (Spirit Level) **1176.89**
 Quadrangle **MADISON. 15 / Griffithville 7.5**
 County **BOONE** District **SCOTT**
 Engineer **G. E. Krebs**
 Engineer's Registration No. **9**
 File No. **11,917** Drawing No. _____
 Date **7-10-45** Scale 1" = 400 FT.

STATE OF WEST VIRGINIA
Division of Environmental Protection
Office of Oil & Gas
Niteo, W.Va.

WELL LOCATION MAP
Oil Well No. 47-005-00408-W

+ Denotes location of well on United States Topographic Maps, scale 1 to 62,500, latitude and longitude lines being represented by border lines as shown.

- Denotes one inch spaces on border line of original tracing.

JUN 11 1994

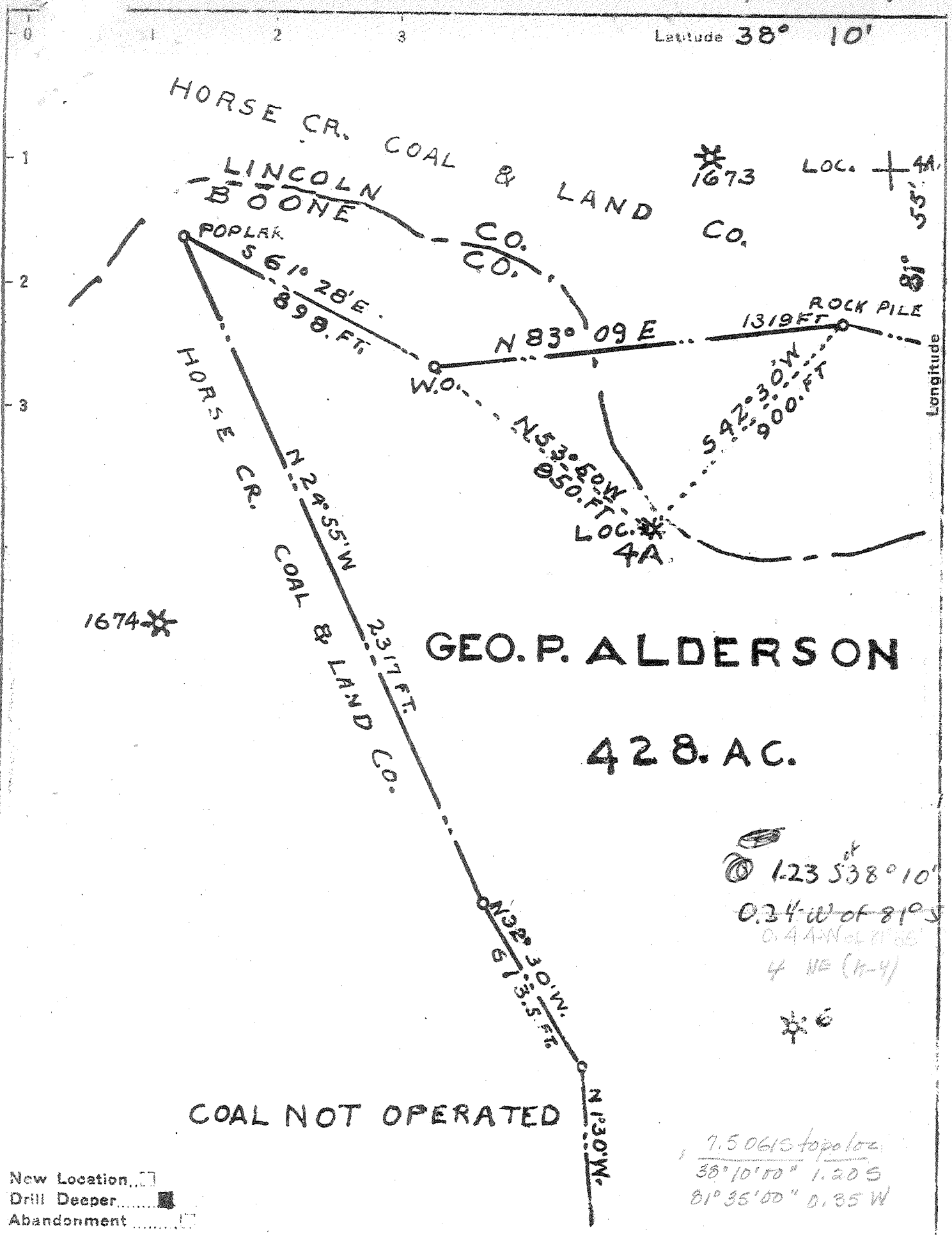

New Location

Drill Deeper

Abandonment

Company CAMERON OIL & GAS CO.

Address CHARLESTON, W.VA.

Farm GEO. P. ALDERSON.

Tract 428. Acres _____ Lease No. _____

Well (Farm) No. 4A. Serial No. _____

Elevation (Spirit Level) 1176.89

Quadrangle MADISON. — WE

County BOONE. District SCOTT.

Engineer G. E. Krebs.

Engineer's Registration No. 9.

File No. 11,917. Drawing No. _____

Date 7-10-45. Scale 1" = 400 FT.

STATE OF WEST VIRGINIA
DEPARTMENT OF MINES
OIL AND GAS DIVISION
CHARLESTON

WELL LOCATION MAP

FILE NO. B00-408-D
FORMERLY B00-740-D

+ Denotes location of well on United States Topographic Maps, scale 1 to 62,500, altitude and longitude lines being represented by border lines as shown.

- Denotes one inch spaces on border line of original tracing

3-3 246 Deep Well

State of West Virginia
Division of Environmental Protection
Section of Oil and Gas

Well Operator's Report of Well Work

Farm name: ALDERSON, GEORGE P. HEIRS Operator Well No.: ALDERSON 4-A

LOCATION: Elevation: 1,176.89 Quadrangle: GRIFFITHSVILLE

District: SCOTT County: BOONE
Latitude: 6470 Feet South of 38 Deg. 10Min. 0 Sec.
Longitude 2020 Feet West of 81 Deg. 55 Min. 0 Sec.

Company: CAMERON OIL & GAS COMPANY
P. O. BOX 1462
CHARLESTON, WV 25325-1462

Agent: JOHN A. HOPKINS

Inspector: RICHARD CAMPBELL
Permit Issued: 06/07/94
Well work Commenced: 06/14/94
Well work Completed: 07/12/94
Verbal Plugging
Permission granted on: n/a
Rotary Cable X Rig
Total Depth (feet) 2230'
Fresh water depths (ft) Behind Pipe

Salt water depths (ft) Behind Pipe

Is coal being mined in area (Y/N)? N
Coal Depths (ft): Behind Pipe

Casing & Tubing Size	Used in Drilling	Left in Well	Cement Fill Up Cu. Ft.
8 1/2"	465'	465'	
6 5/8"	1864'	1864'	77 sx
4 1/2"	2149'	2149'	50 sx

OPEN FLOW DATA

Producing formation Injun Pay zone depth (ft) 2050-2060'
Gas: Initial open flow show MCF/d Oil: Initial open flow 0 Bbl/d
Final open flow 313 MCF/d Final open flow 0 Bbl/d
Time of open flow between initial and final tests 4 Hours
Static rock Pressure 154 psig (surface pressure) after 12 Hours

Second producing formation n/a Pay zone depth (ft)
Gas: Initial open flow MCF/d Oil: Initial open flow Bbl/d
Final open flow MCF/d Final open flow Bbl/d
Time of open flow between initial and final tests Hours
Static rock Pressure psig (surface pressure) after Hours

NOTE: ON BACK OF THIS FORM PUT THE FOLLOWING: 1). DETAILS OF PERFORATED INTERVALS, FRACTURING OR STIMULATING, PHYSICAL CHANGE, ETC. 2). THE WELL LOG WHICH IS A SYSTEMATIC DETAILED GEOLOGICAL RECORD OF ALL FORMATIONS, INCLUDING COAL ENCOUNTERED BY THE WELLBORE.

For: CAMERON OIL & GAS COMPANY

By: Douglas C. Malcolm, Consultant
Date: 7/13/94

JUL 15 1994

- 1) Attempted to drill through bridge @ 2230'. Only made 20' which then caved in again.
- 2) Ran 4½", 10.5#/ft., J-55 casing with Formation Packer Shoe on bottom to 2149'.
- 3) Cemented 4½" with 50 sx thixotropic cmt.
- 4) Perforated Injun 2050'-2060' with 30 holes.
- 5) Fractured Injun with 500 gal 15% HCl breakdown acid, 44500# sand, 233 mscf N₂, 150 bbls H₂O (75 quality foam), 1500 gal 28% HCl. BDP=1675 psi, ATP=1225 psi @ 20 bpm (downhole).

See original completion reports for driller's depths

<u>Depth</u>	<u>Formation</u>
1878'-2045'	Big Lime
2045'-2064'	Injun
2064'-2230'	Shale

19122

WEST VIRGINIA DEPARTMENT OF MINES

OIL & GAS DIVISION

WELL RECORD

Permit No. Bo-408

Gas Well

Madison Quad.

CASING & TUBING

Company	Cameron Oil & Gas Co.	8-1/4	465'	465'
Address	Box 1460, Charleston, W. Va.	6-5/8	1864	1864
Farm	Geo. P. Alderson ACRE 428	3	2015'10"	2015'10"
Location	Fuqua Fork			
Well No.	4A ELEV. 1176.89			
District	Scott County Boone	CASING CEMENTED		
Surface & Mineral Address	Geo. P. Alderson Lewisburg, W. Va.	Size - 7" OD 20#		
Drilling commenced	May 14, 1938	Feet - 871		
Drilling completed	July 11, 1938	Date - 6/22/38		
Shot	Not shot	COAL ENCOUNTERED		
Open Flow	-	Feet	Inches	
Volume	-	180		
Rock Pressure	-	450		
Water	-			

Formation Color ^{Hor} 5 Top Base Result Formation Color ^{Hor} 5 Top Base Result

Formation	Color	Hor	5	Top	Base	Result	Formation	Color	Hor	5	Top	Base	Result
Clay				0	80								
Sand	gray			80	140								
Slate	black			140	180								
Coal				180	185								
Slate	black			185	195								
Sand	white			195	245								
Slate	black			245	255	Water	250						
Sand	gray			255	325	Water	320	5 bailers					
Black Slate				325	366			1 Screw					
Lime	black			366	400								
Coal				450	455								
Sand	white			455	487								
Slate	black			487	492								
Sand	gray			492	509								
Slate	gray			509	525								
Sand	white			525	565								
Slate & Shells				565	860	Gas Show	965						
Sand	gray			860	900	Water	900	2 bailers					
Slate & Shells				900	950	Water	1075	Hole full					
Sand	gray			950	1082								
Slate	black			1082	1125								
Salt Sand				1125	1658								
Red Lime				1658	1685								
Slate & Shells				1685	1725								
Red Rock	red			1725	1740								
Slate				1740	1745								
Maxton Shells				1745	1770								
Slate				1770	1775								
Little Lime				1775	1815								
Slate	white			1815	1817								
Lime Shell				1817	1843								
Pencil Cave				1843	1845								
Big Lime				1845	2016	T.D.	Gas 1970						
							S.L.M. 1854'	- 12' in Big Lime					

WEST VIRGINIA DEPARTMENT OF MINES
OIL & GAS DIVISION
W E L L R E C O R D

Permit No. Boo 408-D

Madison Quad.

Company

Address

Farm

Location

Well No.

District

Surface

Mineral

Commenced

Completed

Date shot

Cameron Oil & Gas Company

801 Grant Street, Charleston, W.Va.

George P. Alderson Acres 428

Horse Creek

4-A Elev. 1176.89

Scott Boone County

George P. Alderson Heirs, et als

Charleston, W.Va.

Same

August 1945

Sept. 1947

9-6-47 Depth 3967-4860

RECORD OF WELL TO 1845' sent in - in 1938

✓ Big Lime	1845	2032	
✓ Injun Sand	2032	2072	
Shells	2072	2102	
✓ Weir Sand	2102	2137	
Slate & Shells	2137	2400	Gas at 4260
Lime	2400	2440	
Slate & Shells	2440	2510	Gas at 4330
✓ Shale Br	2510	2519	
✓ Berea Sand	2519	2544	Gas at 4682
Slate & Shells	2544	2910	
Lime Gray	2910	2945	
Slate & Shells	2945	3680	
Shale Br	3680	3715	
Lime Gr	3715	3745	
Slate & Shells	3745	3900	
Shale Br	3900	4020	
Lime Br	4020	4080	
Shale Wh	4080	4483	
Shale Br	4483	4649	
Slate Bl	4649	4675	
✓ Corniferous Lime	4675	4787	
✓ Oriskany Sand	4787	4860	
Total Depth		4860	

Top shot 3967
Bottom shot 4860
Shot with detonite

A75

4675	4787
<u>1177</u>	<u>1177</u>
- 3498	- 3610