

NOTES ON SURVEY

- NO WATER WELLS OR DEVELOPED SPRINGS WERE FOUND WITHIN 250' OF PROPOSED GAS WELL. NO AGRICULTURAL BUILDINGS > 2500 SQ. FT. OR DWELLINGS WERE FOUND WITHIN 625' OF THE CENTER OF PROPOSED WELL PAD. NO RAILROADS WERE FOUND WITHIN THE SCOPE OF THIS PLAT.
- TAX MAPS IN THIS AREA WERE FOUND TO CONTAIN SIGNIFICANT ERROR. PROPERTY LINES SHOWN HEREON WERE TAKEN FROM DEEDS AND FIELD EVIDENCE.
- TIES TO WELLS, CORNERS AND REFERENCES ARE BASED ON GRID NORTH FOR THE WV STATE PLANE COORDINATE SYSTEM NORTH ZONE NAD'27.

TAG	SURFACE OWNER	TAX MAP / PCL	ACREAGE
A	HOWDERSHOLT LIVING TRUST, MELVIN & RENEE HOWDERSHOLT TRUSTEES	19-41	158.94±
B	PAUL D. & JOHN R. ADAMS	18-31	109.00±
C	ROMMILL FAMILY TRUST	26-5	179.02±

**ARSENAL RESOURCES
HOWDERSHOLT BCH 204**

(S.P.C. NORTH ZONE) (UTM(M) ZONE 17 NORTH)

NAD'83 S.P.C.(FT) N. 254,073.4 E. 1,862,149.2
 NAD'83 GEO. LAT.(N) 39.195971 LONG.(W) 79.875258
 NAD'83 UTM (M) N. 4,339,237.6 E. 597,124.1

LANDING POINT

NAD'83 S.P.C.(FT) N. 253,270.9 E. 1,862,835.5
 NAD'83 GEO. LAT.(N) 39.194760 LONG.(W) 79.873530
 NAD'83 UTM (M) N. 4,338,994.0 E. 597,276.3

BOTTOM HOLE

NAD'83 S.P.C.(FT) N. 246,327.0 E. 1,865,739.3
 NAD'83 GEO. LAT.(N) 39.175730 LONG.(W) 79.862480
 NAD'83 UTM (M) N. 4,336,894.0 E. 598,257.1

SLS
Land & Energy Development
Solutions from the ground up.
P.O. Box 180 • 12 Vanhook Drive • Glenville, WV 26031 • (304) 462-5034
www.slsurveys.com

I THE UNDERSIGNED, HEREBY CERTIFY THAT THIS PLAT IS CORRECT TO THE BEST OF MY KNOWLEDGE AND BELIEF AND SHOWS ALL THE INFORMATION REQUIRED BY LAW AND THE REGULATIONS ISSUED AND PRESCRIBED BY THE DIVISION OF ENVIRONMENTAL PROTECTION.

P.S. 677 *Gregory A. Smith*



(+) DENOTES LOCATION OF WELL ON UNITED STATES TOPOGRAPHIC MAPS.
 DATE DECEMBER 7, 20 17

REVISED _____
 OPERATORS WELL NO. HOWDERSHOLT BCH 204
 API WELL NO. 47-001-03358
 STATE COUNTY PERMIT

MINIMUM DEGREE OF ACCURACY 1/2500 FILE NO. 7962NP204R.dwg
 HORIZONTAL & VERTICAL CONTROL DETERMINED BY DGPS (SURVEY GRADE TIE TO CORS NETWORK) SCALE 1" = 2000'

STATE OF WEST VIRGINIA
 DIVISION OF ENVIRONMENTAL PROTECTION
 OFFICE OF OIL AND GAS

WELL TYPE: OIL GAS LIQUID INJECTION WASTE DISPOSAL IF "GAS" PRODUCTION STORAGE DEEP SHALLOW

LOCATION: ELEVATION EXISTING: 1,553' / PROPOSED: 1,558' WATERSHED BRUSHY FORK
 DISTRICT COVE COUNTY BARBOUR QUADRANGLE NESTORVILLE 7.5'

SURFACE OWNER HOWDERSHOLT LIVING TRUST, MELVIN & RENEE HOWDERSHOLT TRUSTEES ACREAGE 158.94±
 ROYALTY OWNER HOWDERSHOLT LIVING TRUST, MELVIN & RENEE HOWDERSHOLT TRUSTEES, ET AL ACREAGE 158.94±

PROPOSED WORK: DRILL CONVERT DRILL DEEPER REDRILL FRACTURE OR STIMULATE PLUG OFF OLD FORMATION PERFORATE NEW FORMATION PLUG AND ABANDON CLEAN OUT AND REPLUG OTHER

PHYSICAL CHANGE IN WELL (SPECIFY) _____ TARGET FORMATION HUNTERSVILLE CHERT (PILOT HOLE)
 ESTIMATED DEPTH 15,599' TMD / 7,534' TVD (LATERAL)
7,702' TVD (PILOT HOLE)

WELL OPERATOR ARSENAL RESOURCES DESIGNATED AGENT WILLIAM VEIGEL
 ADDRESS 6031 WALLACE RD. EXT. SUITE 300 ADDRESS 65 PROFESSIONAL PLACE
WEXFORD, PA 15090 BRIDGEPORT, WV 26330

05/25/2018

COUNTY NAME PERMIT

HOWDERSHOLT PAD POSSIBLE WATER PURVEYORS

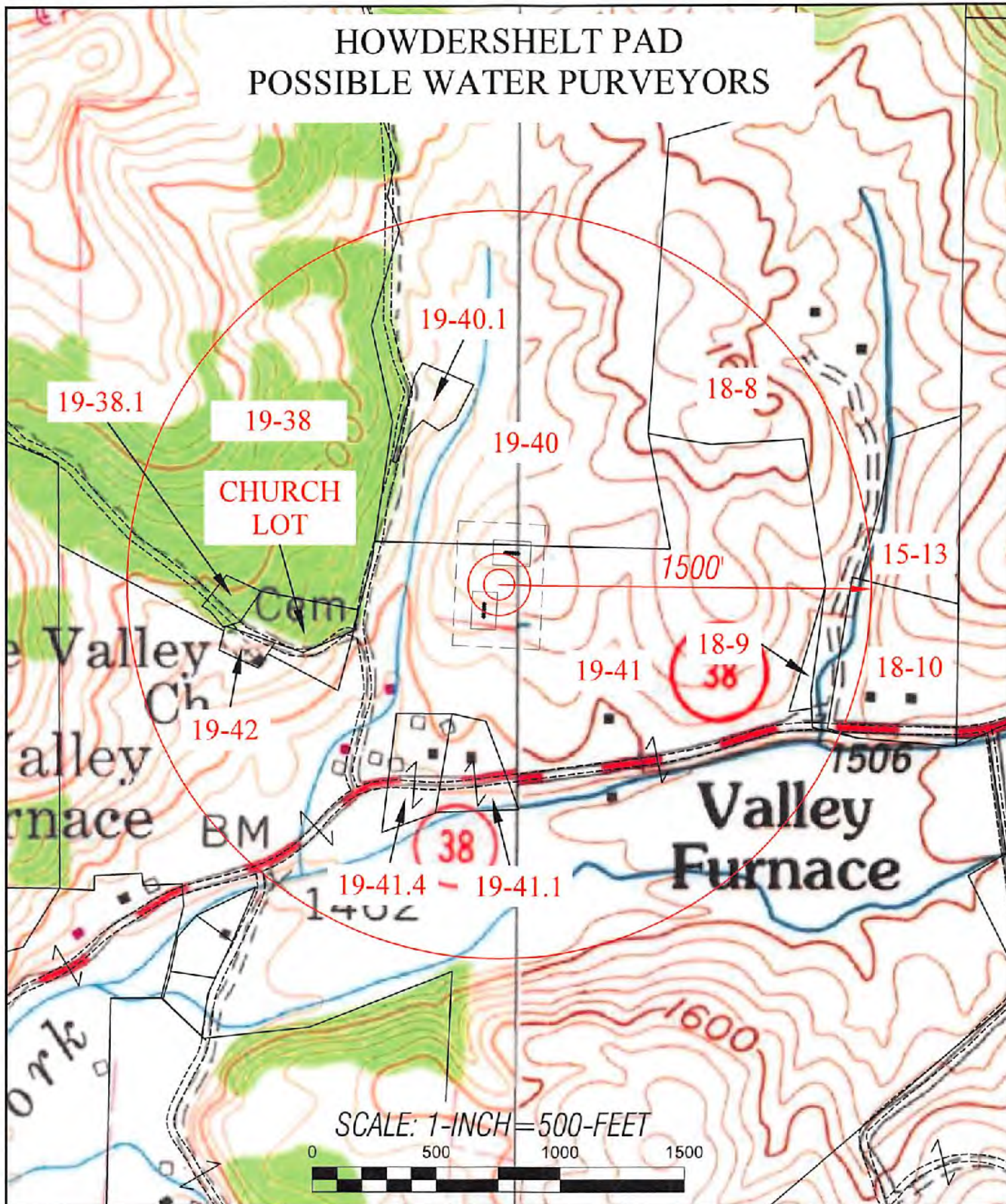

SCALE: 1-INCH = 500-FEET



TOPO SECTIONS OF:
COLEBANK & NESTORVILLE WV
7.5' QUADRANGLE

OPERATOR:

ARSENAL RESOURCES
65 Professional Place, Suite 200
Bridgeport, WV 26330

05/25/2018

DRAWN BY K.G.M.	FILE NO. 8606	DATE 12-11-17	CADD FILE: PDRWATERPURVEYORS.DWG
--------------------	------------------	------------------	-------------------------------------

COUNTY BARBOUR	DISTRICT COVE
-------------------	------------------